

ELEVATION

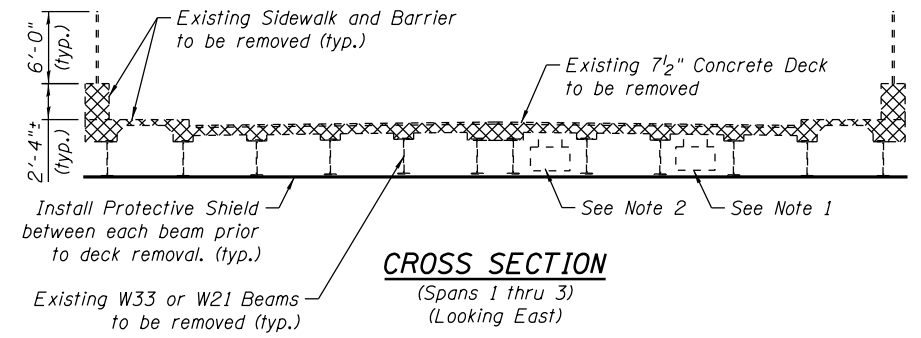

CROSS SECTION
(Spans 1 thru 3)
(Looking East)

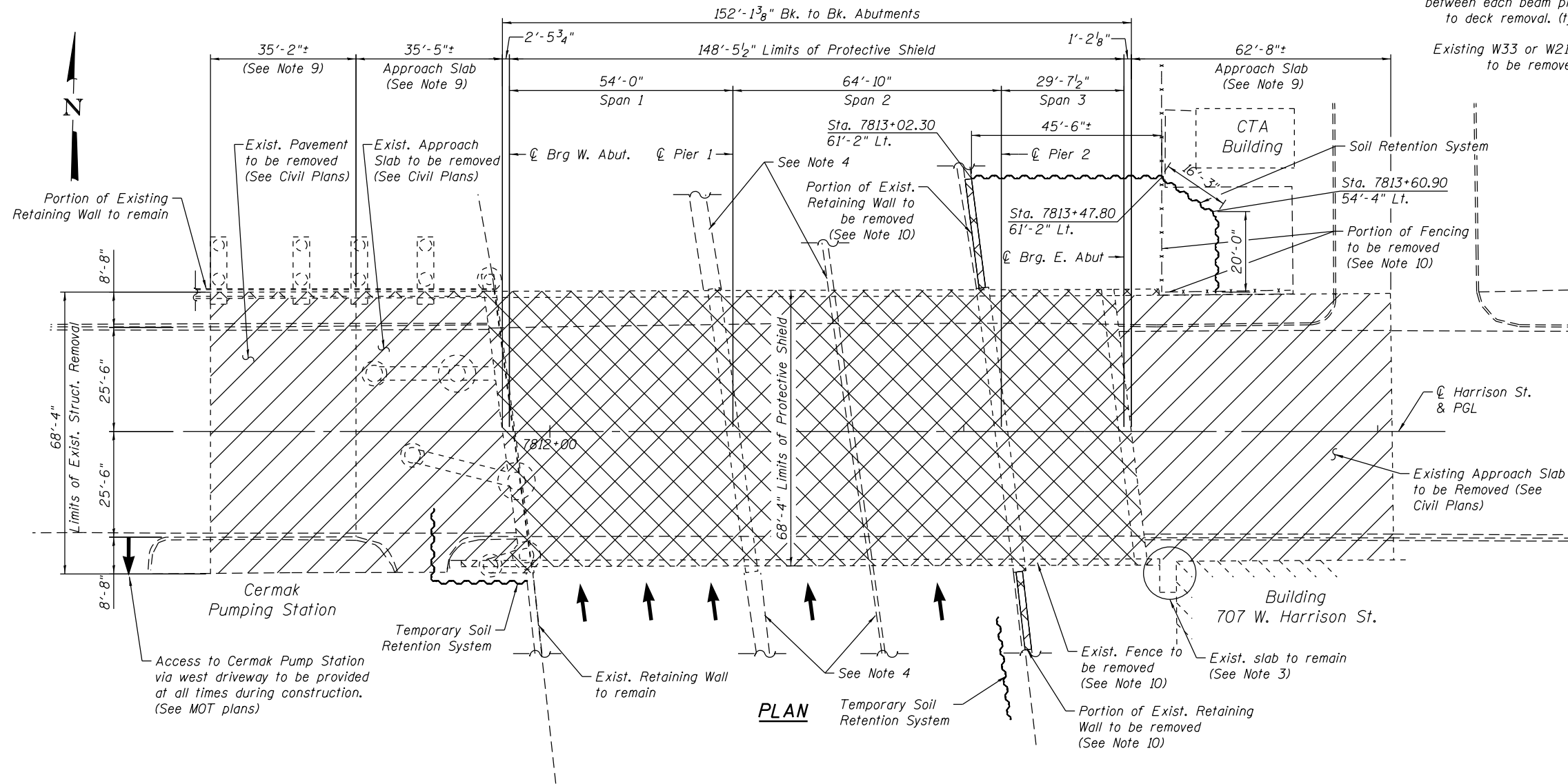

PLAN

LEGEND:

- Removal of Existing Structures
- See Civil Plans for Limits of Removal

NOTES:

1. Existing Utility between girders to be relocated (By Others) prior to bridge demolition. Utility to be placed back on proposed bridge (By Others).
2. Existing Utility to be removed and replaced as part of this contract. (See Electrical Plans for details)
3. Contractor to protect the existing entrance to 707 W. Harrison St. during construction.
4. See Civil Plans for roadway barrier removal under the structure, along ramps and I-90/94.
5. Work this sheet with sheets S-05 and S-06.
6. For Temporary Soil Retention and Soil Retention System limits see sheet S-07.
7. Reference sheets AS-1 thru AS-72 for existing bridge dimensions and details.
8. The Contractor shall take precautions to protect existing utilities and foundations during construction of the bridge. The utilities were located based on SUE and utility supplier information available at design.
9. The existing approach slab, pavement and sidewalk removal will be included in civil pay items. See Civil Plans for details.
10. The existing retaining wall, light poles and fence removal are part of this contract and will be included in Removal of Existing Structures pay item.



USER NAME = dabe2lcd	DESIGNED - EJO	REVISED
CHECKED - DD	REVISOR	REVISOR
PLOT SCALE = N.T.S.	DRAWN - BRD	REVISOR
PLOT DATE = 2/19/2014	CHECKED - DD	REVISOR

**STATE OF ILLINOIS
DEPARTMENT OF TRANSPORTATION**

**EXISTING STRUCTURAL REMOVAL (1 of 3)
STRUCTURE NO. 016-1711**

SHEET NO. S-04 OF S-47 SHEETS

F.A.I. RTE. 90/94/290	SECTION 2013-036R	COUNTY COOK	TOTAL SHEETS 256	SHEET NO. 96
CONTRACT NO. 60W71				ILLINOIS FED. AID PROJECT NUMBER

0161711-60W71-S04-Removal