

FOR INFORMATION ONLY

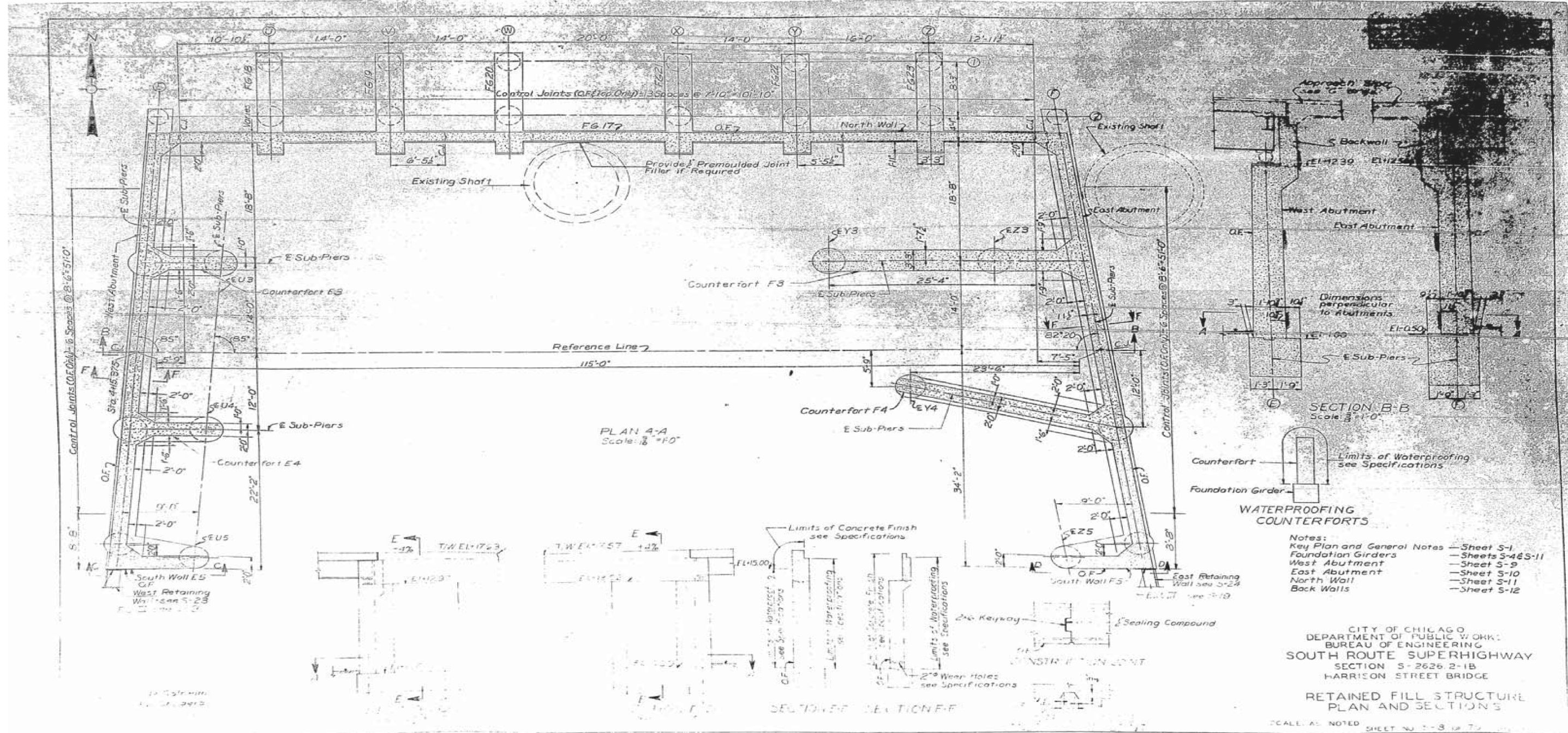

- Notes:
- Key Plan and General Notes — Sheet S-1
 - Foundation Girders — Sheets S-4&S-11
 - West Abutment — Sheet S-9
 - East Abutment — Sheet S-10
 - North Wall — Sheet S-11
 - Back Walls — Sheet S-12

CITY OF CHICAGO
 DEPARTMENT OF PUBLIC WORKS
 BUREAU OF ENGINEERING
 SOUTH ROUTE SUPERHIGHWAY
 SECTION S-2626.2-1B
 HARRISON STREET BRIDGE
 RETAINED FILL STRUCTURE
 PLAN AND SECTION S
 SCALE AS NOTED SHEET NO. S-3 OF 7

D160W71-sht-AS-BUILT-37.dgn

USER NAME = dunkerleyb	DESIGNED -	REVISED
	CHECKED -	REVISED
PLOT SCALE = N.T.S.	DRAWN -	REVISED
PLOT DATE = 11/26/2013	CHECKED -	REVISED

STATE OF ILLINOIS
 DEPARTMENT OF TRANSPORTATION

EXISTING AS-BUILTS SN 016-1088

SHEET NO. AS-37 OF AS-72 SHEETS

F.A.I. R.T.E.	SECTION	COUNTY	TOTAL SHEETS	SHEET NO.
90/94/290	2013-036R	COOK	256	179
				CONTRACT NO. 60W71
ILLINOIS FED. AID PROJECT -NUMBER-				