

DATE	
BY	
FINAL SURVEY	SURVEYED
NOTE BOOK	PLOTTED
NO.	TEMPLATE
	AREAS
	CHECKED

DATE	
BY	
ORIGINAL SURVEY	SURVEYED
NOTE BOOK	PLOTTED
NO.	TEMPLATE
	AREAS
	CHECKED

FILE PATH = p:\388093\p\m\concom\me\local\PM\EC\DWG\Documents\01\Americas\Transportation\62629938\_Circle\Phase\1\000\_CAD\006\_Roadway\Sheets\60W71\_Contract\0160W71-ht-XS-HAR.dgn

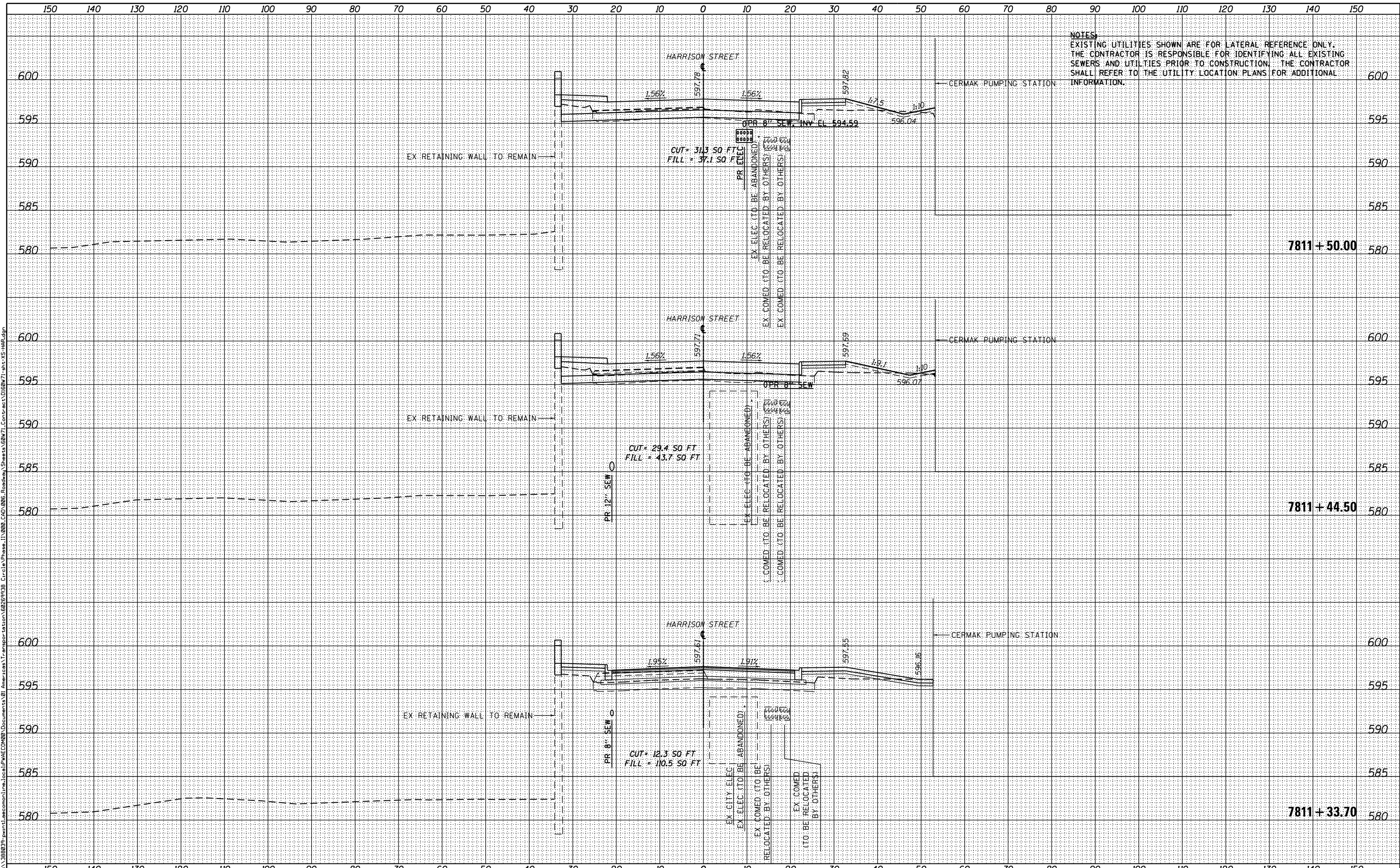

**NOTES:**  
 EXISTING UTILITIES SHOWN ARE FOR LATERAL REFERENCE ONLY.  
 THE CONTRACTOR IS RESPONSIBLE FOR IDENTIFYING ALL EXISTING  
 SEWERS AND UTILITIES PRIOR TO CONSTRUCTION. THE CONTRACTOR  
 SHALL REFER TO THE UTILITY LOCATION PLANS FOR ADDITIONAL  
 INFORMATION.



D160W71-ht-XS-HAR.dgn  
 USER NAME = PIMSARNO  
 PLOT SCALE = 20.0000' / in.  
 PLOT DATE = 2/18/2014

DESIGNED - OPS  
 DRAWN - OPS  
 CHECKED - DBM  
 DATE - 02/19/14

REVISED -  
 REVISED -  
 REVISED -  
 REVISED -

**STATE OF ILLINOIS  
 DEPARTMENT OF TRANSPORTATION**

**HARRISON STREET CROSS SECTION**

SCALE: 1:5V,1:10H SHEET 2 OF 5 SHEETS STA. 7811+33.70 TO STA. 7811+50.00

F.A.I. RTE.	SECTION	COUNTY	TOTAL SHEETS	SHEET NO.
90/94/290	2013-036R	COOK	256	254A
CONTRACT NO. 60W71				
ILLINOIS FED. AID PROJECT				