

EXIST. CURVE E_157-8
 PI STA. = 349+61.70
 Δ = 6° 09' 02" (RT)
 D = 2° 18' 37"
 R = 2,479.98'
 T = 133.24'
 L = 266.22'
 E = 3.58'
 e = ----
 T.R. = ----
 S.E. RUN = ----
 P.C. STA. = 348+28.47
 P.T. STA. = 350+94.68

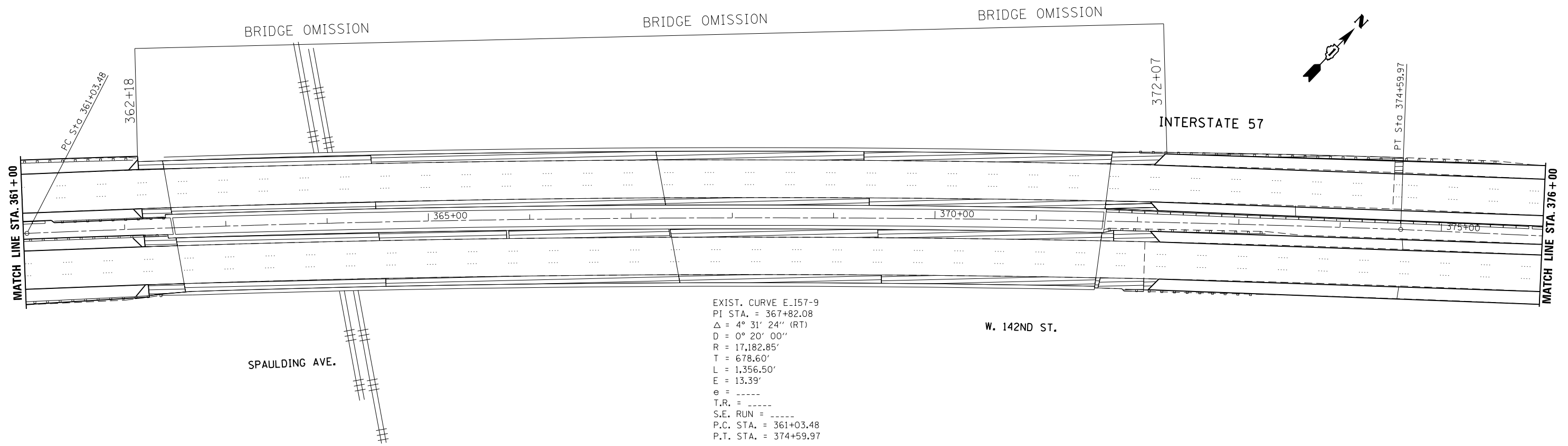

EXIST. CURVE E_157-9
 PI STA. = 367+82.08
 Δ = 4° 31' 24" (RT)
 D = 0° 20' 00"
 R = 17,182.85'
 T = 678.60'
 L = 1,356.50'
 E = 13.39'
 e = ----
 T.R. = ----
 S.E. RUN = ----
 P.C. STA. = 361+03.48
 P.T. STA. = 374+59.97

FILE NAME =	USER NAME = Bakerom	DESIGNED -	REVISED -
c:\pwork\pwork\pwork\pwork\d0370686\011614-shit-plan.dgn		DRAWN -	REVISED -
Default	PLOT SCALE = 100.0000' / in.	CHECKED -	REVISED -
	PLOT DATE = 2/21/2014	DATE -	REVISED -

**STATE OF ILLINOIS
 DEPARTMENT OF TRANSPORTATION**

**ROADWAY PLAN
 INTERSTATE 57 (FROM N. OF 175TH ST. TO IL ROUTE 1)**

SCALE: SHEET OF SHEETS STA. TO STA.

F.A.I. RTE.	SECTION	COUNTY	TOTAL SHEETS	SHEET NO.
57	2013-079I	COOK	32	15
CONTRACT NO. 60X67				
ILLINOIS FED. AID PROJECT				