

PLANS FOR PROPOSED FEDERAL AID HIGHWAY

FAU 0037 (DEAN STREET)

SIDEWALK INSTALLATION PRAIRIE RIDGE DRIVE TO KIMBALL AVENUE

SECTION 12-00112-00-SW

PROJECT NO. SRTS-4009(190)

CITY OF WOODSTOCK

MCHENRY COUNTY

JOB NO. C-91-555-12

F.A.U. RTE.	SECTION	COUNTY	TOTAL SHEETS	SHEET NO.
37	12-00112-00-SW	MCHENRY	20	1
		ILLINOIS	CONTRACT NO. 61A15	



INDEX OF SHEETS	
SHEET NO.	DESCRIPTION
1	COVER SHEET
2	GENERAL NOTES, TYPICAL SECTIONS
3	SUMMARY OF QUANTITIES
4	SCHEDULE OF QUANTITIES
5-8	DEAN STREET PLAN AND PROFILE
9-10	DETAILS
11-18	DEAN STREET CROSS SECTIONS
19-20	DISTRICT 1 STANDARDS

HIGHWAY STANDARDS

- 000001-06 STANDARD SYMBOLS, ABBREVIATIONS AND PATTERNS
- 280001-07 TEMPORARY EROSION CONTROL SYSTEMS
- 424001-07 PERPENDICULAR CURB RAMPS FOR SIDEWALKS
- 602011-02 CATCH BASIN TYPE C
- 604001-03 FRAME AND LID TYPE 1
- 604036-02 GRATE TYPE 8
- 604051-03 FRAME AND GRATE TYPE 11
- 606001-05 CONCRETE CURB TYPE B AND COMBINATION CONCRETE CURB AND GUTTER
- 701006-05 OFF-RD OPERATIONS, 2L, 2W, 15' (4.5 m) TO 24" (600 mm) FROM PAVEMENT EDGE
- 701301-04 LANE CLOSURE, 2L, 2W, SHORT TIME OPERATIONS
- 701311-03 LANE CLOSURE, 2L, 2W MOVING OPERATIONS - DAY ONLY
- 701501-06 URBAN LANE CLOSURE, 2L, 2W, UNDIVIDED
- 701801-05 SIDEWALK, CORNER OR CROSSWALK CLOSURE
- 701901-03 TRAFFIC CONTROL DEVICES

IMPROVEMENT ENDS
STA. 30+58

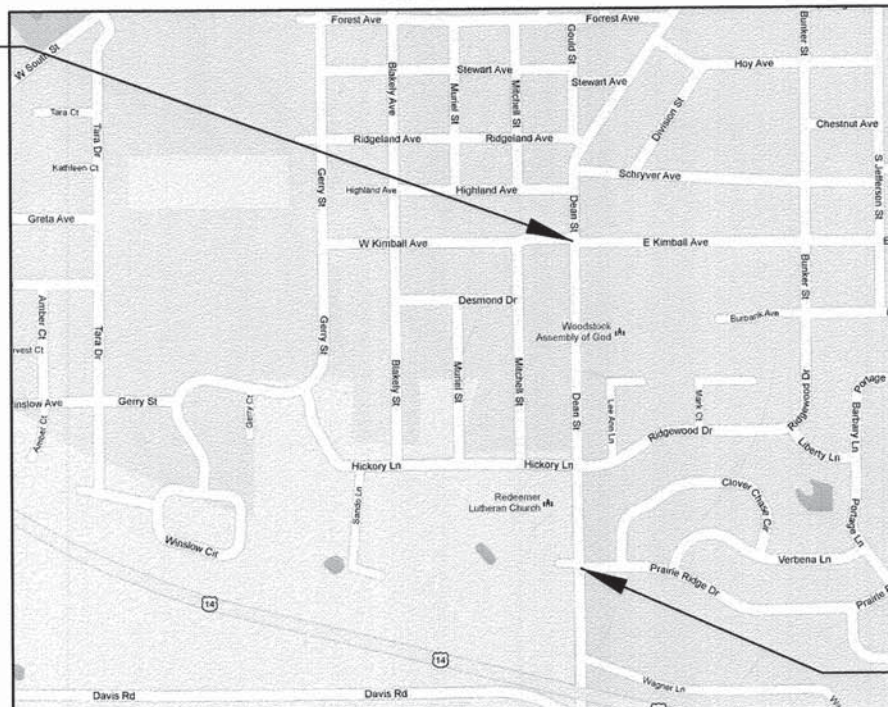

IMPROVEMENT BEGINS
STA. 11+34

LOCATION MAP
GROSS LENGTH = 1924 FT = 0.36 MILE
NET LENGTH = 1924 FT = 0.36 MILE

PRINTED BY THE AUTHORITY OF THE STATE OF ILLINOIS

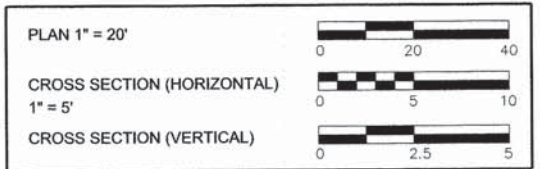

DEAN STREET:
ADT = 5500
POSTED SPEED LIMIT = 30 MPH
DESIGN SPEED = 30 MPH
FUNCTIONAL CLASSIFICATION = LOCAL
CONTRACT NO. 61A15

STATE OF ILLINOIS
DEPARTMENT OF TRANSPORTATION
DIVISION OF HIGHWAYS

APPROVED FEBRUARY 3 20 14
Paul K. ... PUBLIC WORKS DIRECTOR
TITLE, CITY OF WOODSTOCK

PASSED FEBRUARY 10 20 14
C. Holt C.J. HOLT
DISTRICT 1 ENGINEER OF LOCAL ROADS

RELEASING FOR BID
BASED ON LIMITED
REVIEW FEBRUARY 10 20 14
John ... DEPUTY DIRECTOR OF HIGHWAYS, REGION 1 ENGINEER

DATE: 2/3/14
BY: *[Signature]*
LICENSE EXPIRES: NOVEMBER 30, 2015

LICENSE NO. 062-052119
REGISTERED PROFESSIONAL ENGINEER
STATE OF ILLINOIS
SEAL: EXPIRES: 11/30/2015

Hampton, Lenzini and Renwick, Inc.
Civil Engineers - Structural Engineers
Land Surveyors - Environmental Services
380 SHEPARD DRIVE
ELGIN, ILLINOIS 60123
847.697.6700 www.hirengineering.com
ILLINOIS PROFESSIONAL DESIGN FIRM LS / PE CORPORATION

PROJECT NUMBER: 12.0146.330 DATE: 01/23/2014

FEDERAL AID PROGRAM ENGINEER: FAWAD ARQUEEL, P.E. 847-705-4021 SCHAUMBURG, IL

GENERAL NOTES

ALL WORK SHALL BE IN ACCORDANCE WITH THE "STANDARD SPECIFICATIONS FOR ROAD AND BRIDGE CONSTRUCTION," ADOPTED JANUARY 1, 2012, (HEREINAFTER REFERRED TO AS THE STANDARD SPECIFICATIONS); THE "SUPPLEMENTAL SPECIFICATIONS AND RECURRING SPECIAL PROVISIONS," ADOPTED JANUARY 1, 2014; "STANDARD SPECIFICATIONS FOR WATER AND SEWER CONSTRUCTION IN ILLINOIS"; THE LATEST EDITION OF THE "ILLINOIS MANUAL ON UNIFORM TRAFFIC CONTROL DEVICES FOR STREETS AND HIGHWAYS"; THE DETAILS IN THE PLANS AND THE SPECIAL PROVISIONS INCLUDED INCLUDED IN THE CONTRACT DOCUMENTS.

ANY REFERENCE TO STANDARDS THROUGHOUT THE PLANS OR SPECIAL PROVISIONS SHALL BE INTERPRETED AS THE LATEST STANDARD OF THE ILLINOIS DEPARTMENT OF TRANSPORTATION.

THE CONTRACTOR SHALL COOPERATE WITH THE CITY OF WOODSTOCK IF ANY MUNICIPAL UTILITY IMPROVEMENTS ARE REQUIRED WITHIN THE DURATION OF THE CONTRACT.

THE CONTRACTOR SHALL BE RESPONSIBLE FOR CONTACTING THE OWNERS OF ALL UTILITIES PRIOR TO CONSTRUCTION TO DETERMINE THE LOCATION OF ALL UTILITY EQUIPMENT. THE CONTRACTOR SHALL COOPERATE WITH ALL UTILITY OWNERS AS PROVIDED FOR IN THE STANDARD SPECIFICATIONS IF UTILITY RELOCATION, ADJUSTMENT OR PROTECTION IS NECESSARY.

THE LOCATION ON THE PLANS OF EXISTING DRAINAGE STRUCTURES, STORM SEWERS, WATER MAINS, SANITARY SEWERS, AND ANY OTHER PUBLIC AND PRIVATE UTILITIES IS APPROXIMATE AND THEIR EXACT LOCATIONS ARE TO BE DETERMINED IN THE FIELD BY THE CONTRACTOR AT THE CONTRACTOR'S EXPENSE.

THE CONTRACTOR SHALL BE RESPONSIBLE FOR THE PROTECTION OF ALL UNDERGROUND OR SURFACE UTILITIES EVEN THOUGH THEY MAY NOT BE SHOWN ON THE PLANS. ANY UTILITY THAT IS DAMAGED DURING CONSTRUCTION SHALL BE REPAIRED OR REPLACED TO THE SATISFACTION OF THE OWNER AT THE CONTRACTOR'S EXPENSE.

THE CONTRACTOR SHALL PROTECT AND CAREFULLY PRESERVE ALL SECTION OR SUBSECTION MONUMENTS, PROPERTY CORNERS AND REFERENCE MARKERS UNTIL THE OWNER, HIS AGENT OR A PROFESSIONAL LAND SURVEYOR HAS WITNESSED OR OTHERWISE REFERENCED THEIR LOCATIONS.

ALL ELEVATIONS ARE ON AN ASSUMED LOCAL DATUM.

WHENEVER ANY LOOSE MATERIAL IS DEPOSITED IN THE FLOW LINE OF DRAINAGE STRUCTURES SUCH THAT THE NATURAL FLOW OF WATER IS OBSTRUCTED, THE MATERIAL SHALL BE REMOVED AT THE CLOSE OF EACH WORKING DAY. PRIOR TO ACCEPTANCE OF THE IMPROVEMENT, ALL DRAINAGE STRUCTURES SHALL BE FREE OF DIRT AND DEBRIS. THIS WORK WILL NOT BE PAID FOR SEPARATELY BUT SHALL BE INCLUDED IN THE COST OF THE CONTRACT.

WHEN EXISTING DRAINAGE FACILITIES ARE DISTURBED, THE CONTRACTOR SHALL PROVIDE AND MAINTAIN IN AN OPERATING CONDITION TEMPORARY OUTLETS AND CONNECTIONS FOR ALL DRAINS, SEWERS AND CATCH BASINS. THIS WORK WILL NOT BE PAID FOR SEPARATELY, BUT SHALL BE INCLUDED IN THE COST OF THE CONTRACT.

THE CONTRACTOR SHALL BE SOLELY RESPONSIBLE FOR HIS WORK. ANY WORK THAT IS VANDALIZED OR OTHERWISE DAMAGED AND JUDGED UNACCEPTABLE BY THE ENGINEER SHALL BE REMOVED AND REPLACED AT THE CONTRACTOR'S EXPENSE.

FORTY-EIGHT HOURS BEFORE STARTING EXCAVATION, THE CONTRACTOR WILL CALL J.U.L.I.E. (1-800-892-0123) TO HAVE THE LOCATION OF EXISTING UTILITIES STAKED.

EROSION AND SEDIMENT CONTROL DEVICES SHALL BE PLACED ACCORDING TO THE SCHEDULES CONTAINED HEREIN OR AS DIRECTED BY THE ENGINEER.

LEGEND

- EXISTING BUSH
- EXISTING DECIDUOUS TREE & DIAMETER
- EXISTING EVERGREEN TREE & DIAMETER
- EXISTING DRAINAGE MANHOLE
- PROPOSED DRAINAGE MANHOLE
- PROPOSED CATCH BASIN
- PROPOSED INLET
- EXISTING STORM SEWER
- PROPOSED STORM SEWER
- EXISTING UNDERGROUND GAS
- EXISTING UNDERGROUND TELEPHONE
- EXISTING AERIAL POWER LINE
- EXISTING UNDERGROUND CABLE TV
- EXISTING SANITARY SEWER
- EXISTING WATERMAIN
- EXISTING ROW
- EXISTING LIGHT STANDARD
- EXISTING HANDHOLE
- MAIL BOX
- EXISTING UTILITY POLE
- DEPRESSED CURB
- CLASS D PATCH, 8"
- CURB AND GUTTER REMOVAL
- SIDEWALK REMOVAL
- DETECTABLE WARNINGS
- DRIVEWAY PAVEMENT REMOVAL AND DRIVEWAY PAVEMENT, 4"

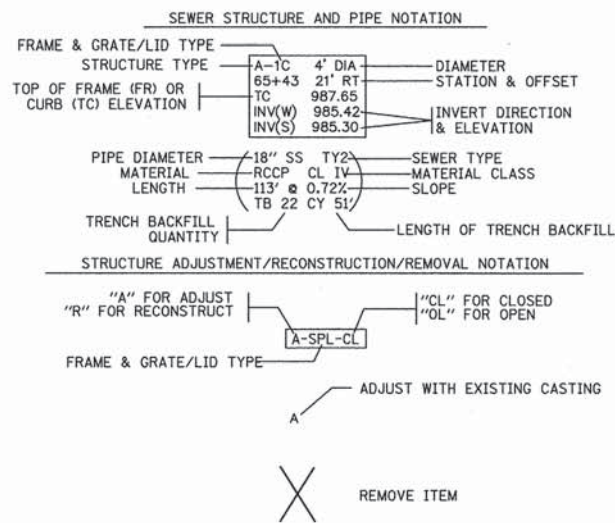

HOT-MIX ASPHALT MIXTURE REQUIREMENTS	
MIXTURE TYPE	AIR VOIDS
DRIVEWAYS	
HMA SURFACE COURSE, MIX D, N50 (IL 9.5mm); 1 3/4"	4% @ 50 GYR.
HMA BASE COURSE (HMA BINDER IL-19.0); 2 1/4"	4% @ 50 GYR.
PATCHING	
HMA SURFACE COURSE, MIX D, N50 (IL 9.5mm); 2"	4% @ 50 GYR.
CLASS D PATCHING (HMA BINDER IL-19mm); 8", (2 Lifts)	4% @ 50 GYR.

THE UNIT WEIGHT USED TO CALCULATE ALL HMA SURFACE MIXTURE QUANTITIES IS 112 LBS/SQ YD/IN.

THE "AC TYPE" FOR POLYMERIZED HMA MIXES SHALL BE SBS/SBR 76-22 AND FOR NON-POLYMERIZED HMA, THE "AC TYPE" SHALL BE PG 64-22 UNLESS MODIFIED BY DISTRICT ONE SPECIAL PROVISIONS.

FOR PERCENT OF RAP, SEE DISTRICT ONE SPECIAL PROVISIONS.

NOTE: ALL PATCHING SHALL BE CLASS D PATCHING WITH 8" HMA BASE COURSE AND 2" SURFACE COURSE

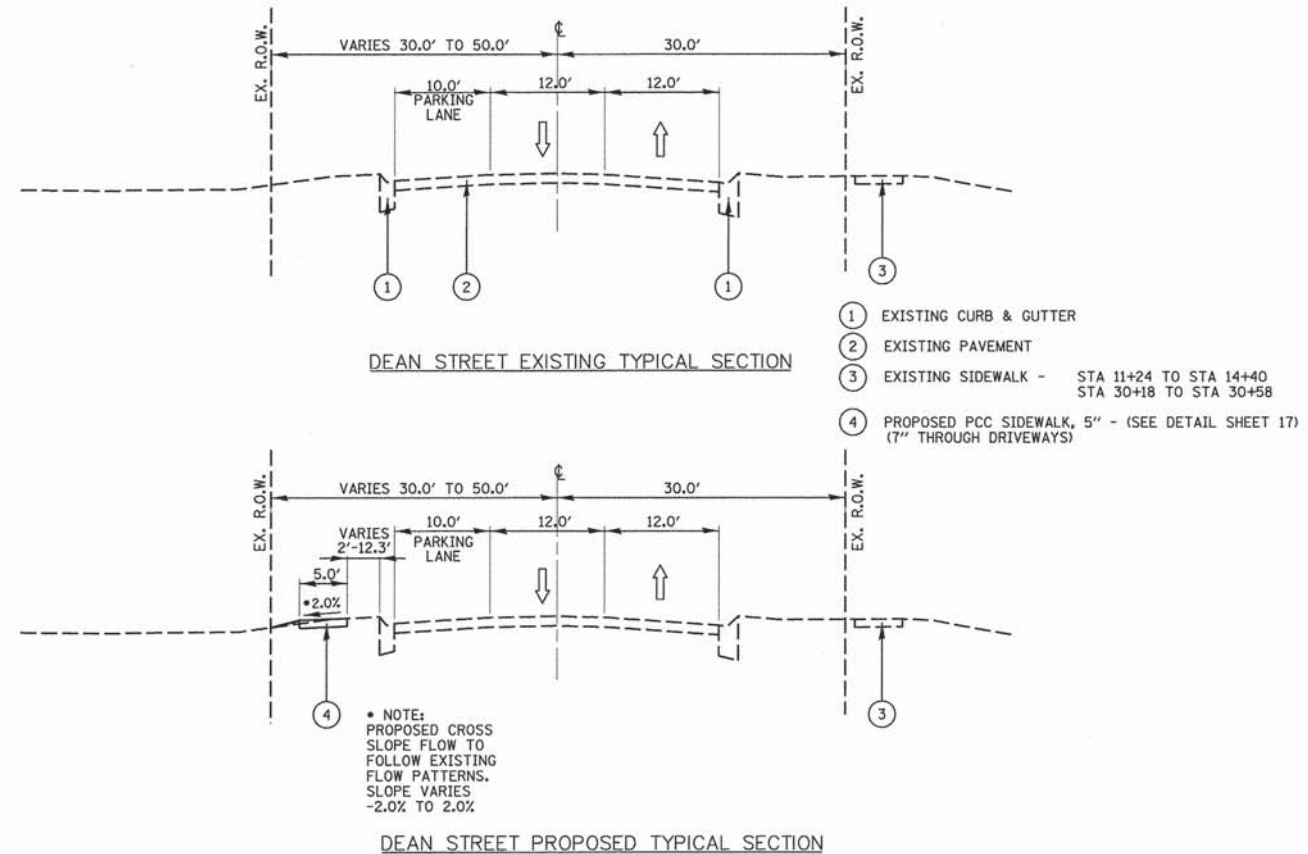

SUMMARY OF QUANTITIES

		0021			
CODE NO.	ITEM	UNIT	TOTAL QUANTITY	S.I.	SP PR
20101200	TREE ROOT PRUNING	EACH	3.0		
20800150	TRENCH BACKFILL	CU YD	46.		
21101615	TOPSOIL FURNISH AND PLACE, 4"	SQ YD	540.		
25000110	SEEDING, CLASS 1A	ACRE	0.1		
25000400	NITROGEN FERTILIZER NUTRIENT	POUND	10.0		
25000500	PHOSPHORUS FERTILIZER NUTRIENT	POUND	10.0		
25000600	POTASSIUM FERTILIZER NUTRIENT	POUND	10.0		
28000250	TEMPORARY EROSION CONTROL SEEDING	POUND	9.0		
28000400	PERIMETER EROSION BARRIER	FOOT	1,290.0		
28000510	INLET FILTERS	EACH	15.0		
28001100	TEMPORARY EROSION CONTROL BLANKET	SQ YD	540		
42400200	PORTLAND CEMENT CONCRETE SIDEWALK 5 INCH	SQ FT	8,793.0		
42400400	PORTLAND CEMENT CONCRETE SIDEWALK 7 INCH	SQ FT	1,390.0		
42400800	DETECTABLE WARNINGS	SQ FT	48.0		
44000200	DRIVEWAY PAVEMENT REMOVAL	SQ YD	386.		
44000500	COMBINATION CURB AND GUTTER REMOVAL	FOOT	183.0		
44000600	SIDEWALK REMOVAL	SQ FT	660.0		
44201737	CLASS D PATCHES, TYPE I, 8 INCH	SQ YD	10.	X	
44201741	CLASS D PATCHES, TYPE II, 8 INCH	SQ YD	47	X	
44201745	CLASS D PATCHES, TYPE III, 8 INCH	SQ YD	22	X	
44201747	CLASS D PATCHES, TYPE IV, 8 INCH	SQ YD	27.	X	
550A0340	STORM SEWERS, CLASS A, TYPE 2 12"	FOOT	22.0		

SUMMARY OF QUANTITIES

		0021			
CODE NO.	ITEM	UNIT	TOTAL QUANTITY	S.I.	SP PR
56103000	DUCTILE IRON WATER MAIN 6"	FOOT	29.0	X	*
56200300	WATER SERVICE LINE 1"	FOOT	30.0	X	
56201400	CORPORATION STOPS 1"	EACH	2.0	X	*
56400510	FIRE HYDRANTS TO BE REMOVED AND REPLACED	EACH	1.0	X	*
56500600	DOMESTIC WATER SERVICE BOXES TO BE ADJUSTED	EACH	5.0	X	*
56500800	DOMESTIC WATER SERVICE BOXES	EACH	2.0	X	*
60207605	CATCH BASINS, TYPE C, TYPE 8 GRATE	EACH	1.0		
60207905	CATCH BASINS, TYPE C, TYPE 11 FRAME AND GRATE	EACH	1.0		
60255700	MANHOLES TO BE ADJUSTED WITH NEW TYPE 1 FRAME, OPEN LID	EACH	3.0		
60255800	MANHOLES TO BE ADJUSTED WITH NEW TYPE 1 FRAME, CLOSED LID	EACH	4.0		
60257900	MANHOLES TO BE RECONSTRUCTED	EACH	4.0		
60603800	COMBINATION CONCRETE CURB AND GUTTER, TYPE B-6.12	FOOT	183.0		
67100100	MOBILIZATION	L SUM	1.0		
70102620	TRAFFIC CONTROL AND PROTECTION, STANDARD 701501	L SUM	1.0		
70102640	TRAFFIC CONTROL AND PROTECTION, STANDARD 701801	L SUM	1.0		
72000100	SIGN PANEL - TYPE 1	SQ FT	17.0		
72900100	METAL POST - TYPE A	FOOT	28.0		
78001130	PAINT PAVEMENT MARKING - LINE 6"	FOOT	237.0	X	
78001180	PAINT PAVEMENT MARKING - LINE 24"	FOOT	48.0	X	
Z0004514	HOT-MIX ASPHALT DRIVEWAY PAVEMENT, 4"	SQ YD	386	X	*
Z0015000	CURB STOPS 1"	EACH	2.0		*

FILE NAME =	USER NAME = #USER#	DESIGNED - RCL	REVISED -
F:\2012\120146\cad\phase 2\dwg-East Side	E:\minotad\120146-shr\notes.dgn	DRAWN - RCL	REVISED -
	PLOT SCALE = #SCALE#	CHECKED -	REVISED -
	PLOT DATE = 2/20/2014	DATE -	REVISED -

**STATE OF ILLINOIS
DEPARTMENT OF TRANSPORTATION**

**WOODSTOCK SAFE ROUTES
SUMMARY OF QUANTITIES**

SCALE: NTS SHEET 1 OF 1 SHEETS STA. TO STA.

F.A.U. RTE.	SECTION	COUNTY	TOTAL SHEETS	SHEET NO.
0037	12-00112-00-SW	MCHENRY	20	3
CONTRACT NO. 61A15			ILLINOIS FED. AID PROJECT	

DATE	
BY	
REVISIONS	
NO.	
PLAN	
NO.	
NOTE BOOK	
NO.	
ALIGNED	
CHECKED	
DATE	
FILE NAME	

DATE	
BY	
REVISIONS	
NO.	
PROFILE	
NO.	
GRADES	
CHECKED	
DATE	
STRUCTURE	
NOTATION	
CHRD	

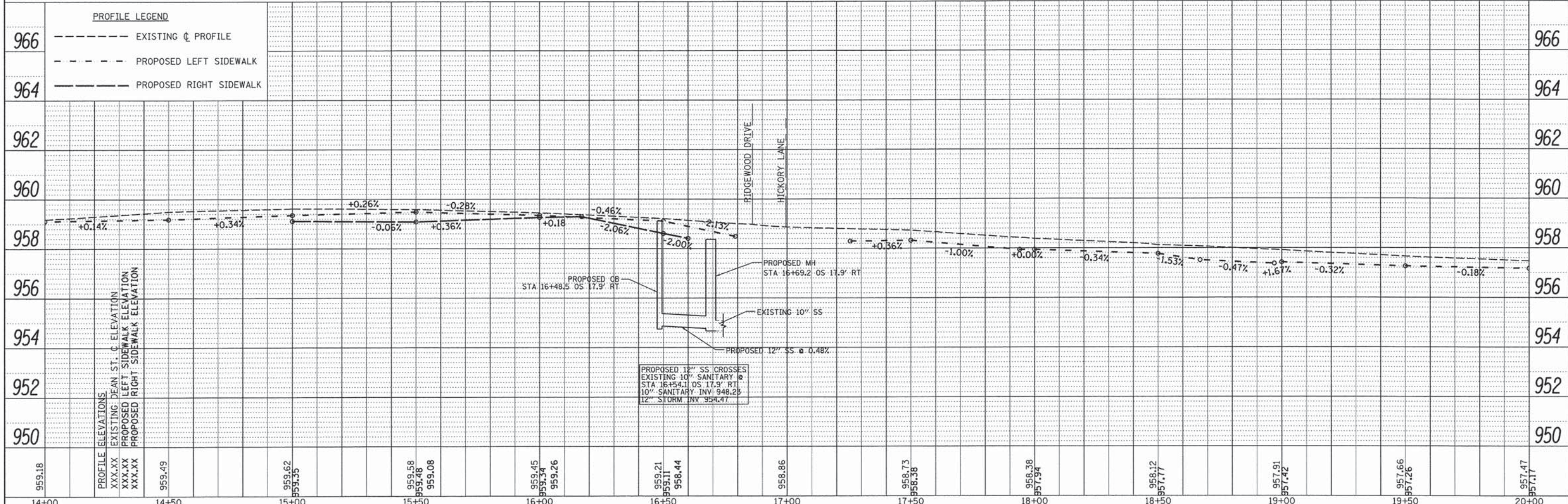
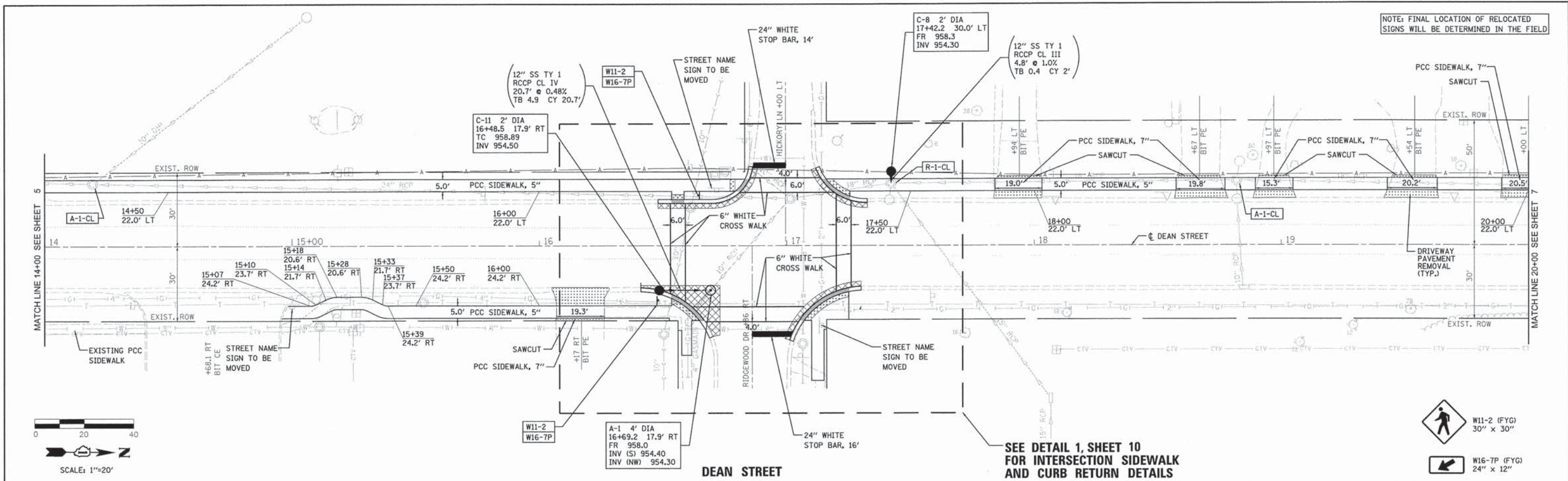

FILE NAME =	USER NAME = #USER#	DESIGNED - NMP	REVISED -
PLOT SCALE = #SCALE#	CHECKED - CM	DRAWN - JMH	REVISED -
PLOT DATE = 2/1/2014	DATE -	CHECKED -	REVISED -

STATE OF ILLINOIS
DEPARTMENT OF TRANSPORTATION



WOODSTOCK SAFE ROUTES
DEAN STREET PLAN AND PROFILE

F.A.U. RTE.	SECTION	COUNTY	TOTAL SHEETS	SHEET NO.
0037	12-00112-00-SW	MCHENRY	20	6
CONTRACT NO. 61A15			ILLINOIS FED. AID PROJECT	

SCALE: 1" = 20' SHEET 2 OF 4 SHEETS STA. 14+00 TO STA. 20+00

PLAN	DATE	BY
DESIGNED		
ALIGNED		
CHECKED		
DATE		
NO.		

PROFILE	DATE	BY
DESIGNED		
CHECKED		
DATE		
NO.		

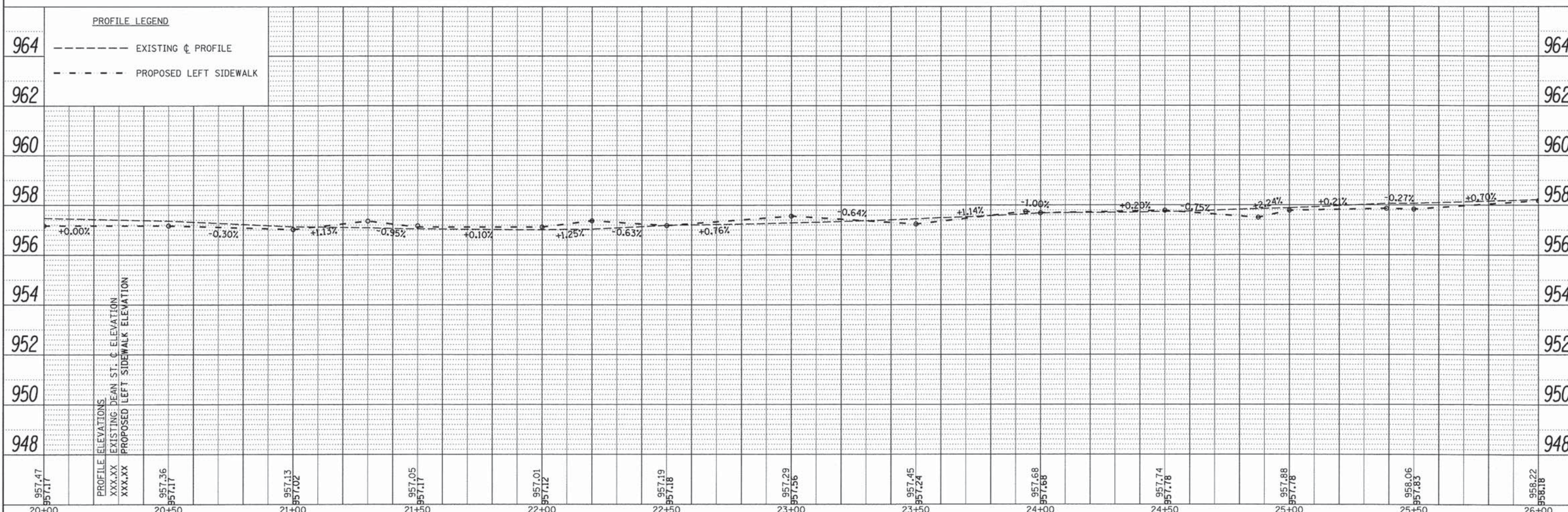
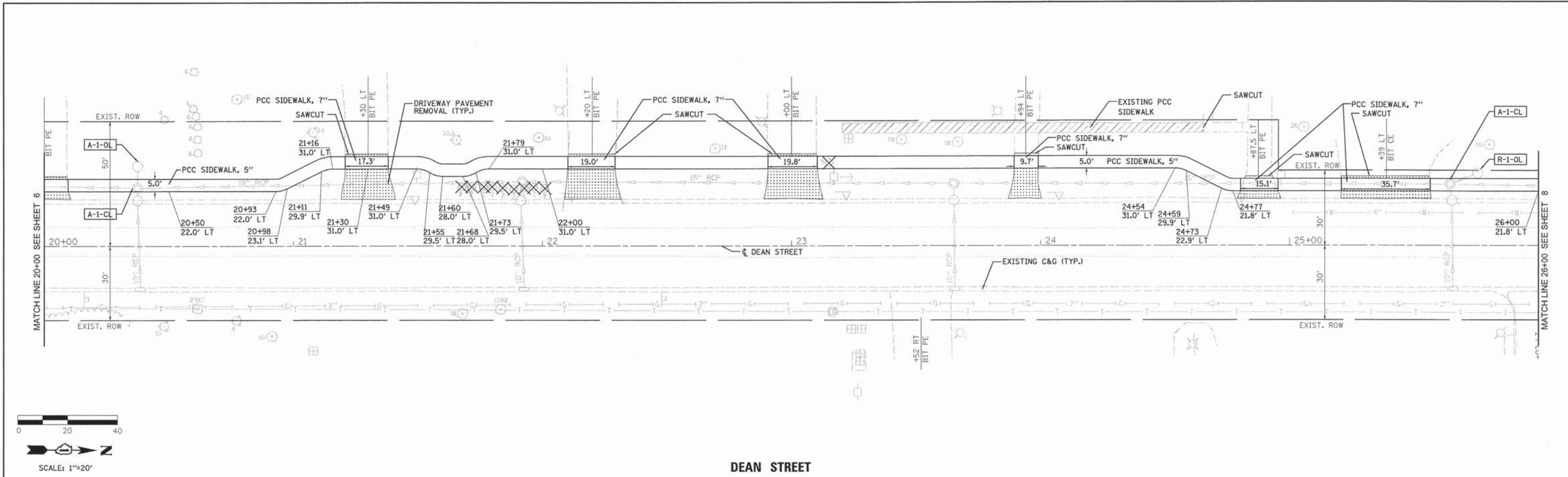

FILE NAME = P:\2012\120146\road\phase 2\dwg-East Side	USER NAME = #USER#	DESIGNED - NMP	REVISED -		WOODSTOCK SAFE ROUTES DEAN STREET PLAN AND PROFILE			<table border="1"> <tr> <th>F.A.U. RTE.</th> <th>SECTION</th> <th>COUNTY</th> <th>TOTAL SHEETS</th> <th>SHEET NO.</th> </tr> <tr> <td>0037</td> <td>12-00112-00-SW</td> <td>MCHENRY</td> <td>20</td> <td>7</td> </tr> </table>	F.A.U. RTE.	SECTION	COUNTY	TOTAL SHEETS	SHEET NO.	0037	12-00112-00-SW	MCHENRY	20	7
F.A.U. RTE.	SECTION	COUNTY	TOTAL SHEETS		SHEET NO.													
0037	12-00112-00-SW	MCHENRY	20		7													
	PLOT SCALE = #SCALE#	DRAWN - JMH	REVISED -		SCALE: 1" = 20'	SHEET 3 OF 4 SHEETS	STA. 20+00 TO STA. 26+00		CONTRACT NO. 61A15									
	PLOT DATE = 2/1/2014	CHECKED - CJM	REVISED -				ILLINOIS FED. AID PROJECT											
		DATE -	REVISED -															

PLAN
 SURVEYED BY: []
 ALIGNED BY: []
 CHECKED BY: []
 RT. OF WAY CHECKED BY: []
 NO. []
 FILE NAME []

PROFILE
 SURVEYED BY: []
 GRADES CHECKED BY: []
 NO. []
 FILE NAME []

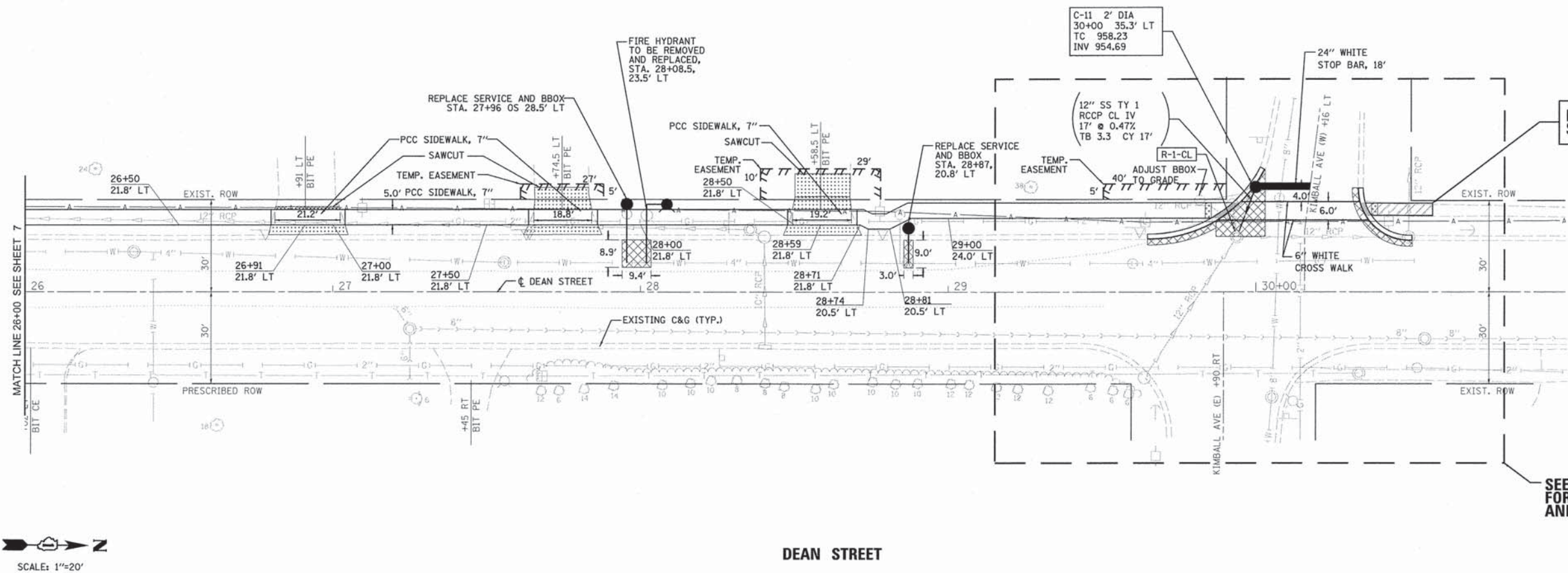

IMPROVEMENT ENDS
 STA. 30 + 62

SEE DETAIL 2, SHEET 10
 FOR INTERSECTION SIDEWALK
 AND CURB RETURN DETAILS

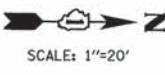

DEAN STREET

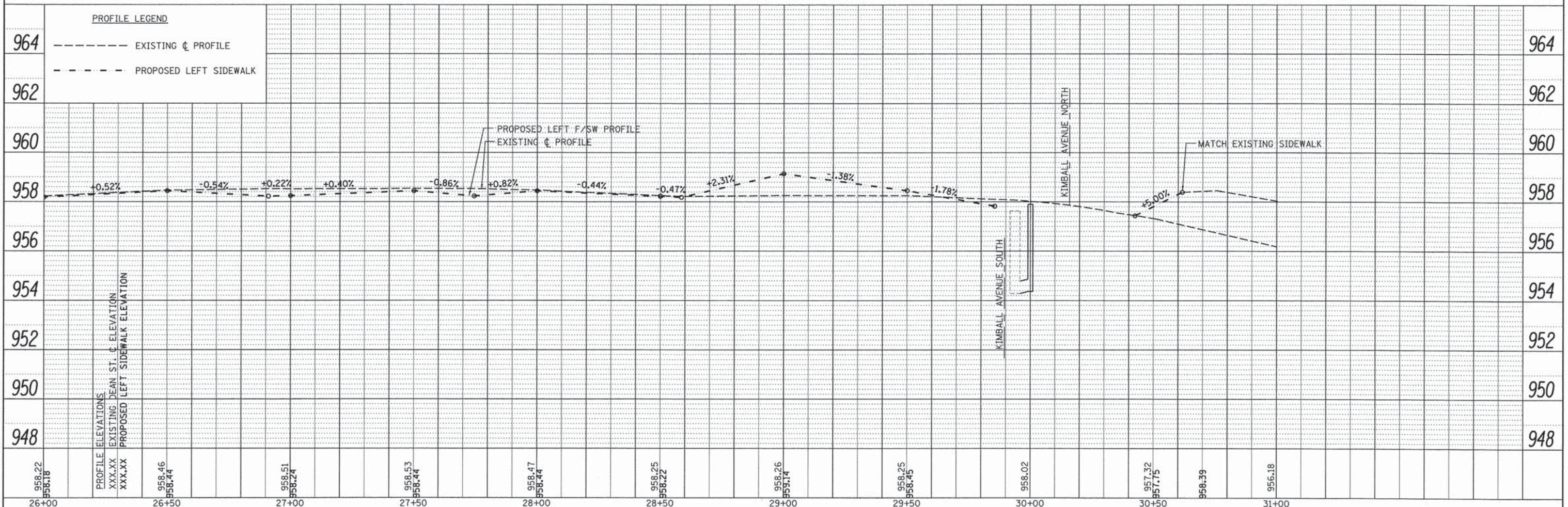

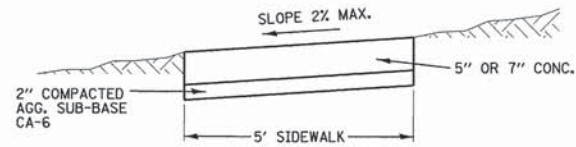

- NOTES:
1. CONCRETE SHALL BE IDOT CLASS S1.
 2. MINIMUM SIDEWALK THICKNESS SHALL BE 5".
 3. SIDEWALK THICKNESS ACROSS DRIVEWAYS SHALL BE MINIMUM 7" FOR RESIDENTIAL DRIVEWAYS.
 4. MAXIMUM LONGITUDINAL SLOPE SHALL NOT EXCEED 8%.
 5. MAXIMUM TRANSVERSE SLOPE SHALL BE (2%).
 6. A MINIMUM TWO (2) INCH AGGREGATE SUB-BASE (CA-6) SHALL BE PROVIDED.
 7. AGGREGATE SUB-BASE COURSE SHALL BE MECHANICALLY COMPACTED.
 8. ALL SIDEWALKS SHALL BE PROMPTLY BACKFILLED AND PROTECTED FROM DAMAGE.

SIDEWALK DETAIL

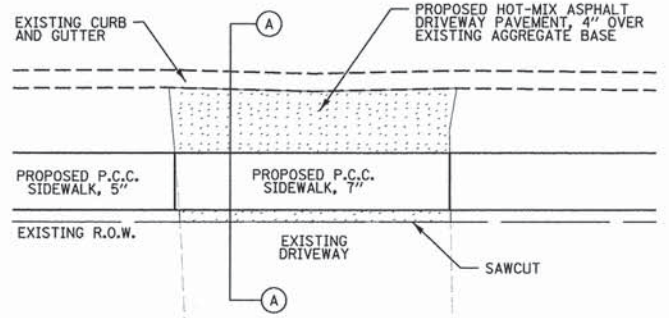

DRIVEWAY DETAIL

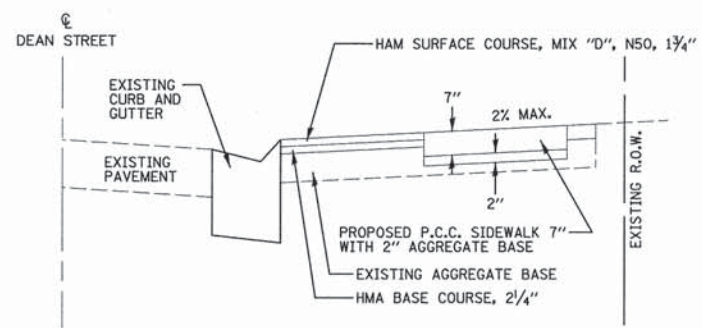

DRIVEWAY CROSS SECTION A - A

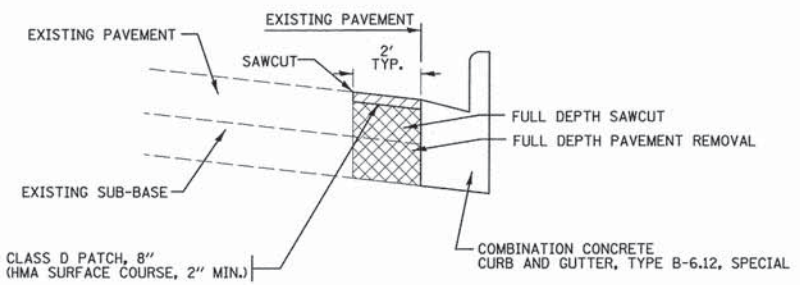

HMA REMOVAL DETAIL

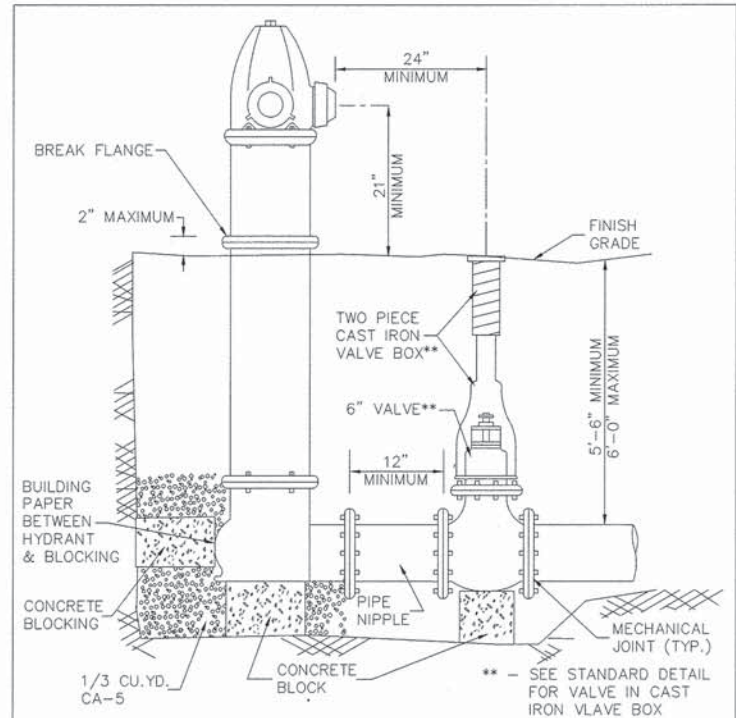

- REQUIRED HYDRANT FEATURES:
- 5-1/4" VALVE OPENING
 - 3-WAY HOSE CONNECTIONS
 - 2 X 2-1/2" NOZZLE
 - 1 X 4-1/2" PUMPER NOZZLE
 - ALL NOZZLES NST
 - 6" M.J. SHOE
 - 5'-6" BURY
- APPROVED FIRE HYDRANTS:
- MUELLER CENTURION A423
 - WATEROUS PACER
 - CLOW MEDALLION
- ** - SEE STANDARD DETAIL FOR VALVE IN CAST IRON VALVE BOX

STANDARD DETAIL FOR FIRE HYDRANT WITH AUXILIARY VALVE AND CAST IRON BOX	REVISIONS	CITY OF WOODSTOCK

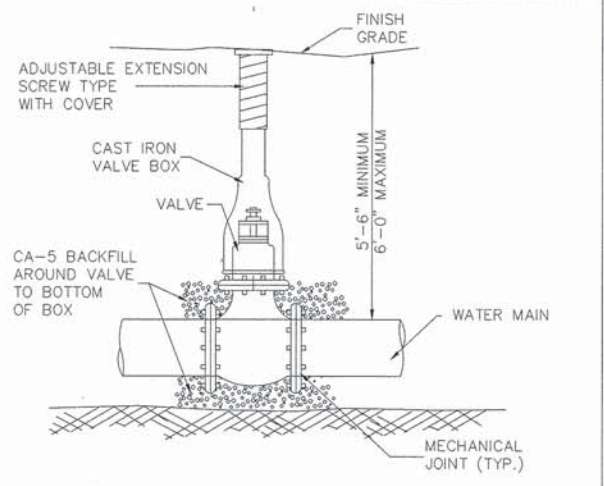

- APPROVED MATERIALS:
- VALVES:
- MUELLER MJ RESILIENT SEAT GATE VALVE, OL, SERIES 2360
 - WATEROUS MJ RESILIENT WEDGE GATE VALVE, OL, SERIES 2500
 - CLOW MJ RESILIENT WEDGE GATE VALVE, OL, 6100 SERIES
- VALVE BOXES:
- TYLER CAST IRON 664S

STANDARD DETAIL FOR VALVE IN CAST IRON VALVE BOX	REVISIONS	CITY OF WOODSTOCK

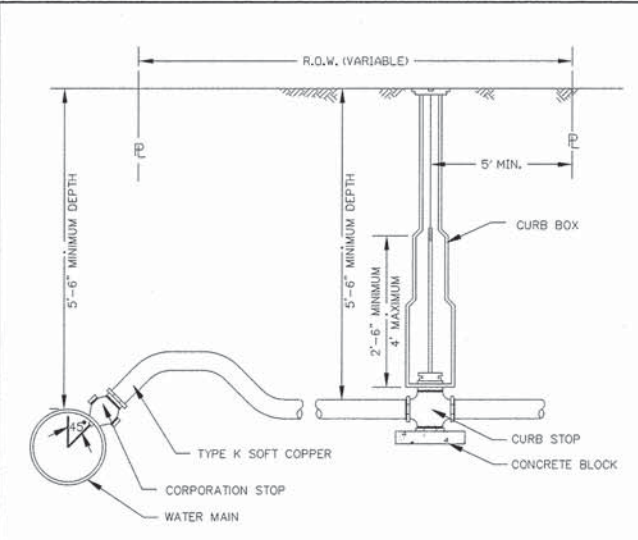





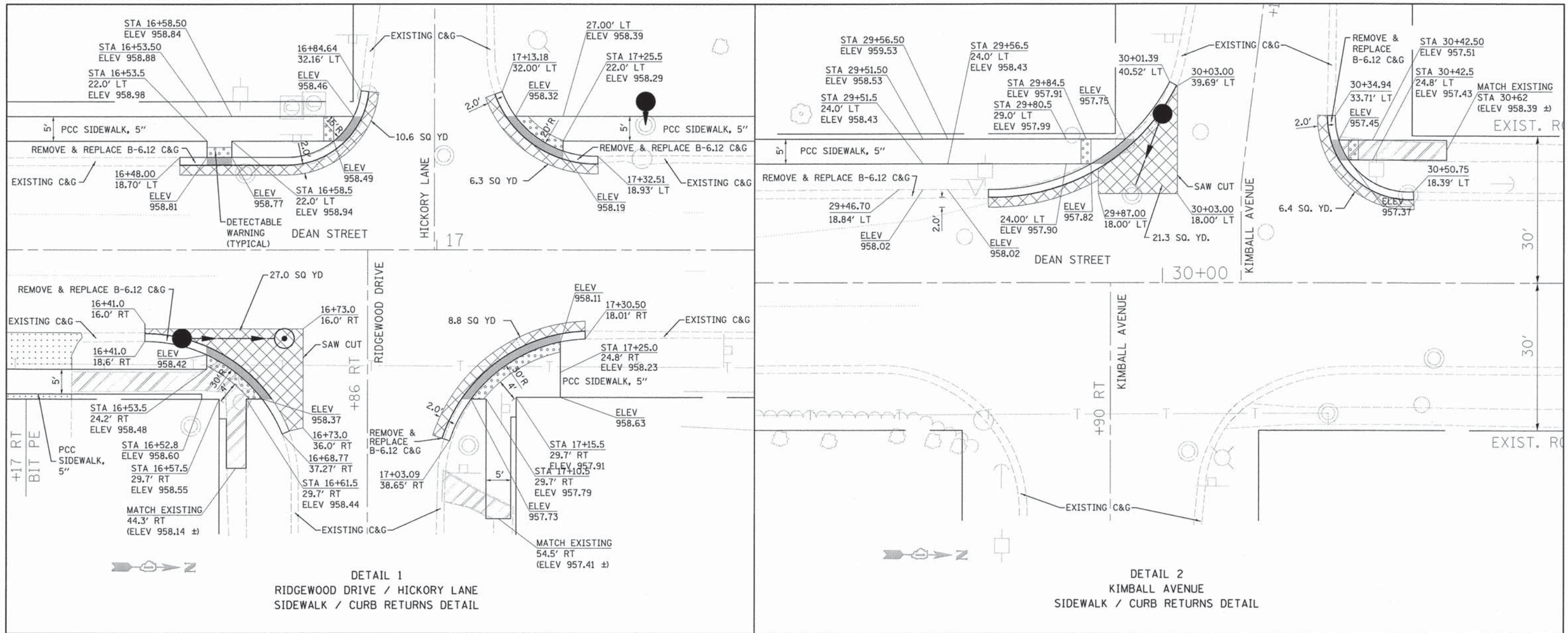

1. NO CORPORATION STOPS, COPPER SERVICE, OR CURB BOXES MAY BE LOCATED UNDER PAVED AREAS INCLUDING DRIVES AND SIDEWALKS.
2. ALL WATER MAIN HARDWARE SHALL BE MUELLER, A.Y. McDONALD OR FORD.
3. SERVICE TO BE CONTINUOUS WITHOUT JOINTS FROM CORPORATION STOP TO CURB STOP.
4. MULTIPLE TAPS INTO MAIN SHALL BE NO CLOSER THAN 2' APART.
5. TRENCH FROM MAIN TO BACK OF SIDEWALK TO BE COMPACTED TRENCH BACKFILL.

STANDARD DETAIL FOR WATERMAIN SERVICE LINE ASSEMBLY	REVISIONS	CITY OF WOODSTOCK



HATCH LEGEND

-  DEPRESSED CURB
-  CLASS D PATCH, 8"
-  CURB AND GUTTER REMOVAL
-  SIDEWALK REMOVAL
-  DETECTABLE WARNINGS
-  DRIVEWAY PAVEMENT REMOVAL AND DRIVEWAY PAVEMENT, 4"

FILE NAME =
 P:\2012\120146\road\phase 2\dwg-East Side

USER NAME = #USER#
 Eliminated\120146-sht-detail-02.dgn
 PLOT SCALE = #SCALE#
 PLOT DATE = 2/11/2014

DESIGNED - NMP
 DRAWN - JMH
 CHECKED - CJM
 DATE -

REVISED -
 REVISED -
 REVISED -
 REVISED -

STATE OF ILLINOIS
 DEPARTMENT OF TRANSPORTATION

WOODSTOCK SAFE ROUTES
 CROSSING DETAILS

SCALE: 1" = 10' SHEET OF SHEETS STA. TO STA.

F.A.U. RTE.	SECTION	COUNTY	TOTAL SHEETS	SHEET NO.
0037	12-00112-00-SW	MCHENRY	20	10
				CONTRACT NO. 61A15
ILLINOIS FED. AID PROJECT				

FINAL SURVEY	SURVEYED	BY	DATE
NOTE BOOK NO.	PLOTTED		
	TEMPLATE		
	AREAS CHECKED		

ORIGINAL SURVEY	SURVEYED	BY	DATE
NOTE BOOK NO.	PLOTTED		
	TEMPLATE		
	AREAS CHECKED		

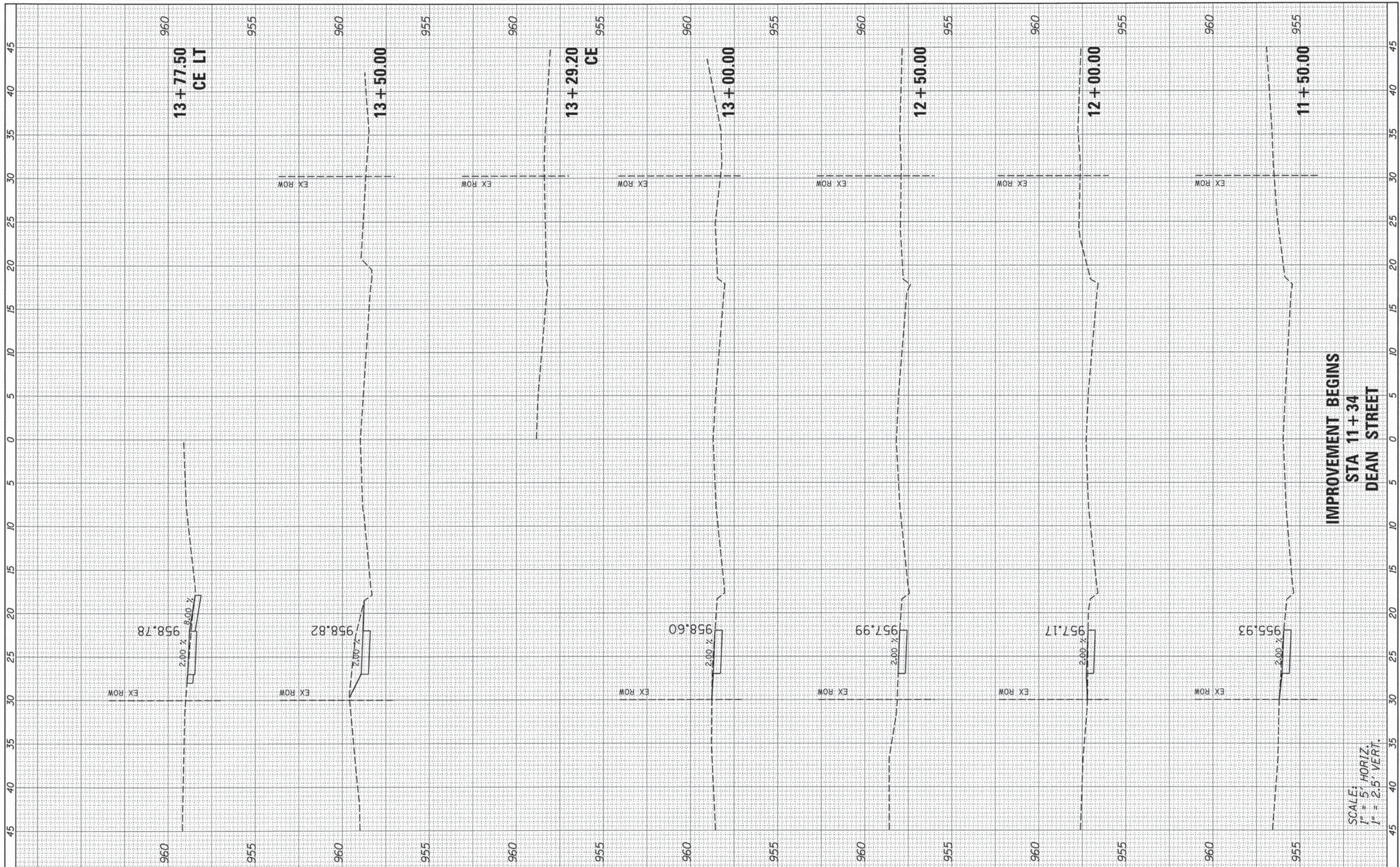

**IMPROVEMENT BEGINS
 STA 11+34
 DEAN STREET**

SCALE:
 1" = 5' HORIZ.
 1" = 2.5' VERT.

FILE NAME = P:\2012\120146\oad\phase 2\dwg\East Side Eliminated\120146-xsec-Dean.dgn

USER NAME = #USER#
 PLOT SCALE = #SCALE#
 PLOT DATE = 2/1/2014

DESIGNED - NMP
 DRAWN - NMP
 CHECKED - CJM
 DATE -

REVISED -
 REVISED -
 REVISED -
 REVISED -

**STATE OF ILLINOIS
 DEPARTMENT OF TRANSPORTATION**

**WOODSTOCK SAFE ROUTES
 CROSS SECTIONS**
 SCALE: SHEET 1 OF 8 SHEETS STA. 11+50.00 TO STA. 13+77.00

F.A.U. RTE.	SECTION	COUNTY	TOTAL SHEETS	SHEET NO.
0037	12-00112-00-SW	MCHENRY	20	11
CONTRACT NO. 61A15			ILLINOIS FED. AID PROJECT	

FINAL SURVEY NO.	SURVEYED	BY	DATE
NOTE BOOK	PLOTTED		
AREAS CHECKED	TEMPLATE		
	AREAS		
	CHECKED		

ORIGINAL SURVEY NO.	SURVEYED	BY	DATE
NOTE BOOK	PLOTTED		
AREAS CHECKED	TEMPLATE		
	AREAS		
	CHECKED		

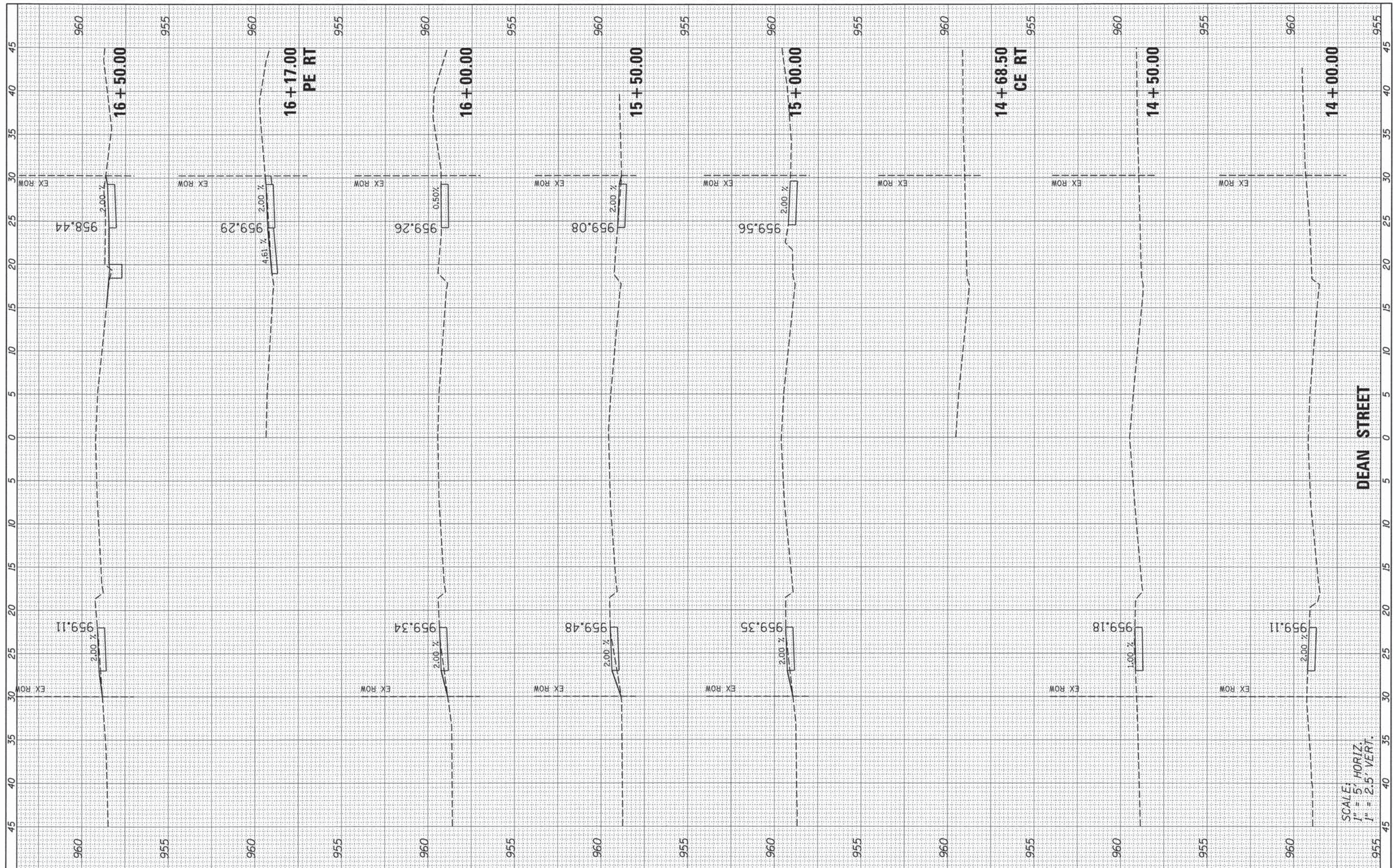

SCALE:
1" = 5' HORIZ.
1" = 2.5' VERT.

FILE NAME =
P:\2012\120146\cad\phase 2\dwg-East Side Elm...

USER NAME = #USER#
DRAWN - NMP
CHECKED - CJM
DATE -
PLOT SCALE = #SCALE#
PLOT DATE = 2/1/2014

DESIGNED - NMP
DRAWN - NMP
CHECKED - CJM
DATE -

REVISED -
REVISED -
REVISED -
REVISED -

STATE OF ILLINOIS
DEPARTMENT OF TRANSPORTATION

WOODSTOCK SAFE ROUTES
CROSS SECTIONS
SCALE: SHEET 2 OF 8 SHEETS STA. 14+00.00 TO STA. 16+50.00

F.A.U. RTE.	SECTION	COUNTY	TOTAL SHEETS	SHEET NO.
0037	12-00112-00-SW	MCHENRY	20	12
CONTRACT NO. 61A15			ILLINOIS FED. AID PROJECT	

FINAL SURVEY NO.	SURVEYED	DATE
NOTE BOOK	PLOTTED	
AREAS CHECKED	TEMPLATE	
	AREAS	
	CHECKED	

ORIGINAL SURVEY NO.	SURVEYED	DATE
NOTE BOOK	PLOTTED	
AREAS CHECKED	TEMPLATE	
	AREAS	
	CHECKED	

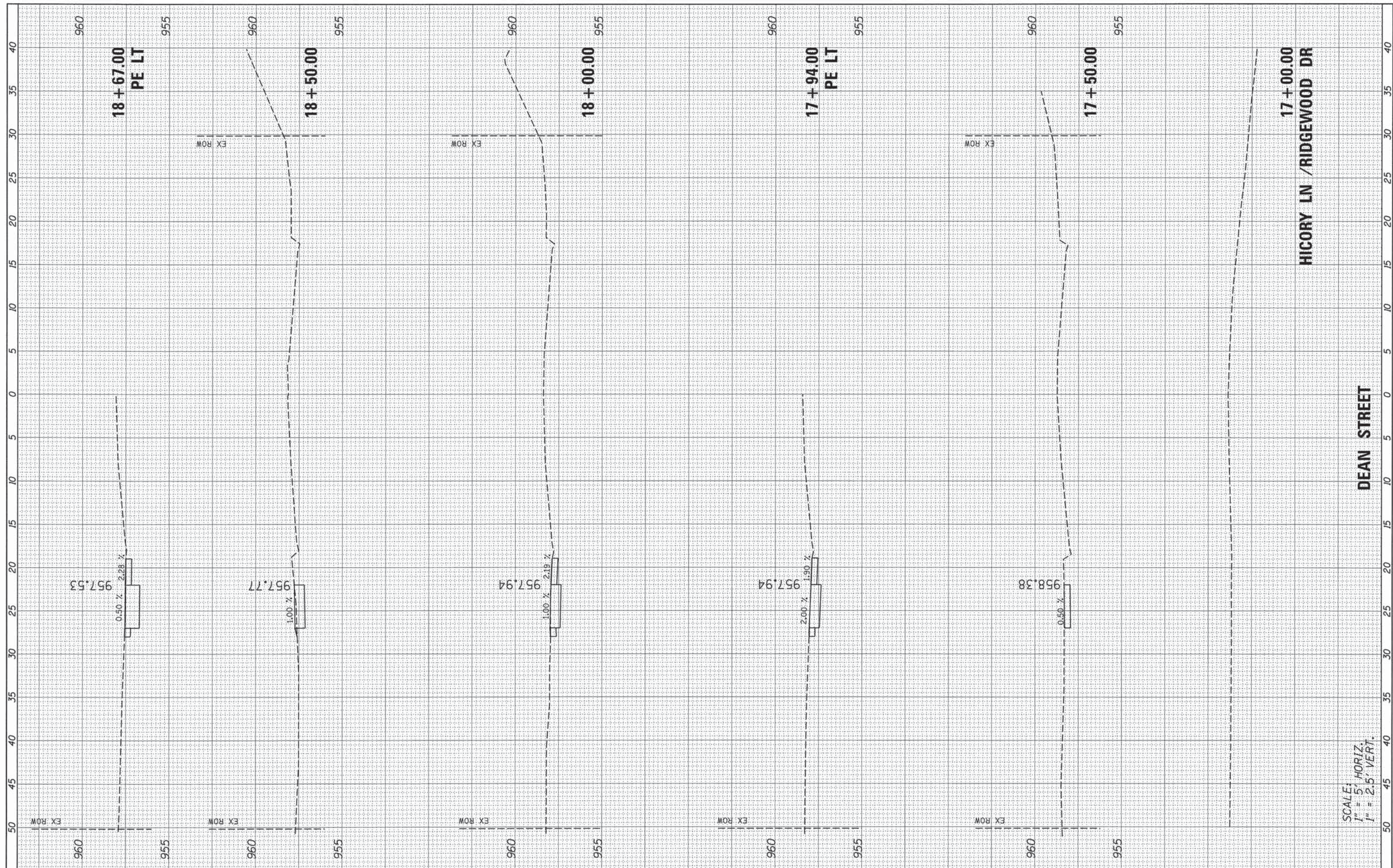

FILE NAME = P:\2012\120145\cad\phase 2\dwg-East Side Eliminated\120146-xsec-Dean.dgn

USER NAME = #USER#
 DESIGNED - NMP
 DRAWN - NMP
 CHECKED - CJM
 DATE -
 PLOT SCALE = #SCALE#
 PLOT DATE = 2/1/2014

DESIGNED - NMP
 DRAWN - NMP
 CHECKED - CJM
 DATE -

REVISED -
 REVISED -
 REVISED -
 REVISED -

**STATE OF ILLINOIS
 DEPARTMENT OF TRANSPORTATION**

**WOODSTOCK SAFE ROUTES
 CROSS SECTIONS**
 SCALE: SHEET 3 OF 8 SHEETS STA. 16+87.00 TO STA. 18+67.00

F.A.U. RTE. 0037	SECTION 12-00112-00-SW	COUNTY MCHENRY	TOTAL SHEETS 20	SHEET NO. 13
CONTRACT NO. 61A15			ILLINOIS FED. AID PROJECT	

SCALE:
 1" = 5' HORIZ.
 1" = 2.5' VERT.

FINAL SURVEY	SURVEYED	DATE
NOTE BOOK	BY	
NO.		
	SURVEYED	
	BY	
	DATE	

ORIGINAL SURVEY	SURVEYED	DATE
NOTE BOOK	BY	
NO.		
	SURVEYED	
	BY	
	DATE	

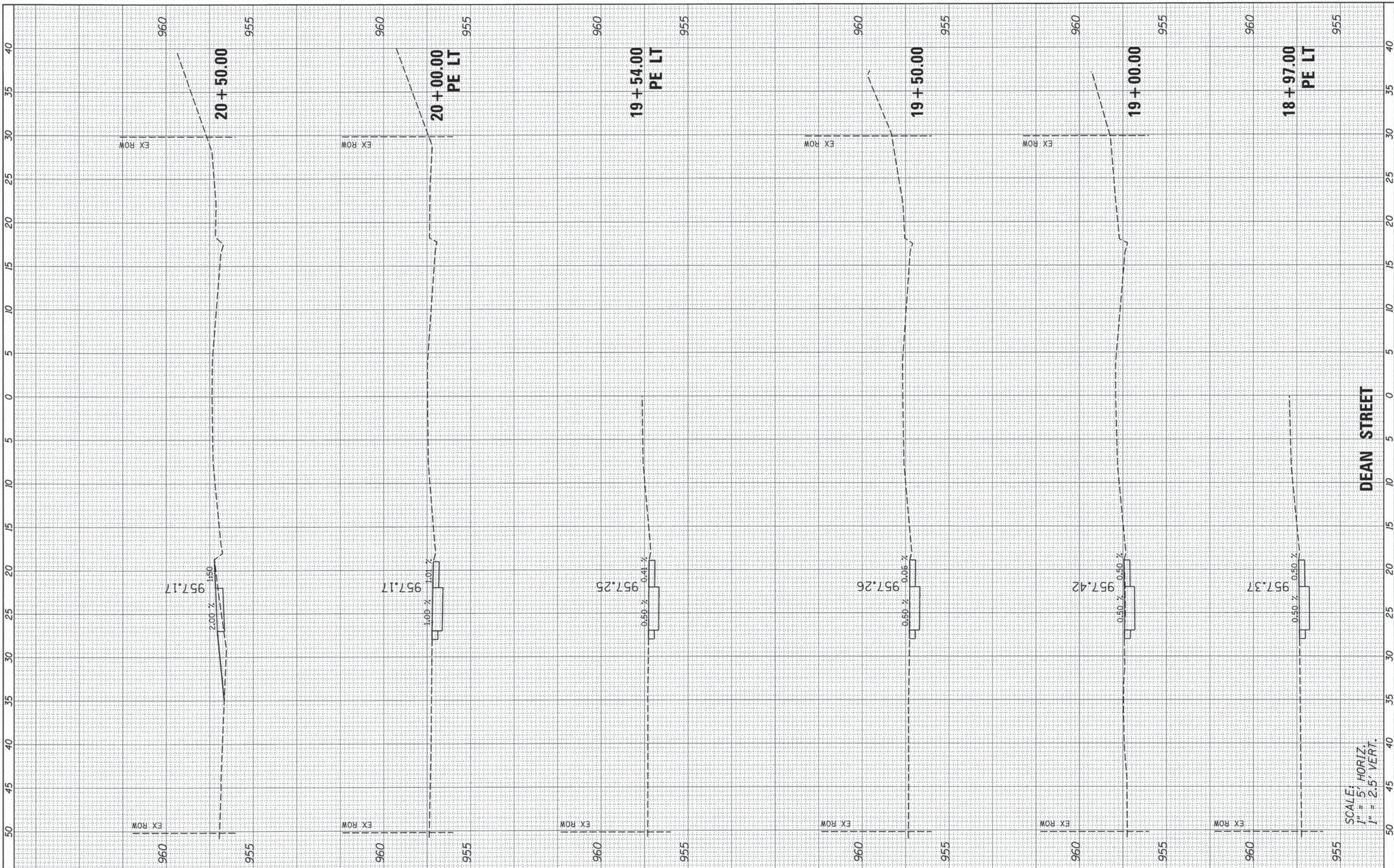

SCALE:
 1" = 5' HORIZ
 1" = 2.5' VERT.

DEAN STREET

FILE NAME =
 P:\2012\120146\cod\phase 2\dwg-East Side Eliminated\120146-xsec-Dean.dgn

USER NAME = #USER#
 DRAWN - NMP
 CHECKED - CJM
 DATE - 2/1/2014

DESIGNED - NMP
 DRAWN - NMP
 CHECKED - CJM
 DATE -

REVISED -
 REVISED -
 REVISED -
 REVISED -

STATE OF ILLINOIS
 DEPARTMENT OF TRANSPORTATION

WOODSTOCK SAFE ROUTES
 CROSS SECTIONS

SCALE: SHEET 4 OF 8 SHEETS STA. 18+83.20 TO STA. 20+50.00

F.A.U. RTE.	SECTION	COUNTY	TOTAL SHEETS	SHEET NO.
0037	12-00112-00-SW	MCHENRY	20	14
CONTRACT NO. 61A15				
ILLINOIS FED. AID PROJECT				

FINAL SURVEY	SURVEYED	DATE
NOTE BOOK	PLOTTED	BY
NO.	TEMPLATE	
	AREAS CHECKED	

ORIGINAL SURVEY	SURVEYED	DATE
NOTE BOOK	PLOTTED	BY
NO.	TEMPLATE	
	AREAS CHECKED	



SCALE:
1" = 5' HORIZ.
1" = 2.5' VERT.

FILE NAME =
P:\2012\120146\cad\phase 2\dwg-East Side Eliminated\120146-xsec-Dean.dgn

USER NAME = #USER#
PLOT SCALE = #SCALE#
PLOT DATE 2/1/2014

DESIGNED - NMP
DRAWN - NMP
CHECKED - CJM
DATE -

REVISED -
REVISED -
REVISED -
REVISED -

STATE OF ILLINOIS
DEPARTMENT OF TRANSPORTATION

WOODSTOCK SAFE ROUTES
CROSS SECTIONS

SCALE: SHEET 5 OF 8 SHEETS STA. 21+00.00 TO STA. 22+50.00

F.A.U. RTE.	SECTION	COUNTY	TOTAL SHEETS	SHEET NO.
0037	12-00112-00-SW	MCHENRY	20	15
CONTRACT NO. 61A15			ILLINOIS FED. AID PROJECT	

FINAL SURVEY NO.	SURVEYED	DATE
NOTE BOOK	PLOTTED	
AREAS CHECKED	TEMPLATE	
	AREAS CHECKED	

ORIGINAL SURVEY NO.	SURVEYED	DATE
NOTE BOOK	PLOTTED	
AREAS CHECKED	TEMPLATE	
	AREAS CHECKED	

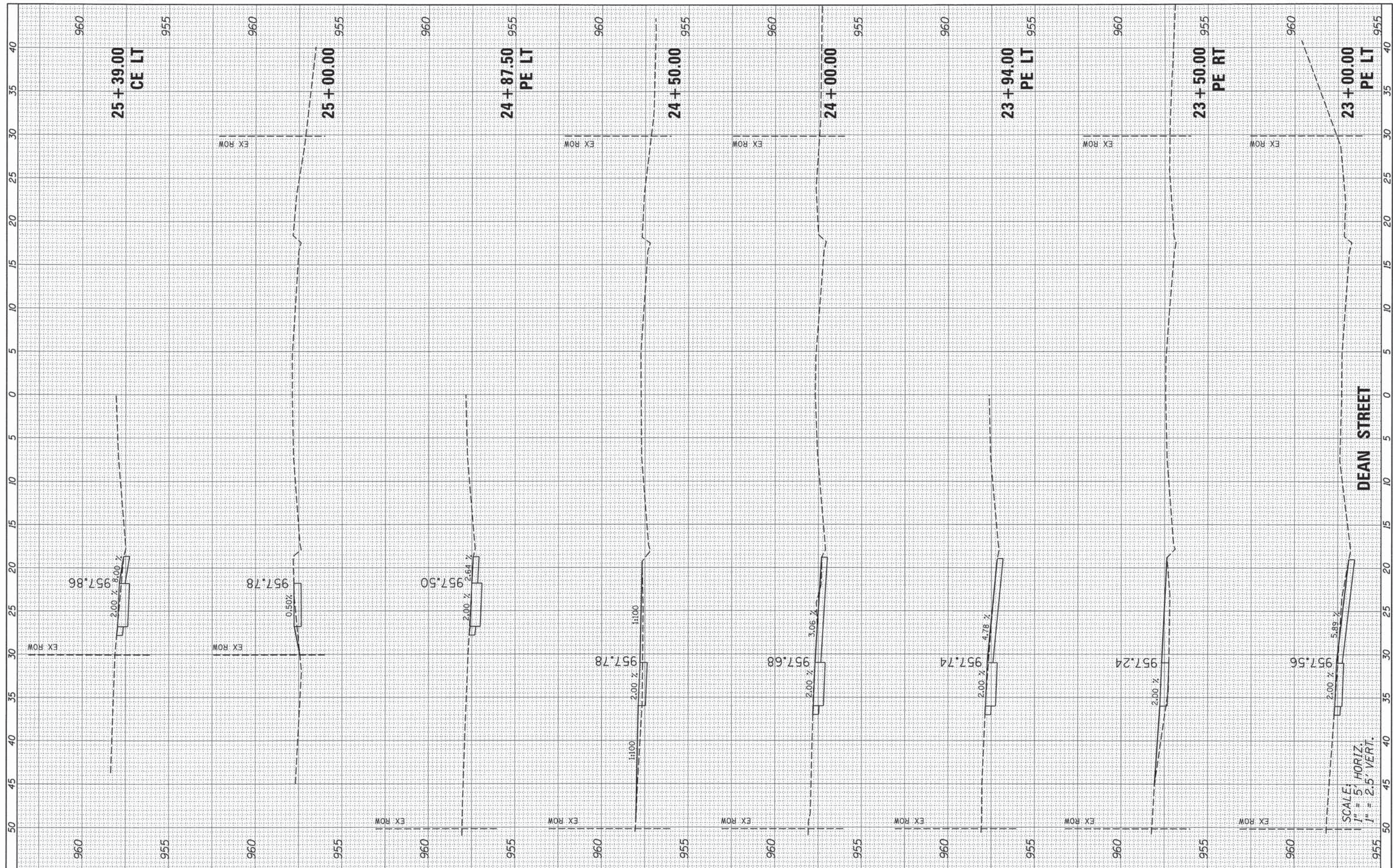

FILE NAME = P:\2012\120146\cad\phase 2\dwg-East Side Elm...

USER NAME = #USER#
 PLOT SCALE = #SCALE#
 PLOT DATE = 2/1/2014

DESIGNED - NMP
 DRAWN - NMP
 CHECKED - CJM
 DATE -

REVISED -
 REVISED -
 REVISED -
 REVISED -

STATE OF ILLINOIS
 DEPARTMENT OF TRANSPORTATION

WOODSTOCK SAFE ROUTES
 CROSS SECTIONS
 SCALE: SHEET 6 OF 8 SHEETS STA. 23+00.00 TO STA. 25+39.00

F.A.U. RTE.	SECTION	COUNTY	TOTAL SHEETS	SHEET NO.
0037	12-00112-00-SW	MCHENRY	20	16
CONTRACT NO. 61A15			ILLINOIS FED. AID PROJECT	

FINAL SURVEY	SURVEYED	DATE
NOTE BOOK	PLOTTED	BY
NO.	TEMPLATE	
	AREAS	
	CHECKED	

ORIGINAL SURVEY	SURVEYED	DATE
NOTE BOOK	PLOTTED	BY
NO.	TEMPLATE	
	AREAS	
	CHECKED	

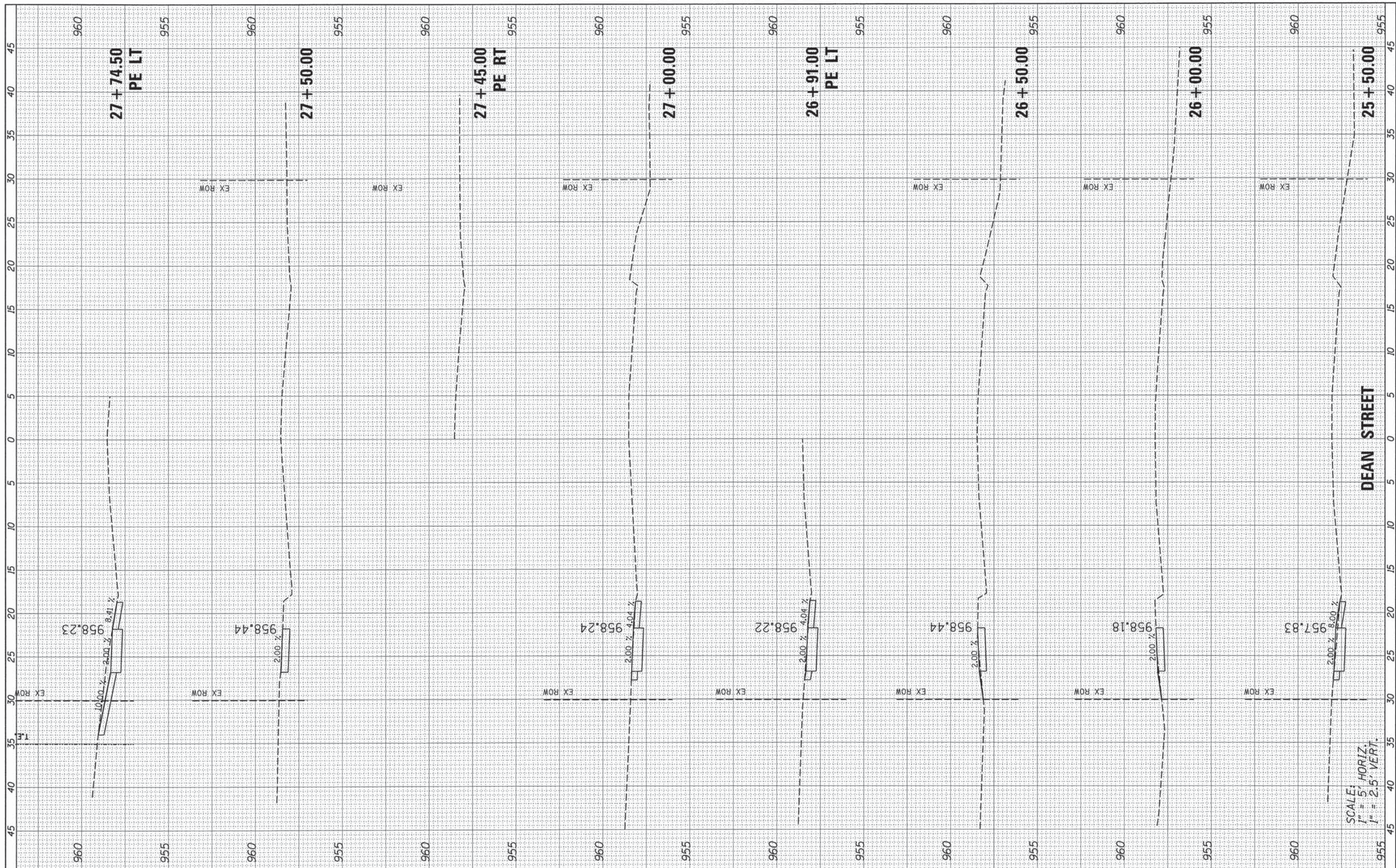

SCALE:
 1" = 5' HORIZ.
 1" = 2.5' VERT.

FILE NAME =
 P:\2012\120146\ood\phase 2\dwg-East Side Eliminated\120146-xsec-Dean.dgn

USER NAME = #USER#
 PLOT SCALE = #SCALE#
 PLOT DATE = 2/1/2014

DESIGNED - NMP
 DRAWN - NMP
 CHECKED - CJM
 DATE -

REVISED -
 REVISED -
 REVISED -
 REVISED -

**STATE OF ILLINOIS
 DEPARTMENT OF TRANSPORTATION**

**WOODSTOCK SAFE ROUTES
 CROSS SECTIONS**
 SCALE: SHEET 7 OF 8 SHEETS STA. 25+50.00 TO STA. 27+74.50

F.A.U. RTE.	SECTION	COUNTY	TOTAL SHEETS	SHEET NO.
0037	12-00112-00-SW	MCHENRY	20	17
CONTRACT NO. 61A15				
ILLINOIS FED. AID PROJECT				

FINAL SURVEY	SURVEYED
NOTE BOOK NO.	PLOTTED
	DATE
	AREAS CHECKED

ORIGINAL SURVEY	SURVEYED
NOTE BOOK NO.	PLOTTED
	DATE
	AREAS CHECKED

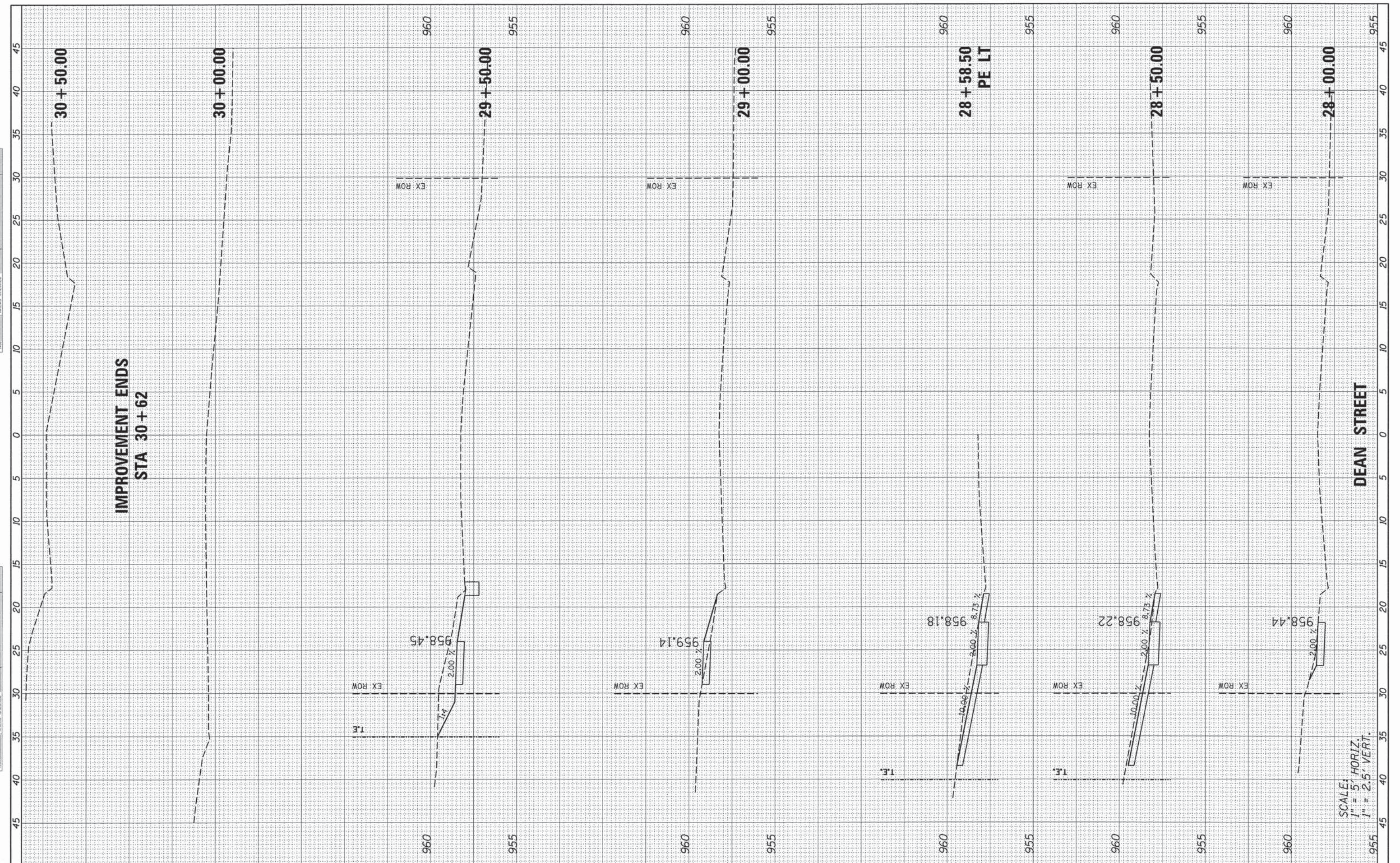

SCALE:
 1" = 5' HORIZ.
 1" = 2.5' VERT.

FILE NAME = P:\2012\120146\cad\phase 2\dwg-East Side Eliminated\120146-xsec-Dean.dgn

USER NAME = #USER#
 PLOT SCALE = #SCALE#
 PLOT DATE = 2/11/2014

DESIGNED - NMP
 DRAWN - NMP
 CHECKED - CJM
 DATE -

REVISED -
 REVISED -
 REVISED -
 REVISED -

STATE OF ILLINOIS
 DEPARTMENT OF TRANSPORTATION

WOODSTOCK SAFE ROUTES
 CROSS SECTIONS

SCALE: SHEET 8 OF 8 SHEETS STA. 28+00.00 TO STA. 30+50.00

F.A.U. RTE. 0037	SECTION 12-00112-00-SW	COUNTY MCHENRY	TOTAL SHEETS 20	SHEET NO. 18
CONTRACT NO. 61A15			ILLINOIS FED. AID PROJECT	

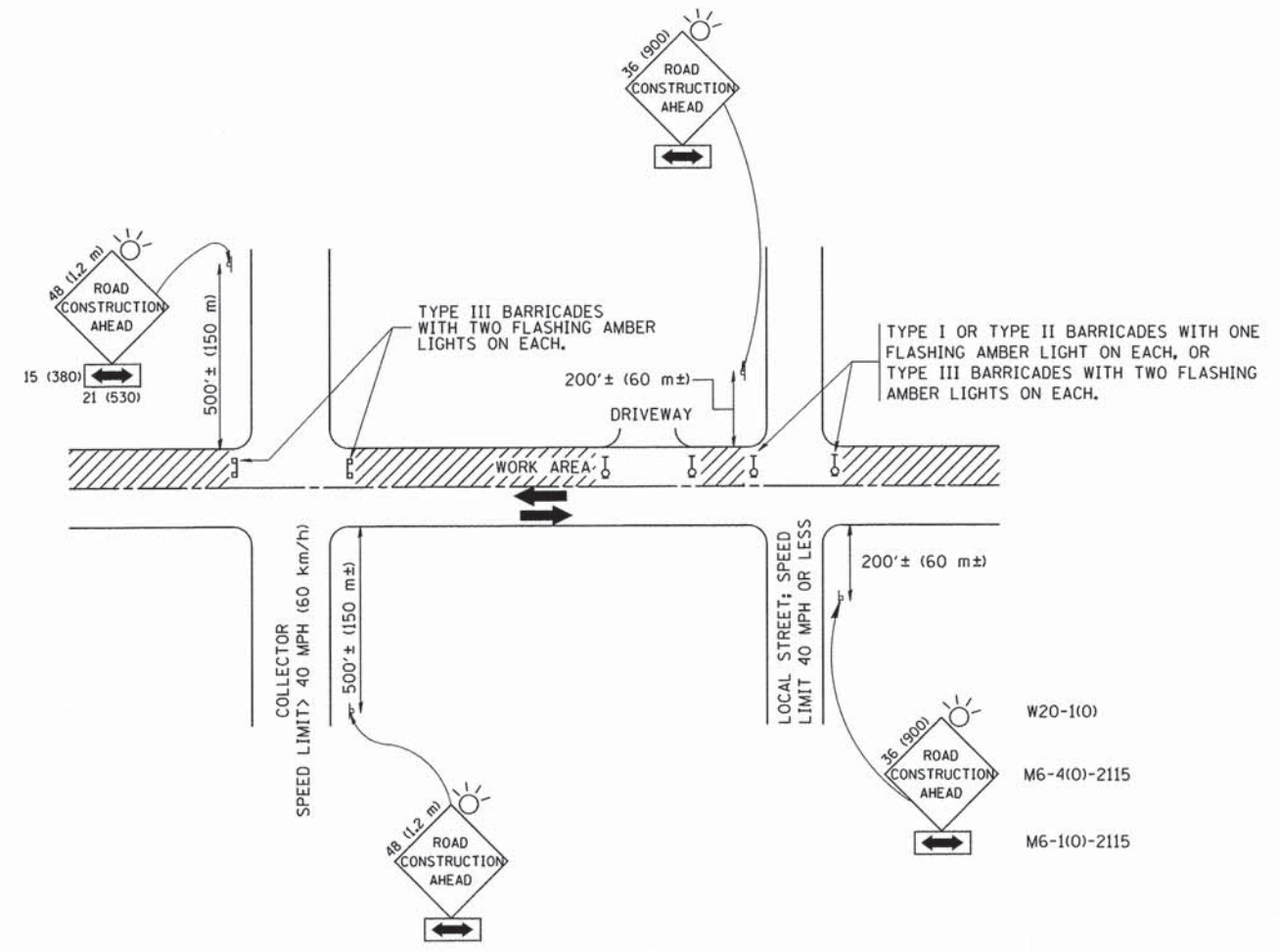

TRAFFIC CONTROL AND PROTECTION FOR SIDE ROADS, INTERSECTIONS, AND DRIVEWAYS

NOTES:

- A. FOR NO LANE RESTRICTION ON THE SIDE ROAD OR DRIVEWAYS**
- SIDE ROAD WITH A SPEED LIMIT OF 40 MPH (60 km/h) OR LESS AS SHOWN ON THE DRAWING AND AS DIRECTED BY THE ENGINEER:
 - ONE ROAD CONSTRUCTION AHEAD SIGN 36 x 36 (900x900) WITH A FLASHER AND FLAG MOUNTED ON IT APPROXIMATELY 200' (60 m) IN ADVANCE OF THE MAIN ROUTE.
 - THE CLOSED PORTION OF THE MAIN ROUTE SHALL BE PROTECTED BY BLOCKING WITH TYPE I, TYPE II OR TYPE III BARRICADES, 1/3 OF THE CROSS SECTION OF THE CLOSED PORTION.
 - SIDE ROAD WITH A SPEED LIMIT GREATER THAN 40 MPH (60 km/h) AS SHOWN ON THE DRAWING AND AS DIRECTED BY THE ENGINEER:
 - ONE ROAD CONSTRUCTION AHEAD SIGN 48 x 48 (1.2 m x 1.2 m) WITH A FLASHER MOUNTED ON IT APPROXIMATELY 500' (150 m) IN ADVANCE OF THE MAIN ROUTE.
 - THE CLOSED PORTION OF THE MAIN ROUTE SHALL BE PROTECTED BY BLOCKING WITH TYPE III BARRICADES, 1/2 OF THE CROSS SECTION OF THE CLOSED PORTION.
 - WHEN THE SIDE ROAD LIES BETWEEN THE BEGINNING OF THE MAINLINE SIGNING AND THE WORK ZONE, A SINGLE HEADED ARROW (M6-1) SHALL BE USED IN LIEU OF THE DOUBLE HEADED ARROW (M6-4).
- B. FOR A LANE CLOSURE ON A SIDE ROAD OR DRIVEWAY:**
- USE APPLICABLE PORTIONS OF THE TYPICAL APPLICATION OF TRAFFIC CONTROL DEVICES (STD. 701501, STD. 701606 OR THE APPROPRIATE STANDARD). THE SPACING OF SIGNS AND BARRICADES SHALL BE ADJUSTED FOR FIELD CONDITIONS AS DIRECTED BY THE ENGINEER. THE DIRECTIONAL ARROW SHALL BE COVERED OR REMOVED WHEN NO LONGER CONSISTENT WITH THE SIDE ROAD LANE CLOSURE.
- C. ADVANCE WARNING SIGNS ARE TO BE OMITTED ON DRIVEWAY UNLESS OTHERWISE NOTED.**
- D. THE TRAFFIC CONTROL AND PROTECTION FOR SIDE ROADS, INTERSECTIONS, AND DRIVEWAYS SHALL BE INCIDENTAL TO THE COST OF SPECIFIED TRAFFIC CONTROL STANDARDS OR ITEMS.**

All dimensions are in millimeters (inches) unless otherwise shown.

FILE NAME =	USER NAME = geglanoht	DESIGNED - LHA	REVISED - J. OBERLE 10-18-95
W:\diststd\22x34\trcl8.dgn		DRAWN -	REVISED - A. HOUSEH 03-06-96
		CHECKED -	REVISED - A. HOUSEH 10-15-96
		DATE - 06-89	REVISED - T. RAMMACHER 01-06-00

STATE OF ILLINOIS
DEPARTMENT OF TRANSPORTATION

TRAFFIC CONTROL AND PROTECTION FOR SIDE ROADS, INTERSECTIONS, AND DRIVEWAYS			
SCALE: NONE	SHEET NO. 1 OF 1 SHEETS	STA.	TO STA.

F.A.U. RTE.	SECTION	COUNTY	TOTAL SHEETS	SHEET NO.
0037	12-00112-00-SW	MCHEMRY	20	19
TC-10			CONTRACT NO. 61A15	
FED. ROAD DIST. NO. 1 (ILLINOIS) FED. AID PROJECT				

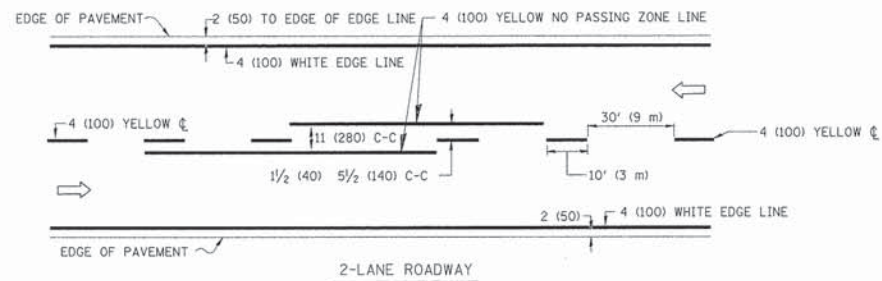

2-LANE ROADWAY

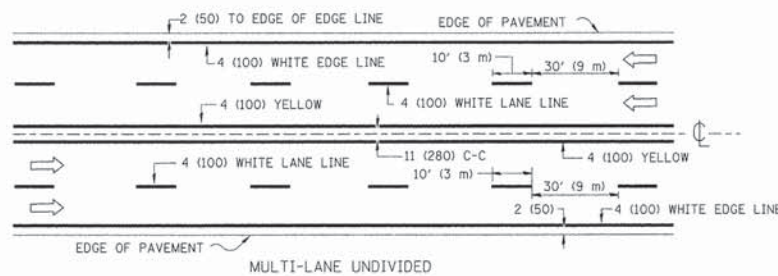

MULTI-LANE UNDIVIDED

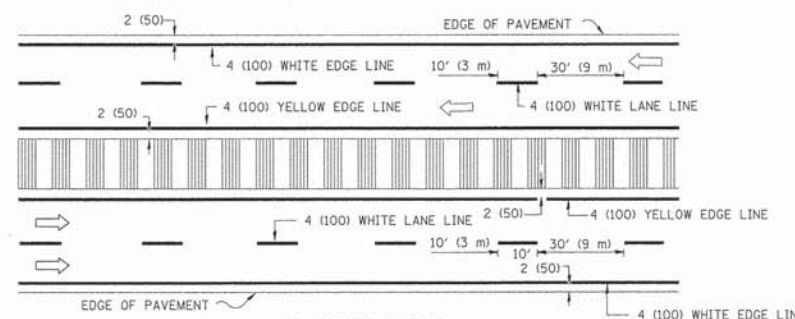

MULTI-LANE DIVIDED WITH MOUNTABLE MEDIAN

NOTE: MEDIANS WITH BARRIER CURB DO NOT REQUIRE AN EDGE LINE

TYPICAL LANE AND EDGE LINE MARKING

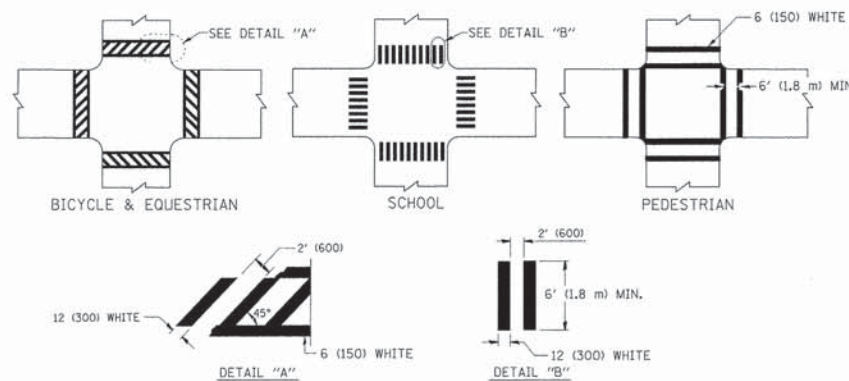

TYPICAL CROSSWALK MARKING

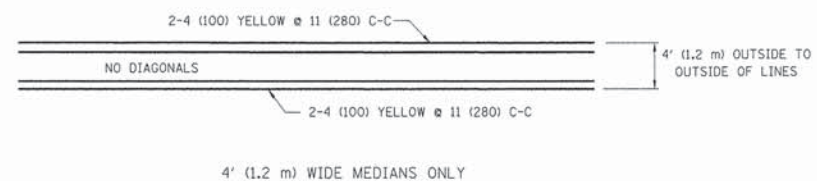

4' (1.2 m) WIDE MEDIANS ONLY

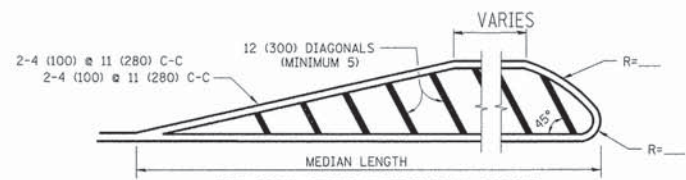

MEDIANS OVER 4' (1.2 m) WIDE

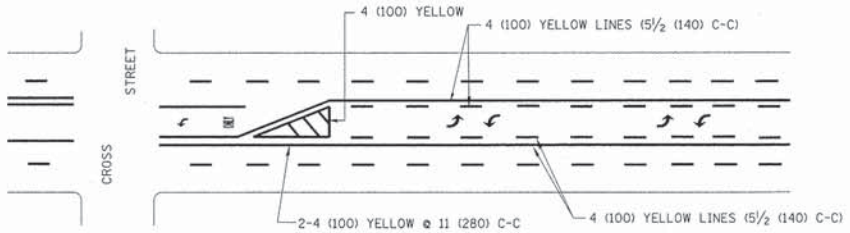

TYPICAL PAINTED MEDIAN MARKING

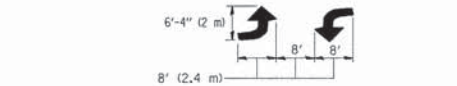

MEDIAN WITH TWO-WAY LEFT TURN LANE

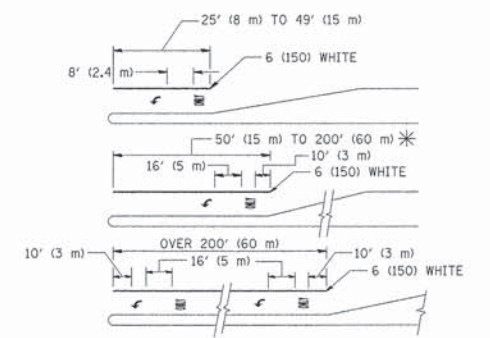

TYPICAL LEFT (OR RIGHT) TURN LANE

FULL SIZE LETTERS 8' (2.4 m) AND ARROWS SHALL BE USED.
 * TURN LANES IN EXCESS OF 400' (120 m) IN LENGTH MAY HAVE AN ADDITIONAL SET OF ARROW - "ONLY" INSTALLED MIDWAY BETWEEN THE OTHER TWO SETS OF ARROW - "ONLY".

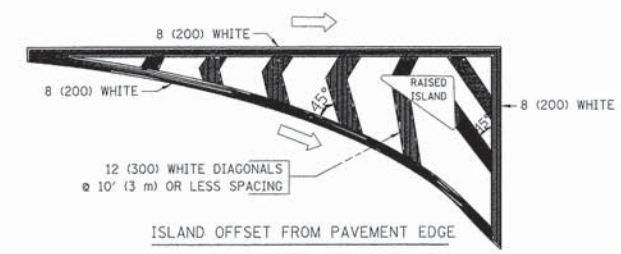

ISLAND OFFSET FROM PAVEMENT EDGE

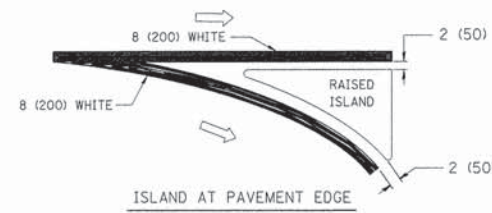

ISLAND AT PAVEMENT EDGE

TYPICAL ISLAND MARKING

TYPE OF MARKING	WIDTH OF LINE	PATTERN	COLOR	SPACING / REMARKS
CENTERLINE ON 2 LANE PAVEMENT	4 (100)	SKIP-DASH	YELLOW	10' (3 m) LINE WITH 30' (9 m) SPACE
CENTERLINE ON MULTI-LANE UNDIVIDED PAVEMENT	2 @ 4 (100)	SOLID	YELLOW	11 (280) C-C
NO PASSING ZONE LINES FOR ONE DIRECTION FOR BOTH DIRECTIONS	4 (100) 2 @ 4 (100)	SOLID SOLID	YELLOW YELLOW	5 1/2 (140) C-C FROM SKIP-DASH CENTERLINE 11 (280) C-C OMIT SKIP-DASH CENTERLINE BETWEEN
LANE LINES	4 (100) 5 (125) ON FREEWAYS	SKIP-DASH SKIP-DASH	WHITE WHITE	10' (3 m) LINE WITH 30' (9 m) SPACE
DOTTED LINES (EXTENSIONS OF CENTER, LANE OR TURN LANE MARKINGS)	SAME AS LINE BEING EXTENDED	SKIP-DASH	SAME AS LINE BEING EXTENDED	2' (600) LINE WITH 6' (1.8 m) SPACE
EDGE LINES	4 (100)	SOLID	YELLOW-LEFT WHITE-RIGHT	OUTLINE MOUNTABLE MEDIANS IN YELLOW; EDGE LINES ARE NOT USED NEXT TO BARRIER CURB
TURN LANE MARKINGS	6 (150) LINE; FULL SIZE LETTERS & SYMBOLS (8' (2.4m))	SOLID	WHITE	SEE TYPICAL TURN LANE MARKING DETAIL
TWO WAY LEFT TURN MARKING	2 @ 4 (100) EACH DIRECTION 8' (2.4m) LEFT ARROW	SKIP-DASH AND SOLID IN PAIRS	YELLOW WHITE	10' (3 m) LINE WITH 30' (9 m) SPACE FOR SKIP-DASH; 5 1/2 (140) C-C BETWEEN SOLID LINE AND SKIP-DASH LINE SEE TYPICAL TWO-WAY LEFT TURN MARKING DETAIL
CROSSWALK LINES (PEDESTRIAN) A. DIAGONALS (BIKE & EQUESTRIAN) B. LONGITUDINAL BARS (SCHOOL)	2 @ 6 (150) 12 (300) @ 45° 12 (300) @ 90°	SOLID SOLID SOLID	WHITE WHITE WHITE	NOT LESS THAN 6' (1.8 m) APART 2' (600) APART 2' (600) APART SEE TYPICAL CROSSWALK MARKING DETAILS.
STOP LINES	24 (600)	SOLID	WHITE	PLACE 4' (1.2 m) IN ADVANCE OF AND PARALLEL TO CROSSWALK, IF PRESENT. OTHERWISE, PLACE AT DESIRED STOPPING POINT. PARALLEL TO CROSSROAD CENTERLINE, WHERE POSSIBLE.
PAINTED MEDIANS	2 @ 4 (100) WITH 12 (300) DIAGONALS @ 45° NO DIAGONALS USED FOR 4' (1.2 m) WIDE MEDIANS	SOLID	YELLOW; TWO WAY TRAFFIC WHITE; ONE WAY TRAFFIC	11 (280) C-C FOR THE DOUBLE LINE SEE TYPICAL PAINTED MEDIAN MARKING.
GORE MARKING AND CHANNELIZING LINES	8 (200) WITH 12 (300) DIAGONALS @ 45°	SOLID	WHITE	DIAGONALS: 15' (4.5 m) C-C (LESS THAN 30MPH (50 km/h)) 20' (6 m) C-C 30MPH (50 km/h) TO 45MPH (70 km/h) 30' (9 m) C-C (OVER 45MPH (70 km/h))
RAILROAD CROSSING	24 (600) TRANSVERSE LINES; "RR" IS 6' (1.8 m) LETTERS; 16 (400) LINE FOR "X"	SOLID	WHITE	SEE STATE STANDARD 780001 AREA OF: "R"=3.6 SQ. FT. (0.33 m ²) EACH "X"=54.0 SQ. FT. (5.0 m ²)
SHOULDER DIAGONALS	12 (300) @ 45°	SOLID	WHITE - RIGHT YELLOW - LEFT	50' (15 m) C-C (LESS THAN 30MPH (50 km/h)) 75' (25 m) C-C (30 MPH (50 km/h) TO 45MPH (70 km/h)) 150' (45 m) C-C (OVER 45MPH (70 km/h))

FOR FURTHER DETAILS ON PAVEMENT MARKING REFER TO STANDARD SPECIFICATIONS FOR ROAD AND BRIDGE CONSTRUCTION AND STATE STANDARD 780001.

All dimensions are in inches (millimeters) unless otherwise shown.

FILE NAME =	USER NAME = drivakosgn	DESIGNED - EVERS	REVISED -T. RAMMACHER 10-27-94
ca:\p\work\p\ridot\drivakosgn\d018315\td3.dgn		DRAWN -	REVISED -C. JUCIUS 09-09-09
	PLOT SCALE = 50,000' / IN.	CHECKED -	REVISED -
	PLOT DATE = 9/9/2009	DATE - 03-19-90	REVISED -

STATE OF ILLINOIS
DEPARTMENT OF TRANSPORTATION

DISTRICT ONE		F.A.W. RTE.	SECTION	COUNTY	TOTAL SHEETS	SHEET NO.
TYPICAL PAVEMENT MARKINGS		0037	12-00112-00-SW	MCHEVRY	20	20
SCALE: NONE		SHEET NO. 1 OF 1 SHEETS		TO STA.	TO STA.	
		FED. ROAD DIST. NO. 1 ILLINOIS		FED. AID PROJECT		

CONTRACT NO. 61A15	
--------------------	--