

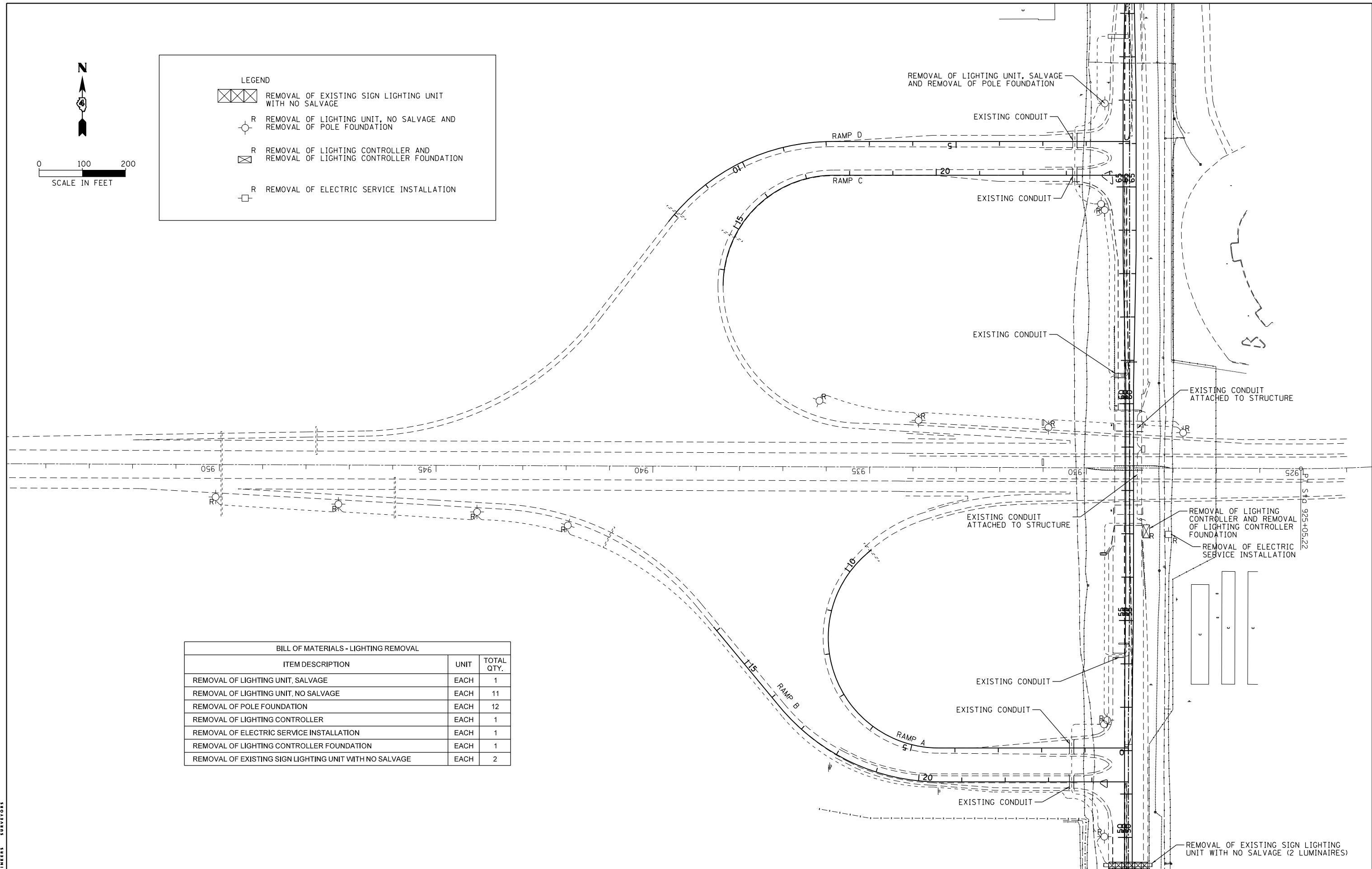

0 100 200
SCALE IN FEET

LEGEND	
	REMOVAL OF EXISTING SIGN LIGHTING UNIT WITH NO SALVAGE
	REMOVAL OF LIGHTING UNIT, NO SALVAGE AND REMOVAL OF POLE FOUNDATION
	REMOVAL OF LIGHTING CONTROLLER AND REMOVAL OF LIGHTING CONTROLLER FOUNDATION
	REMOVAL OF ELECTRIC SERVICE INSTALLATION



BILL OF MATERIALS - LIGHTING REMOVAL		
ITEM DESCRIPTION	UNIT	TOTAL QTY.
REMOVAL OF LIGHTING UNIT, SALVAGE	EACH	1
REMOVAL OF LIGHTING UNIT, NO SALVAGE	EACH	11
REMOVAL OF POLE FOUNDATION	EACH	12
REMOVAL OF LIGHTING CONTROLLER	EACH	1
REMOVAL OF ELECTRIC SERVICE INSTALLATION	EACH	1
REMOVAL OF LIGHTING CONTROLLER FOUNDATION	EACH	1
REMOVAL OF EXISTING SIGN LIGHTING UNIT WITH NO SALVAGE	EACH	2

MAURER-STUTZ
ENGINEERS SURVEYORS

FILE NAME = S:\237\2013\23713009\00\A11enRdPh11\CADD	USER NAME = baswanson	DESIGNED -	REVISED -
CADD Sheets\0468683-sht-lighting 02.dgn		DRAWN -	REVISED -
PLOT SCALE = 200.0000' / in.		CHECKED -	REVISED -
PLOT DATE = 1/29/2014 12:12:11 PM		DATE -	REVISED -

**STATE OF ILLINOIS
DEPARTMENT OF TRANSPORTATION**

**ALLEN ROAD IMPROVEMENTS
LIGHTING - REMOVAL**

SCALE: SHEET 2 OF 19 SHEETS STA. TO STA.

F.A.U. RTE. 6584	SECTION 105; (72-7HB)BY	COUNTY PEORIA	TOTAL SHEETS 487	SHEET NO. 270
6585			CONTRACT NO. 68683	
ILLINOIS FED. AID PROJECT				