

STATE OF ILLINOIS  
DEPARTMENT OF TRANSPORTATION  
DIVISION OF HIGHWAYS

**PROPOSED  
HIGHWAY PLANS**

F.A.P. ROUTE 317 (US 24)  
SECTION 17-1-1  
D4 SLOPE STABILIZATION 2014  
TAZEWELL COUNTY

C-94-047-13

F.A.P. RTE.	SECTION	COUNTY	TOTAL SHEETS	SHEET NO.
317	17-1-1	TAZEWELL	16	1
		ILLINOIS	CONTRACT NO. 68B41	

INDEX OF SHEETS

1. COVER SHEET
2. GENERAL NOTES/COMMITMENTS/JOB SPECIFIC NOTES
3. SUMMARY OF QUANTITIES
4. SCHEDULE OF QUANTITIES
5. PROPOSED PLAN
- 6-16. CROSS SECTIONS

STANDARDS

- 630001-10
- 701101-04
- 701421-06
- 701901-03

PROJECT LOCATION

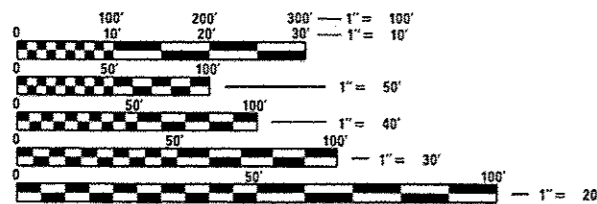
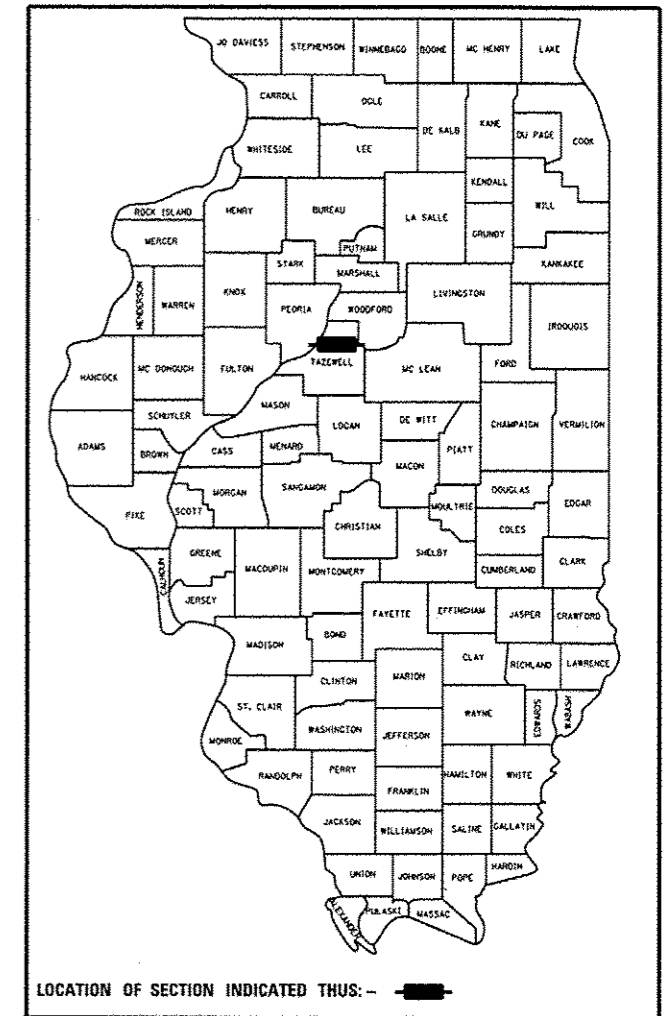
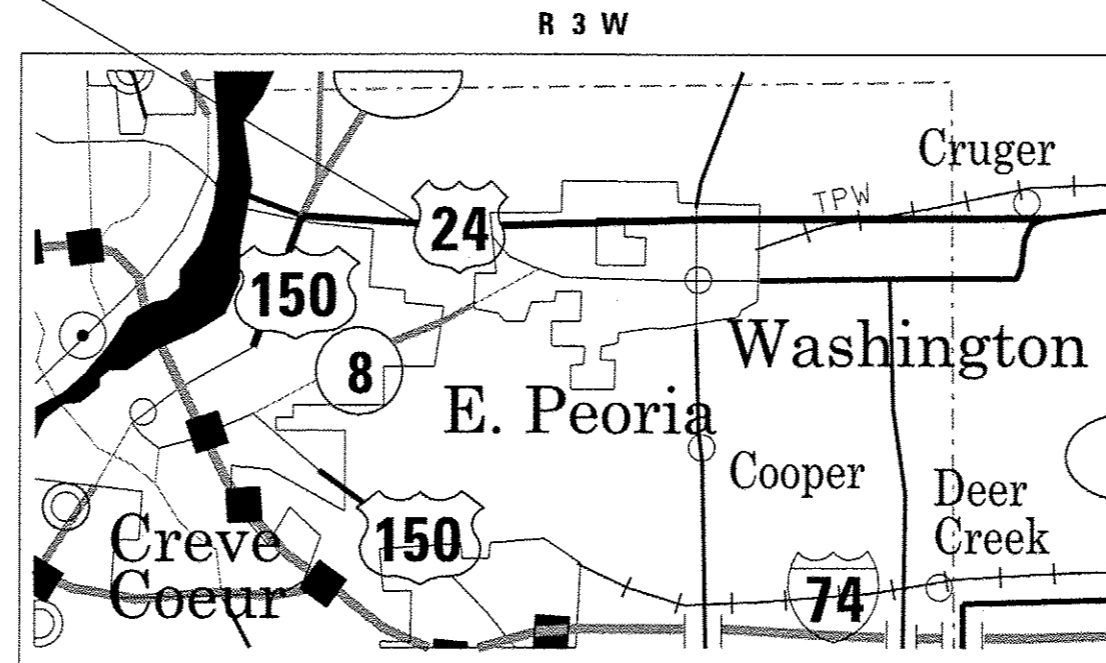

FULL SIZE PLANS HAVE BEEN PREPARED USING STANDARD ENGINEERING SCALES. REDUCED SIZED PLANS WILL NOT CONFORM TO STANDARD SCALES. IN MAKING MEASUREMENTS ON REDUCED PLANS, THE ABOVE SCALES MAY BE USED.

J.U.L.I.E.  
JOINT UTILITY LOCATION INFORMATION FOR EXCAVATION  
1-800-892-0123  
OR 811

PROJECT DESCRIPTION:

THIS PROJECT CONSISTS OF SLOPE STABILIZATION ALONG US 24 WEST OF HOLLANDS GROVE ROAD NEAR WASHINGTON IN TAZEWELL COUNTY.

GROSS LENGTH = N/A  
NET LENGTH = N/A

PROJECT ENGINEER: CHRISTOPHER MAUSHARD (309)671-3477  
PROJECT MANAGER: DAVID LAYNE (309)671-3477  
CONTRACT NO. 68B41  
CATALOG NO. 034919-00D

STATE OF ILLINOIS  
DEPARTMENT OF TRANSPORTATION  
DIVISION OF HIGHWAYS

SUBMITTED Feb 4 20 14  
Joseph Chovan  
DEPUTY DIRECTOR OF HIGHWAYS, REGION ENGINEER

March 21 20 14  
John D. Baranzelli, P.E.  
ENGINEER OF DESIGN AND ENVIRONMENT

March 21 20 14  
Omer Osman, P.E.  
DIRECTOR OF HIGHWAYS, CHIEF ENGINEER

PRINTED BY THE AUTHORITY  
OF THE STATE OF ILLINOIS

**COMMITMENTS**

There are no commitments for this project.

**ENVIRONMENTAL REVIEWS**

Prior to the use of any proposed borrow areas, use areas (temporary access roads, detours, run-arounds, etc.) and/or waste areas, the Contractor shall file the required environmental resource request surveys according to Section 107.22 of the Standard Specifications. These surveys are required in order for the Department to conduct cultural and biological resource surveys for the proposed site.

Prior to any waste materials being removed from the construction site the required environmental resource surveys will need to be obtained and filed by the Contractor. Excess waste products removed from the construction site shall be disposed of as required in Section 202.03 of the Standard Specifications.

Any protruding metal bars shall be removed prior to the disposal of broken concrete at approved disposal sites.

The required environmental resource documentation shall include the following:

- \* BDE Form 2289 (Environmental Survey Request)
- \* A location map showing the size limits and location of the use area
- \* Signed property owner agreement form-D4 PI0100
- \* Color photographs depicting the use area
- \* Borrow Area Entry Agreement form-D4 PI0101

Please note that a minimum of two weeks shall be allowed for the District to obtain the required environmental clearances.

**PROJECT SPECIFIC NOTES**

No bedding material, and fabric shall be required to be placed under the proposed riprap.

FILE NAME =	USER NAME = aubreyga	DESIGNED -	REVISED -	<b>STATE OF ILLINOIS DEPARTMENT OF TRANSPORTATION</b>	<b>GENERAL NOTES/COMMITMENTS/JOB SPECIFIC NOTES</b>	F.A.P. RTE.	SECTION	COUNTY	TOTAL SHEETS	SHEET NO.	
c:\users\aubreyga\desktop\68b41\0468841	plan01.dgn	DRAWN -	REVISED -			317	17-1-1	TAZEWELL	16	2	
	PLOT SCALE = 100.000 1/4 in.	CHECKED -	REVISED -			CONTRACT NO. 68841					
	PLOT DATE = 2/5/2014	DATE -	REVISED -			ILLINOIS FED. AID PROJECT					
					SCALE:	SHEET NO.	OF	SHEETS	STA.	TO STA.	



TREE REMOVAL ACRES	
LOCATION	ACRES
JOBSITE	1.5
TOTAL	1.5

MOBILIZATION	
LOCATION	L SUM
JOBSITE	1
TOTAL	1

HEAVY DUTY EROSION CONTROL BLANKET	
LOCATION	SQ YD
JOBSITE	445
TOTAL	445

TRAFFIC CONTROL AND PROTECTION, STANDARD 701421	
LOCATION	L SUM
JOBSITE	1
TOTAL	1

STONE DUMPED RIPRAP, CLASS B4	
LOCATION	TON
JOBSITE	1000
TOTAL	1000

REMOVE AND RE-ERECT STEEL PLATE BEAM GUARD RAIL, TYPE A	
LOCATION	FOOT
JOBSITE	50
TOTAL	50

NO BEDDING MATERIAL AND FABRIC SHALL BE REQUIRED UNDER THE PROPOSED RIPRAP

- ① Stone Dumped Riprap, Class B4
- ② Heavy Duty Erosion Control Blanket and Seeding

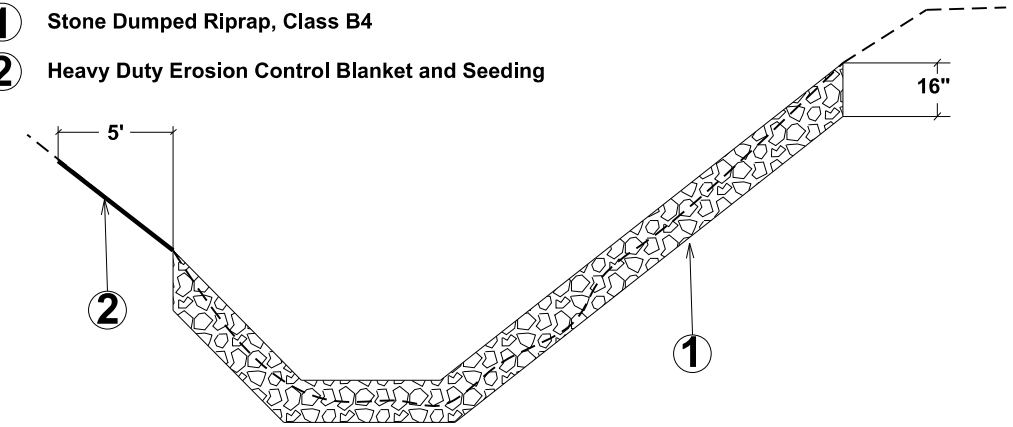

**SECTION A-A**  
FLOWLINE TO BE SHAPED AS DIRECTED BY ENGINEER

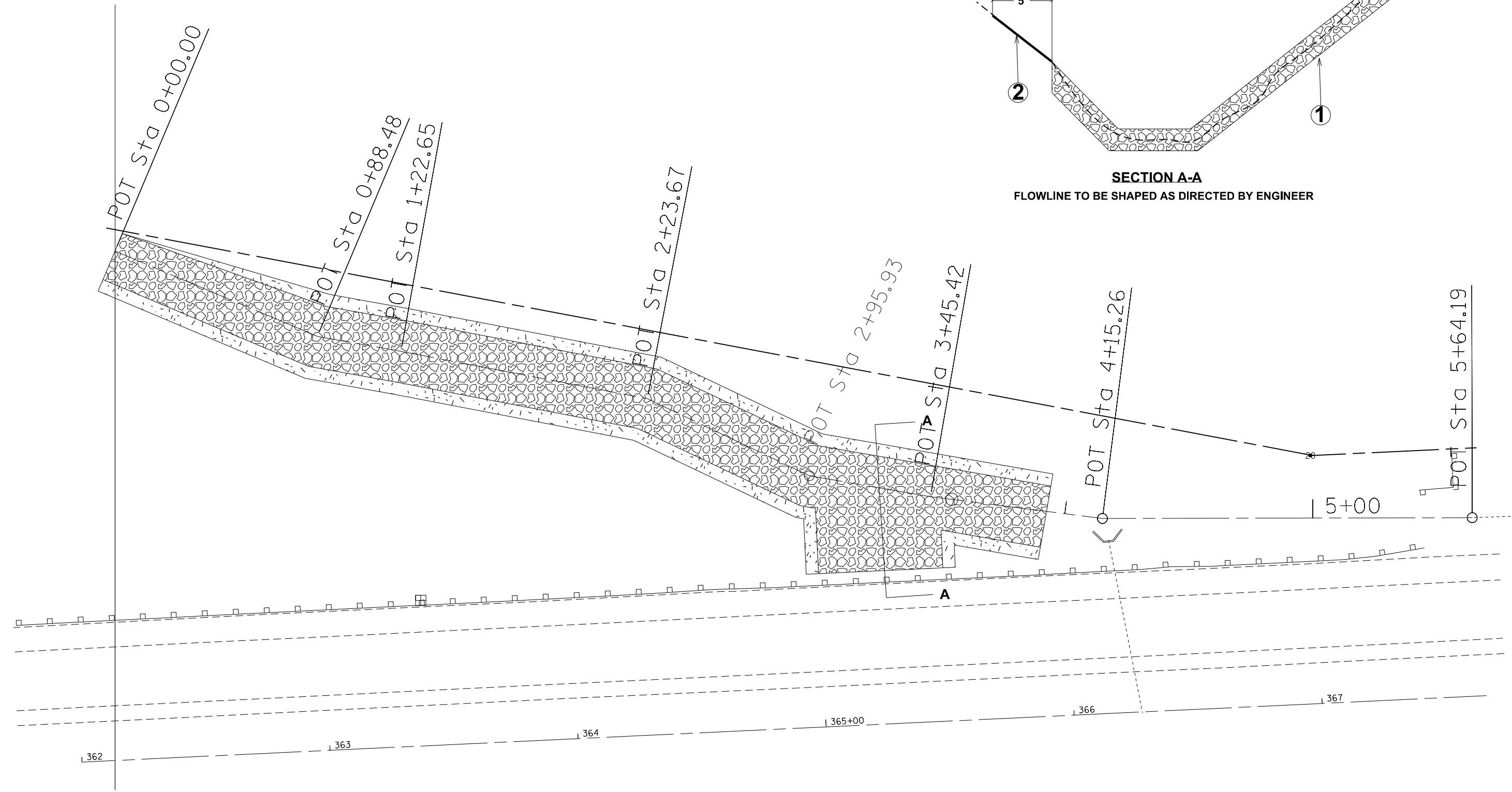

FILE NAME =	USER NAME = aubreys	DESIGNED -	REVISED -
C:\Users\aubreys\Desktop\68B41\0468B41	plan01.dgn	DRAWN -	REVISED -
Default	PLOT SCALE = 100.000' / in.	CHECKED -	REVISED -
	PLOT DATE = 2/5/2014	DATE -	REVISED -

**STATE OF ILLINOIS**  
**DEPARTMENT OF TRANSPORTATION**

<b>PROPOSED PLAN</b>				
SCALE:	SHEET	OF	SHEETS	STA. TO STA.

F.A.P. RTE.	SECTION	COUNTY	TOTAL SHEETS	SHEET NO.
317	17-1-1	TAZEWELL	16	5
CONTRACT NO. 68B41				
ILLINOIS FED. AID PROJECT				

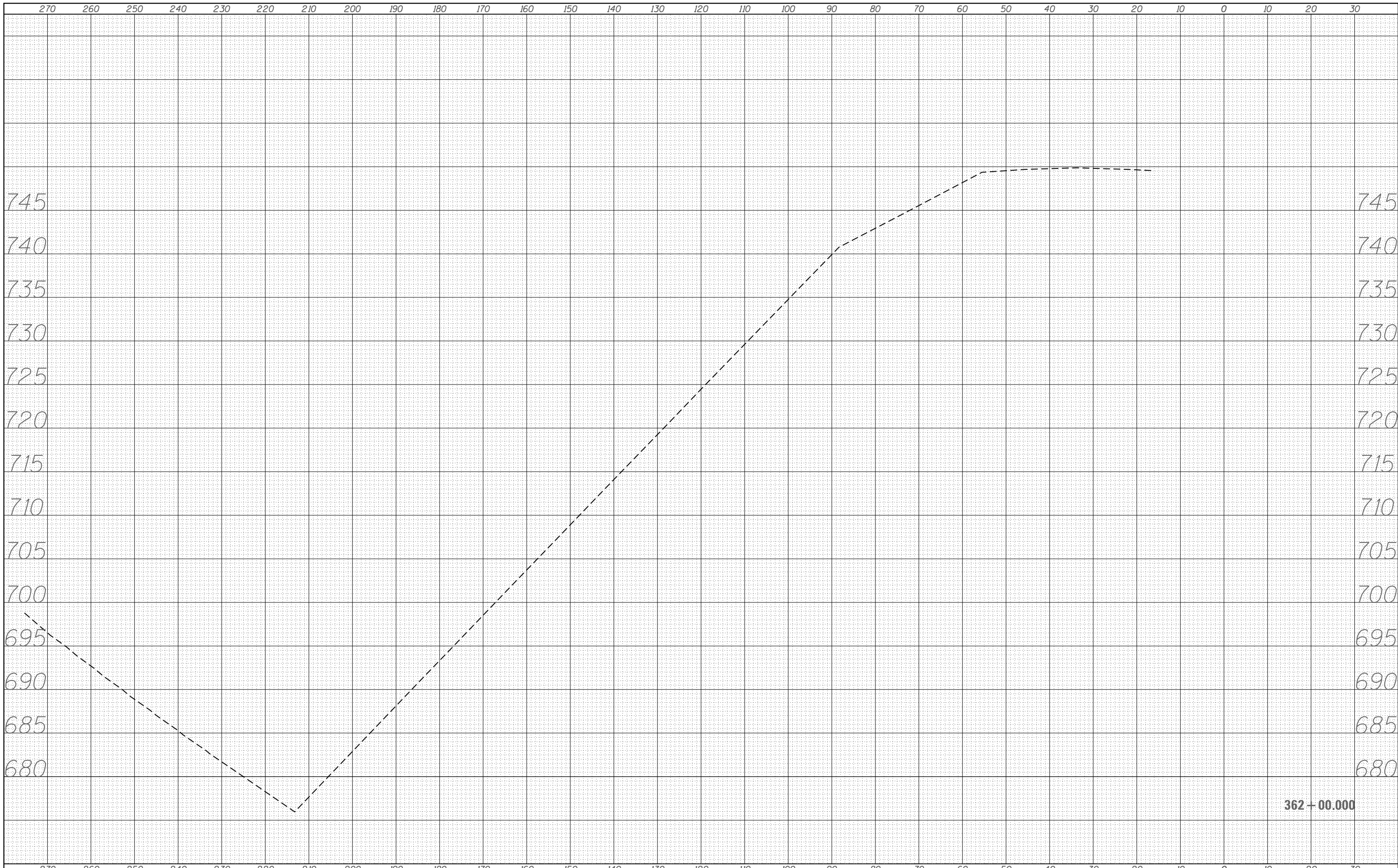

SURVEYED  
PLOTTED  
TEMPLATE  
AREAS  
CHECKED

SURVEY  
NOTE BOOK  
NO.

SURVEYED  
PLOTTED  
TEMPLATE  
AREAS  
CHECKED

SURVEY  
NOTE BOOK  
NO.

362+00.000

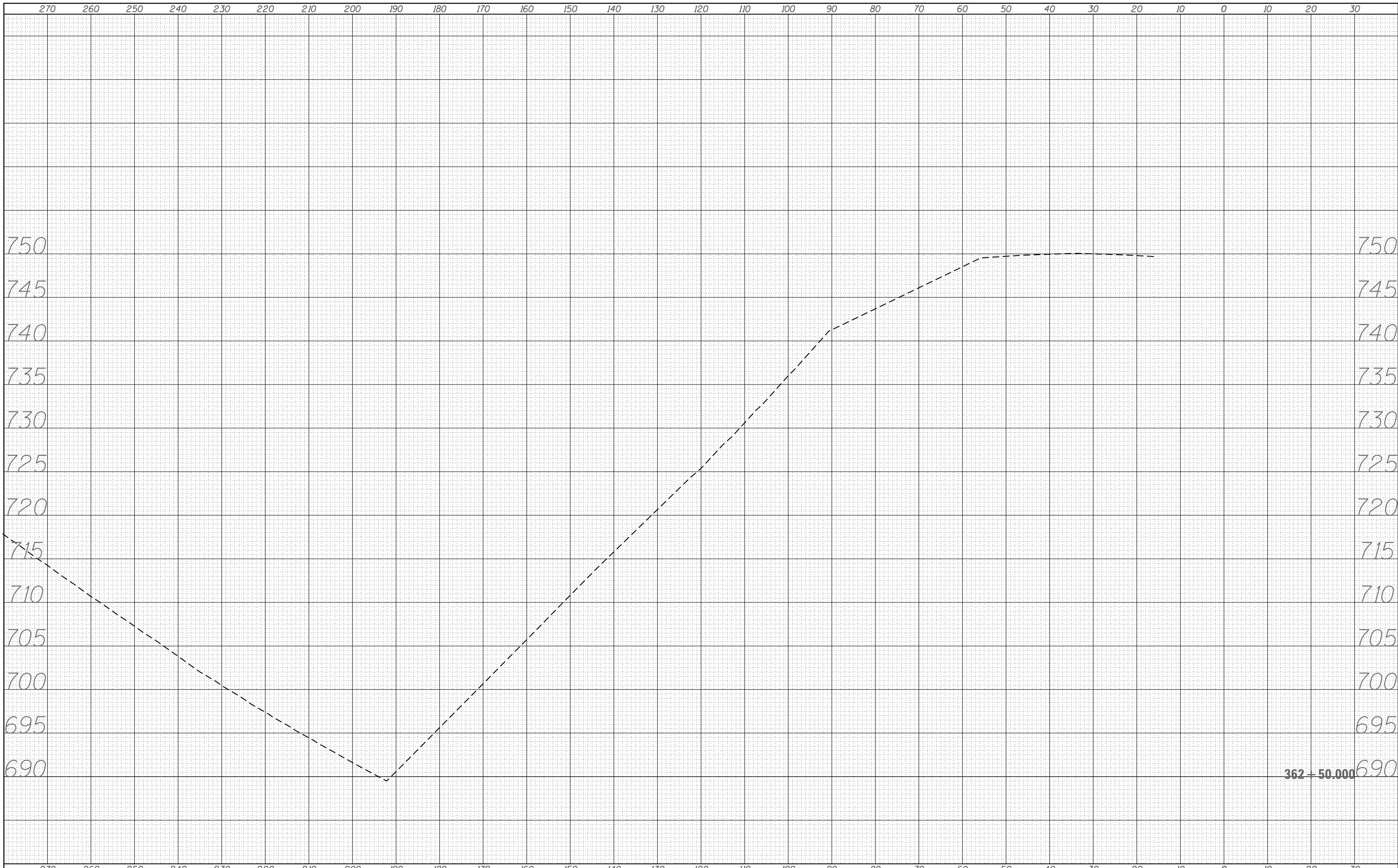

DATE	
BY	
ORIGINAL SURVEY	
SURVEYED	
PLOTTED	
TEMPLATE	
AREAS	
CHECKED	
NO.	

DATE	
BY	
ORIGINAL SURVEY	
SURVEYED	
PLOTTED	
TEMPLATE	
AREAS	
CHECKED	
NO.	

FILE NAME = c:\users\aubreys\desktop\68b41\0468b41-plan01.dgn

USER NAME = aubreys	DESIGNED -	REVISED -
	DRAWN -	REVISED -
PLOT SCALE = 100.000' / in.	CHECKED -	REVISED -
PLOT DATE = 2/5/2014	DATE -	REVISED -

**STATE OF ILLINOIS  
DEPARTMENT OF TRANSPORTATION**

**CROSS SECTIONS**  
SCALE: SHEET NO. 2 OF 11 SHEETS STA. 362+50.000 TO STA. 362+50.000

F.A.P. RTE.	SECTION	COUNTY	TOTAL SHEETS	SHEET NO.
317	17-1-1	TAZWELL	16	7
ILLINOIS FED. AID PROJECT			CONTRACT NO. 68B41	

362+50.000

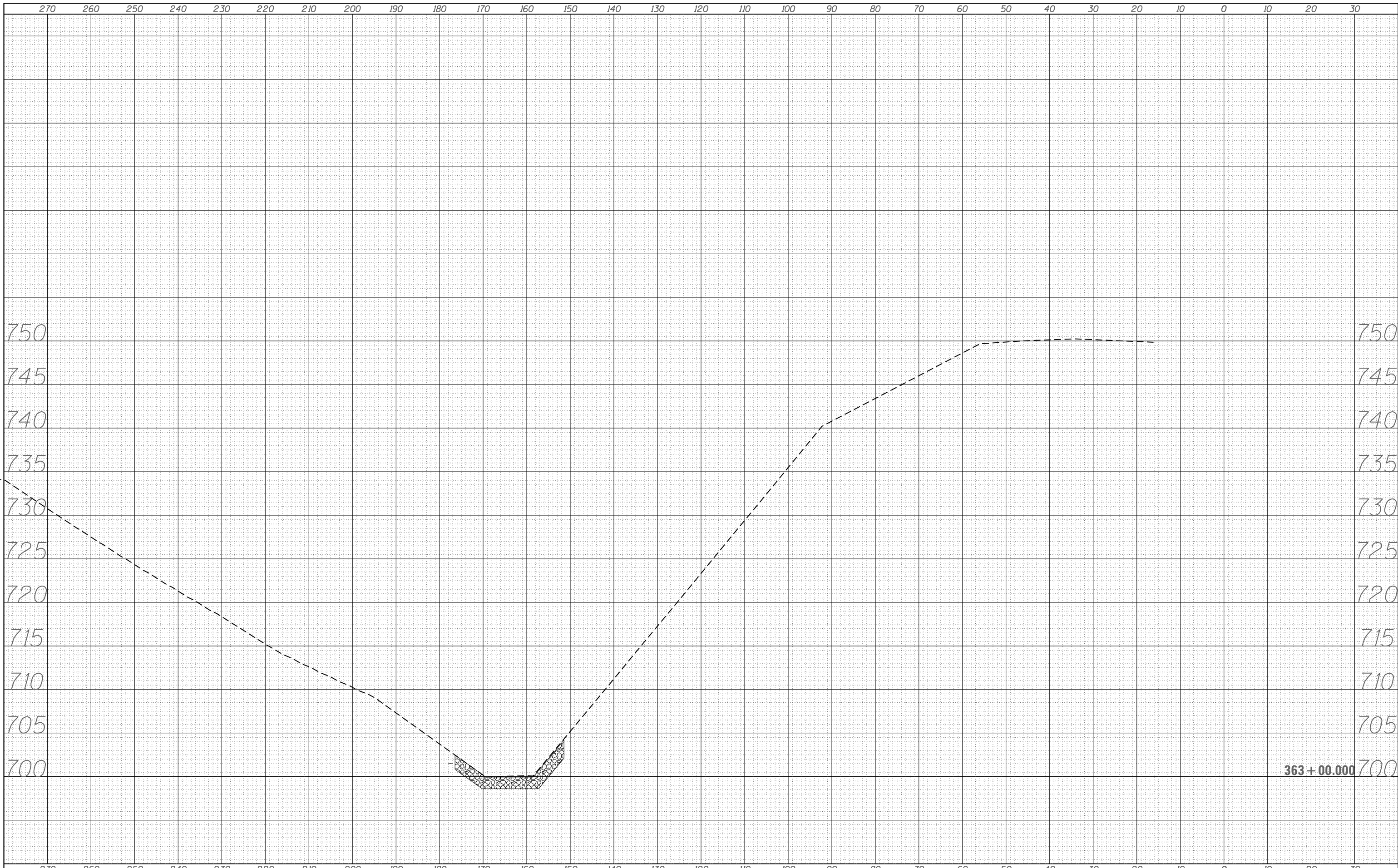

DATE	
BY	
FINAL SURVEY	SURVEYED
NOTE BOOK	PLOTTED
NO.	TEMPLATE
	AREAS
	CHECKED

DATE	
BY	
ORIGINAL SURVEY	SURVEYED
NOTE BOOK	PLOTTED
NO.	TEMPLATE
	AREAS
	CHECKED

FILE NAME = c:\users\aubreys\desktop\68b41\0468841-plan01.dgn

USER NAME = aubreys	DESIGNED -	REVISED -
	DRAWN -	REVISED -
PLOT SCALE = 100.000' / in.	CHECKED -	REVISED -
PLOT DATE = 2/5/2014	DATE -	REVISED -

**STATE OF ILLINOIS  
DEPARTMENT OF TRANSPORTATION**

**CROSS SECTIONS**  
SCALE: SHEET NO. 3 OF 11 SHEETS STA. 363+00.000 TO STA. 363+00.000

F.A.P. RTE.	SECTION	COUNTY	TOTAL SHEETS	SHEET NO.
317	17-1-1	TAZWELL	16	8
CONTRACT NO. 68B41			ILLINOIS FED. AID PROJECT	

363+00.000



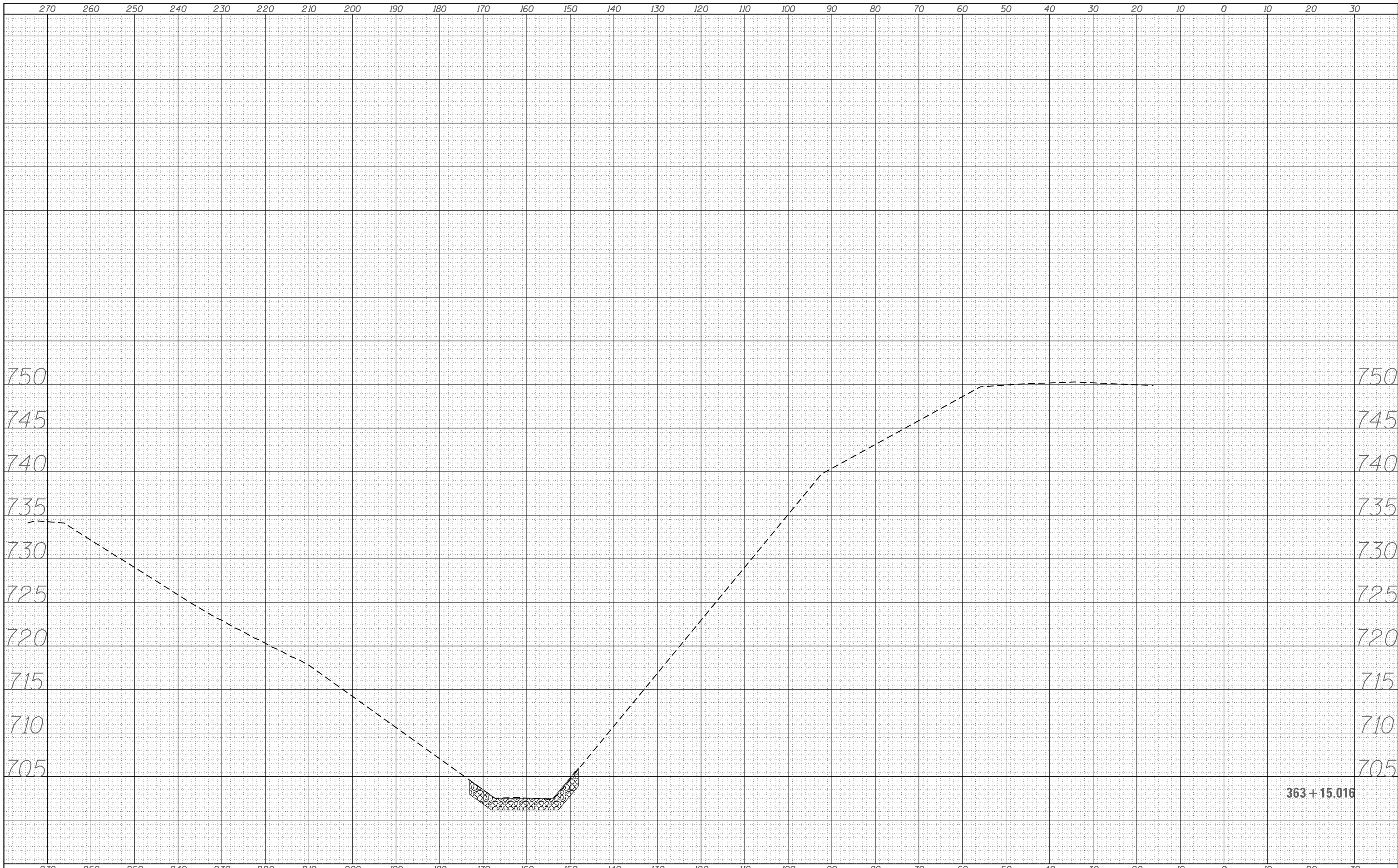

DATE	
BY	
FINAL SURVEY	SURVEYED
NOTE BOOK	PLOTTED
NO.	TEMPLATE
	AREAS
	CHECKED

DATE	
BY	
ORIGINAL SURVEY	SURVEYED
NOTE BOOK	PLOTTED
NO.	TEMPLATE
	AREAS
	CHECKED

FILE NAME = c:\users\aubreys\desktop\68b41\0468841-plan01.dgn

USER NAME = aubreys	DESIGNED -	REVISED -
	DRAWN -	REVISED -
PLOT SCALE = 100.000' / in.	CHECKED -	REVISED -
PLOT DATE = 2/5/2014	DATE -	REVISED -

**STATE OF ILLINOIS  
DEPARTMENT OF TRANSPORTATION**

**CROSS SECTIONS**  
SCALE: SHEET NO. 4 OF 11 SHEETS STA. 363+15.016 TO STA. 363+15.016

F.A.P. RTE.	SECTION	COUNTY	TOTAL SHEETS	SHEET NO.
317	17-1-1		16	9
			CONTRACT NO. 68B41	
ILLINOIS FED. AID PROJECT				

**363 + 15.016**

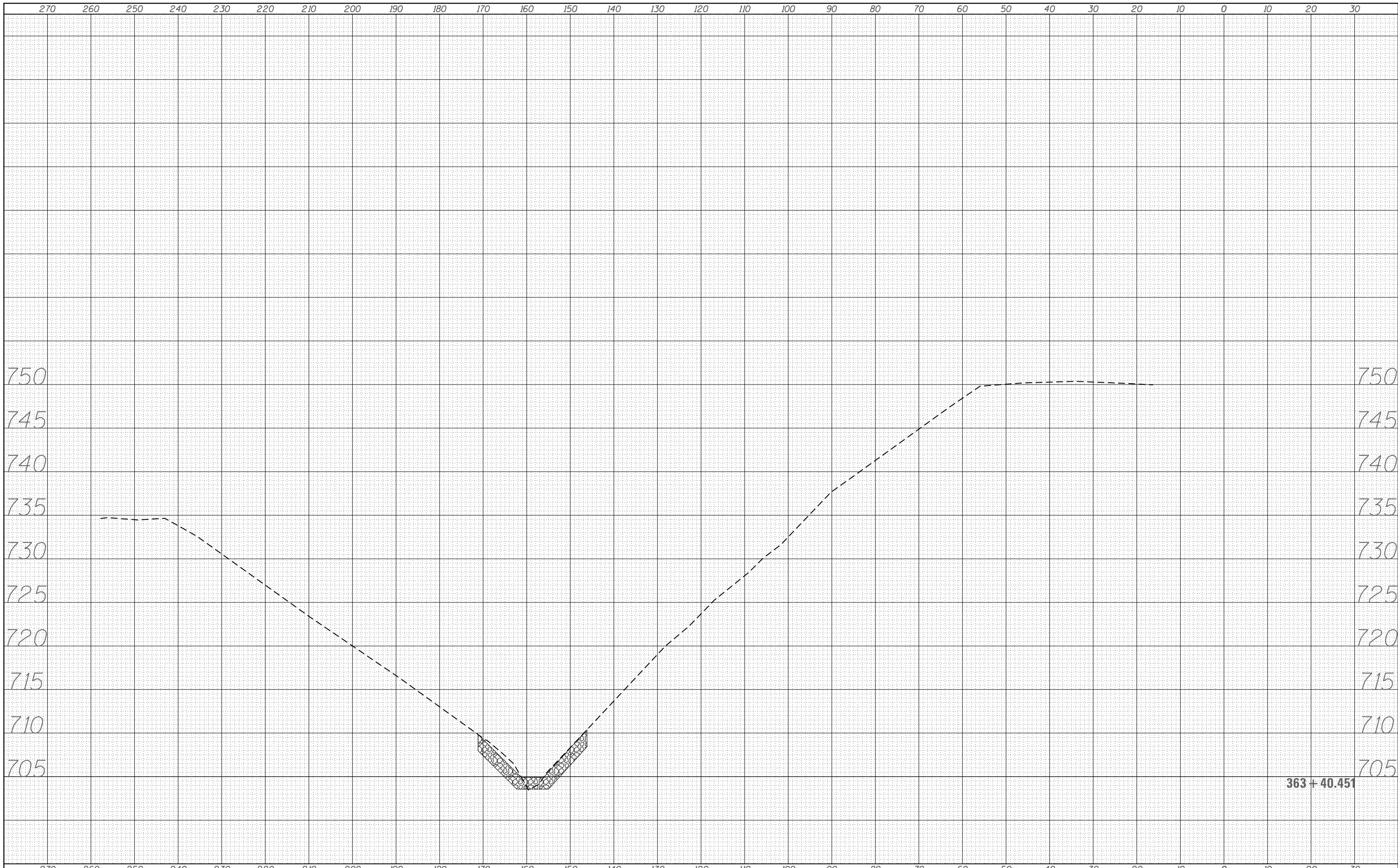

DATE	
BY	
FINAL SURVEY	SURVEYED
NOTE BOOK	PLOTTED
NO.	TEMPLATE
	AREAS
	CHECKED

DATE	
BY	
ORIGINAL SURVEY	SURVEYED
NOTE BOOK	PLOTTED
NO.	TEMPLATE
	AREAS
	CHECKED

FILE NAME = c:\users\aubreygs\desktop\68b41\0468841-plan01.dgn

USER NAME = aubreygs	DESIGNED -	REVISED -
	DRAWN -	REVISED -
PLOT SCALE = 100.000' / in.	CHECKED -	REVISED -
PLOT DATE = 2/5/2014	DATE -	REVISED -

**STATE OF ILLINOIS  
DEPARTMENT OF TRANSPORTATION**

**CROSS SECTIONS**  
SCALE: SHEET NO. 5 OF 11 SHEETS STA. 363+40.451 TO STA. 363+40.451

F.A.P. RTE.	SECTION	COUNTY	TOTAL SHEETS	SHEET NO.
317	17-1-1	TAZWELL	16	10
CONTRACT NO. 68B41			ILLINOIS FED. AID PROJECT	

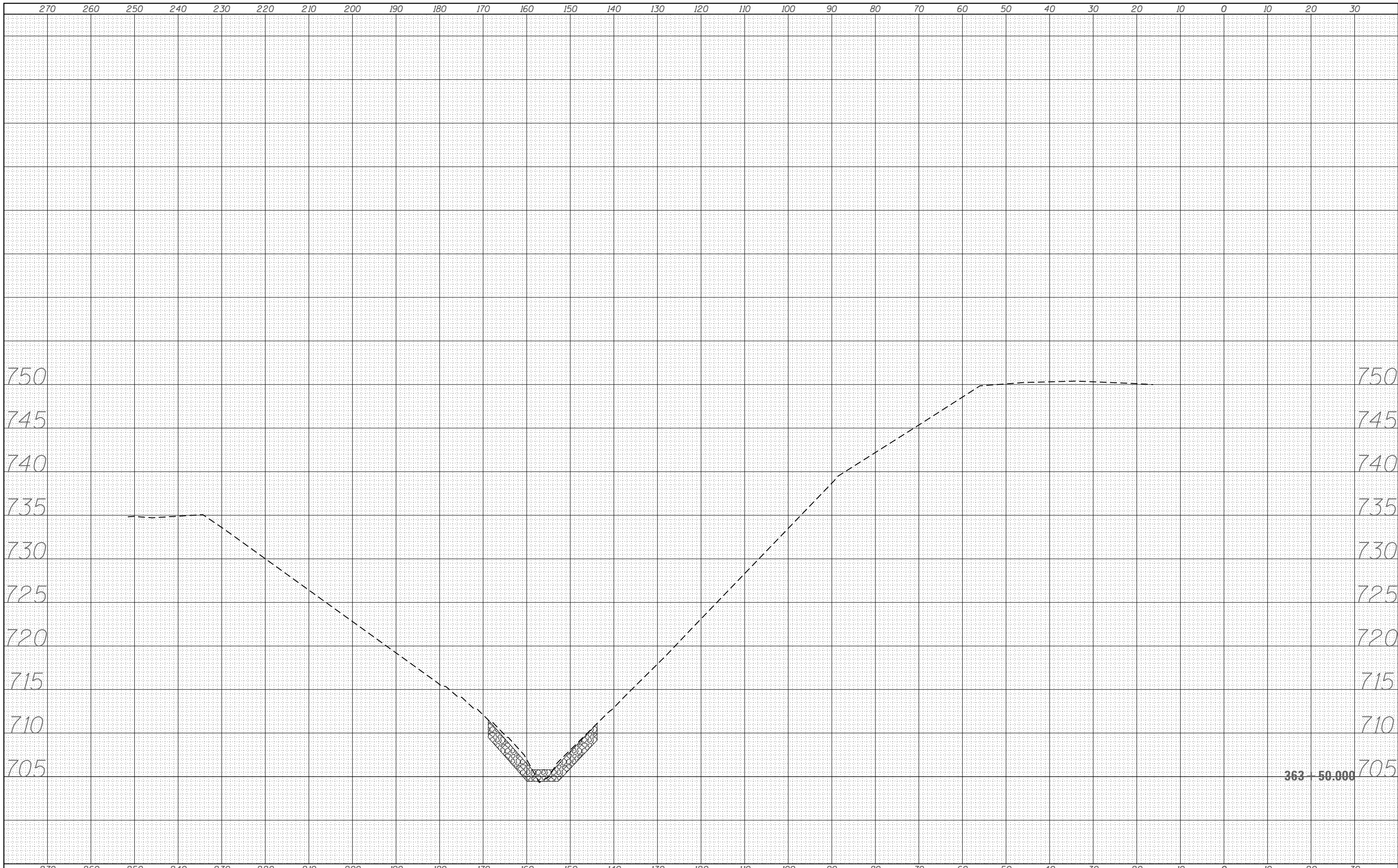

DATE	
BY	
FINAL SURVEY	SURVEYED
NOTE BOOK	PLOTTED
NO.	TEMPLATE
	AREAS
	CHECKED

DATE	
BY	
ORIGINAL SURVEY	SURVEYED
NOTE BOOK	PLOTTED
NO.	TEMPLATE
	AREAS
	CHECKED

FILE NAME =	USER NAME = aubreys	DESIGNED -	REVISED -	<b>STATE OF ILLINOIS</b> <b>DEPARTMENT OF TRANSPORTATION</b>	<b>CROSS SECTIONS</b>			F.A.P. RTE.	SECTION	COUNTY	TOTAL SHEETS	SHEET NO.	
c:\users\aubreys\desktop\68b41\0468841-plan01.dgn		DRAWN -	REVISED -					317	17-1-1	TAZWELL	16	11	
		CHECKED -	REVISED -		SCALE:			SHEET NO. 6 OF 11 SHEETS		STA. 363+50.000 TO STA. 363+50.000		ILLINOIS FED. AID PROJECT	
		DATE -	REVISED -		CONTRACT NO. 68B41								

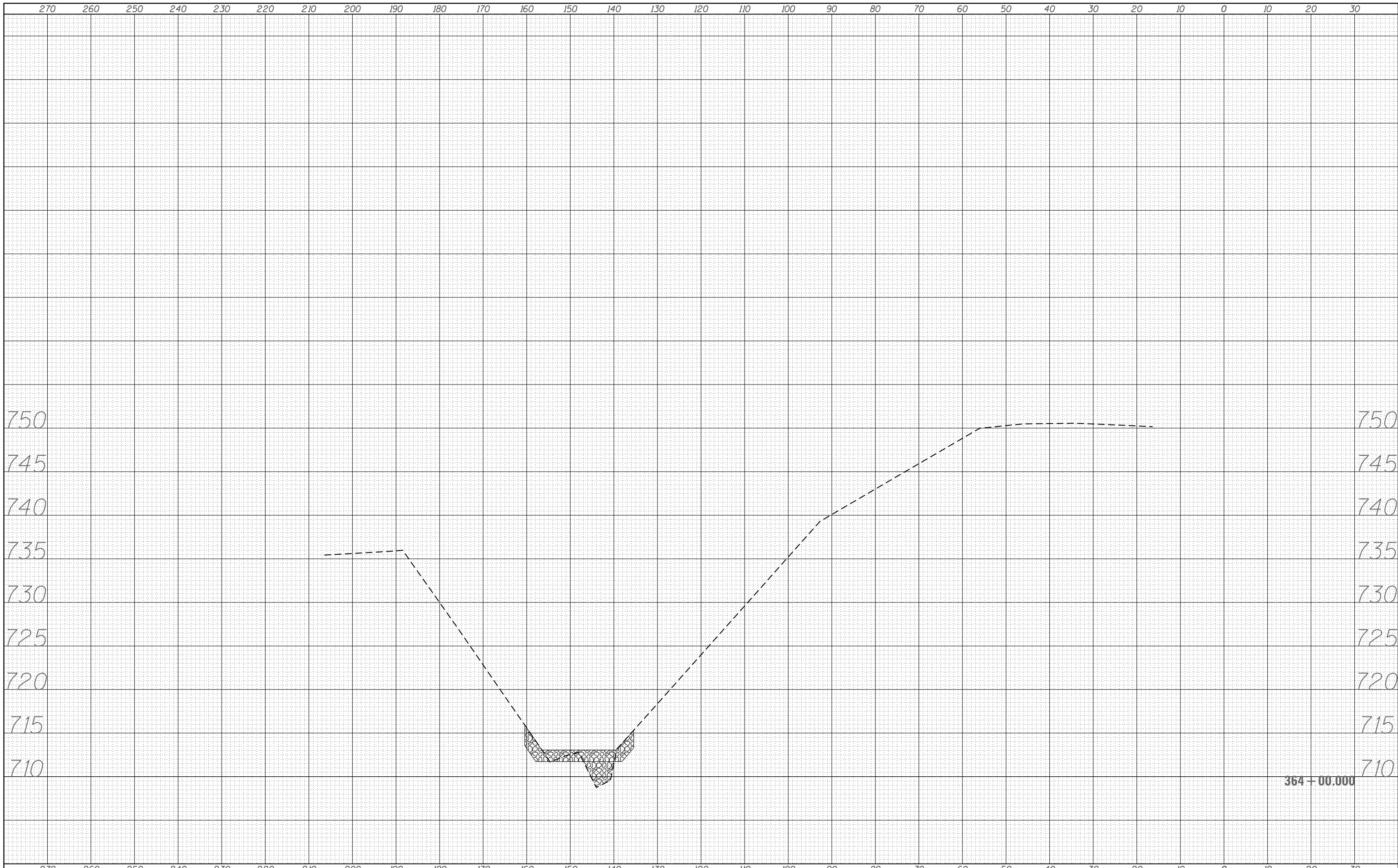

DATE	
BY	
FINAL SURVEY	SURVEYED
NOTE BOOK	PLOTTED
NO.	TEMPLATE
	AREAS
	CHECKED

DATE	
BY	
ORIGINAL SURVEY	SURVEYED
NOTE BOOK	PLOTTED
NO.	TEMPLATE
	AREAS
	CHECKED

FILE NAME = c:\users\aubreygs\desktop\68b41\0468841-plan01.dgn

USER NAME = aubreygs	DESIGNED -	REVISED -
	DRAWN -	REVISED -
PLOT SCALE = 100.000' / in.	CHECKED -	REVISED -
PLOT DATE = 2/5/2014	DATE -	REVISED -

**STATE OF ILLINOIS  
DEPARTMENT OF TRANSPORTATION**

**CROSS SECTIONS**

SCALE: SHEET NO. 7 OF 11 SHEETS STA. 364+00.000 TO STA. 364+00.000

F.A.P. RTE.	SECTION	COUNTY	TOTAL SHEETS	SHEET NO.
317	17-1-1	TAZWELL	16	12
CONTRACT NO. 68B41				
ILLINOIS FED. AID PROJECT				

364 + 00.000

BY	DATE
FINAL SURVEY	SURVEYED
NOTE BOOK	PLOTTED
NO.	TEMPLATE
	AREAS
	CHECKED

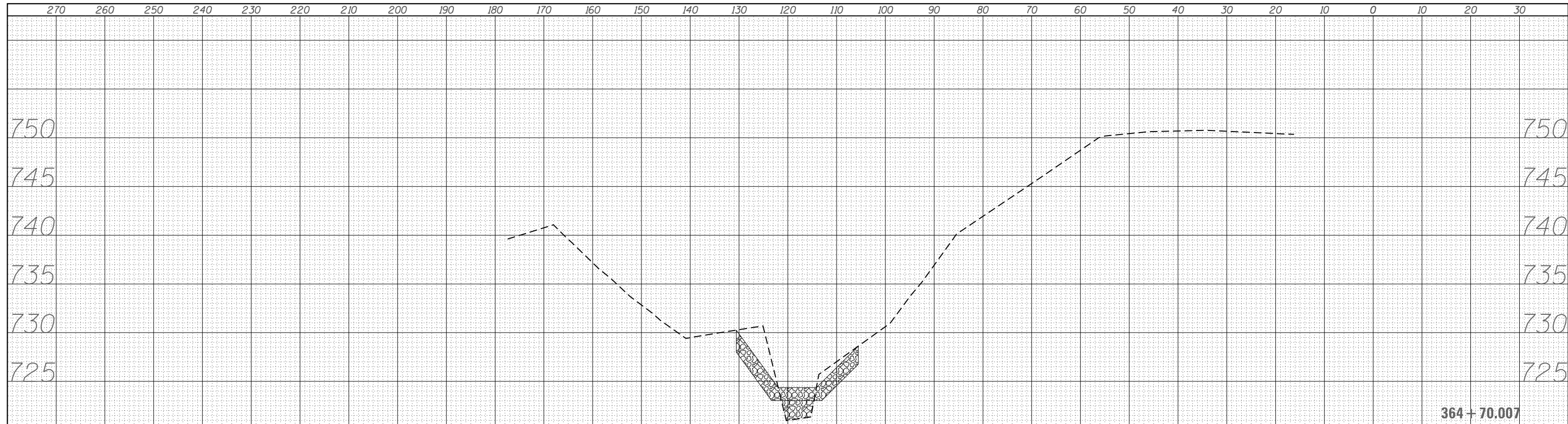

**364 + 70.007**

BY	DATE
ORIGINAL SURVEY	SURVEYED
NOTE BOOK	PLOTTED
NO.	TEMPLATE
	AREAS
	CHECKED



**364 + 50.000**

FILE NAME	:	c:\users\aubreygs\desktop\68b41\0468841-plan01.dgn
-----------	---	--

USER NAME	=	aubreygs
DESIGNED	-	
DRAWN	-	
CHECKED	-	
DATE	-	2/5/2014

REVISED	-	
REVISED	-	
REVISED	-	
REVISED	-	

**STATE OF ILLINOIS  
DEPARTMENT OF TRANSPORTATION**

**CROSS SECTIONS**

SCALE: SHEET NO. 8 OF 11 SHEETS STA. 364+50.000 TO STA. 364+70.007

F.A.P. RTE.	SECTION	COUNTY	TOTAL SHEETS	SHEET NO.
317	17-1-1	TAZWELL	16	13
CONTRACT NO. 68B41				
ILLINOIS FED. AID PROJECT				







270 260 250 240 230 220 210 200 190 180 170 160 150 140 130 120 110 100 90 80 70 60 50 40 30 20 10 0 10 20 30

DATE	
BY	
FINAL SURVEY	SURVEYED
NOTE BOOK	PLOTTED
NO.	TEMPLATE
	AREAS
	CHECKED

DATE	
BY	
ORIGINAL SURVEY	SURVEYED
NOTE BOOK	PLOTTED
NO.	TEMPLATE
	AREAS
	CHECKED

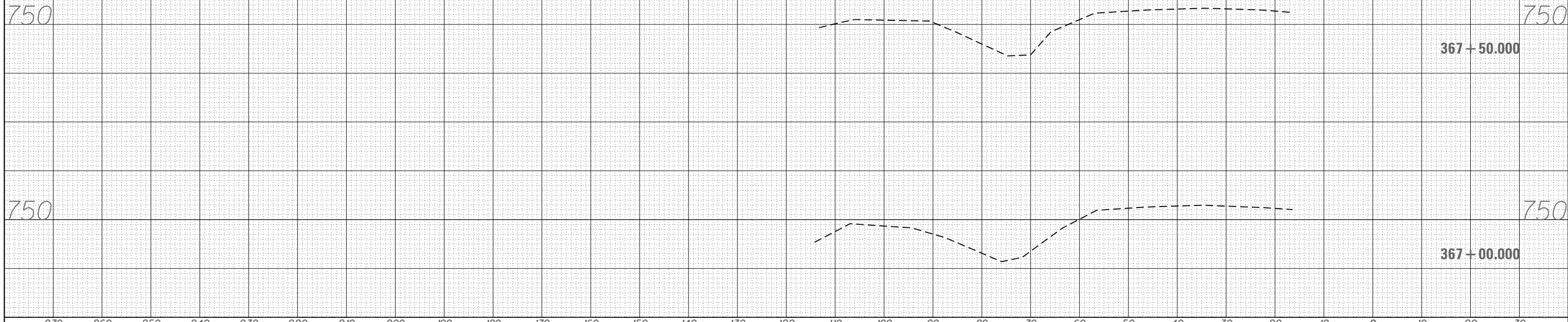

FILE NAME =	USER NAME = aubreys	DESIGNED -	REVISED -	<p align="center"><b>STATE OF ILLINOIS</b> <b>DEPARTMENT OF TRANSPORTATION</b></p> <p align="center"><b>CROSS SECTIONS</b></p> <p>SCALE:      SHEET NO. 11 OF 11 SHEETS      STA. 367+00.000 TO STA. 367+50.000</p>	F.A.P. RTE.	SECTION	COUNTY	TOTAL SHEETS	SHEET NO.
c:\users\aubreys\desktop\68b41\0468841-plan01.dgn		DRAWN -	REVISED -		317	17-1-1	TAZWELL	16	16
		CHECKED -	REVISED -		CONTRACT NO. 68B41				
		DATE -	REVISED -		ILLINOIS FED. AID PROJECT				