

PTZ CAMERA INSTALLATION & FIBER OPTIC CONNECTION

LINCOLN AVE. & I-74

(NOT TO SCALE)

CAMERA & CONDUIT /CABLE LAYOUT



BILL OF MATERIALS		
I-74 & LINCOLN AVE.		
ITEM	UNIT	QUANTITY
UNDERGROUND CONDUIT, PVC, 2" DIA.	FOOT	80
HANDHOLE	EACH	1
GULFBOX JUNCTION REMOVAL	EACH	1
LIGHT POLE FOUNDATION, 30" DIAMETER	FOOT	8
TRANSCEIVER - FIBER OPTIC	EACH	3
FIBER OPTIC CABLE IN CONDUIT, NO. 62.5/125, MM12F SM12F	FOOT	1495
ELECTRIC CABLE IN CONDUIT, TRACER, NO. 12 1C	FOOT	1032
DRILL EXISTING HANDHOLE	EACH	3
REMOVE ELECTRIC CABLE FROM CONDUIT	FOOT	1473
LIGHT POLE, STEEL 50 FT. WITH CAMERA LOWERING SYSTE	EACH	1
ETHERNET SWITCH	EACH	1
CLOSED CIRCUIT TELEVISION CAMERA	EACH	1
FIBER OPTIC CABLE 12 FIBERS, SINGLE MODE	FOOT	498

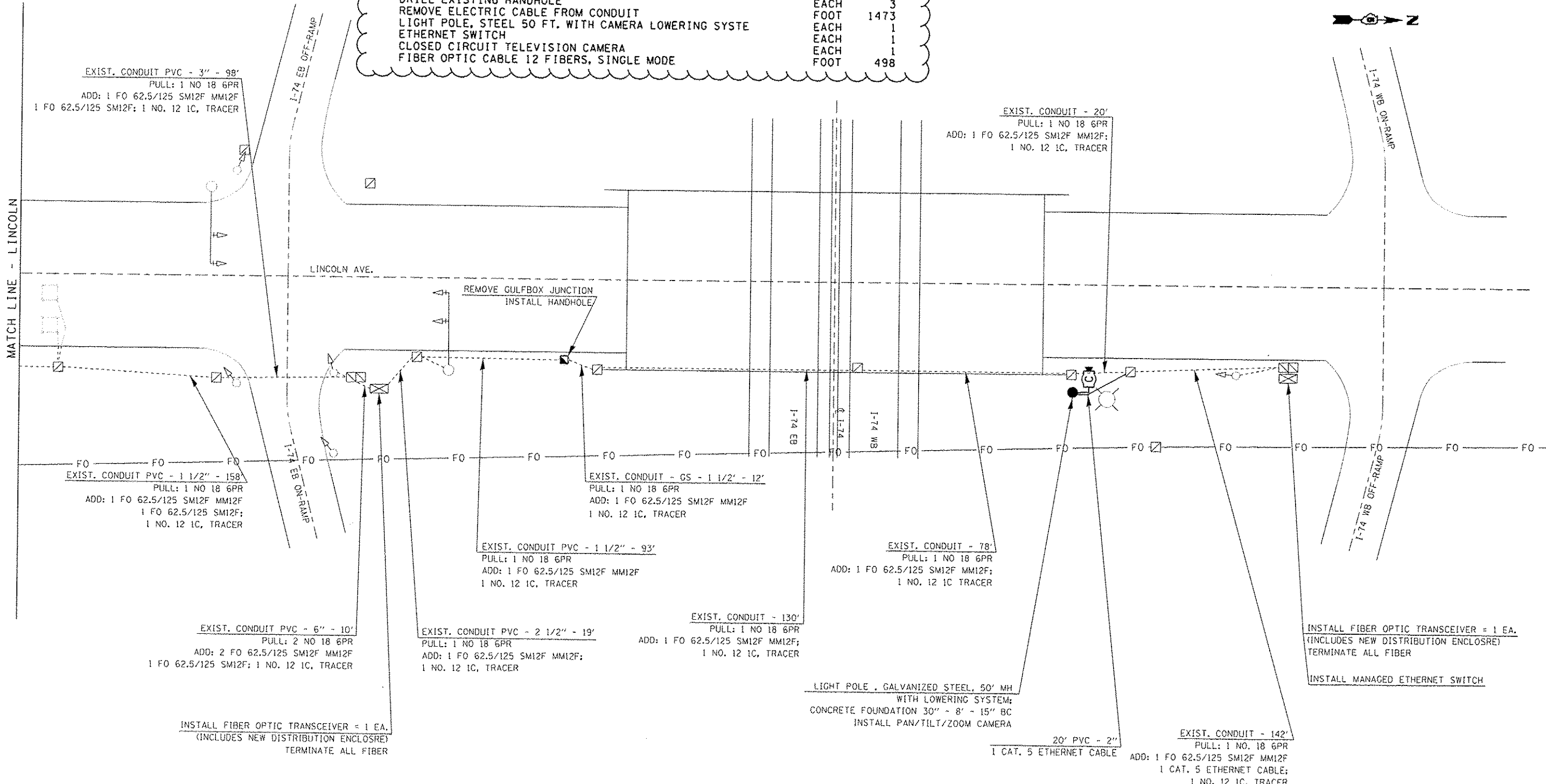

EXIST. CONDUIT PVC - 3" - 98'
PULL: 1 NO 18 6PR
ADD: 1 FO 62.5/125 SM12F MM12F
1 FO 62.5/125 SM12F; 1 NO. 12 1C, TRACER

EXIST. CONDUIT - 20'
PULL: 1 NO 18 6PR
ADD: 1 FO 62.5/125 SM12F MM12F;
1 NO. 12 1C, TRACER

EXIST. CONDUIT PVC - 1 1/2" - 158'
PULL: 1 NO 18 6PR
ADD: 1 FO 62.5/125 SM12F MM12F
1 FO 62.5/125 SM12F;
1 NO. 12 1C, TRACER

EXIST. CONDUIT - GS - 1 1/2" - 12'
PULL: 1 NO 18 6PR
ADD: 1 FO 62.5/125 SM12F MM12F
1 NO. 12 1C, TRACER

EXIST. CONDUIT PVC - 1 1/2" - 93'
PULL: 1 NO 18 6PR
ADD: 1 FO 62.5/125 SM12F MM12F
1 NO. 12 1C, TRACER

EXIST. CONDUIT - 78'
PULL: 1 NO 18 6PR
ADD: 1 FO 62.5/125 SM12F MM12F;
1 NO. 12 1C TRACER

EXIST. CONDUIT PVC - 6" - 10'
PULL: 2 NO 18 6PR
ADD: 2 FO 62.5/125 SM12F MM12F
1 FO 62.5/125 SM12F; 1 NO. 12 1C, TRACER

EXIST. CONDUIT PVC - 2 1/2" - 19'
PULL: 1 NO 18 6PR
ADD: 1 FO 62.5/125 SM12F MM12F;
1 NO. 12 1C, TRACER

EXIST. CONDUIT - 130'
PULL: 1 NO 18 6PR
ADD: 1 FO 62.5/125 SM12F MM12F;
1 NO. 12 1C, TRACER

LIGHT POLE, GALVANIZED STEEL, 50' MH
WITH LOWERING SYSTEM;
CONCRETE FOUNDATION 30" - 8" - 15" BC
INSTALL PAN/TILT/ZOOM CAMERA

20' PVC - 2"
1 CAT. 5 ETHERNET CABLE

EXIST. CONDUIT - 142'
PULL: 1 NO. 18 6PR
ADD: 1 FO 62.5/125 SM12F MM12F
1 CAT. 5 ETHERNET CABLE;
1 NO. 12 1C, TRACER

INSTALL FIBER OPTIC TRANSCEIVER = 1 EA.
(INCLUDES NEW DISTRIBUTION ENCLOSURE)
TERMINATE ALL FIBER

INSTALL MANAGED ETHERNET SWITCH

INSTALL FIBER OPTIC TRANSCEIVER = 1 EA.
(INCLUDES NEW DISTRIBUTION ENCLOSURE)
TERMINATE ALL FIBER

FILE NAME =	USER NAME = biggard	DESIGNED -	REVISED -
c:\pwork\pwork\biggard\102348463\PTZ	sonora plans.dgn	DRAWN -	REVISED -
MODELNAME =	PLOT SCALE = 3/32" = 1' / 32"	CHECKED -	REVISED -
	PLOT DATE = 4/5/2014	DATE -	REVISED -

**STATE OF ILLINOIS
DEPARTMENT OF TRANSPORTATION**

SCALE:	SHEET	OF	SHEETS	STA.	TO STA.

F.A.P. RTE.	SECTION	COUNTY	TOTAL SHEETS	SHEET NO.
VAR.	FY2014 ITS-1	CHAMPAIGN	74	41
CONTRACT NO. 70A26				
ILLINOIS FED. AID PROJECT				

REV. 4-10-14