

PTZ CAMERA INSTALLATION

**UNIVERSITY AVE.
&
I-74**

(NOT TO SCALE)

CAMERA & CONDUIT /CABLE LAYOUT

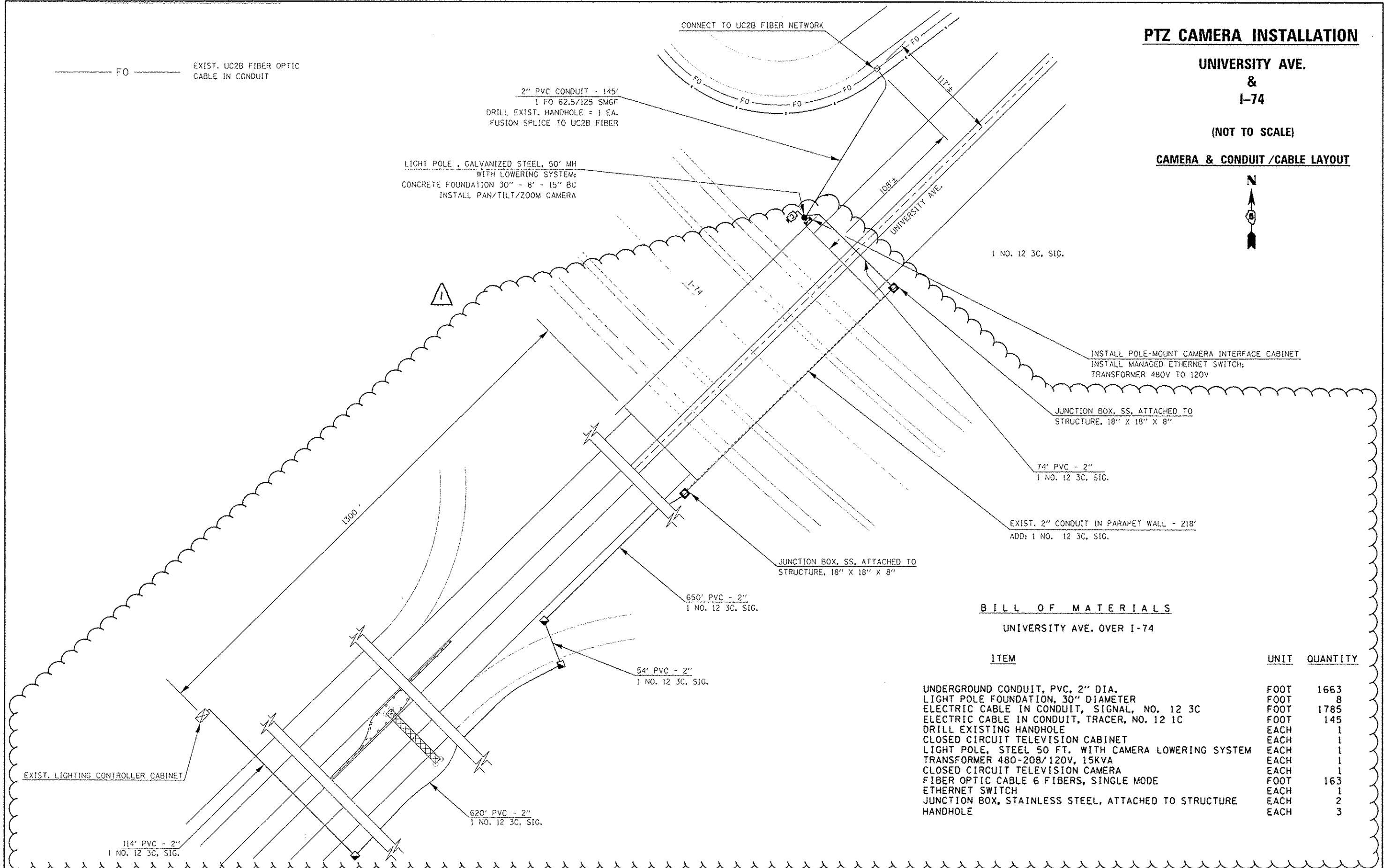

BILL OF MATERIALS

UNIVERSITY AVE. OVER I-74

ITEM	UNIT	QUANTITY
UNDERGROUND CONDUIT, PVC, 2" DIA.	FOOT	1663
LIGHT POLE FOUNDATION, 30" DIAMETER	FOOT	8
ELECTRIC CABLE IN CONDUIT, SIGNAL, NO. 12 3C	FOOT	1785
ELECTRIC CABLE IN CONDUIT, TRACER, NO. 12 1C	FOOT	145
DRILL EXISTING HANDHOLE	EACH	1
CLOSED CIRCUIT TELEVISION CABINET	EACH	1
LIGHT POLE, STEEL 50 FT. WITH CAMERA LOWERING SYSTEM	EACH	1
TRANSFORMER 480-208/120V, 15KVA	EACH	1
CLOSED CIRCUIT TELEVISION CAMERA	EACH	1
FIBER OPTIC CABLE 6 FIBERS, SINGLE MODE	FOOT	163
ETHERNET SWITCH	EACH	1
JUNCTION BOX, STAINLESS STEEL, ATTACHED TO STRUCTURE	EACH	2
HANDHOLE	EACH	3

FILE NAME : c:\p\work\p\dot\biggard\2348463\PTZ	USER NAME : biggard	DESIGNED -	REVISED -	STATE OF ILLINOIS DEPARTMENT OF TRANSPORTATION	F.A.P. RTE.	SECTION	COUNTY	TOTAL SHEETS	SHEET NO.
#MODELNAME#	camera plans.dgn	DRAWN -	REVISED -		VAR.	FY2014 [TS-1]	CHAMPAIGN	74	44
	PLOT SCALE : 3/32"=1'	CHECKED -	REVISED -		SCALE:		CONTRACT NO. 70A26		
	PLOT DATE : 4/5/2014	DATE -	REVISED -		SHEET OF SHEETS STA. TO STA.		[ILLINOIS] FED. AID PROJECT		

REV. 4-10-14