

PLAN	SURVEYED	DATE
NOTE BOOK	PLOTTED	BY
NO.	GRADES CHECKED	
	STRUCTURE	
	NOT AT THIS OFFICE	

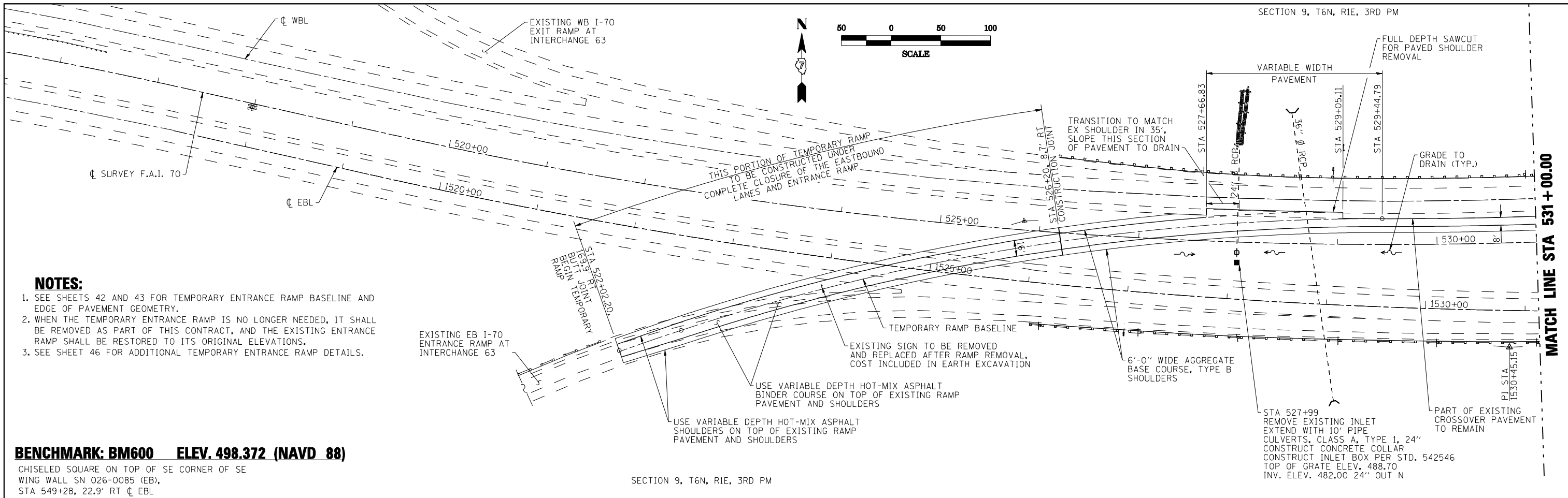

NOTES:

1. SEE SHEETS 42 AND 43 FOR TEMPORARY ENTRANCE RAMP BASELINE AND EDGE OF PAVEMENT GEOMETRY.
2. WHEN THE TEMPORARY ENTRANCE RAMP IS NO LONGER NEEDED, IT SHALL BE REMOVED AS PART OF THIS CONTRACT, AND THE EXISTING ENTRANCE RAMP SHALL BE RESTORED TO ITS ORIGINAL ELEVATIONS.
3. SEE SHEET 46 FOR ADDITIONAL TEMPORARY ENTRANCE RAMP DETAILS.

BENCHMARK: BM600 ELEV. 498.372 (NAVD 88)

CHISELED SQUARE ON TOP OF SE CORNER OF SE WING WALL SN 026-0085 (EB), STA 549+28, 22.9' RT ϕ EBL

PROFILE	SURVEYED	DATE
NOTE BOOK	PLOTTED	BY
NO.	GRADES CHECKED	
	STRUCTURE	
	NOT AT THIS OFFICE	

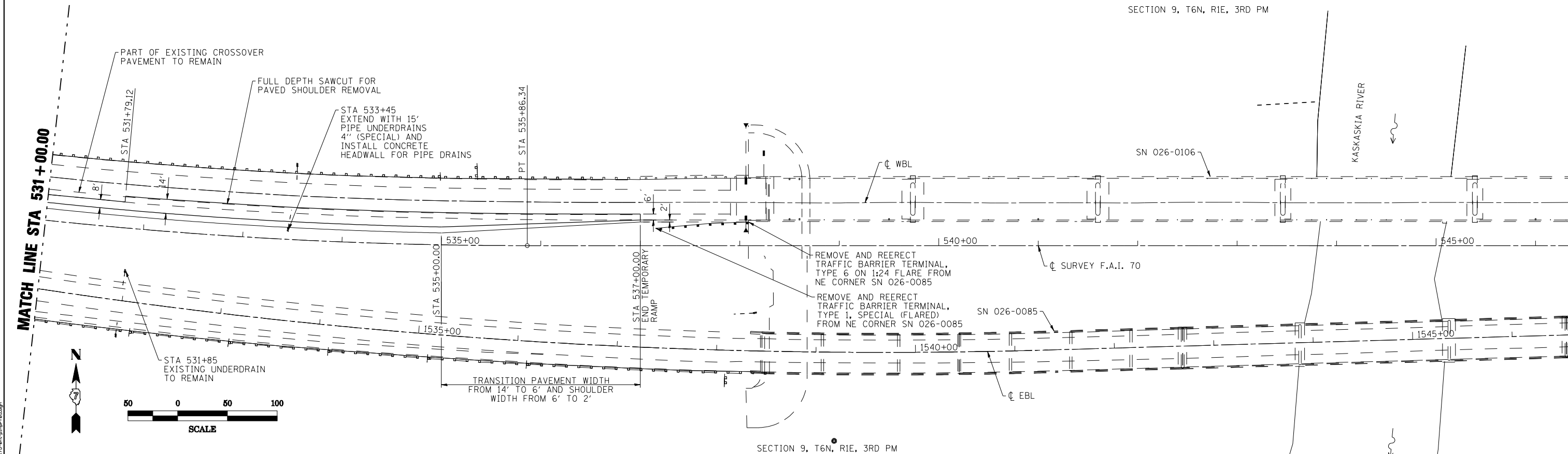

STATE OF ILLINOIS DEPARTMENT OF TRANSPORTATION

TEMPORARY ENTRANCE RAMP PLAN



USER NAME = has	DESIGNED - ELH	REVISED -
ESCA PROJECT NO. 1000.05	DRAWN - HAS	REVISED -
SCALEs: (HORIZ) 1"=50' (VERT) 1"=10'	CHECKED - ELH	REVISED -
PLOT DATE = 1/29/2014 1:53:55 PM	DATE - 11/13	REVISED -

SCALE: 1"=50' SHEET NO. 1 OF 2 SHEETS STA. 516+00.00 TO STA. 546+00.00

F.A.I. RTE. 70	SECTION (26-3B-1, 3B-1(3))BR	COUNTY FAYETTE	TOTAL SHEETS 277	SHEET NO. 40
CONTRACT NO. 74175			FED. ROAD DIST. NO. ILLINOIS FED. AID PROJECT AID	

PRINT DRIVER = L.D.L.B. & P.L. ESCA CONSULTANTS, INC. 1101 S. WASHINGTON ST. SUITE 200 ST. LOUIS, MO 63102
 PLOT DATE = 1/29/2014 1:53:55 PM