

**NOTES**

- For additional steel details, see sheets 62 thru 67 of 113.
- AASHTO M270 grade 50 steel shall be used for all flange plates, web plates, bearing stiffeners, and jacking stiffeners.
- Load carrying components designated "NTR" shall conform to the Impact Testing Requirement, Zone 2.
- All cross frames between girders shall be installed with erection pins and bolts in accordance with the erection plan approved by the Engineer. Individual cross frames at supports may be temporarily disconnected to install bearing anchor rods.
- All longitudinal dimensions shown are measured along the centerline of EBL & PGL. The centerlines of splices shall be located parallel to adjacent substructure elements in all spans.
- All bearing stiffeners shall be oriented to allow the End Cross Frames and Pier Cross Frames to be located along the skew and parallel to the substructure units.
- All connection plates for Interior Cross Frames shall be perpendicular to the girders. Interior Cross Frames shall be located radially within the horizontal curve limits. All other Interior Cross Frames shall be located perpendicular to the girders and staggered along the skew line. See detail on sheet 65 of 113.
- See sheet 61 of 113 for Curved Girder Layout.

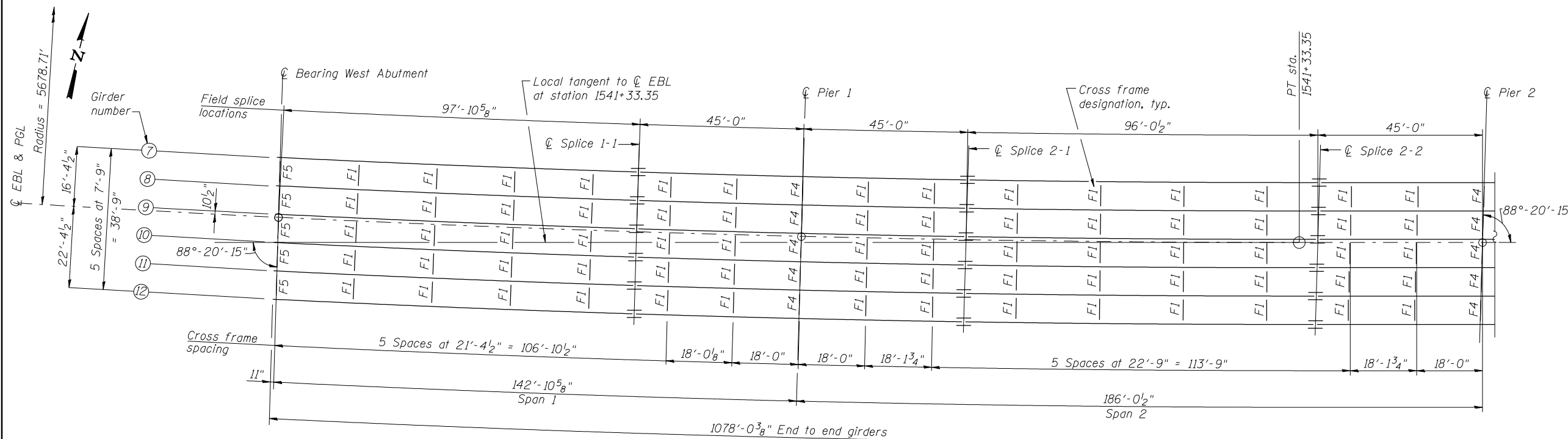

**FRAMING PLAN - SPANS 1 AND 2**

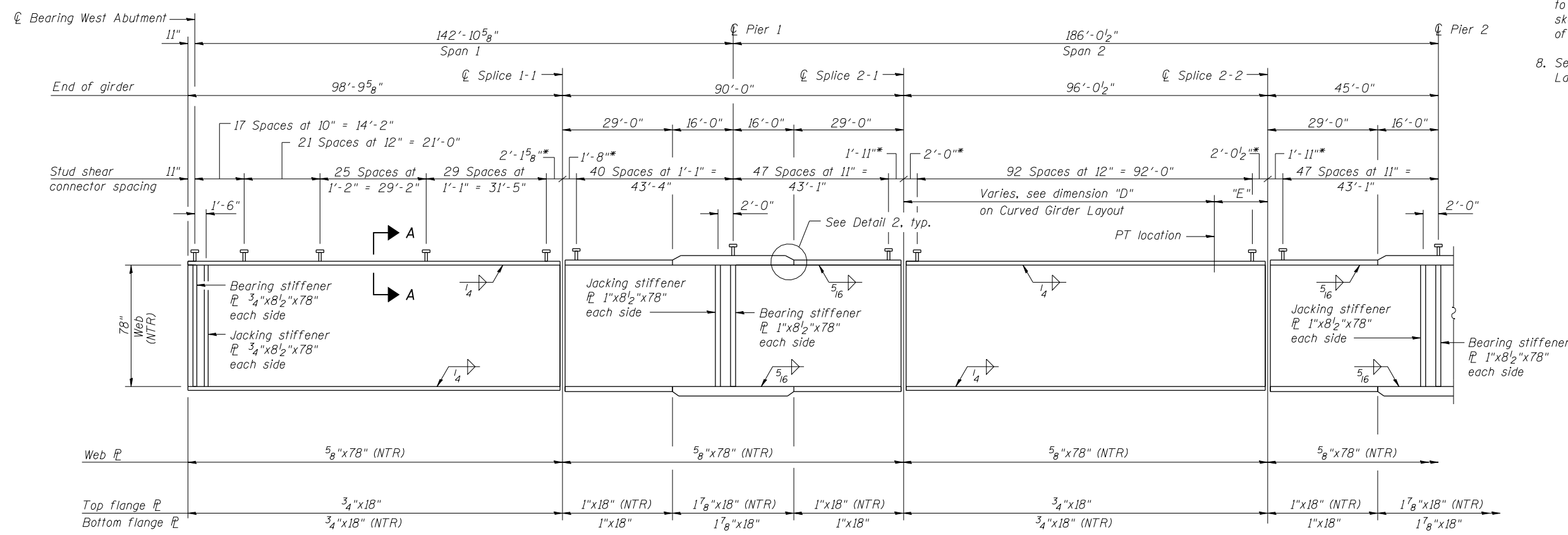

**GIRDER ELEVATION - SPANS 1 AND 2**

\*Omit shear connectors over splice



USER NAME = hos	DESIGNED - ELH 08/13	REVISED -
ESCA PROJECT NO. 1070.09	CHECKED - RDP 08/13	REVISED -
	DRAWN - DWH 08/13	REVISED -
PLOT DATE = 1/28/2014 1:22:36 PM	CHECKED - ELH 08/13	REVISED -

**STATE OF ILLINOIS  
DEPARTMENT OF TRANSPORTATION**

**STEEL FRAMING PLAN - EB  
STRUCTURE NO. 026-0107**

SHEET NO. 55 OF 113 SHEETS

F.A.I. RTE.	SECTION	COUNTY	TOTAL SHEETS	SHEET NO.
70	(26-3B-1, 3B-1(3))BR	FAYETTE	277	135
CONTRACT NO. 74175				
ILLINOIS FED. AID PROJECT				