

STATE OF ILLINOIS  
DEPARTMENT OF PUBLIC WORKS & BUILDINGS  
DIVISION OF HIGHWAYS

ROUTE NO.	SECTION	COUNTY	TOTAL SHEETS	SHEET NO.
70	26-3B-1(2)	FAYETTE	36	19
SHEET NO. 15 30 SHEETS				

**PILE DATA**

Type *Timber*  
Capacity *24 Tons*  
Est. Length *29'-0"*  
No. Req'd. *531* (Incl. 1 Test Pile)

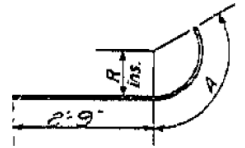
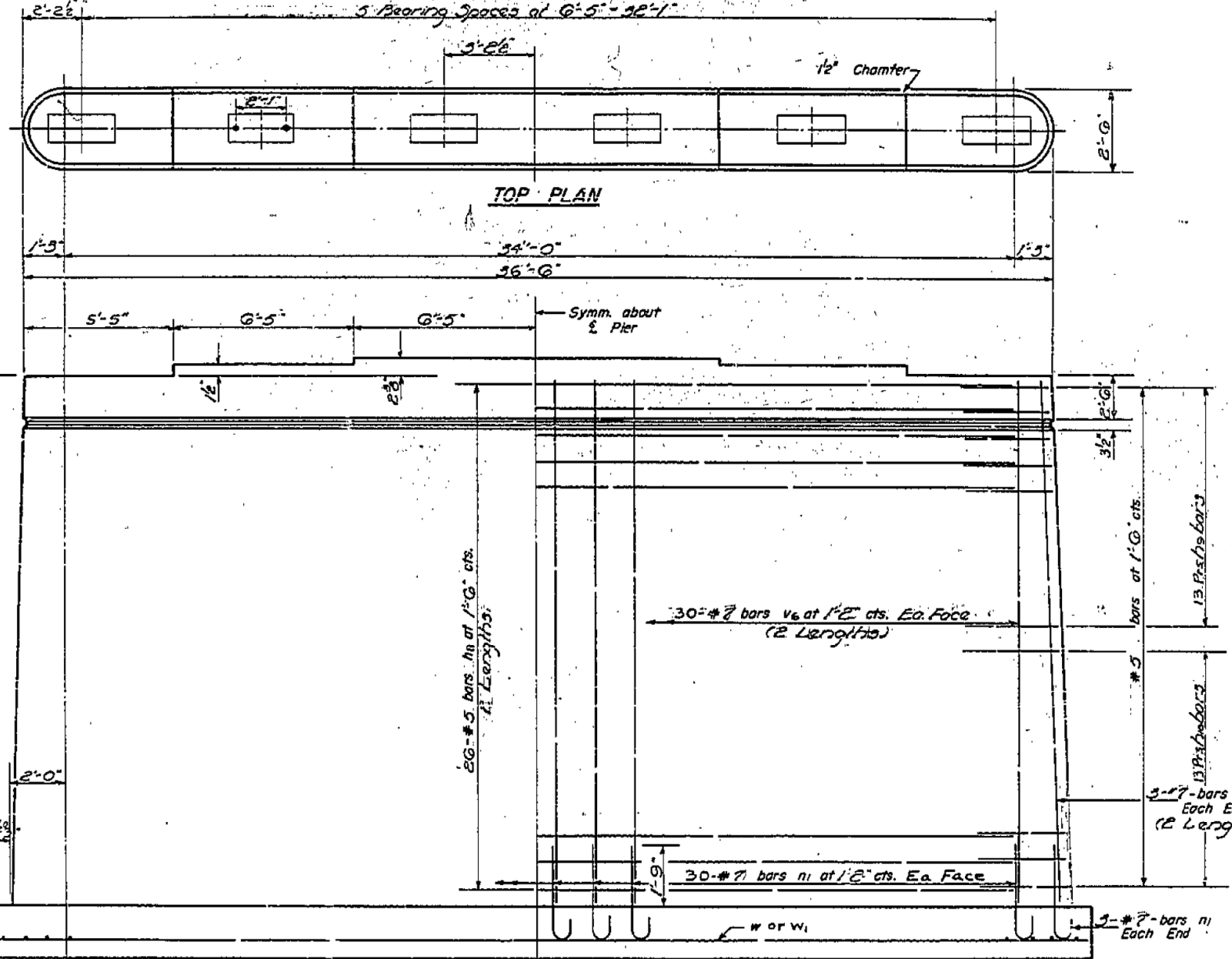
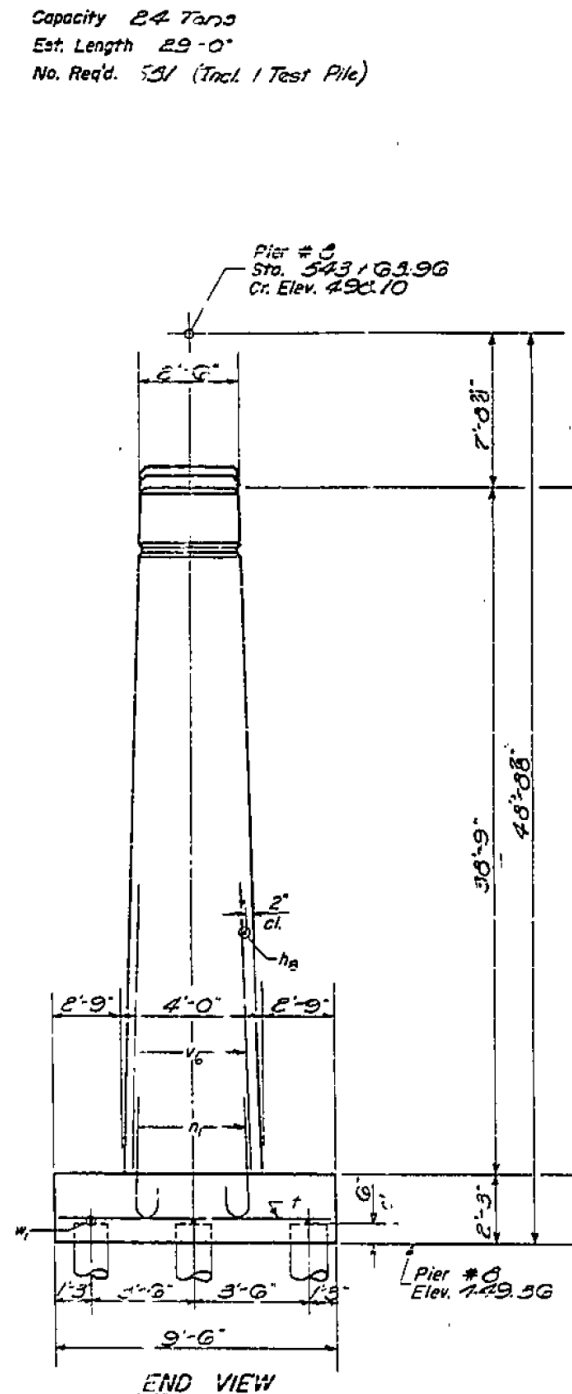

Bar	R	A
h <sub>2</sub>	1'-5"	2'-6"
h <sub>10</sub>	1'-7"	3'-1"

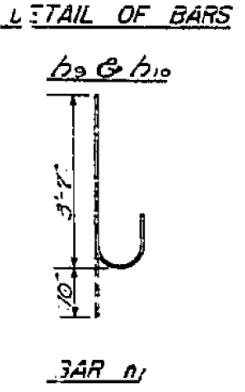

**BILL OF MATERIAL**

Bar	No.	Size	Length	Shape
h <sub>2</sub>	102	#5	7'-6"	—
h <sub>10</sub>	52	#5	5'-3"	—
h <sub>10</sub>	52	#5	5'-10"	—
n <sub>1</sub>	66	#7	4'-5"	C
t	51	#7	9'-0"	—
v <sub>6</sub>	132	#7	20'-0"	—
n <sub>1</sub>	14	#8	6'-0"	—
w <sub>1</sub>	6	#8	22'-0"	—

Class A Concrete	Cu. Yds.	203.0
Reinforcement Bars	Lbs.	10070
Timber Piles	Lin. Ft.	1450
Test Piles (Timber)	Each	1

**PIER #8**  
**F.A.I. RT. 70 - SEC. 26-3B-1(2)**  
**FAYETTE COUNTY**  
**STA. 544+27**

DESIGNED *R. X. Taylor*  
CHECKED *P. H. Johnson*  
EXAMINED *H. E. Baumann*  
PASSED *[Signature]*  
APPROVED *[Signature]*  
DATE: JUNE 6 1963

P-1 Re-drawn 7-21-59 Rev. 11-25-59



USER NAME = has	DESIGNED - ELH	REVISED -
ESCA PROJECT NO. 1000.05	DRAWN - HAS	REVISED -
PLOT SCALE = 0.1667' / IN.	CHECKED - RDP	REVISED -
PLOT DATE = 1/29/2014 2:08:52 PM	DATE - 08/13	REVISED -

STATE OF ILLINOIS  
DEPARTMENT OF TRANSPORTATION

STRUCTURE NO. 026-0018 EXISTING BRIDGE PLANS  
WB - FOR INFORMATION ONLY

SCALE: SHEET NO. 14 OF 28 SHEETS STA. TO STA.

F.A.I. RTE.	SECTION	COUNTY	TOTAL SHEETS	SHEET NO.
70	(26-3B-1, 3B-1(3))BR	FAYETTE	277	207
CONTRACT NO. 74175			FED. ROAD DIST. NO. ILLINOIS FED. AID PROJECT	