

DESIGNED R. K. Mathur

CHECKED James Pence

DRAWN R. P. S.

CHECKED JP

EXAMINED [Signature]

PASSED [Signature]

APPROVED [Signature]

DATE - 08/13

DETAIL OF PRECAST CONCRETE PILES

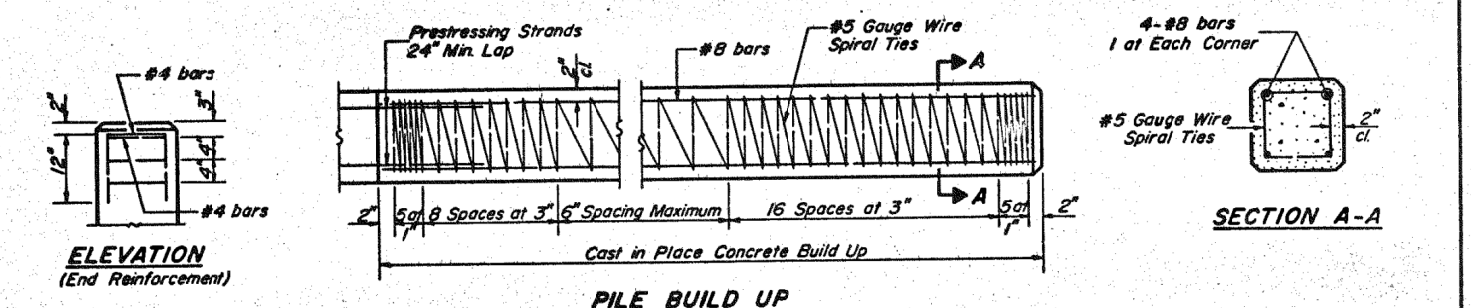
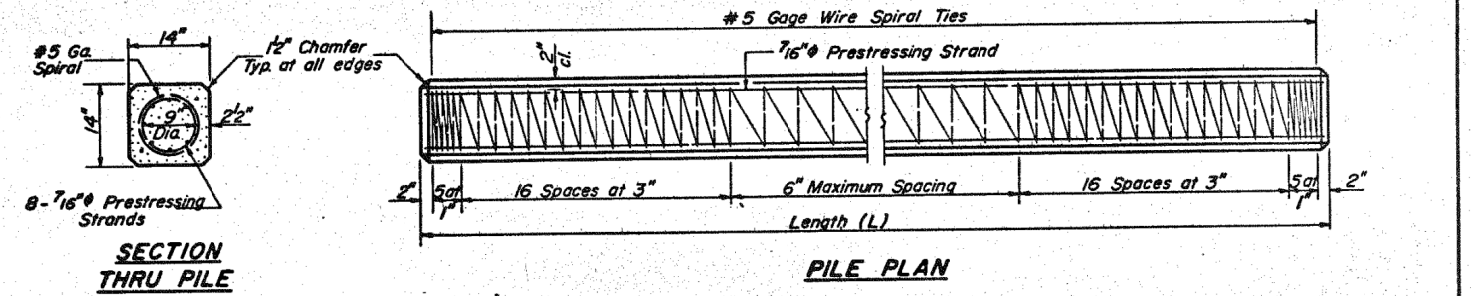

DESIGN STRESSES

f<sub>c</sub>' = 5,000 psi.

f<sub>t</sub>' = 4,000 psi.

f<sub>s</sub>' = 268,000 psi. (31,000 lbs.)

f<sub>s</sub>' = 188,000 psi. (21,700 lbs.)

Note: Prestressing steel shall be non-galvanized extra high strength stress-relieved 7 wire strand. The nominal diameter shall be 7/16" and the minimum nominal cross-sectional area shall be 0.1155 square inch.

Handling: For pile lengths up to 65', use two slings placed at a distance of 0.21L from each end. For piles longer than 65', use three slings placed at a distance of 0.12L from each end at midpoint of pile.

FILE DETAILS

F.A.I. RT70 SEC 26-3B-1(3) E.B.L.

FAYETTE COUNTY

STATION 543A+92.91

DETAIL OF PRECAST PRESTRESSED CONCRETE PILES

X-2 2-14-69



USER NAME = has	DESIGNED - ELH	REVISED -
ESCA PROJECT NO. 1000.05	DRAWN - HAS	REVISED -
PLOT SCALE = 0.1667' / IN.	CHECKED - RDP	REVISED -
PLOT DATE = 1/29/2014	DATE - 08/13	REVISED -