

FOR INFORMATION ONLY

STATE OF ILLINOIS  
DEPARTMENT OF TRANSPORTATION

ROUTE NO.	SECTION	COUNTY	TOTAL SHEETS	SHEET NO.
255	B2-7HB	St. Clair	83	55
SHEET NO. 41 69 SHEETS				

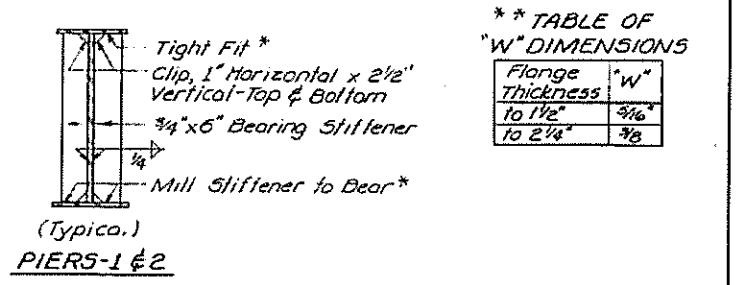
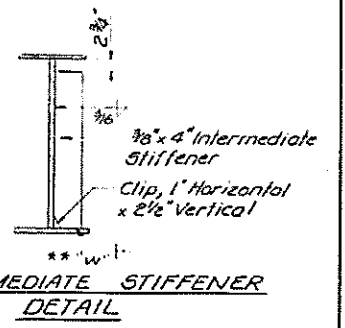
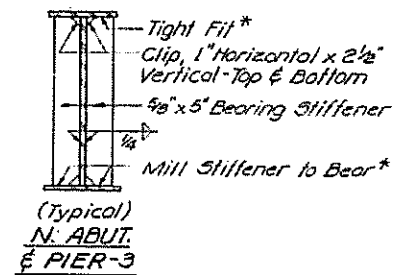
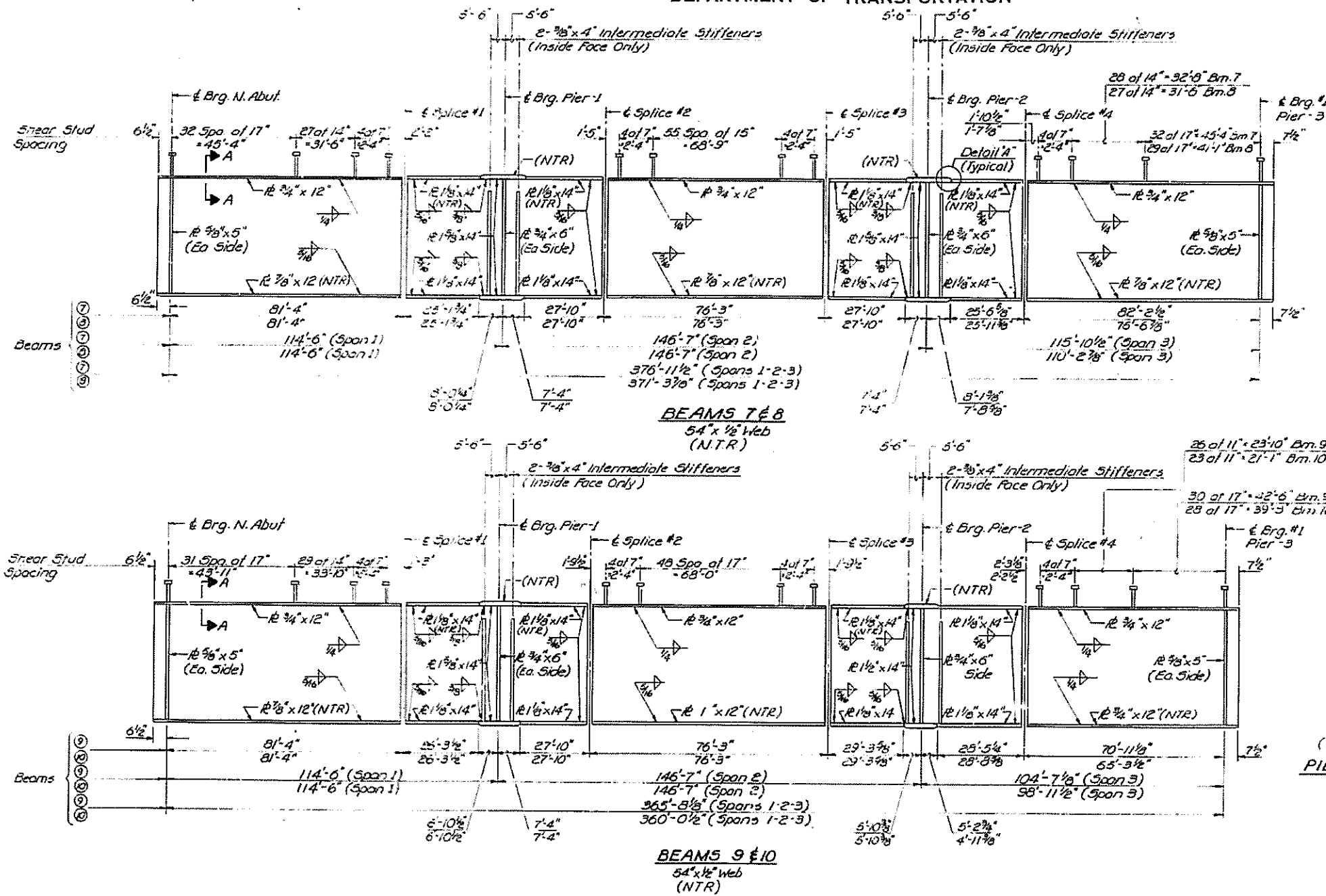

**GIRDER ELEVATIONS**  
UNIT #1 - RAMP-F (SPANS 1-2-3)  
(SHOWING BEAMS 7 THRU 10)

Note:  
NTR denotes steel that must conform to the Supplemental Requirements for Notch Toughness (Zone 2).  
All R Girder components shall be AASHTO M-223 Grade 50.

DESIGNED	Rich Brunette	EXAMINED	May 7 1981
CHECKED	DAJ KRUL	PASSED	
DRAWN	S.G. FERGHOW	APPROVED	
CHECKED	DK		

\* Except as noted on Sht. #45 (Cross frame details)

Notes:  
See Sheet #42 for Detail "A" and Section A-A

UNIT #1 RAMP-F  
STRUCTURAL STEEL  
SPAN 1 THRU 3  
F.A.I. RT. 270 SEC. 82-7HB  
ST. CLAIR COUNTY  
STATION 343+61.11