

INDEX OF SHEETS

1. COVER SHEET
2. GENERAL NOTES AND LEGEND
3. SUMMARY OF QUANTITIES
- 4.-6. TYPICAL SECTIONS
7. SCHEDULE OF QUANTITIES
8. ALIGNMENT, BENCHMARKS, AND TIES SHEET
9. TENNESSEE BLACKTOP (CH 11) COLD IN-PLACE RECYCLING
10. IL ROUTE 9 INTERSECTION STAGE CONSTRUCTION PLAN
11. IL ROUTE 9 INTERSECTION REMOVAL PLAN
12. IL ROUTE 9 INTERSECTION ROADWAY PLAN
13. IL ROUTE 9 INTERSECTION EROSION CONTROL PLAN
- 14.-15. IL ROUTE 9 INTERSECTION INTERSECTION GRADING AND JOINTING PLAN
- 16.-17. US ROUTE 136 INTERSECTION STAGE CONSTRUCTION PLAN
18. US ROUTE 136 INTERSECTION REMOVAL PLAN
19. US ROUTE 136 INTERSECTION ROADWAY PLAN
20. US ROUTE 136 INTERSECTION EROSION CONTROL PLAN
- 21.-22. US ROUTE 136 INTERSECTION GRADING AND JOINTING PLAN
23. GUTTER OUTLET SPECIAL DETAILS
24. OUTLET SPECIAL DETAILS
25. DRAINAGE STRUCTURE DETAILS
- 26.-29. IL ROUTE 9 INTERSECTION CROSS SECTIONS
- 30.-31. US ROUTE 136 INTERSECTION CROSS SECTIONS
- 32.-33. IDOT DISTRICT 4 STANDARD DETAILS

LIST OF STANDARDS

IDOT HIGHWAY STANDARDS

- 000001-06 STANDARD SYMBOLS, ABBREVIATIONS AND PATTERNS
- 280001-07 TEMPORARY EROSION CONTROL SYSTEMS
- 420001-07 PAVEMENT JOINTS
- 420101-04 JOINTED PCC PAVEMENT
- 602301-04 INLET TYPE A
- 602401-03 MANHOLE TYPE A
- 604001-03 FRAME AND LIDS TYPE 1
- 604036-02 GRATE TYPE B
- 606001-05 CONCRETE CURB TYPE B AND COMBINATION CONCRETE CURB AND GUTTER
- 701006-05 OFF-ROAD OPERATIONS, 2L, 2W, 15' TO 24" FROM PAVEMENT EDGE
- 701306-03 LANE CLOSURE, 2L, 2W, SLOW MOVING OPERATIONS DAY ONLY, FOR SPEEDS > 45 MPH
- 701701-09 URBAN LANE CLOSURE, MULTILANE INTERSECTION
- 701901-03 TRAFFIC CONTROL DEVICES
- 720001-01 SIGN PANEL MOUNTING DETAILS
- 720006-04 SIGN PANEL ERECTION DETAILS
- 780001-04 TYPICAL PAVEMENT MARKINGS
- BLR 22-7 TYPICAL APPLICATIONS OF TRAFFIC CONTROL DEVICES FOR CONSTRUCTION ON RURAL LOCAL HIGHWAYS (TWO-LANE TWO WAY RURAL TRAFFIC) (ROAD CLOSED TO THRU TRAFFIC)

IDOT DISTRICT 4 STANDARDS

- 780001-D4 TYPICAL PAVEMENT MARKINGS

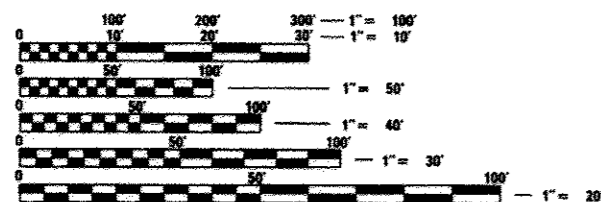

FULL SIZE PLANS HAVE BEEN PREPARED USING STANDARD ENGINEERING SCALES. REDUCED SIZED PLANS WILL NOT CONFORM TO STANDARD SCALES. IN MAKING MEASUREMENTS ON REDUCED PLANS, THE ABOVE SCALES MAY BE USED.

CAT # 034695-00
CONTRACT NO. 89607

J.U.L.I.E.
JOINT UTILITY LOCATION INFORMATION FOR EXCAVATION
1-800-492-0123
OR 811

STATE OF ILLINOIS
DEPARTMENT OF TRANSPORTATION
DIVISION OF HIGHWAYS

TENNESSEE BLACKTOP (CH 11)
ROADWAY IMPROVEMENTS

FAS 1434 (TENNESSEE BLACKTOP)
SECTION 11-00101-00-RS
PROJECT NO. RS 1434 (106)
McDONOUGH COUNTY
C-94-081-11

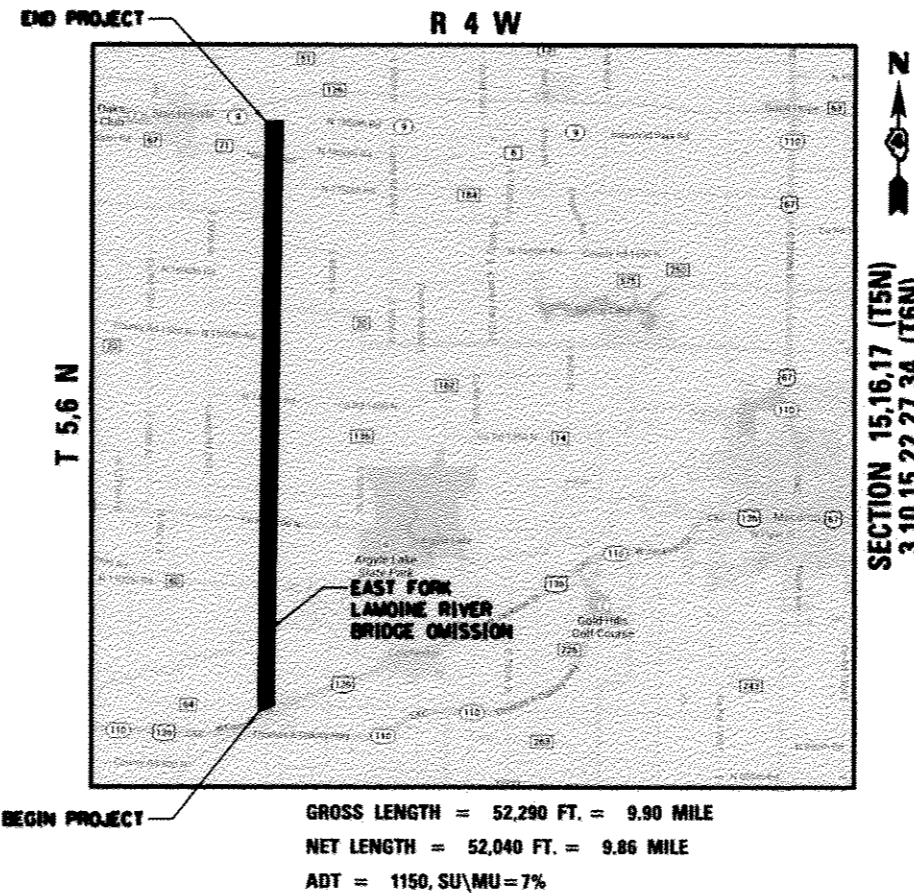

GROSS LENGTH = 52,290 FT. = 9.90 MILE
NET LENGTH = 52,040 FT. = 9.86 MILE
ADT = 1150, SU\MU=7%

SECTION 15,16,17 (T5N)
3,10,15,22,27,34 (T6N)

ILLINOIS PROFESSIONAL ENGINEER
MATTHEW P. JENSEN
11-057939
DATE SIGNED: 1/21/14
LIC. EXP. DATE: 11/30/2015
EXCLUDES COLD IN-PLACE RECYCLING SHOWN ON SHEETS 4 AND 9 ALONG WITH ASSOCIATED QUANTITIES AND SPECIAL PROVISIONS.

ILLINOIS PROFESSIONAL ENGINEER
ROBERT J. HICKEY
05-05128
DATE SIGNED: 1/22/14
LIC. EXP. DATE: 11/30/2015
COLD IN-PLACE RECYCLING, SHEETS 4 AND 9 ALONG WITH ASSOCIATED QUANTITIES AND SPECIAL PROVISIONS.

APPROVED: *Robert J. Hickey* 20 14
McDONOUGH COUNTY ENGINEER

PASSED: *John J. ...* 20 14
DISTRICT FOUR ENGINEER OF LOCAL ROADS & STREETS

Releasing For Bid Based on Limited Review: *Jan 27* 20 14
DEPUTY DIRECTOR OF HIGHWAYS, REGION THREE ENGINEER

STATE OF ILLINOIS
DEPARTMENT OF TRANSPORTATION

DATE: 1/21/14
© Copyright Hanson Professional Services Inc. 2014
HANSON
Hanson Professional Services Inc.
7625 N. University St., Suite 200
Peoria, Illinois 61614
Offices Nationwide

F.A.S. RTE.	SECTION	COUNTY	TOTAL SHEETS	SHEET NO.
1434	11-00101-00-RS	McDONOUGH	33	1



LOCATION OF SECTION INDICATED THUS: - [black rectangle] -