



STRUCTURE NUMBER	STATION	OFFSET	TYPE	RIM ELEVATION	INVERT ELEVATIONS			
					N	S	E	W
S100	30+35.24	29.22	RT	686.94	681.50 EX	681.48 EX	683.84	683.50
S101	30+42.92	47.49	RT	686.55	-	-	-	684.00
S102	30+50.51	22.09	LT	686.56	-	-	684.00	-

PIPE NUMBER	FROM STRUCTURE	U/S INVERT	TO STRUCTURE	D/S INVERT	CLASS/TYPE	DIAMETER	LENGTH	SLOPE	AVG. DEPTH	T.B. FACTOR	TRENCH BACKFILL
P102	S102	684.00	S100	683.50	STORM SEWERS, CLASS A, TYPE 1	12	50.5	0.99%	3.00	0.152	7.7

LEGEND

-  SEEDING (COMPLETE)
MULCH
-  PERIMETER EROSION BARRIER
-  INLET FILTERS

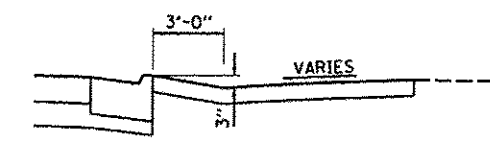

SECTION A-A

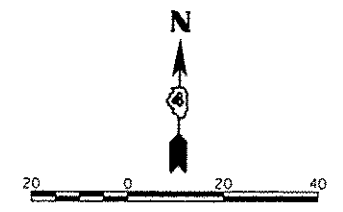
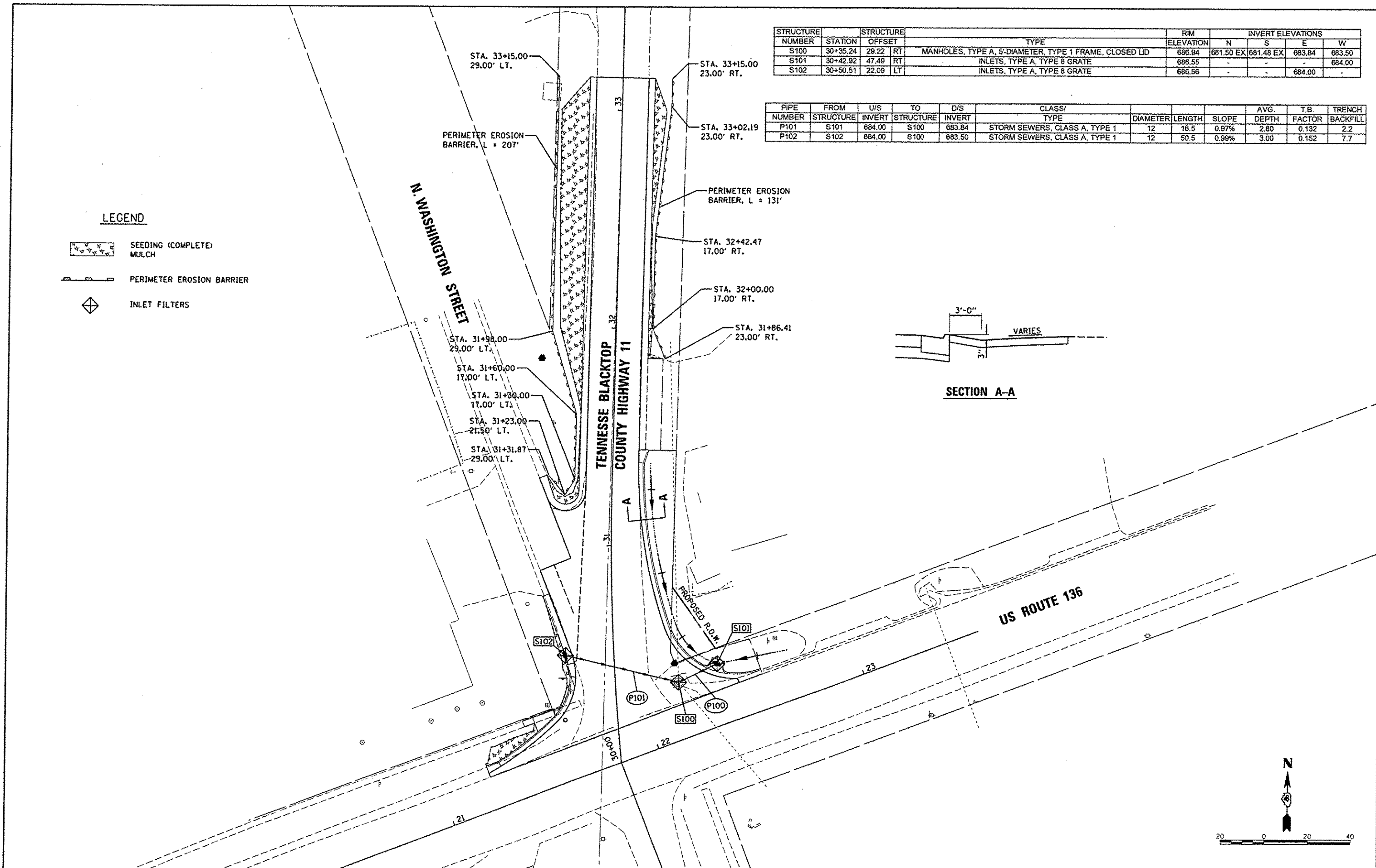

LAYOUT	9/25/2013
DRAWN	1/17/2014
REVIEWED	1/20/2014

FILE NAME =	USER NAME = mansk01398	DESIGNED - MGD	REVISED -	STATE OF ILLINOIS DEPARTMENT OF TRANSPORTATION	TENNESSEE BLACKTOP (CH 11) & US ROUTE 136 INTERSECTION DRAINAGE & EROSION CONTROL PLAN	F.A.S. RTE.	SECTION	COUNTY	TOTAL SHEETS	SHEET NO.
IN:\Jobs\1118161\CAD\Road\Sheet\c-1020.dgn	DRAWN - RLA	REVISED -	1434			11-00101-00-RS	McDONOUGH	33	20	
PLOT SCALE = 3/9,9999 1/16" = 1'	CHECKED - KNB	REVISED -	CONTRACT NO. 89607							
PLOT DATE = 8/1/2014	DATE - 1/21/2014	REVISED -	ILLINOIS FED. AID PROJECT RS 1434 (106)							