

ROUTE NO	SECTION	COUNTY	TOTAL SHEETS	THIS SHEET
LOCAL STREET	*	TAZEWELL	23	9

FED. RD. DIST. NO. 7 ILLINOIS PROJECT  
12-00112-00-SW  
CONTRACT NO. 89623

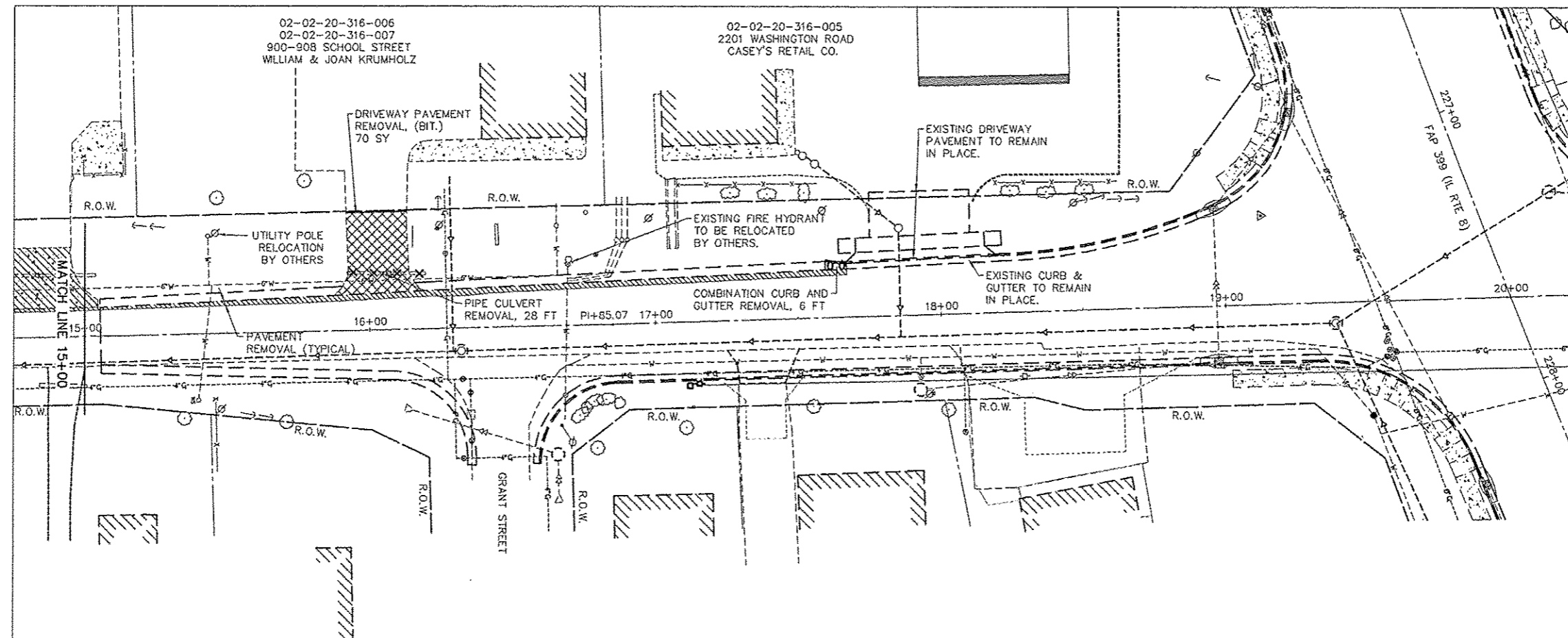

**44000100 PAVEMENT REMOVAL**

LOCATION	QUANTITY
LT. STA. 10+55.2 TO LT. STA. 11+17.8	33 SQ.YD.
LT. STA. 11+17.8 TO LT. STA. 12+40.1	40 SQ.YD.
LT. STA. 12+40.1 TO LT. STA. 15+05.6	31 SQ.YD.
LT. STA. 15+05.6 TO LT. STA. 17+65.9	54 SQ.YD.
<b>PROJECT TOTAL</b>	<b>158 SQ.YD.</b>

**44000200 DRIVEWAY PAVEMENT REMOVAL**

LOCATION	QUANTITY
LT. STA. 11+38.0 TO LT. STA. 11+78.4 (BIT.)	54 SQ.YD.
LT. STA. 11+91.5 TO LT. STA. 12+39.8 (BIT.)	57 SQ.YD.
LT. STA. 13+10.7 TO LT. STA. 13+36.4 (BIT.)	36 SQ.YD.
LT. STA. 14+63.9 TO LT. STA. 15+04.9 (CONC.)	69 SQ.YD.
LT. STA. 15+87.5 TO LT. STA. 16+18.3 (BIT.)	70 SQ.YD.
<b>PROJECT TOTAL</b>	<b>286 SQ.YD.</b>

**50105220 PIPE CULVERT REMOVAL**

LOCATION	QUANTITY
LT. STA. 11+42.0 TO LT. STA. 11+78.4	36 FT
LT. STA. 11+94.9 TO LT. STA. 12+30.2	35
LT. STA. 13+14.3 TO LT. STA. 13+30.0	16
LT. STA. 13+75.2	9
LT. STA. 14+64.2 TO LT. STA. 15+04.3	40
LT. STA. 15+92.5 TO LT. STA. 16+19.9	28
<b>PROJECT TOTAL</b>	<b>164 FT</b>

**55100500 STORM SEWER REMOVAL, 12"**

LOCATION	QUANTITY
LT. STA. 10+60.0 TO LT. STA. 11+41.0	81 FT
<b>PROJECT TOTAL</b>	<b>81 FT</b>

**60500060 REMOVING INLETS**

LOCATION	QUANTITY
LT. STA. 10+58.2	1 EA
<b>PROJECT TOTAL</b>	<b>1 EA</b>

**44000500 COMBINATION CURB & GUTTER REMOVAL**

LOCATION	QUANTITY
LT. STA. 10+53.2 TO LT. STA. 10+63.2	7 FT
LT. STA. 11+19.6 TO LT. STA. 11+38.7	23
LT. STA. 17+60.0 TO LT. STA. 17+65.9	6
<b>PROJECT TOTAL</b>	<b>36 FT</b>

**20100110 TREE REMOVAL (8 TO 15 UNITS DIAMETER)**

LOCATION	QUANTITY
31.4' LT. STA. 14+12.8	12 UNITS
<b>PROJECT TOTAL</b>	<b>12 UNITS</b>

**20100210 TREE REMOVAL (OVER 15 UNITS DIAMETER)**

LOCATION	QUANTITY
29.8' LT. STA. 13+98.6	36 UNITS
28.5' LT. STA. 14+06.9	24
27.6' LT. STA. 14+35.3	18
<b>PROJECT TOTAL</b>	<b>78 UNITS</b>



**LEGEND**

- DRIVEWAY PAVEMENT REMOVAL - BITUMINOUS
- DRIVEWAY PAVEMENT REMOVAL - CONCRETE
- BITUMINOUS PAVEMENT REMOVAL
- CULVERT OR STORM SEWER REMOVAL
- COMB. CURB AND GUTTER REMOVAL
- TREE REMOVAL

REMOVAL PLAN - 15+00 TO 20+00 BEVERLY MANOR SCHOOL SIDEWALK		AUSTIN ENGINEERING CO., INC. CIVIL ENGINEERS	
FOR: CITY OF WASHINGTON	DATE: 12/19/13	PROJECT NO. 12-00112-00-SW	ILLINOIS LICENSE NO. 184-001143
		PROJECT NO. 12-00112-00-SW	ILLINOIS SHEET NO. 9 OF 23