

STATE OF ILLINOIS
DEPARTMENT OF TRANSPORTATION
DIVISION OF HIGHWAYS
**PLANS FOR
SAFE ROUTE TO SCHOOLS
CITY OF ELMWOOD, IL**

MAIN ST., ALTHEA ST., MORGAN ST.,
ASH ST., MAGNOLIA ST., FREMONT ST., AND BUTTERNUT ST.

COUNTY OF PEORIA, ILLINOIS
SECTION 12-00003-00-SW
FEDERAL PROJECT NO. SRTS-4009(266)
JOB NO. C-94-013-14
CITY OF ELMWOOD

F.A. ROUTE	SECTION	COUNTY	TOTAL SHEETS	SHEET NO.
	12-00003-00-SW	PEORIA	16	1
FEDERAL NO. SRTS - 4009(266) ILLINOIS		CONTRACT NO. 89651		

INDEX OF SHEETS

- 1 COVER SHEET
- 2 TYPICAL SECTIONS
- 3 SCHEDULES OF QUANTITIES
- 4 SUMMARY OF QUANTITIES AND GENERAL NOTES
- 5 PLAN VIEW - ALTHEA ST. STA. 24+50 TO STA. 36+00
- 6 PLAN VIEW - ALTHEA ST. STA. 36+00 TO STA. 43+00
- 7 ALTHEA ST. INTERSECTION DETAILS
- 8 PLAN VIEW AND INTERSECTION DETAIL - MORGAN ST.
- 9 PLAN VIEW AND INTERSECTION DETAIL - MAIN ST.
- 10 PLAN VIEW AND INTERSECTION DETAIL - ASH ST.
- 11 **URBAN ENTRANCES, ACCESSIBLE TO THE DISABLED FOR CURBLINE SIDEWALKS**
- 13 **URBAN ENTRANCES, ACCESSIBLE TO THE DISABLED FOR SEPARATED SIDEWALKS**
- 15 **TYPICAL PAVEMENT MARKINGS**

- 000001-06 STANDARD SYMBOLS, ABBREVIATIONS AND PATTERNS
- 424001-07 PERPENDICULAR CURB RAMPS FOR SIDEWALKS
- 424006-01 DIAGONAL CURB RAMPS FOR SIDEWALKS
- 424011-01 CORNER PARALLEL CURB RAMPS FOR SIDEWALKS
- 424016-01 MID-BLOCK CURB RAMPS FOR SIDEWALKS
- 606001-05 COMB. CURB TYPE B & COMB. CONCRETE CURB AND GUTTER
- 701301-04 LANE CLOSURE, 2L, 2W, SHORT TIME OPERATIONS
- 701501-06 URBAN LANE CLOSURE, 2L, 2W, UNDIVIDED
- 701801-05 SIDEWALK, CORNER OR CROSSWALK CLOSURE
- 701901-03 TRAFFIC CONTROL DEVICES
- 720006-04 SIGN PANEL ERECTION DETAILS
- 720011-01 METAL POST FOR SIGNS, MARKERS AND DELINEATORS
- 728001-01 TELESCOPING STEEL SIGN SUPPORT
- 729001-01 APPLICATIONS OF TYPES A & B METAL POSTS

B.L.R. 18-5 DAY LABOR MAINTENANCE

SCALES

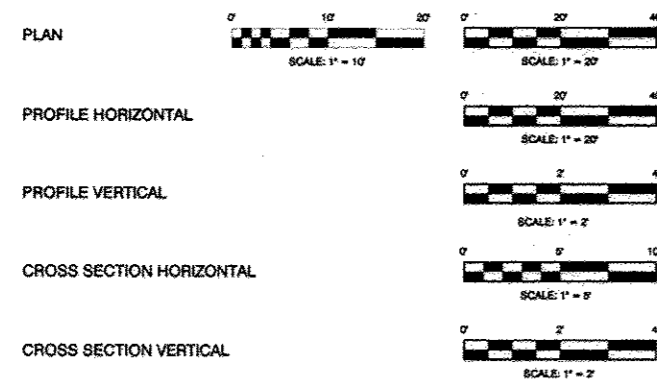

LOCATION OF PROPOSED IMPROVEMENT



LOCATION SKETCH
N.T.S.
CITY OF ELMWOOD

GROSS LENGTH OF PROJECT: = 1,850 FOOT
ALTERNATE GROSS LENGTH OF PROJECT: 142 FOOT

APPROVED 2/5/14 2014
LOCAL AGENCY OFFICIAL

PASSED 02-27 2014
DISTRICT 4 ENGINEER OF LOCAL ROADS & STREETS

RELEASING FOR BID BASED ON LIMITED REVIEW
FEB 24 2014
DEPUTY DIRECTOR OF HIGHWAY REGION THREE ENGINEER
STATE OF ILLINOIS DEPARTMENT OF TRANSPORTATION

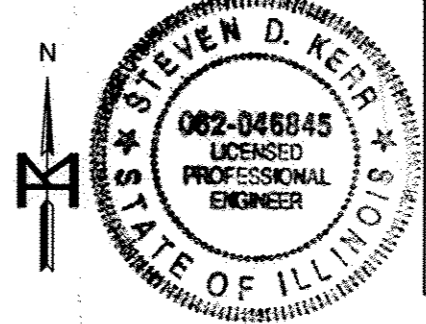

Steven D. Kerr 2/5/14
DATE: 2/5/14
STEVEN D KERR, P.E.
ILLINOIS REGISTRATION 062-046845
EXPIRES 11/30/15

NEW IMPROVEMENT CONSISTS OF CONSTRUCTING P.C.C. SIDEWALK, 4", P.C.C. DRIVEWAY PAVEMENT, PATCHING AND SEEDING.

JULIE LOCATION
CALL JULIE 1-800-892-0123 48 HOURS BEFORE YOU DIG EXCLUDING SATURDAYS, SUNDAYS, AND HOLIDAYS

CONTRACT NO. 89651
CATALOG NO. 03803-00P

M MOHR & KERR ENGINEERING & LAND SURVEYING, P.C.
7336 N. University Ave. Office: (309) 692-8500
Peoria, Illinois 61614 Fax: (309) 692-8501
www.mohrandkerr.com Professional Design Firm #184.005091

PROJECT NO. 12-168
SHEET 1 OF 16
DRAWING NO. 1

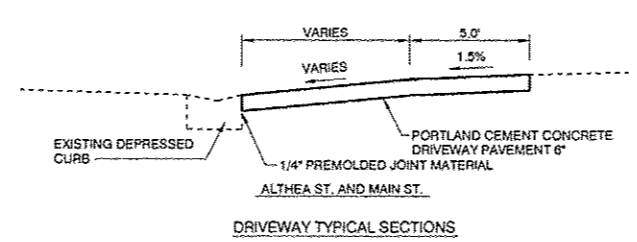
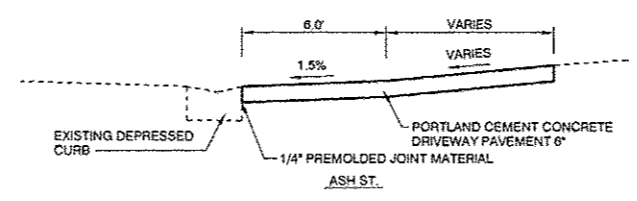
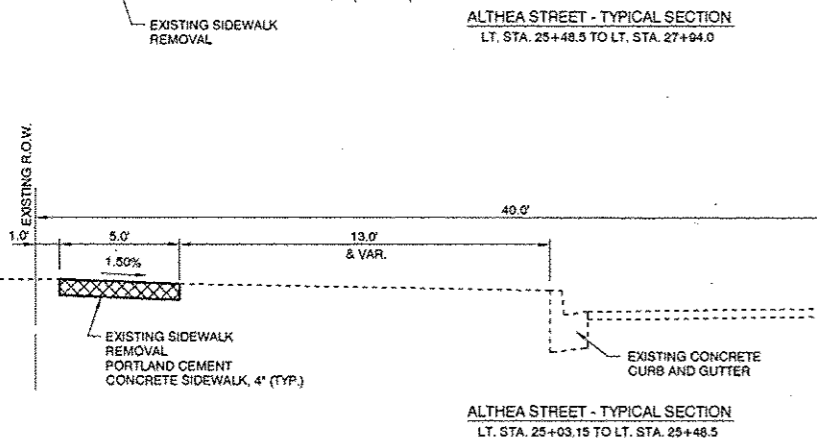
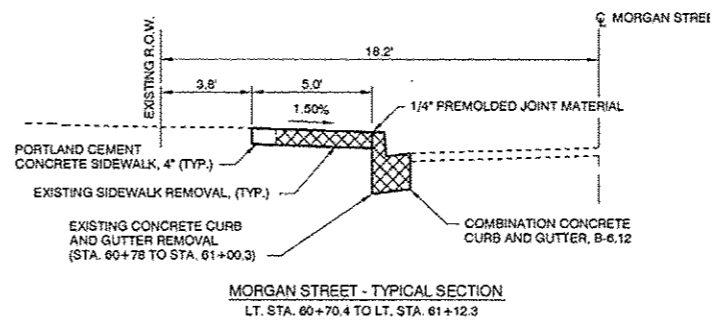
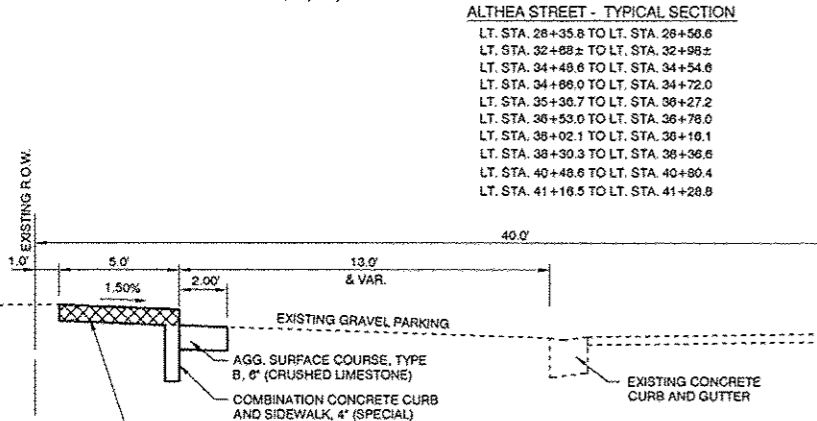
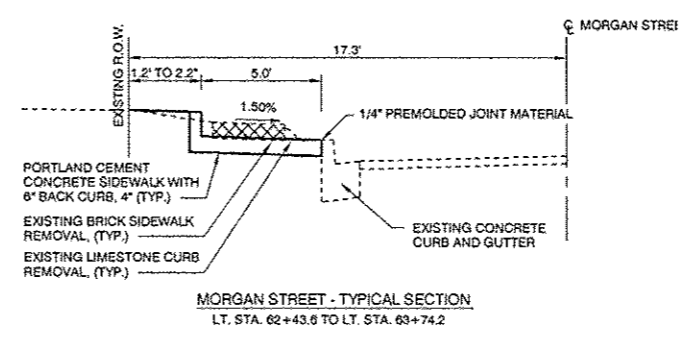
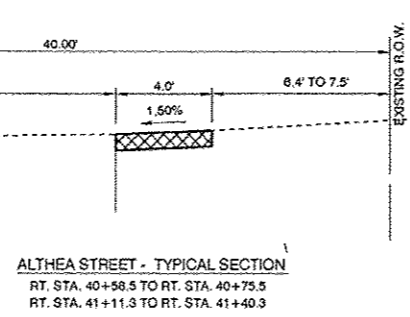
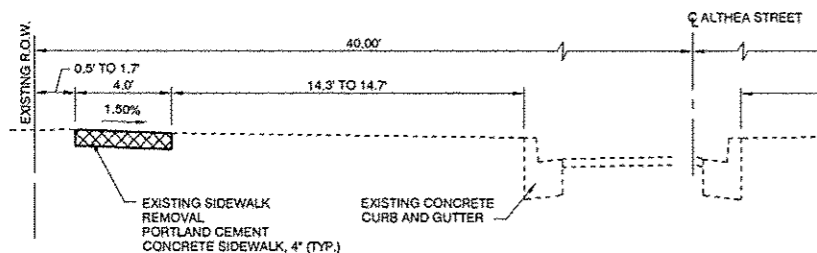
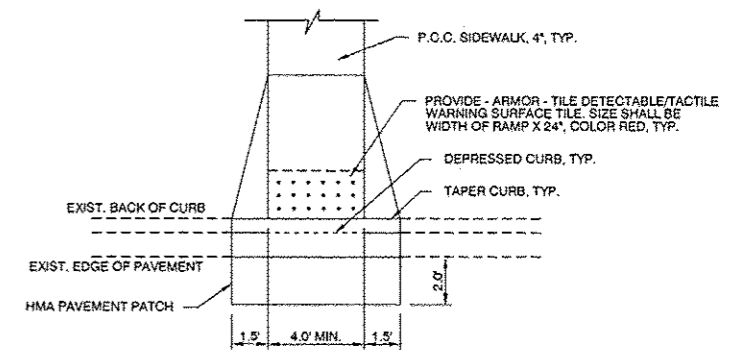
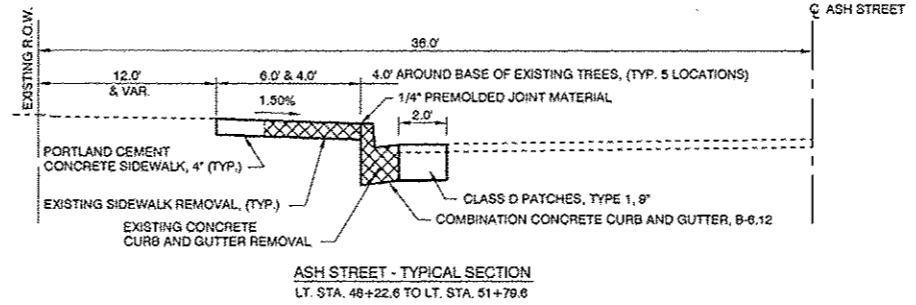
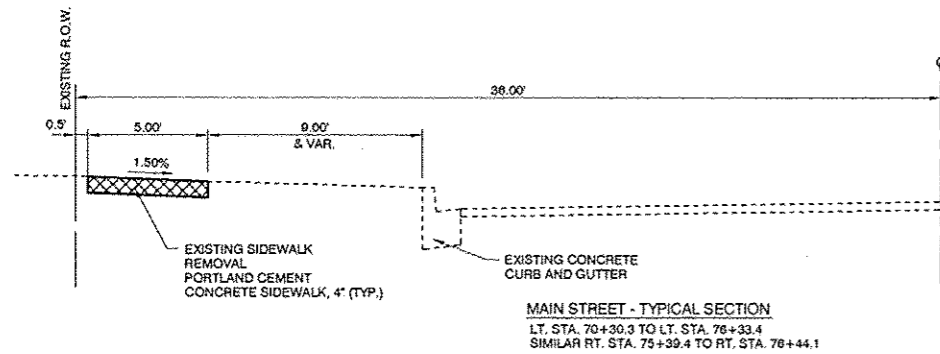

MIXTURE REQUIREMENTS	
MIXTURE USE(S)	HMA SURFACE: MAINLINE, ENTRANCES, PAVEMENT PATCH, 6"
RAP % (MAX)	15%
AGPG	PG 64-22
DESIGN AIR Voids	4.0% @ N _{99.9} = 50
MIXTURE COMPOSITION (GRADATION MIXTURE)	IL 0.5 OR IL 12.5
FRICION AGGREGATE	MIXTURE D

NOTES: INDIVIDUAL LIFT THICKNESS OF EACH MIX TYPE WILL BE NO LESS THAN 3 TIMES NOMINAL MAXIMUM AGGREGATE SIZE AND NO MORE THAN 8 TIMES NOMINAL MAXIMUM AGGREGATE SIZE.

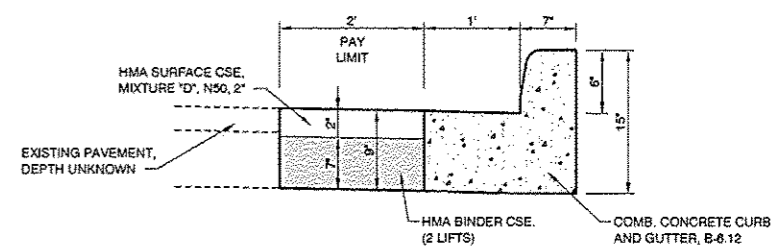

CLASS D PATCHES, TYPE I, 9"
 NOT TO SCALE

NOTE: PAVEMENT REMOVAL INCLUDED IN CLASS D PATCHES.

NOTE: DEPRESS CURBS AT RAMPS, DRIVEWAYS AND ENTRANCES.

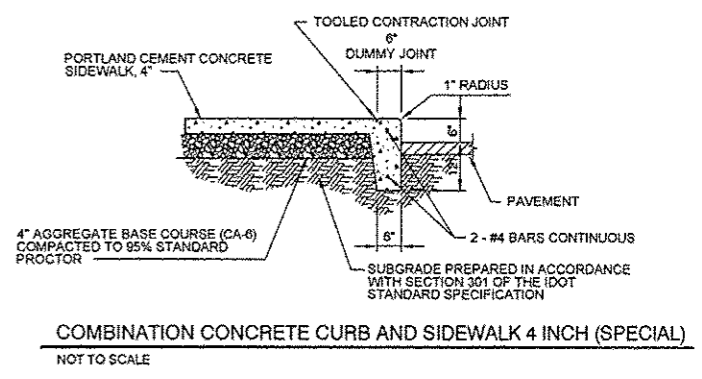
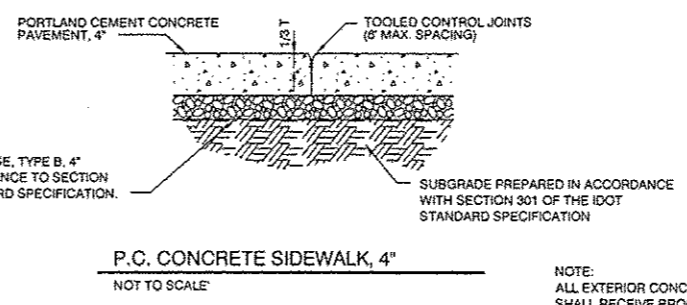
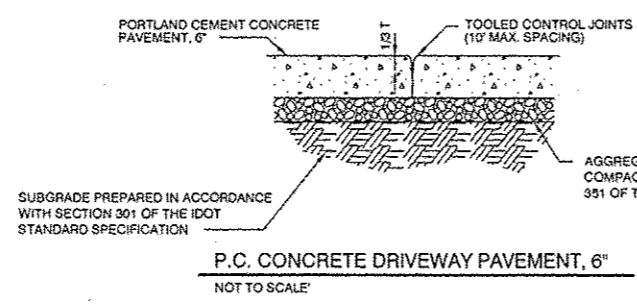

NOTE: ALL EXTERIOR CONCRETE SURFACES SHALL RECEIVE BROOM FINISH FOR SLIP RESISTANCE.

P:\112-108-00\DWG\2-TYP_SECTIONS_12-108.dwg Feb 24, 2014

M MOHR & KERR ENGINEERING & LAND SURVEYING, P.C.
 720 N. University Ave. Peoria, Illinois 61614
 Phone: (309) 692-8000 Fax: (309) 692-8001
 www.mohr-kerr.com Professional Design Firm #164-000291

P:\112-108-00\DWG\2-TYP_SECTIONS_12-108.dwg	DESIGNED SDK	REVISED
	DRAWN MHD/K	REVISED
PLOT SCALE: 1" = 2'	CHECKED SDK	REVISED
Feb 24, 2014	DATE 02-24-14	REVISED

STATE OF ILLINOIS
 DEPARTMENT OF TRANSPORTATION

SAFE ROUTE TO SCHOOL - CITY OF ELMWOOD, IL	
TYPICAL SECTIONS	
SCALE:	SHEET NO. 2 OF 10 SHEETS
STA. _____	TO STA. _____

F.A. ROUTE	SECTION	COUNTY	TOTAL SHEETS	SHEET NO.
---	12-00003-00-SW	PEORIA	16	2
FED PROJ. NO. SRTS-4009(266)		CONTRACT NO. 89651		
ILLINOIS FEDERAL ROAD DIST NO. 4				

SIDEWALK SCHEDULE				
LOCATION	P.C.C. SIDEWALK, 4" (S.F.)	SIDEWALK REMOVAL (S.F.)		
ALTHEA ST.				
LT. STA. 25+03.15 TO LT. STA. 25+48.5	227	227		
LT. STA. 25+48.5 TO LT. STA. 27+94.0	0	1,150		
LT. STA. 28+35.8 TO LT. STA. 29+56.6	108	92		
LT. STA. 32+68.0 TO LT. STA. 32+68.0	120	120		
LT. STA. 34+48.6 TO LT. STA. 34+54.6	24	24		
LT. STA. 34+68.0 TO LT. STA. 34+72.0	24	24		
LT. STA. 35+36.7 TO LT. STA. 36+27.2	384	377		
LT. STA. 36+53.0 TO LT. STA. 36+76.0	132	125		
LT. STA. 38+02.1 TO LT. STA. 38+16.1	61	36		
LT. STA. 38+30.3 TO LT. STA. 38+36.6	21	21		
LT. STA. 40+48.6 TO LT. STA. 40+40.4	113	113		
RT. STA. 40+58.5 TO RT. STA. 40+75.5	77	66		
RT. STA. 41+11.3 TO RT. STA. 41+46.3	382	250		
LT. STA. 41+16.5 TO LT. STA. 41+28.8	160	49		
MORGAN ST.				
LT. STA. 60+70.8 TO LT. STA. 61+12.3	207	163		
LT. STA. 62+43.6 TO LT. STA. 63+74.2	787	437		
MAIN ST.				
LT. STA. 70+30.3 TO LT. STA. 71+24.5	572	519		
LT. STA. 71+45.2 TO LT. STA. 72+66.7	269	263		
LT. STA. 72+07.0 TO LT. STA. 72+23.2	58	70		
LT. STA. 72+33.2 TO LT. STA. 72+81.5	275	251		
LT. STA. 72+94.0 TO LT. STA. 72+42.0	258	241		
LT. STA. 73+51.9 TO LT. STA. 75+71.4	1242	1109		
RT. STA. 75+39.5 TO RT. STA. 75+71.9	249	249		
LT. STA. 76+09.8 TO LT. STA. 76+33.4	149	139		
RT. STA. 76+08.2 TO RT. STA. 76+44.1	120	170		
ASH ST.				
LT. STA. 48+22.6 TO LT. STA. 49+43.5	0	503		
LT. STA. 49+49.0 TO LT. STA. 49+56.8	37	0		
LT. STA. 49+84.7 TO LT. STA. 49+94.4	288	0		
LT. STA. 49+96.5 TO LT. STA. 50+28.3	0	332		
LT. STA. 49+65.5 TO LT. STA. 50+30.9	368	0		
LT. STA. 50+53.9 TO LT. STA. 51+49.4	0	397		
LT. STA. 50+60.9 TO LT. STA. 51+41.8	470	0		
LT. STA. 51+64.4 TO LT. STA. 51+80.7	0	131		
LT. STA. 51+65.7 TO LT. STA. 51+80.7	162	0		
LT. STA. 52+25.3 TO LT. STA. 52+46.1	169	149		
RT. STA. 51+68.8	197	167		
RT. STA. 52+33.4	97	90		
	7,837 S.F.	8,114 S.F.		

SIGN SCHEDULE					
LOCATION	SIGN	SIGN CODE	SIGN PANEL TYPE 1 (SF)	METAL POST TYPE A (FOOT)	
ALTHEA ST.					
LT. STA. 28+02	SCHOOL CROSSING ARROW	S1-1 W16-7P	4.7	5.6	14.5 EA.
RT. STA. 31+03	SCHOOL CROSSING ARROW	S1-1 W16-7P	4.7	2.2	14.5
LT. STA. 32+03	SCHOOL CROSSING ARROW	S1-1 W16-7P	4.7	2.2	14.5
LT. STA. 36+11	SCHOOL CROSSING ARROW	S1-1 W16-7P	4.7	2.2	14.5
RT. STA. 40+56	SCHOOL CROSSING AHEAD	S1-1 W16-3P	4.7	2.0	14.5
RT. STA. 41+14	SCHOOL CROSSING ARROW	S1-1 W16-7P	4.7	2.2	14.5
LT. STA. 41+33	SCHOOL CROSSING ARROW	S1-1 W16-7P	4.7	2.2	14.5
MORGAN ST.					
RT. STA. 60+80	SCHOOL CROSSING ARROW	S1-1 W16-7P	4.7	2.2	14.5
MAIN ST.					
RT. STA. 75+45	SCHOOL CROSSING ARROW	S1-1 W16-7P	4.7	2.2	14.5
ASH ST.					
RT. STA. 51+56	SCHOOL CROSSING ARROW	S1-1 W16-7P	4.7	2.2	14.5
LT. STA. 52+39	SCHOOL CROSSING ARROW	S1-1 W16-7P	4.7	2.2	14.5
TOTAL			75.7 S.F.		159.5 EA.

DETECTABLE WARNINGS		
LOCATION	QUANTITY	
ALTHEA ST.		
LT. STA. 28+35.8	10 S.F.	
LT. STA. 34+54.6	8	
LT. STA. 34+66.0	8	
LT. STA. 36+27.2	8	
LT. STA. 36+53.0	8	
LT. STA. 38+16.1	7	
LT. STA. 38+30.3	7	
RT. STA. 40+75.5	8	
LT. STA. 40+80.4	7	
RT. STA. 41+11.3	8	
LT. STA. 41+16.5	8	
LT. STA. 41+26.0	10	
RT. STA. 41+26.0	8	
MORGAN ST.		
LT. STA. 60+91.7	10	
MAIN ST.		
LT. STA. 75+54.8	10	
RT. STA. 75+54.8	10	
LT. STA. 75+71.4	10	
RT. STA. 75+71.4	10	
LT. STA. 76+10	10	
RT. STA. 76+10	10	
ASH ST.		
LT. STA. 51+80.0	44	
LT. STA. 52+29.5	36	
RT. STA. 51+68.8	10	
RT. STA. 52+33.4	8	
	273 S.F.	

COMBINATION CURB AND GUTTER, R-6, 12"		
LOCATION	QUANTITY	
ALTHEA ST.		
LT. STA. 24+69.1 TO LT. STA. 25+10.6	41.5 FT.	
LT. STA. 28+35.8	9	
LT. STA. 36+27.2	7	
LT. STA. 36+53.0	7	
RT. STA. 40+75.5	7	
RT. STA. 41+10.0 TO RT. STA. 41+29.3	30	
MORGAN ST.		
LT. STA. 60+70.4 TO LT. STA. 61+00.3	30	
MAIN ST.		
LT. STA. 71+28.8 TO LT. STA. 71+52.0	23.1	
LT. STA. 71+90.8 TO LT. STA. 72+39.2	48.4	
LT. STA. 72+75.6 TO LT. STA. 73+00.8	25.2	
LT. STA. 73+35.5 TO LT. STA. 73+58.3	22.8	
LT. STA. 75+54.8	8	
RT. STA. 75+54.8	8	
LT. STA. 75+71.9	9	
RT. STA. 75+71.9	9	
LT. STA. 76+09	9	
RT. STA. 76+08	9	
ASH ST.		
LT. STA. 48+22.6 TO LT. STA. 51+80.7	376	
LT. STA. 52+25.3 TO LT. STA. 52+46.1	24	
RT. STA. 51+68.8	9	
RT. STA. 52+33.4	8	
	720 FT.	

P.C.C. DRIVEWAY PAVEMENT, 6"		
LOCATION	QUANTITY	
ASH ST.		
LT. STA. 48+35.5	32.4 S.Y.	
LT. STA. 48+71.1	31.9	
LT. STA. 49+51.0	37.4	
LT. STA. 50+46.1	33.2	
LT. STA. 51+57.1	26.1	
MAIN ST.		
LT. STA. 71+38.8	18.6	
LT. STA. 72+01.5	19.1	
LT. STA. 72+127.1	21.5	
LT. STA. 72+88.7	20.5	
LT. STA. 73+47.1	20.7	
ALTHEA ST.		
LT. STA. 24+91.0	75.1	
	336 S.Y.	

CLASS D PATCHES, TYPE 1, 9 INCH		
LOCATION	QUANTITY	
ALTHEA ST.		
LT. STA. 24+69.1 TO LT. STA. 25+10.6	9.4 S.Y.	
LT. STA. 28+35.8	1.9	
LT. STA. 36+27.2	1.6	
LT. STA. 36+53.0	1.6	
RT. STA. 40+75.5	1.6	
RT. STA. 41+10.0 TO RT. STA. 41+29.3	14.1	
MORGAN ST.		
LT. STA. 60+70.4 TO LT. STA. 61+00.3	6.9	
MAIN ST.		
LT. STA. 71+28.8 TO LT. STA. 71+52.0	5.3	
LT. STA. 71+90.8 TO LT. STA. 72+39.2	10.9	
LT. STA. 72+75.6 TO LT. STA. 73+00.8	5.7	
LT. STA. 73+35.5 TO LT. STA. 73+58.3	5.1	
LT. STA. 75+54.8	2.0	
RT. STA. 75+54.8	2.0	
LT. STA. 75+71.9	2.2	
RT. STA. 75+71.9	2.2	
LT. STA. 76+09	2.3	
RT. STA. 76+08	2.2	
ASH ST.		
LT. STA. 48+22.6 TO LT. STA. 51+80.7	85.6	
LT. STA. 52+25.3 TO LT. STA. 52+46.1	6.0	
RT. STA. 51+68.8	2.3	
RT. STA. 52+33.4	2.3	
	173 S.Y.	

COMBINATION CURB AND GUTTER REMOVAL		
LOCATION	QUANTITY	
ALTHEA ST.		
LT. STA. 24+69.1 TO LT. STA. 25+10.6	41.5 FT.	
LT. STA. 28+35.8	9	
LT. STA. 36+27.2	7	
LT. STA. 36+53.0	7	
RT. STA. 40+75.5	7	
RT. STA. 41+10.0 TO RT. STA. 41+29.3	30	
MORGAN ST.		
LT. STA. 60+70.4 TO LT. STA. 61+00.3	30	
MAIN ST.		
LT. STA. 71+28.8 TO LT. STA. 71+52.0	23.1	
LT. STA. 71+90.8 TO LT. STA. 72+39.2	48.4	
LT. STA. 72+75.6 TO LT. STA. 73+00.8	25.2	
LT. STA. 73+35.5 TO LT. STA. 73+58.3	22.8	
LT. STA. 75+54.8	8	
RT. STA. 75+54.8	8	
LT. STA. 75+71.9	9	
RT. STA. 75+71.9	9	
LT. STA. 76+09	9	
RT. STA. 76+08	9	
ASH ST.		
LT. STA. 48+22.6 TO LT. STA. 51+80.7	376	
LT. STA. 52+25.3 TO LT. STA. 52+46.1	24	
RT. STA. 51+68.8	9	
RT. STA. 52+33.4	8	
	720 FT.	

DRIVEWAY PAVEMENT REMOVAL		
LOCATION	QUANTITY	
ALTHEA ST.		
LT. STA. 24+91.0	70.3	
ASH ST.		
LT. STA. 48+35.5	17.5 S.Y.	
LT. STA. 48+71.1	16.5	
LT. STA. 49+51.0	25.9	
LT. STA. 50+46.1	26.1	
LT. STA. 51+57.1	21.2	
MAIN ST.		
LT. STA. 71+38.8	15.1	
LT. STA. 72+01.5	15.3	
LT. STA. 72+127.1	16.0	
LT. STA. 72+88.7	19.3	
LT. STA. 73+47.1	17.3	
	260 S.Y.	

COMBINATION CONCRETE CURB AND SIDEWALK, 4" (SPECIAL)		
LOCATION	QUANTITY	
ALTHEA ST.		
LT. STA. 25+48.5 TO LT. STA. 27+94.0	1351 S.F.	
	1351 S.F.	
AGGREGATE SURFACE COURSE, TYPE B		
ALTHEA ST.		
LT. STA. 25+48.5 TO LT. STA. 27+94.0	9.4 TON	
	9.4 TON	
PIPE HANDRAIL (COMPLETE)		
ALTHEA ST.		
LT. STA. 51+73	15 FT.	
	15 FT.	

RELOCATE SIGN PANEL ASSEMBLY, TYPE B		
LOCATION	QUANTITY	
ASH ST.		
LT. STA. 51+75	1 EA.	
	1 EA.	

INLET TO BE ADJUSTED WITH NEW TYPE I FRAME AND GRATE		
LOCATION	QUANTITY	
ALTHEA ST.		
RT. STA. 41+12.5	1 EA.	
ASH ST.		
LT. STA. 51+68	1 EA.	
	2 EA.	
PREFORMED THERMOPLASTIC PAVEMENT MARKING - LINE 6"		
ALTHEA ST.		
LT. STA. 41+00	69	
RT. STA. 41+00	66	
STA. 41+26	54	
MAIN ST.		
STA. 75+54	81	
ASH ST.		
LT. STA. 52+00	87	
	357 FT.	

CONCRETE STEPS		
LOCATION	QUANTITY	
ASH ST.		
LT. STA. 51+72	26.2 S.F.	
	26.2 S.F.	

CONCRETE STEPS REMOVAL		
LOCATION	QUANTITY	
ASH ST.		
LT. STA. 51+72	1 EA.	
	1 EA.	

CURB REMOVAL		
LOCATION	QUANTITY	
MORGAN ST.		
LT. STA. 62+52 TO LT. STA. 63+74	122 FT.	
	122 FT.	

SODDING SCHEDULE						
FERTILIZER TO BE APPLIED @ 270 LB. PER ACRE @ 1-1-1 RATIO						
LOCATION	SODDING (S.Y.)	TOP SOIL FURNISH AND PLACE (S.Y.)	NITROGEN FERTILIZER NUTRIENT (POUND)	PHOSPHORUS FERTILIZER NUTRIENT (POUND)	POTASSIUM FERTILIZER NUTRIENT (POUND)	SUPPLEMENTAL WATERING (MIN)
ALTHEA ST.						
LT. STA. 25+03.15 TO LT. STA. 27+94.0	82	82	1.9	1.5	1.5	1.2
LT. STA. 28+35.8 TO LT. STA. 28+96.6	9	9	0.2	0.2	0.2	0.1
LT. STA. 32+68.0 TO LT. STA. 32+68.0	10	10	0.2	0.2	0.2	0.2
LT. STA. 34+48.6 TO LT. STA. 34+54.6	2	2	0.0	0.0	0.0	0.1
LT. STA. 34+68.0 TO LT. STA. 34+72.0	2	2	0.0	0.0	0.0	0.1
LT. STA. 35+36.7 TO LT. STA. 36+27.2	29	29	0.5	0.5	0.5	0.4
LT. STA. 36+53.0 TO LT. STA. 36+76.0	20	10	0.2	0.2	0.2	0.2
LT. STA. 38+02.1 TO LT. STA. 38+16.1	5					

SUMMARY OF QUANTITIES

CODE NUMBER	ITEM	QUANTITY	UNIT
21101615	TOPSOIL FURNISH AND PLACE, 4"	562	S.Y.
25000400	NITROGEN FERTILIZER NUTRIENT	10.4	LB
25000500	PHOSPHORUS FERTILIZER NUTRIENT	10.4	LB
25000600	POTASSIUM FERTILIZER NUTRIENT	10.4	LB
25200100	SODDING	562	S.Y.
25200200	SUPPLEMENTAL WATERING	8.6	UNIT
40200800	AGGREGATE SURFACE COURSE, TYPE B (CRUSHED LIMESTONE)	9.4	TON
42300200	P.C.C. DRIVEWAY PAVEMENT, 6"	336	S.Y.
42400100	P.C.C. SIDEWALK, 4"	7,837	S.F.
42400800	DETECTABLE WARNING	273	S.F.
44000200	DRIVEWAY PAVEMENT REMOVAL	260	S.Y.
44000300	CURB REMOVAL	122	FT.
44000500	COMBINATION CURB AND GUTTER REMOVAL	720	FT.
44000600	SIDEWALK REMOVAL	8,114	S.F.
44201749	CLASS D PATCHES, TYPE 1, 9"	173	S.Y.
50901760	PIPE HANDRAIL	15	FT.
60260300	INLET TO BE ADJUSTED WITH NEW TYPE 1 FRAME, OPEN LID	2	EA.
60603800	COMBINATION CONCRETE CURB AND GUTTER, 8-6.12	720	FT.
67100100	MOBILIZATION	1	L. SUM
72000100	SIGN PANEL, TYPE 1	75.7	S.F.
72400600	RELOCATE SIGN PANEL ASSEMBY, TYPE B	1	EA.
72900100	METAL POST, TYPE A	159.5	FOOT
Δ 78006130	PREFORMED THERMOPLASTIC PAVEMENT MARKING - LINE 6"	357	FT.
X7010216	TRAFFIC CONTROL AND PROTECTION, (SPECIAL)	1	L. SUM
XX000300	CONCRETE STEPS	26.2	S.F.
Z0012455	CONCRETE STEPS REMOVAL	1	EA.
XX006498	COMBINATION CONCRETE CURB AND SIDEWALK 4 INCH (SPECIAL)	1,351	S.F.
Z0013798	CONSTRUCTION LAYOUT	1	L.S.

Δ SPECIALTY ITEMS

GENERAL NOTES:

- ALL CONSTRUCTION SHALL BE IN ACCORDANCE WITH ILLINOIS DEPARTMENT OF TRANSPORTATION STANDARD SPECIFICATIONS FOR ROAD AND BRIDGE CONSTRUCTION, ADOPTED JANUARY 1, 2012 AND THE SUPPLEMENTAL SPECIFICATIONS AND RECURRING SPECIAL PROVISIONS OF THE STATE OF ILLINOIS, ADOPTED JANUARY 1, 2014.
 - ALL EXISTING UNDERGROUND UTILITIES SHOWN ON PLANS ARE APPROXIMATE. EXACT LOCATIONS AND DEPTHS SHALL BE DETERMINED BY THE CONTRACTOR PRIOR TO CONSTRUCTION. CONTRACTOR SHALL CALL JULIE AT 1-800-892-0123, 48 HOURS PRIOR TO CONSTRUCTION.
 - THE CONTRACTOR SHALL BE RESPONSIBLE FOR THE PROTECTION OF ALL UTILITIES WITHIN THE CONSTRUCTION LIMITS. IF ANY UTILITY IS DAMAGED DURING THE COURSE OF CONSTRUCTION, THE UTILITY OWNER SHALL BE NOTIFIED IMMEDIATELY. THE CONTRACTOR SHALL BE RESPONSIBLE FOR ANY EXPENSES INCURRED TO REPAIR THE UTILITY.
 - IF A UTILITY CONFLICT ARISES WHICH WILL RESULT IN POTENTIAL DAMAGE TO A UTILITY OR WILL CAUSE THE DESIGN TO BE REVISED, CONTACT THE ENGINEER.
 - DRAINAGE AND STORM STRUCTURES SHALL BE KEPT FREE OF DEBRIS AND DIRT DURING THE COURSE OF CONSTRUCTION. CONTRACTOR SHALL BE RESPONSIBLE FOR ANY DAMAGE CAUSED BY ANY STORM SEWER BACKUPS.
 - NO TREES WITHIN THE THE CONTRACT LIMITS ARE TO BE REMOVED, ANY CONFLICT WITH EXISTING TREES, CONTRACTOR TO NOTIFY ENGINEER PRIOR TO CONSTRUCTION.
 - EARTH EXCAVATION AND BACKFILL FOR NEW CURB AND GUTTERS, DRIVEWAY PAVEMENTS AND SIDEWALKS SHALL BE INCLUDED IN THE UNIT COST OF THE VARIOUS ITEMS.
 - ALL ELEVATIONS SHOWN ON THE PLANS ARE ESTABLISHED FROM U.S.G.S. MEAN SEA LEVEL DATUM.
 - PRIOR TO THE USE OF ANY NEW BORROW AREAS, USE AREAS (TEMPORARY ACCESS ROADS, DETOURS, RUN-AROUNDS, ETC.) AND/OR WASTE AREAS, THE CONTRACTOR SHALL FILE THE REQUIRED ENVIRONMENTAL RESOURCE REQUEST SURVEYS ACCORDING TO SECTION 107.22 OF THE STANDARD SPECIFICATIONS. THESE SURVEYS ARE REQUIRED IN ORDER FOR THE DEPARTMENT TO CONDUCT CULTURAL AND BIOLOGICAL RESOURCE SURVEYS FOR THE NEW SITE.

PRIOR TO ANY WASTE MATERIALS BEING REMOVED FROM THE CONSTRUCTION SITE THE REQUIRED ENVIRONMENTAL RESOURCE SURVEYS WILL NEED TO BE OBTAINED AND FILED BY THE CONTRACTOR. EXCESS WASTE PRODUCTS REMOVED FROM THE CONSTRUCTION SITE SHALL BE DISPOSED OF AS REQUIRED IN SECTION 202.03 OF THE STANDARD SPECIFICATIONS.

ANY PROTRUDING METAL BARS SHALL BE REMOVED PRIOR TO THE DISPOSAL OF BROKEN CONCRETE AT APPROVED DISPOSAL SITES.

THE REQUIRED ENVIRONMENTAL RESOURCE DOCUMENTATION SHALL INCLUDE THE FOLLOWING:
 - BDE FORM 2289 (CULTURAL AND NATURAL RESOURCES REVIEW OF BORROW AREAS)
 - BDE FORM 2290 (WASTE/USE AREA REVIEW)
 - A LOCATION MAP SHOWING THE SIZE LIMITS AND LOCATION OF THE USE AREA
 - SIGNED PROPERTY OWNER AGREEMENT FORM - D4 P0100
 - COLOR PHOTOGRAPHS DEPICTING THE USE AREA
 - BORROW AREA ENTRY AGREEMENT FORM - D4 P0101
- PLEASE NOTE THAT A MINIMUM OF FOUR WEEKS SHALL BE ALLOWED FOR THE DISTRICT TO OBTAIN THE REQUIRED ENVIRONMENTAL CLEARANCES.
- SIDEWALKS INSTALLED AT A CROSS SLOPE GREATER THAN 2.00% SHALL BE REMOVED AND REPLACED AT THE CONTRACTOR'S EXPENSE.

P:\112-168-SRIS Elmwood\DWG\SUMMARY AND NOTES_12-168.dwg, Feb 24, 2014

<p>MOHR & KERR ENGINEERING & LAND SURVEYING, P.C. 7265 N. University Ave. Peoria, Illinois 61614 Phone: (309) 691-8114 Fax: (309) 692-8001 www.mohr-kerr.com Professional Design Firm #14-000281</p>	P:\112-168-SRIS\SUMMARY AND NOTES_12-168.dwg	DESIGNED SDK	REVISED	<p align="center">STATE OF ILLINOIS DEPARTMENT OF TRANSPORTATION</p>	<p align="center">SAFE ROUTE TO SCHOOL - CITY OF ELMWOOD, IL SUMMARY OF QUANTITIES AND GENERAL NOTES</p>	F.A. ROUTE	SECTION	COUNTY	TOTAL SHEETS	SHEET NO.
	PLOT SCALE: 1" = 2'	DRAWN MH/DK	REVISED			---	12-00003-00-SW	PEORIA	4	4
	DATE 02-24-14	CHECKED SDK	REVISED			FED PROJ. NO. SRIS-4009(266)	CONTRACT NO. 89651	ILLINOIS FEDERAL ROAD DIST NO. 4		

SCALE: SHEET NO. 4 OF 10 SHEETS STA. TO STA.

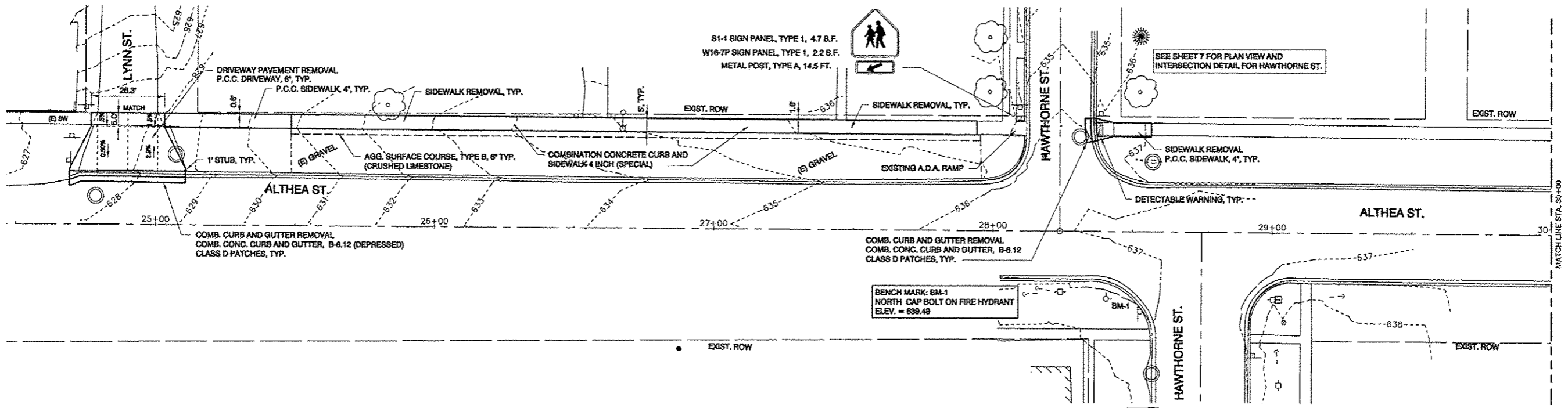

PLAN VIEW - ALTHEA STREET
SCALE: 1" = 20'

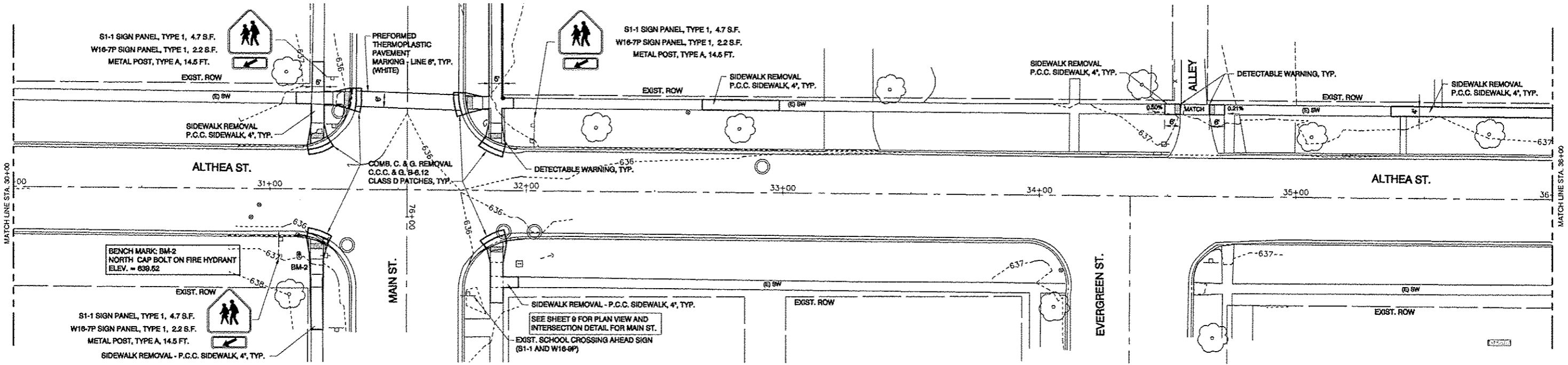

PLAN VIEW - ALTHEA STREET
SCALE: 1" = 20'



LEGEND

- | | | | |
|-----|--------------------------|---|---------------------------|
| --- | EXIST. RIGHT OF WAY LINE | ⊠ | EXIST. HAND HOLE |
| --- | ADJACENT PROPERTY LINE | ⊠ | EXIST. SIGN |
| --- | CENTERLINE OF ROAD | ⊠ | EXIST. TELEPHONE PEDESTAL |
| x | EXIST. FENCE | ⊠ | EXIST. WATER METER |
| ⊕ | EXIST. ELECTRIC METER | ⊠ | EXIST. WATER VALVE |
| ⊕ | EXIST. GAS VALVE | ⊠ | EXIST. CONIFER TREE |
| ⊕ | EXIST. GAS METER | ⊠ | EXIST. DECIDUOUS TREE |
| ⊕ | EXIST. FIRE HYDRANT | ⊠ | EXIST. SHRUB / BUSH |
| ⊕ | EXIST. STORM INLET | ⊠ | LANDSCAPE |
| ⊕ | EXIST. LIGHT | ⊠ | CONCRETE |
| ⊕ | EXIST. MAILBOX | ⊠ | BITUMINOUS |
| ⊕ | EXIST. MANHOLE | ⊠ | |

NOTE:
ALL SIDEWALK TO BE CONSTRUCTED
WITH 1.50% CROSS SLOPE OR FLATTER

P:\12-100 SRTS Elmwood\DWGS\ALTHEA_PP_1_12-100.dwg Feb 24, 2014

M MOHR & KERR ENGINEERING & LAND SURVEYING, P.C.
7330 N. University Ave.
Peoria, Illinois 61614
Office: (309) 692-0200
Fax: (309) 692-0201
www.mohr-kerr.com

P:\12-100 SRTS Elmwood\DWGS\ALTHEA_PP_1_12-100.dwg	DESIGNED	SDK	REVISED
	DRAWN	MH/DK	REVISED
PLOT SCALE: 1" = 2'	CHECKED	SDK	REVISED
Feb 24, 2014	DATE	02-24-14	REVISED

STATE OF ILLINOIS
DEPARTMENT OF TRANSPORTATION

SAFE ROUTE TO SCHOOL - CITY OF ELMWOOD, IL
PLAN VIEW
ALTHEA STREET
SCALE: 1" = 20' SHEET NO. 5 OF 10 SHEETS STA. 24+50 TO STA. 36+00

F.A. ROUTE	SECTION	COUNTY	TOTAL SHEETS	SHEET NO.
---	12-00003-00-SW	PEORIA	16	5
FED PROJ. NO. SRTS-4009(266)		CONTRACT NO. 89651		
ILLINOIS FEDERAL ROAD DIST NO. 4				

S1-1 SIGN PANEL, TYPE 1, 4.7 S.F.
 W16-7P SIGN PANEL, TYPE 1, 2.2 S.F.
 METAL POST, TYPE A, 14.5 FT.

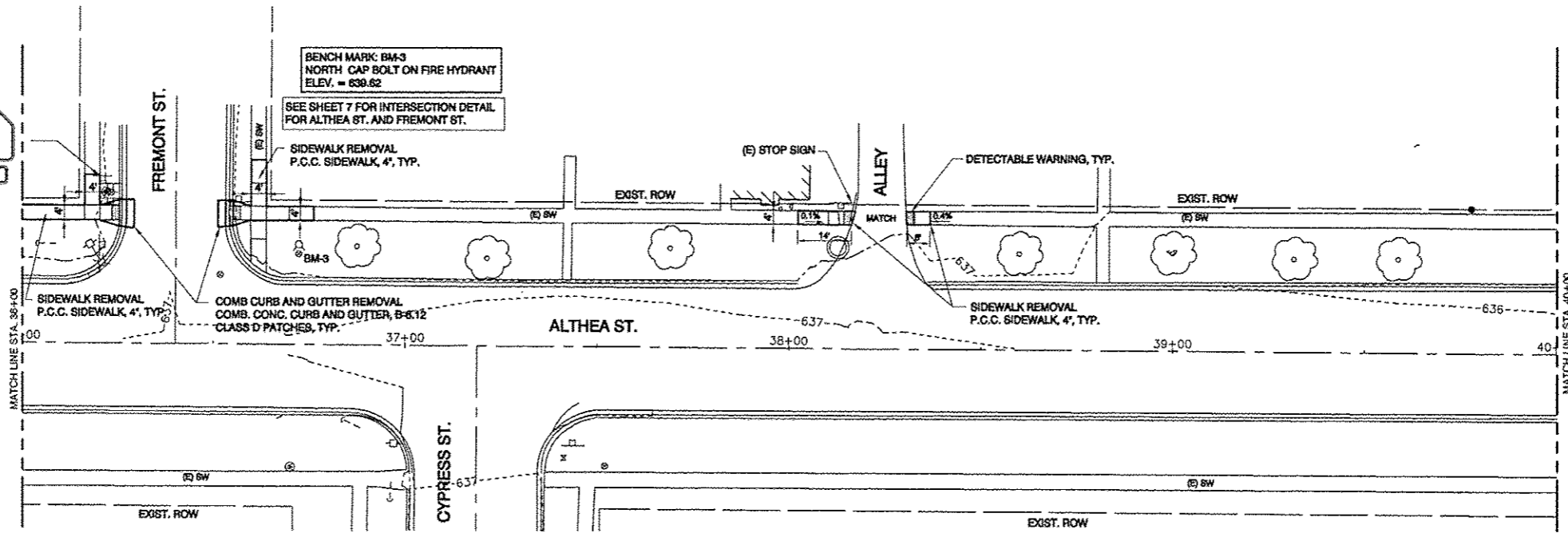

PLAN VIEW - ALTHEA STREET
 SCALE: 1" = 20'



LEGEND

- | | | | |
|-----|--------------------------|------|---------------------------|
| --- | EXIST. RIGHT OF WAY LINE | ⊠ | EXIST. HAND HOLE |
| --- | ADJACENT PROPERTY LINE | ⊡ | EXIST. SIGN |
| --- | CENTERLINE OF ROAD | ⊞ | EXIST. TELEPHONE PEDESTAL |
| --- | EXIST. FENCE | ⊙ | EXIST. WATER METER |
| ⊙ | EXIST. ELECTRIC METER | ⊙ | EXIST. WATER VALVE |
| * | EXIST. GAS VALVE | ⊙ | EXIST. CONIFER TREE |
| ⊙ | EXIST. GAS METER | ⊙ | EXIST. DECIDUOUS TREE |
| ⊙ | EXIST. FIRE HYDRANT | ⊙ | EXIST. SHRUB / BUSH |
| ⊙ | EXIST. STORM INLET | ⊙ | LANDSCAPE |
| ⊙ | EXIST. LIGHT | LS | CONCRETE |
| ⊙ | EXIST. MAILBOX | CONC | BIT |
| ⊙ | EXIST. MANHOLE | BIT | |

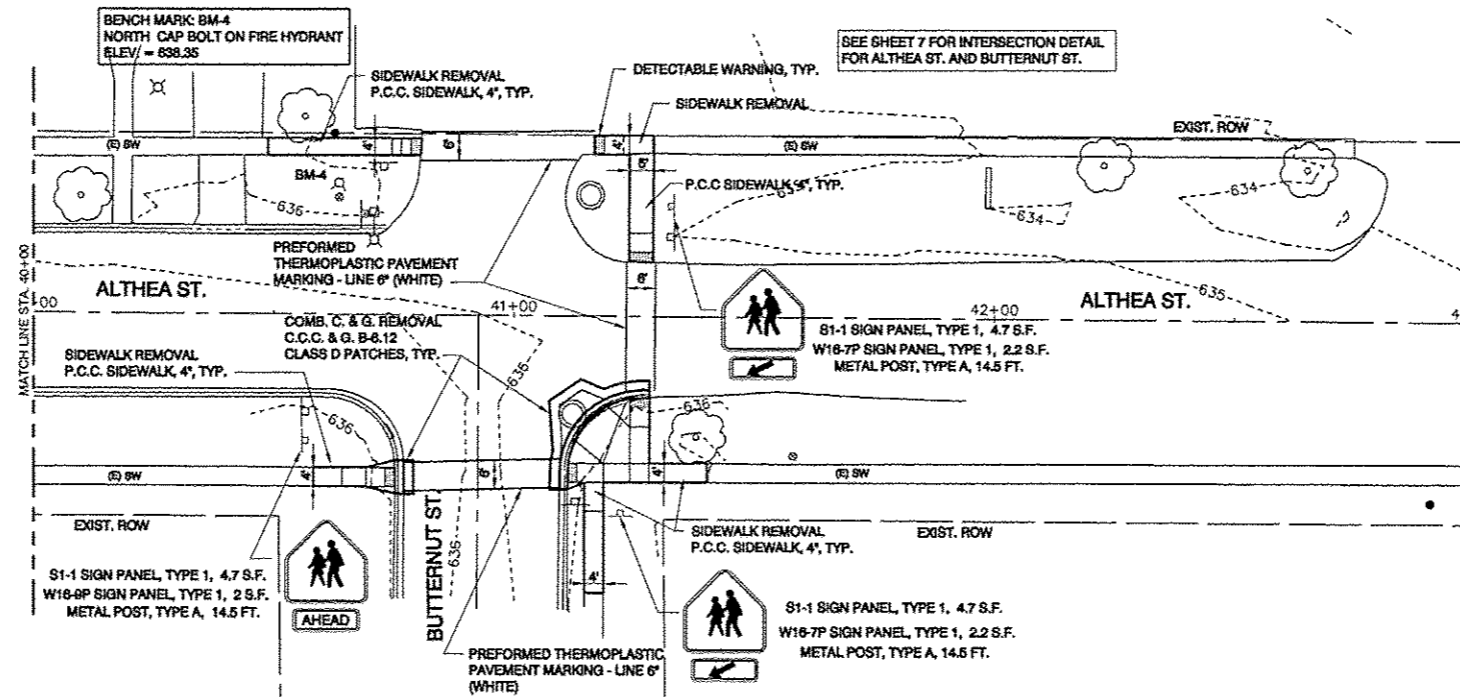

PLAN VIEW - ALTHEA STREET
 SCALE: 1" = 20'

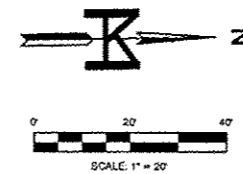

NOTE:
 ALL SIDEWALK TO BE CONSTRUCTED
 WITH 1.50% CROSS SLOPE OR FLATTER

P:\12-100 SRTS\12-100-003-ALTHEA_PP_2_12-100.dwg PLO 04, 2014

M MOHR & KERR ENGINEERING & LAND SURVEYING, P.C.
 7200 N. University Ave. Office: (309) 462-0000
 Peoria, Illinois 61614 Fax: (309) 462-0001
 www.mohr-kerr.com Professional Design Firm #184 005001

P:\12-100 SRTS\12-100-003-ALTHEA_PP_2_12-100.dwg	DESIGNED	SDK	REVISED
	DRAWN	MH/DK	REVISED
PLOT SCALE: 1" = 2'	CHECKED	SDK	REVISED
Feb 24, 2014	DATE	02-24-14	REVISED

STATE OF ILLINOIS
 DEPARTMENT OF TRANSPORTATION

SAFE ROUTE TO SCHOOL - CITY OF ELMWOOD, IL			
PLAN VIEW ALTHEA STREET			
SCALE: 1" = 20'	SHEET NO. 8 OF 10 SHEETS	STA. 36+00 TO STA. 43+00	

F.A. ROUTE	SECTION	COUNTY	TOTAL SHEETS	SHEET NO.
---	12-00003-00-SW	PEORIA	10	6
FED PROJ. NO. SRTS-4009(266)		CONTRACT NO. 89651		
ILLINOIS FEDERAL ROAD DIST NO. 4				

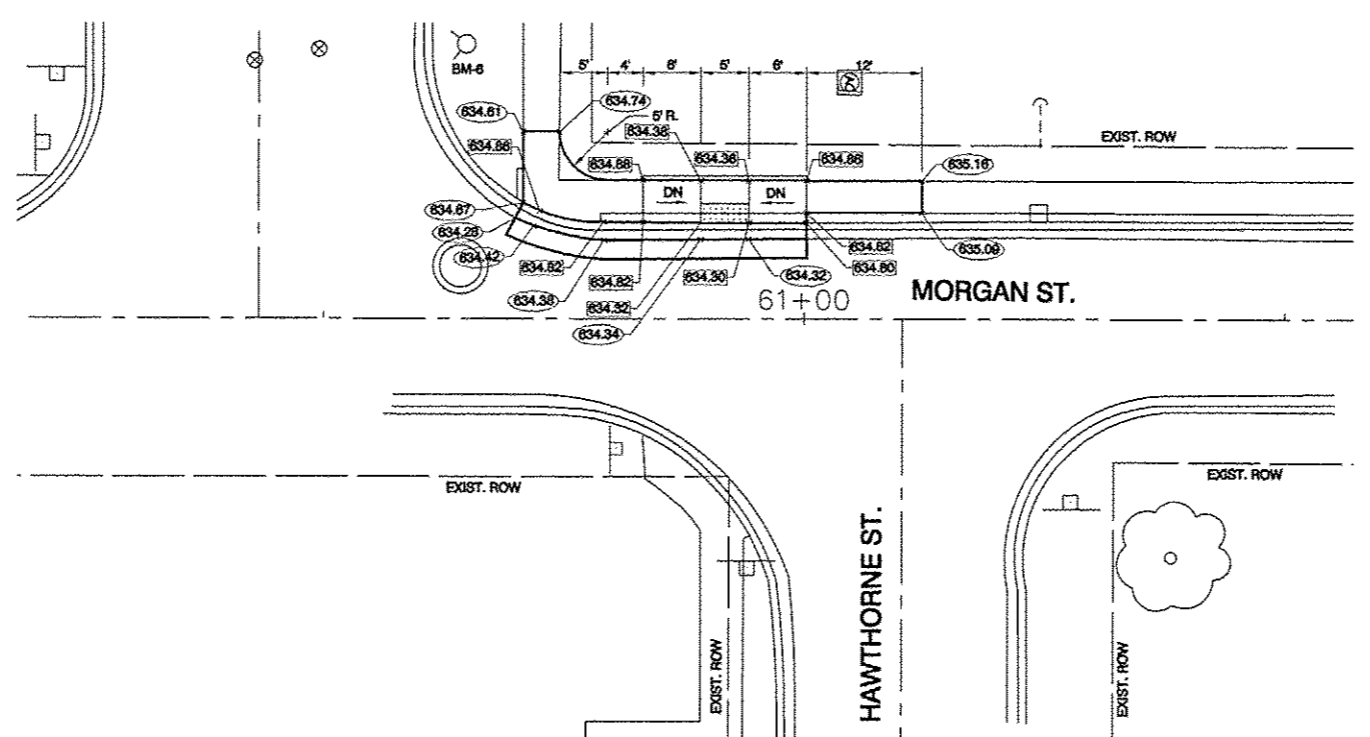
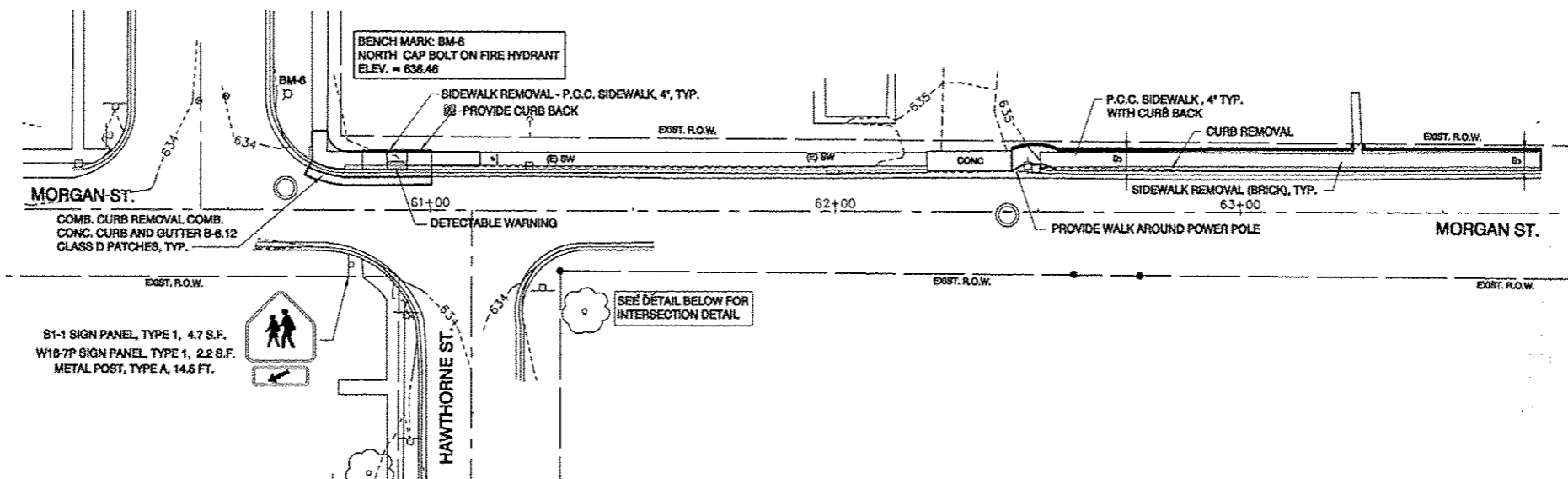

LEGEND

---	EXIST. RIGHT OF WAY LINE	⊠	EXIST. HAND HOLE
---	ADJACENT PROPERTY LINE	⊡	EXIST. SIGN
---	CENTERLINE OF ROAD	⊞	EXIST. TELEPHONE PEDESTAL
---	EXIST. FENCE	⊙	EXIST. WATER METER
⊙	EXIST. ELECTRIC METER	⊕	EXIST. WATER VALVE
+	EXIST. GAS VALVE	⊗	EXIST. CONIFER TREE
⊙	EXIST. GAS METER	⊗	EXIST. DECIDUOUS TREE
⊕	EXIST. FIRE HYDRANT	LS	EXIST. SHRUB / BUSH
⊞	EXIST. STORM INLET	CONC	LANDSCAPE
⊡	EXIST. LIGHT	BIT	CONCRETE
⊞	EXIST. MAILBOX		BITUMINOUS
⊙	EXIST. MANHOLE		

NOTE:
ALL SIDEWALK TO BE CONSTRUCTED
WITH 1.50% CROSS SLOPE OR FLATTER

P:\12-0003-00-SW\MORGAN_PP_1_12-109.dwg Feb 24, 2014

M MOHR & KERR ENGINEERING & LAND SURVEYING, P.C.
2300 N. University Ave.
Peoria, Illinois 61614
Office: (309) 692-8200
Fax: (309) 692-8201
www.mohr-kerr.com
#184 005001

P:\12-0003-00-SW\MORGAN_PP_1_12-109.dwg	DESIGNED	SDK	REVISED
	DRAWN	MH/OK	REVISED
PLOT SCALE: 1" = 2'	CHECKED	SDK	REVISED
Feb 24, 2014	DATE	02-24-14	REVISED

DESIGNED	SDK	REVISED
DRAWN	MH/OK	REVISED
CHECKED	SDK	REVISED
DATE	02-24-14	REVISED

STATE OF ILLINOIS
DEPARTMENT OF TRANSPORTATION

SAFE ROUTE TO SCHOOL - CITY OF ELMWOOD, IL
PLAN VIEW AND INTERSECTION DETAIL
MORGAN STREET
SCALE: AS NOTED SHEET NO. 6 OF 10 SHEETS STA. 60+50 TO STA. 64+00

F.A. ROUTE	SECTION	COUNTY	TOTAL SHEETS	SHEET NO.
---	12-00003-00-SW	PEORIA	16	6
FED PROJ. NO. SRTS-4009(266)		CONTRACT NO. 89651		
ILLINOIS FEDERAL ROAD DIST NO. 4				

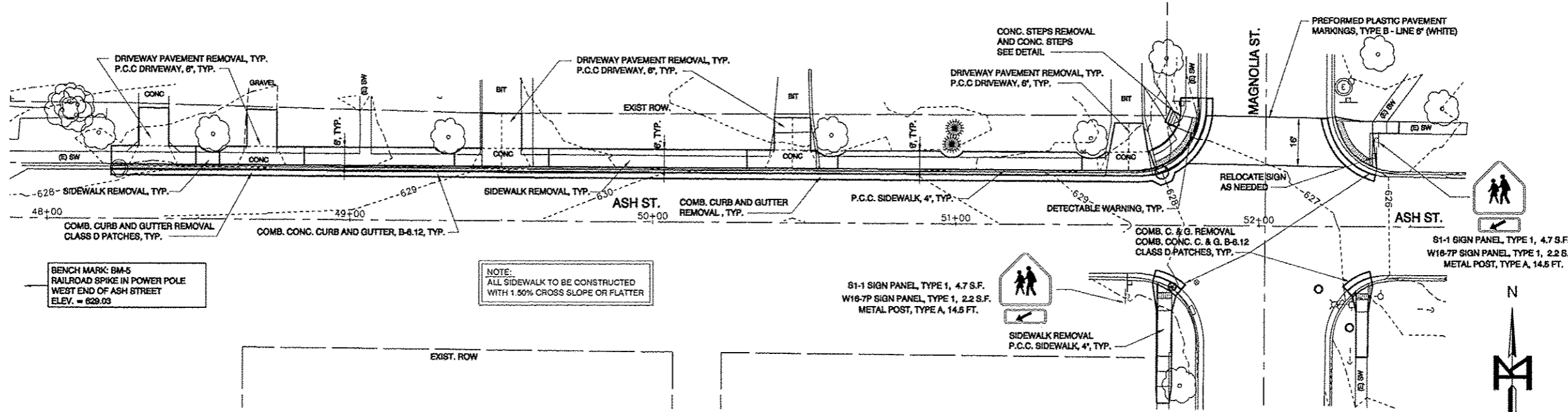

BENCH MARK: BM-5
RAILROAD SPIKE IN POWER POLE
WEST END OF ASH STREET
ELEV. = 628.03

NOTE:
ALL SIDEWALK TO BE CONSTRUCTED
WITH 1.50% CROSS SLOPE OR FLATTER

S1-1 SIGN PANEL, TYPE 1, 4.7 S.F.
W16-7P SIGN PANEL, TYPE 1, 2.2 S.F.
METAL POST, TYPE A, 14.5 FT.

S1-1 SIGN PANEL, TYPE 1, 4.7 S.F.
W16-7P SIGN PANEL, TYPE 1, 2.2 S.F.
METAL POST, TYPE A, 14.5 FT.

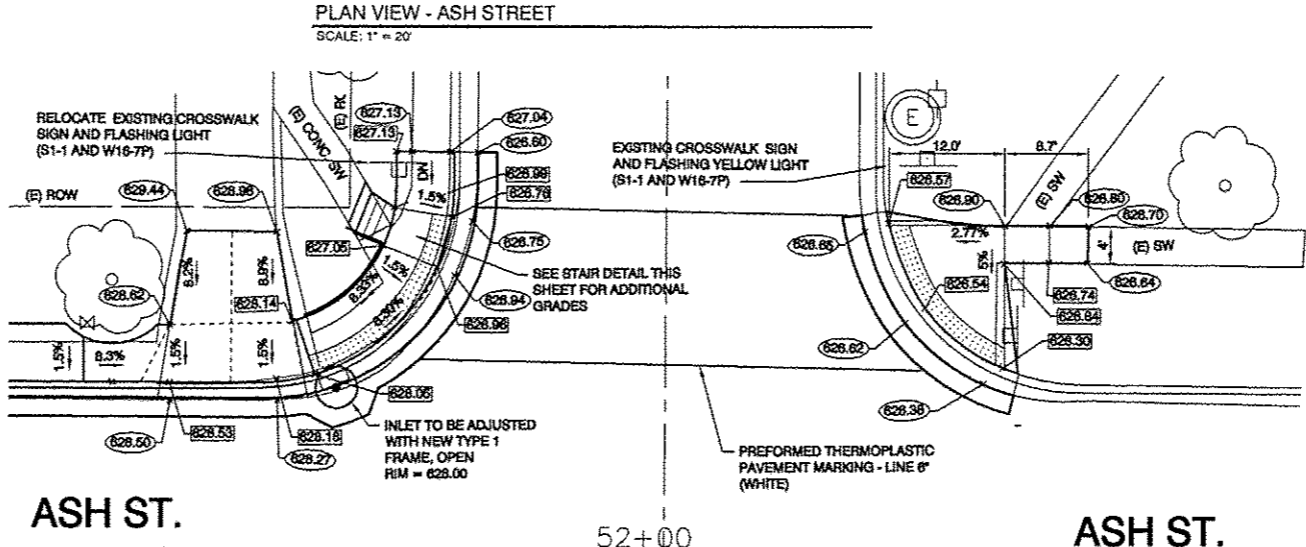
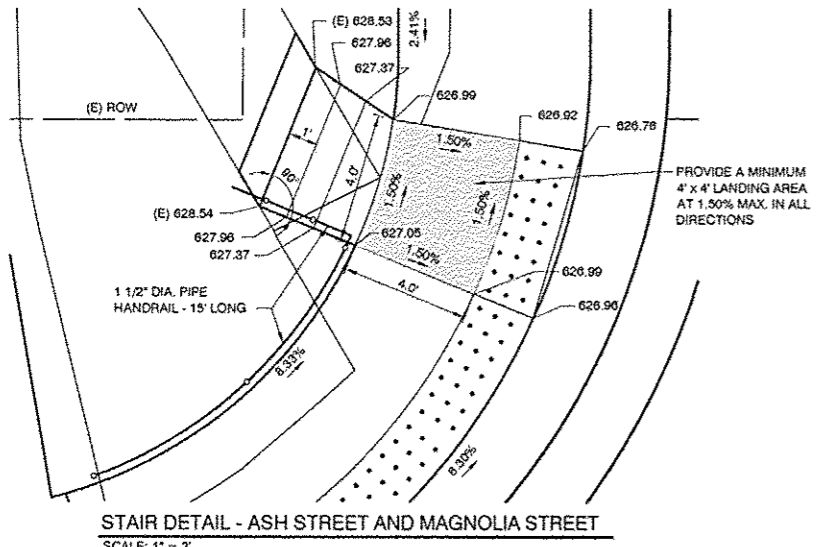
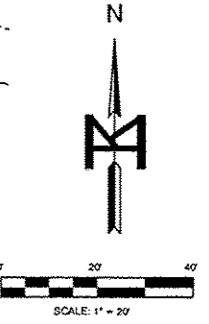

LEGEND

---	EXIST. RIGHT OF WAY LINE	⊗	EXIST. HAND HOLE
---	ADJACENT PROPERTY LINE	⊠	EXIST. SIGN
---	CENTERLINE OF ROAD	⊕	EXIST. TELEPHONE PEDESTAL
---	EXIST. FENCE	⊙	EXIST. WATER METER
---	EXIST. ELECTRIC METER	⊛	EXIST. WATER VALVE
---	EXIST. GAS VALVE	⊘	EXIST. CONIFER TREE
---	EXIST. GAS METER	⊙	EXIST. DECIDUOUS TREE
---	EXIST. FIRE HYDRANT	⊙	EXIST. SHRUB / BUSH
---	EXIST. STORM INLET	LS	LANDSCAPE
---	EXIST. LIGHT	CONC	CONCRETE
---	EXIST. MAILBOX	BIT	BITUMINOUS
---	EXIST. MANHOLE		

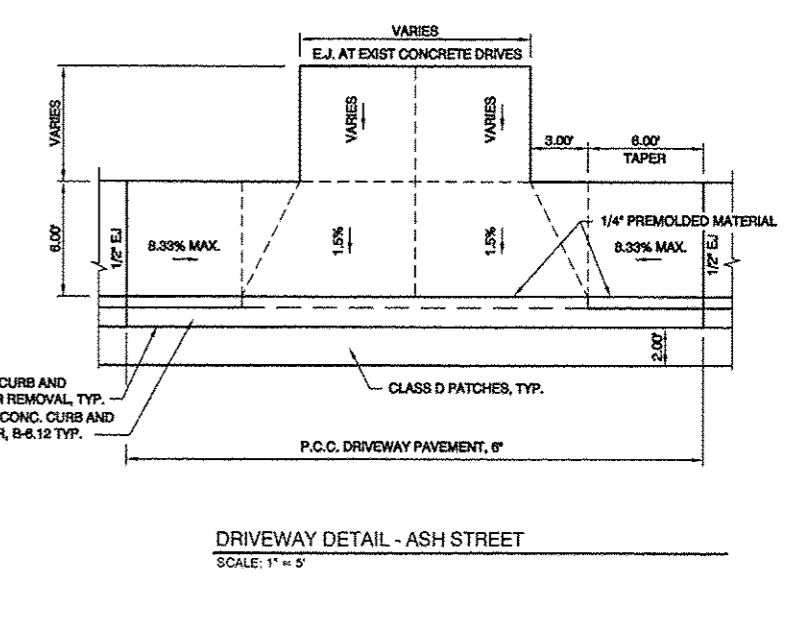
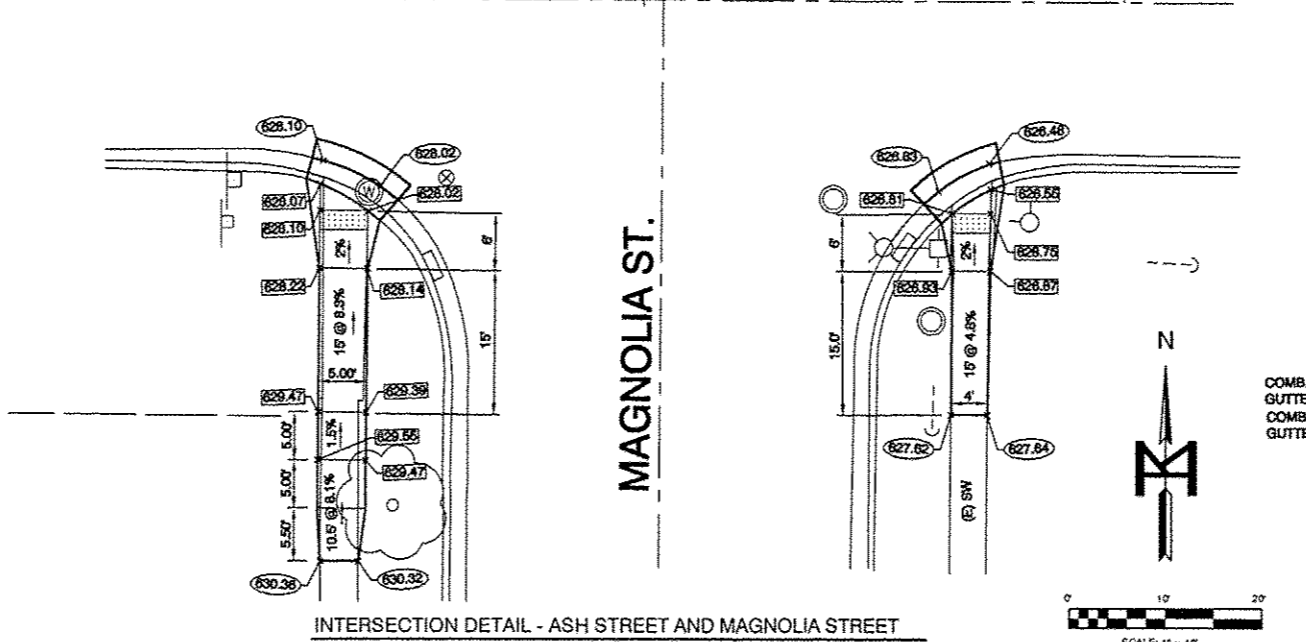
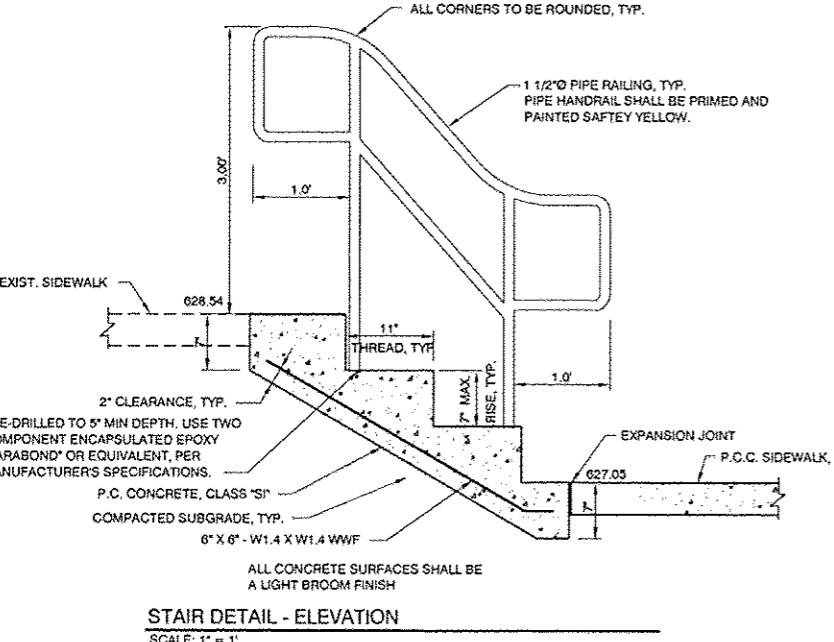

P:\12-1008\DWG\10-ASH_PP_1_12-1008.dwg, Feb 24, 2014

M MOHR & KERR ENGINEERING & LAND SURVEYING, P.C.
7300 N. University Ave.
Peoria, Illinois 61614
Office: (309) 692-8900
Fax: (309) 692-8901
www.mohr-kerr.com
#154 000001

P:\12-1008\DWG\10-ASH_PP_1_12-1008.dwg	DESIGNED SDK	REVISED
PLOT SCALE: 1" = 2'	DRAWN MH/DK	REVISED
Feb 24, 2014	CHECKED SO/K	REVISED
	DATE 02-24-14	REVISED

STATE OF ILLINOIS
DEPARTMENT OF TRANSPORTATION

SAFE ROUTE TO SCHOOL - CITY OF ELMWOOD, IL
PLAN VIEW AND INTERSECTION DETAIL
ASH STREET

SCALE: AS NOTED	SHEET NO. 10 OF 10 SHEETS	STA. 48+00 TO STA. 52+50
-----------------	---------------------------	--------------------------

F.A. ROUTE	SECTION	COUNTY	TOTAL SHEETS	SHEET NO.
---	12-00003-00-SW	PEORIA	16	10
FED PROJ. NO. SRTS-4009(266)		CONTRACT NO. 89651		
ILLINOIS FEDERAL ROAD DIST NO. 4				

DESIGNER NOTES:
 1. DESIGNER SHOULD REVIEW "HANDBOOK FOR THE POLICY ON PERMITS FOR ACCESS DRIVEWAYS TO STATE HIGHWAYS"
 1.1. FLARES ARE RECOMMENDED FOR CURBLINE SIDEWALKS.
 2. DESIGNER SHOULD REVIEW CHAPTER 58 OF BDE FOR THE ADA REQUIREMENTS.
 3. INCLUDE STATE STANDARD 606001 AND APPLICABLE SIDEWALK STANDARDS.

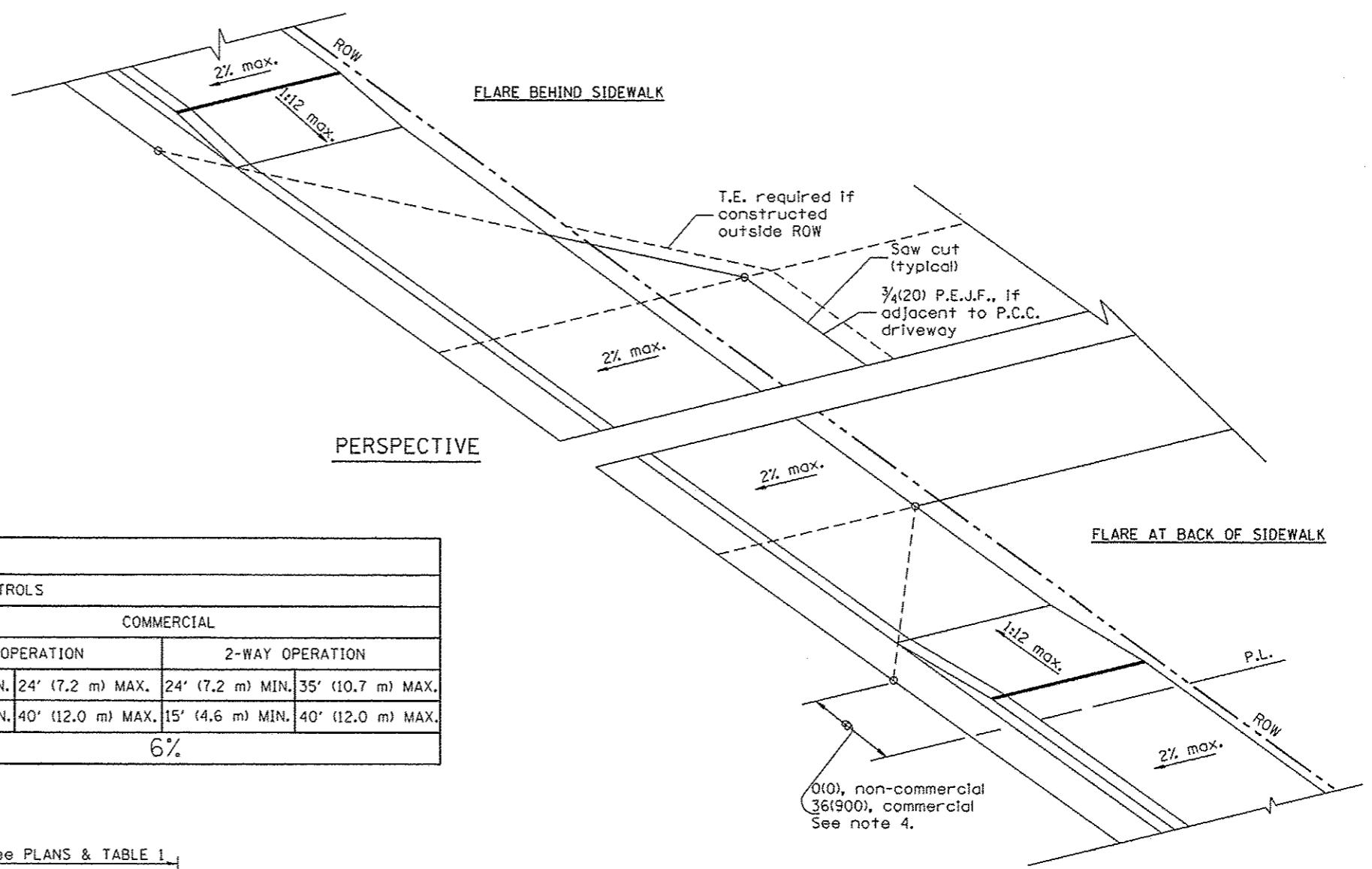

ELEMENT	NON-COMMERCIAL		COMMERCIAL			
			1-WAY OPERATION		2-WAY OPERATION	
WIDTH (W)	12' (3.6 m) MIN.	24' (7.2 m) MAX.	14' (4.3 m) MIN.	24' (7.2 m) MAX.	24' (7.2 m) MIN.	35' (10.7 m) MAX.
RADIUS EQUIVALENT 1:1 FLARE (F)	5' (1.5 m) MIN.	25' (7.6 m) MAX.	15' (4.6 m) MIN.	40' (12.0 m) MAX.	15' (4.6 m) MIN.	40' (12.0 m) MAX.
MAX. GRADE (G)	8%		6%			

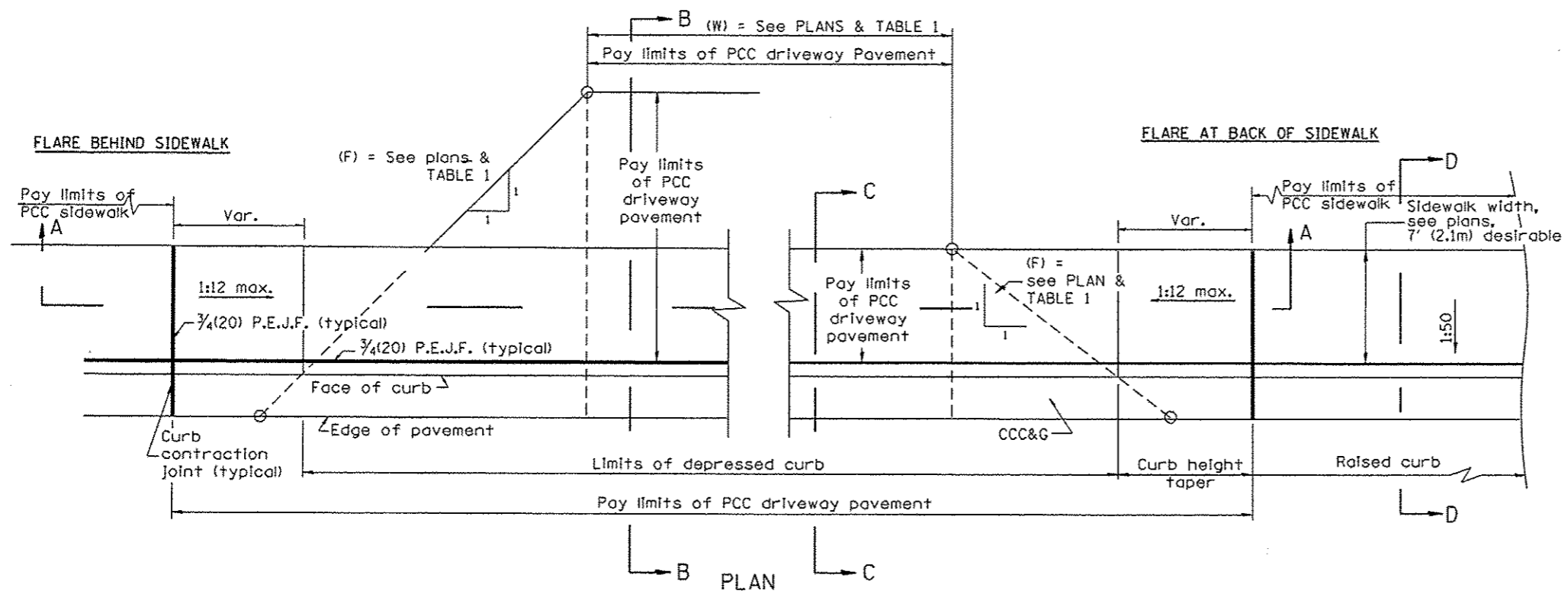

GENERAL NOTES

1. The sidewalk area located within the pay limits of P.C.C. Driveway Pavement will be of the same thickness and construction as the P.C.C. Driveway Pavement.
2. Combination Concrete Curb & Gutter shall be depressed in accordance with Standard 606001.
3. Exceptions to the radius flare/property line relationship are as shown in the plans for common entrances, with jointly executed access permits.
4. Refer to State Standard 424026 for detectable warnings at busy commercial entrances.

All dimensions are in inches (millimeters) unless otherwise noted.

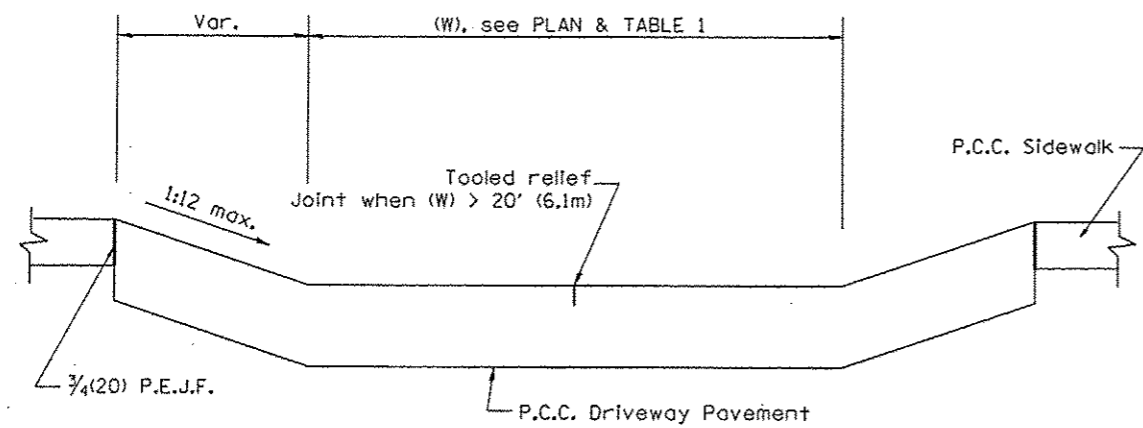

SECTION A-A

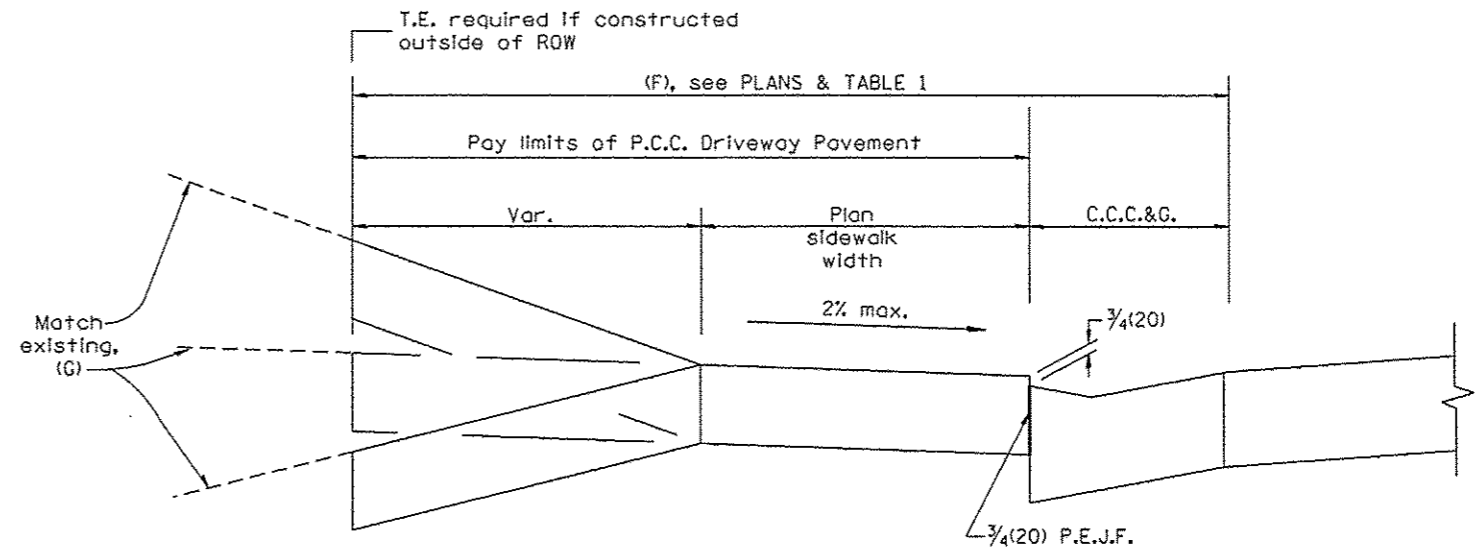

SECTION B-B

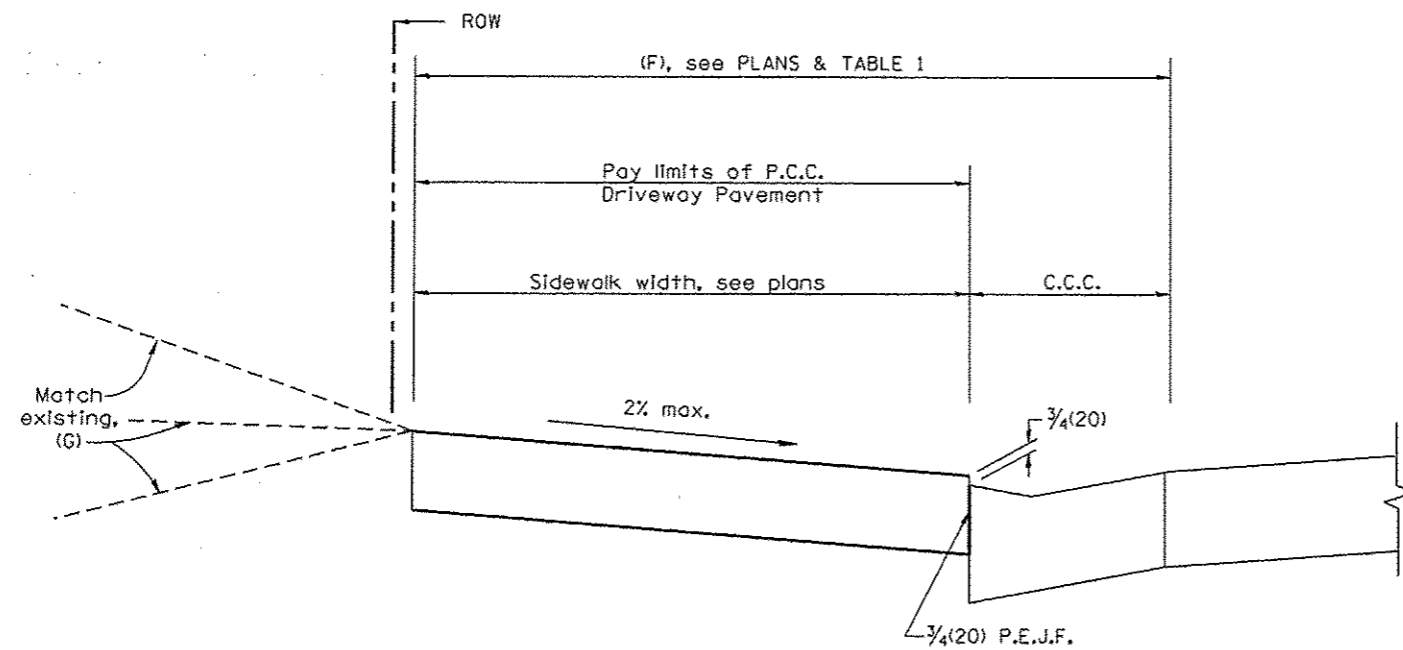

SECTION C-C

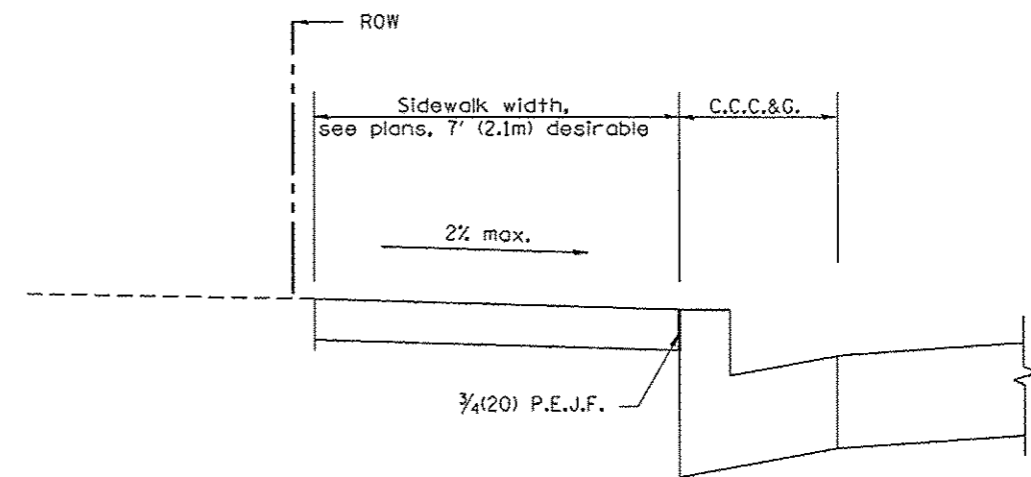

SECTION D-D

All dimensions are in inches (millimeters) unless otherwise noted.

STATE OF ILLINOIS DEPARTMENT OF TRANSPORTATION				URBAN ENTRANCES, ACCESSIBLE TO THE DISABLED, FOR CURBLINE SIDEWALKS				F.A. RTE.		SECTION		COUNTY		TOTAL SHEETS		SHEET NO.	
								-		12-00003-00-SW		PEORIA		16		12	
NOT TO SCALE				SHT. 2 OF 2 CADD STD. 423101-D4				FED. ROAD DIST. NO.		ILLINOIS		FED. AID PROJECT					

DESIGNER NOTES:
 1. DESIGNER SHOULD REVIEW "HANDBOOK FOR THE POLICY ON PERMITS FOR ACCESS DRIVEWAYS TO STATE HIGHWAYS"
 1:1 FLARES ARE RECOMMENDED FOR SIDEWALKS WITH NARROW SEPARATIONS.
 2. DESIGNER SHOULD REVIEW BDE CHAPTER 58.
 3. STATE STANDARD 606001 AND APPLICABLE SIDEWALK STANDARDS SHOULD BE INCLUDED IN THE PLANS TO SUPPLEMENT THIS DRAWING.

TABLE 1						
URBAN ENTRANCE DESIGN CONTROLS						
ELEMENT	NON-COMMERCIAL		COMMERCIAL			
			1-WAY OPERATION		2-WAY OPERATION	
WIDTH (W)	12' (3.6 m) MIN.	24' (7.2 m) MAX.	14' (4.3 m) MIN.	24' (7.2 m) MAX.	24' (7.2 m) MIN.	35' (10.7 m) MAX.
RADIUS EQUIVALENT 1:1 FLARE (F)	5' (1.5 m) MIN.	25' (7.6 m) MAX.	15' (4.6 m) MIN.	40' (12.0 m) MAX.	15' (4.6 m) MIN.	40' (12.0 m) MAX.
MAX. GRADE (G)	8%		6%			

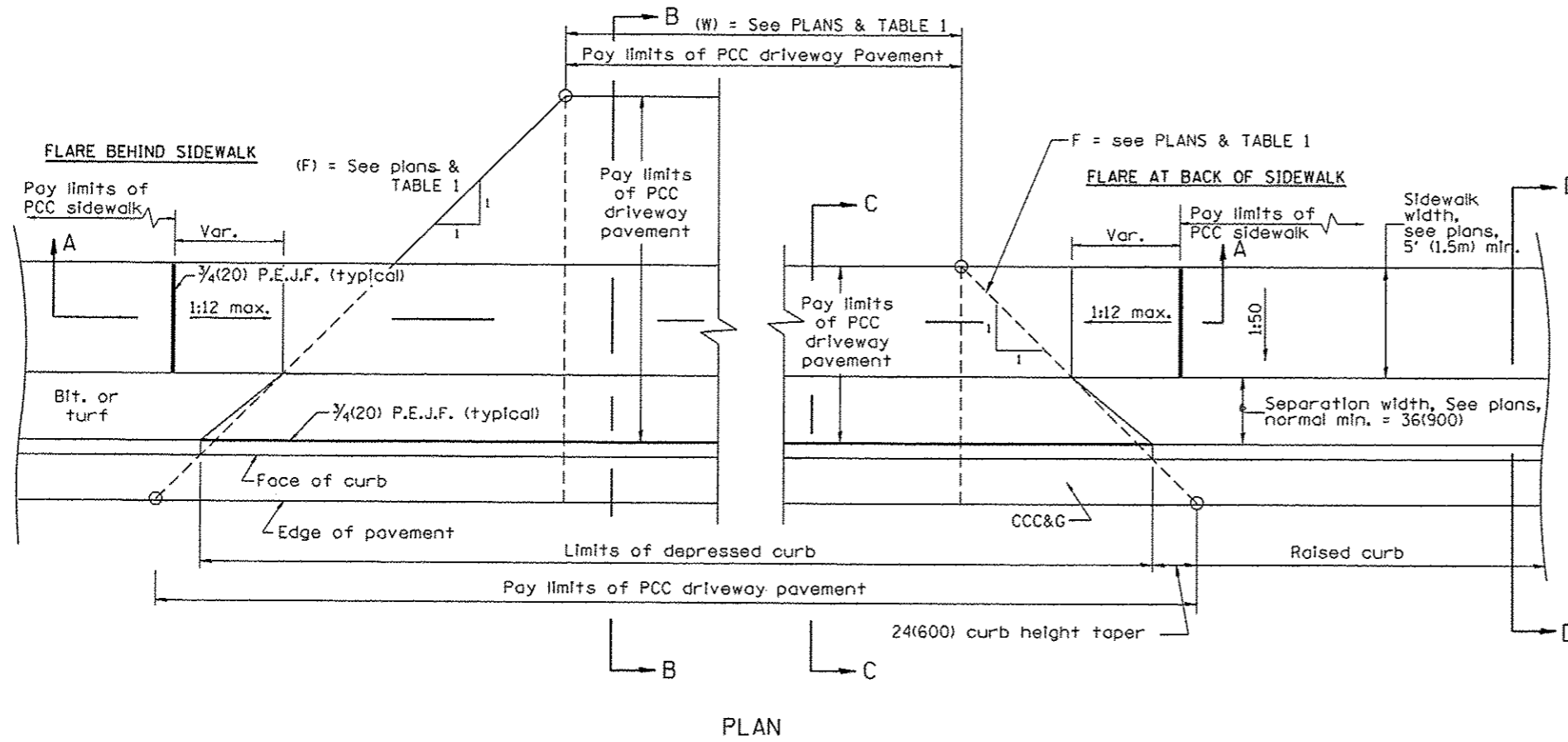
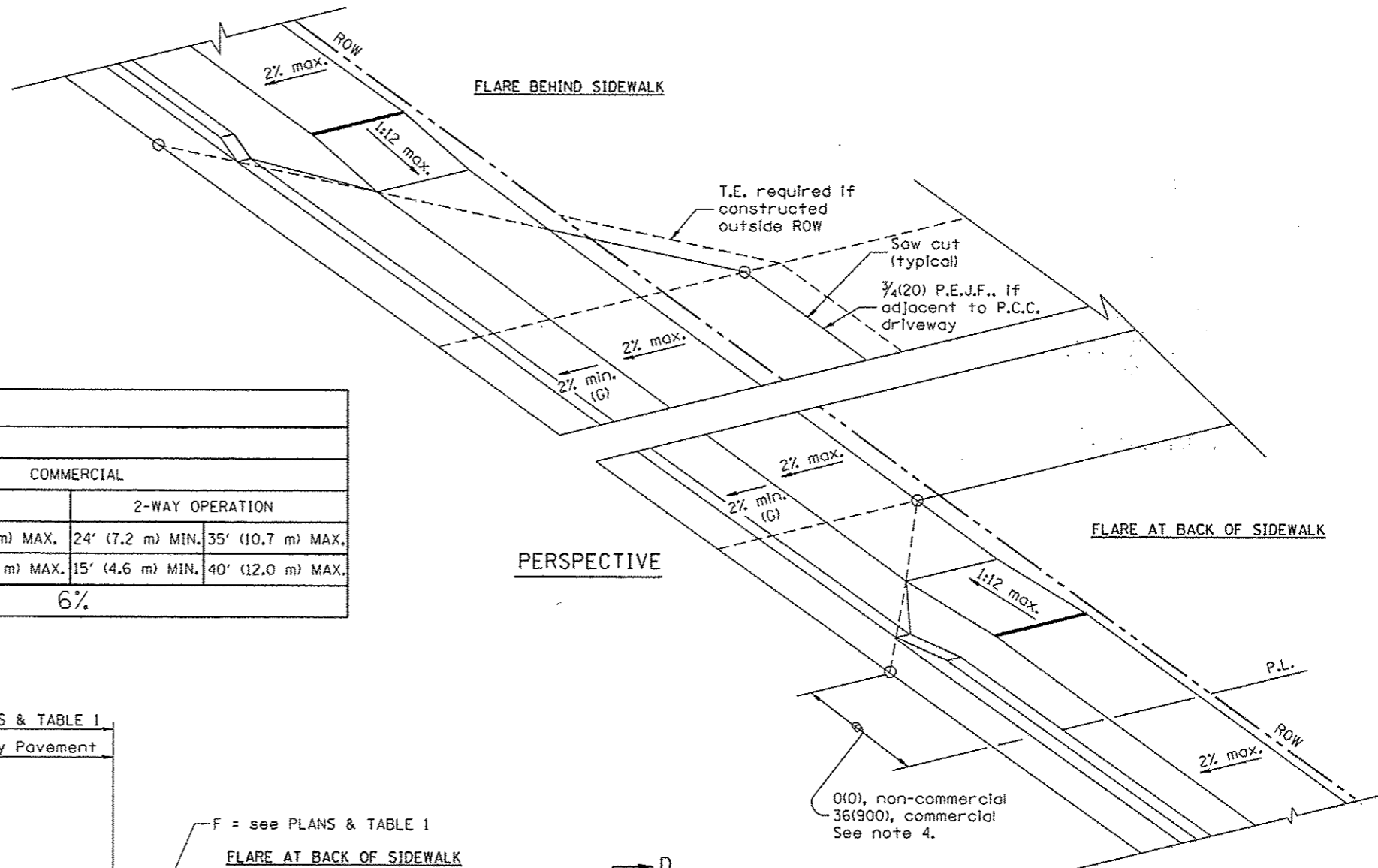

GENERAL NOTES

1. The sidewalk area located within the pay limits of P.C.C. Driveway Pavement will be of the same thickness and construction as the P.C.C. Driveway Pavement.
2. Combination Concrete Curb & Gutter shall be depressed in accordance with Standard 606001.
3. Exceptions to the radius flare/property line relationship are as shown in the plans for common entrances, with jointly executed access permits.
4. Refer to State Standard 424026 for detectable warnings at busy commercial entrances.

All dimensions are in inches (millimeters) unless otherwise noted.

01-01-97	RENUM. C-103.01, NEW REVISION BOX	T.P.	03-15-12	REMOVED HATCHING ON RAMPS	R.D.	STATE OF ILLINOIS DEPARTMENT OF TRANSPORTATION	URBAN ENTRANCES, ACCESSIBLE TO THE DISABLED, FOR SEPARATED SIDEWALKS	F.A. RTE.	SECTION	COUNTY	TOTAL SHEETS	SHEET NO.
01-17-03	REMOVE CURB CONTRACTION	JATR						12-0003-00-SW	PEORIA	16	13	
09-15-05	JOINT	M.M.A.									CONTRACT NO. 89651	
10-16-06	REVISED TO 2007 SPEC.	M.A.										

NOT TO SCALE

SHT. 1 OF 2
CADD STD. 423106-D4

FED. ROAD DIST. NO. ILLINOIS FED. AID PROJECT

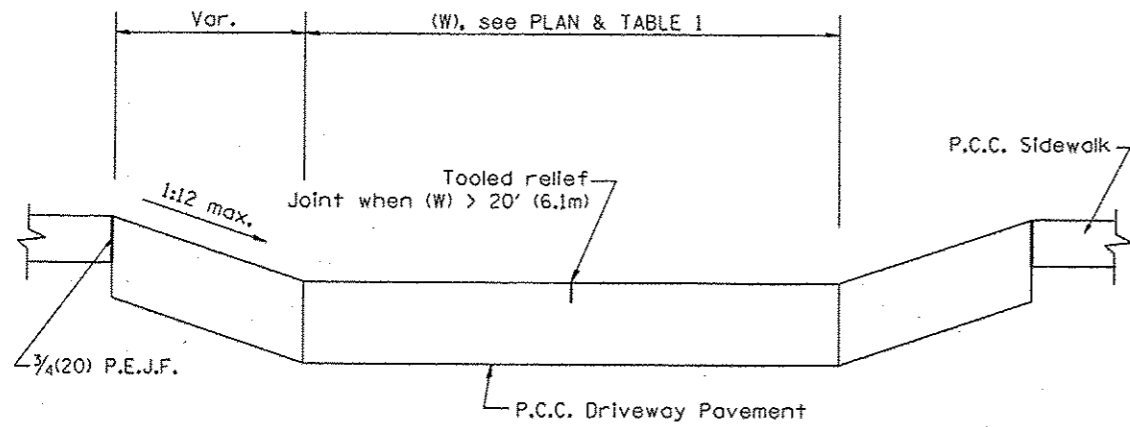

SECTION A-A

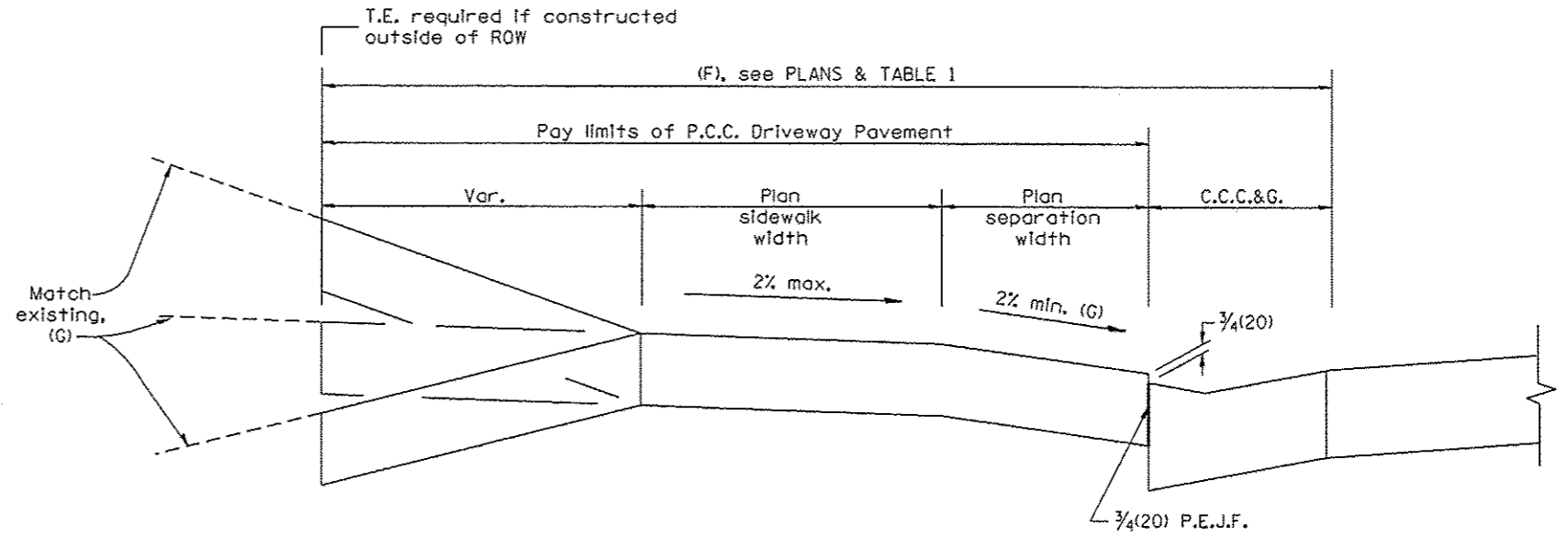

SECTION B-B

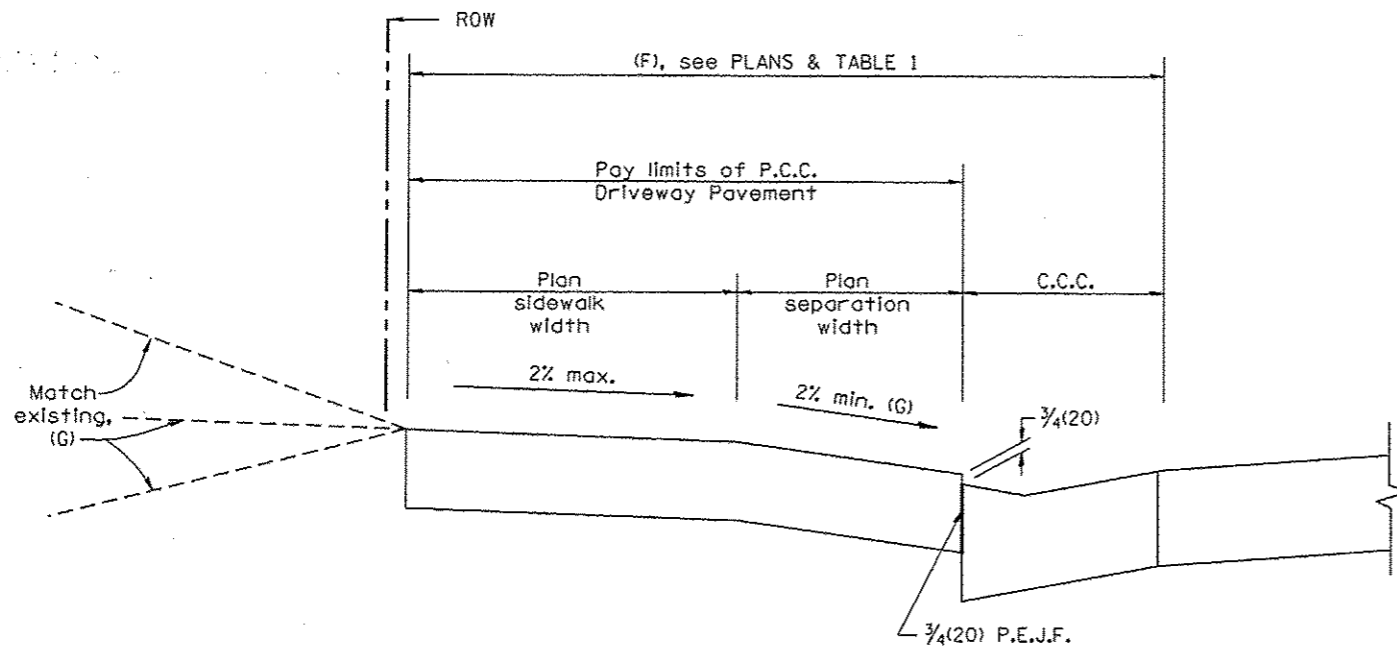

SECTION C-C

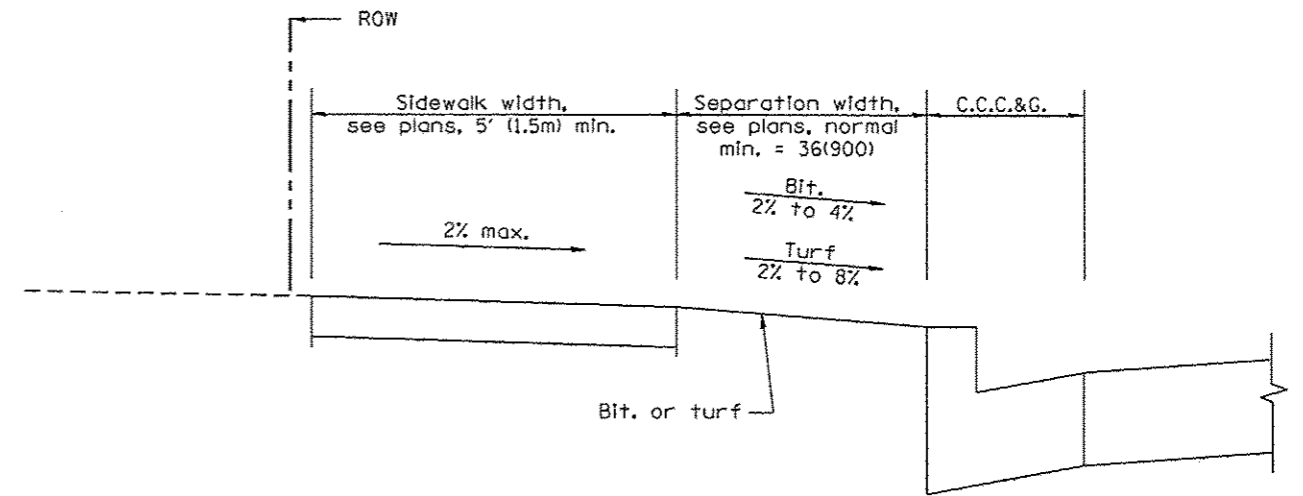

SECTION D-D

All dimensions are in inches (millimeters) unless otherwise noted.

				STATE OF ILLINOIS DEPARTMENT OF TRANSPORTATION		URBAN ENTRANCES, ACCESSIBLE TO THE DISABLED, FOR SEPARATED SIDEWALKS		SHT. 2 OF 2 CADD STD. 423106-D4		F.A. RTE. SECTION COUNTY TOTAL SHEETS SHEET NO. 12-0003-00-SW PEORIA 16 14 CONTRACT NO. 89651	
				NOT TO SCALE						FED. ROAD DIST. NO. ILLINOIS FED. AID PROJECT	

DESIGNER NOTES:
1. Include State Standard 780001 (Typical Pavement Markings)

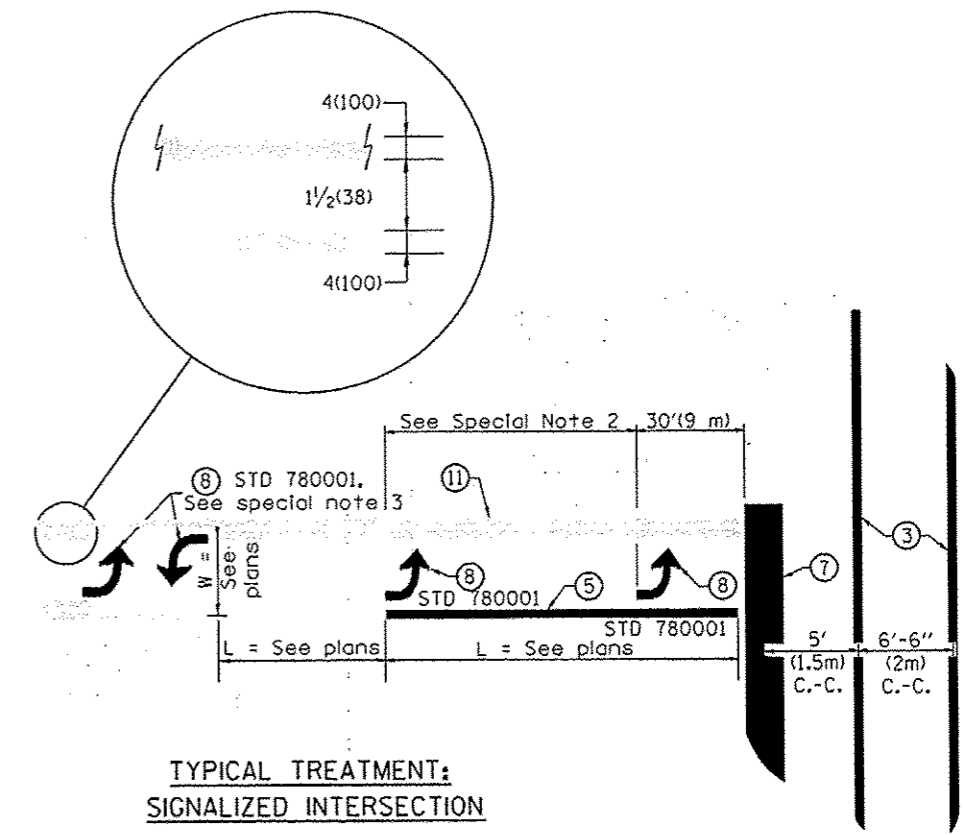
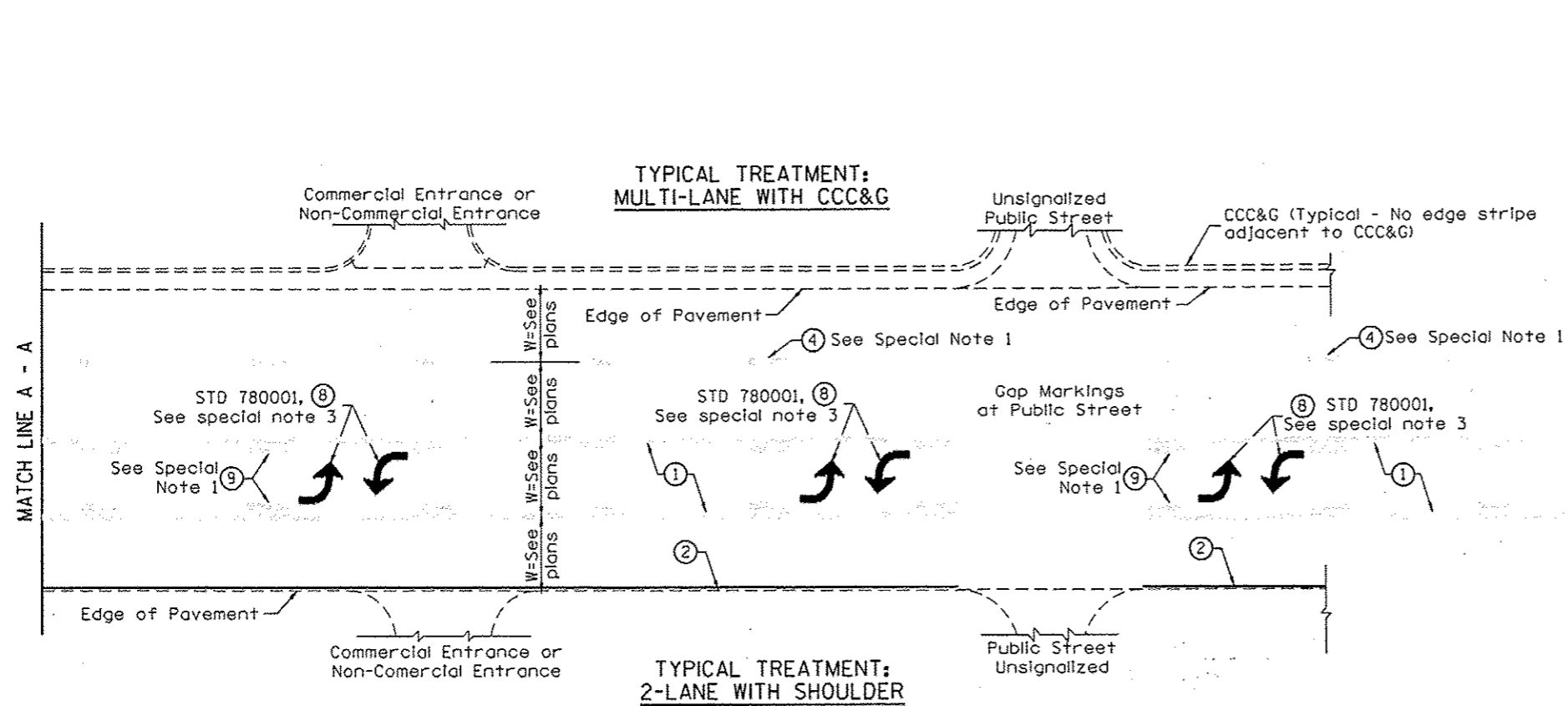

FLUSH PAVED MEDIAN; TWO-WAY LEFT TURN LANE WITH ONE-WAY LEFT TURN LANE AT SIGNALIZED INTERSECTION

TYPICAL PAVEMENT MARKING LEGEND
(Note: This is a District Standard Legend. Some elements may not apply to specific project.)

- ① 4(100) Solid (Yellow)
- ② 4(100) Solid (White)
- ③ 2-6(150) Crosswalk @ 6'-6" (2m)min C.-C. (White)
2-8(200) Crosswalk @ 6'-6" (2m)min C.-C. (White) (When traffic signals are present.)
- ④ 6(150) Skip-Dash (White) (See Special Note 1)
- ⑤ 8(200) Solid (White)
- ⑥ 12(300) Diagonal (White) (Item ⑥ is shown on Std. 780001)
- ⑦ 24(600) Stop Bar (White)
- ⑧ Letters & Arrows (See Std. 780001 and Special Notes 2 & 3)
- ⑨ 4(100) Skip-Dash (Yellow) (See Special Note 1)
- ⑩ 12(300) Diagonal (Yellow) (See Table A)
- ⑪ 4(100) Double Solid (Yellow) (See Table A)

- SPECIAL NOTES**
- Skip-Dash markings will be centered between both ends of city blocks and shall be placed in alignment transversely across the pavement.
 - The following shall apply to arrows located in one-way left turn lanes:
 - A minimum of two (2) arrows is required.
 - The maximum spacing between arrows is 80' (24 m).
 - Arrows shall be evenly spaced if three (3) or more are required.
 - The following shall apply to arrow pairs located in two-way left turn lanes:
 - A minimum of two (2) arrow pairs is required.
 - The maximum spacing between arrow pairs is 200' (61 m).
 - Arrow pairs shall be evenly spaced if three (3) or more are required.
 - The spacing between BI Directional Left Turn Arrows is 33' (10 m).

- GENERAL NOTES**
- Refer to State Standard 780001 for additional Pavement Markings including letters & arrows.
 - See Plans for Pavement Markings adjacent to curbed islands and medians, and through lane reductions.

01-01-97	RENUM. F-8.03, NEW REVISION BOX	T.P.	10-16-06	REVISED TO 2007 SPEC.	STATE OF ILLINOIS DEPARTMENT OF TRANSPORTATION	TYPICAL PAVEMENT MARKINGS	F.A. RTE.	SECTION	COUNTY	TOTAL SHEETS	SHEET NO.
02-07-97	ADD BI DIRECTIONAL DIMENSION	J.A.					12-00003-00-SW	PEORIA	16	15	
10-97	CORRECT BI DIRECTIONAL DIMENSION	J.A.								CONTRACT NO. 89251	
08-02	ADD CROSSWALK DIMNS. WITH T.S.	M.A.									
NOT TO SCALE						SHT. 1 OF 2 CADD STD. 780001-D4		ILLINOIS FED. AID PROJECT			

