

**SOUTHERN ILLINOIS
AIRPORT**

**MURPHYSBORO /
CARBONDALE,
ILLINOIS**

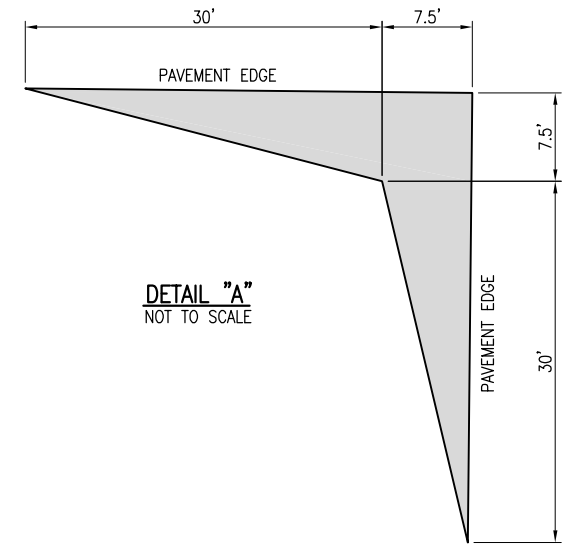

- LEGEND**
- EXISTING PAVEMENT
 - EXISTING PAVEMENT (TO BE REMOVED)
 - PROPOSED IMPROVEMENTS
 - EXISTING ELECTRICAL DUCT
 - EXISTING ELECTRICAL CABLES
 - (E)T EXISTING TELEPHONE CABLE
 - (E)UD EXISTING UNDERDRAIN
 - (E)SS EXISTING STORM SEWER
 - EXISTING STAKE MOUNTED TAXIWAY LIGHT
 - EXISTING TAXI GUIDANCE SIGN

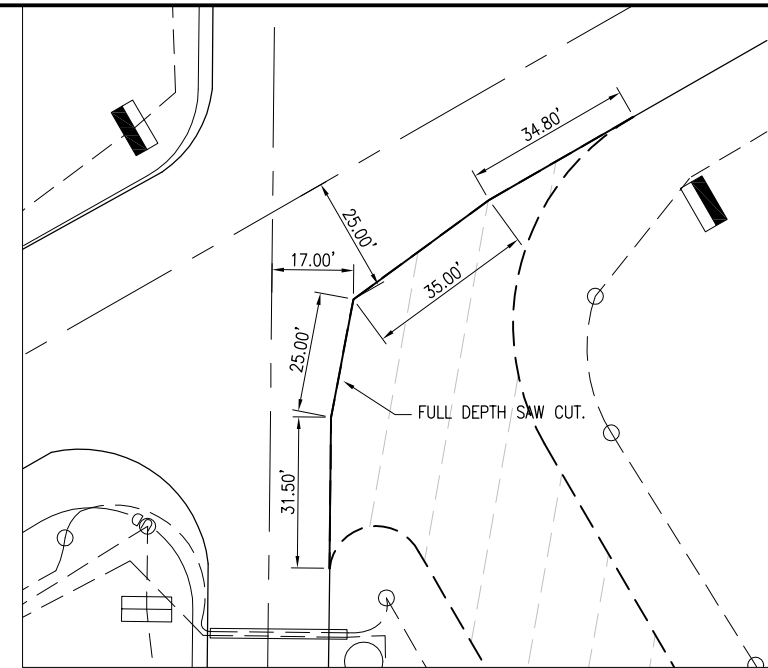
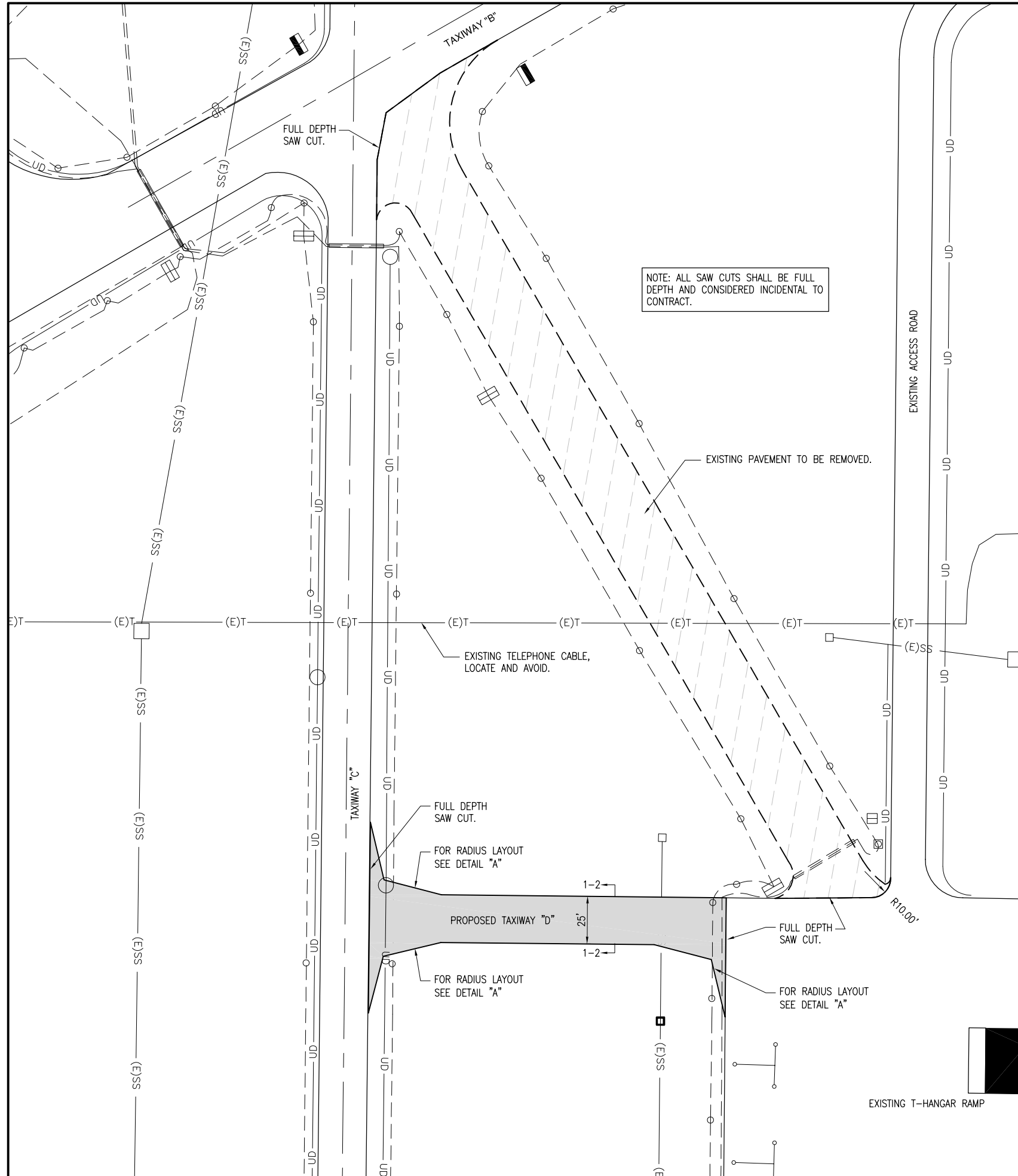
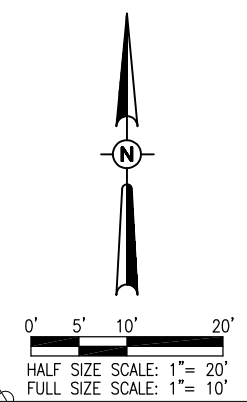
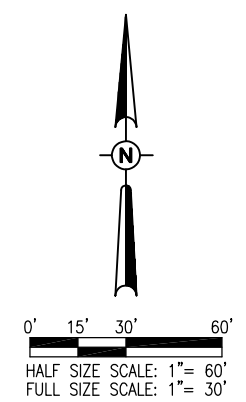

REMOVE TAXIWAY D
IDA No: MDH-4304
Contract No:
SBG No: SBG-TBD

NO.	DATE	DESCRIPTION		
		LAY	DWN	REV

ISSUE: MARCH 07, 2014
PROJECT NO: 13A0083D
CAD FILE: C-1002-CONST.DWG
LAYOUT BY: JSL 02/06/2012
DRAWN BY: CWS 02/06/2012
REVIEWED BY: JSL 03/05/2014
© Copyright Hanson Professional Services Inc. 2014
SHEET TITLE

**PROPOSED
CONSTRUCTION
PLAN**

MAR 05, 2014 11:53 AM SCHUB01446
p:\c\sgl-s\306.hanson.com\hanson\Projects\Documents\13A0083D\CAD\Airport\SheetC-1002-CONST