

INDEX OF SHEETS

STATE STANDARDS

GENERAL NOTES

SHEET NO.

DESCRIPTION

STANDARD NO.

DESCRIPTION

1	COVER SHEET
2	INDEX OF SHEETS, STATE STANDARDS, AND GENERAL NOTES
3	SUMMARY OF QUANTITIES
4	EXISTING AND PROPOSED TYPICAL SECTIONS
5-6	ROADWAY AND PAVEMENT MARKING PLANS
7	PAVEMENT PATCHING FOR HMA SURFACED PAVEMENT (BD-22)
8	BUTT JOINT AND HMA TAPER DETAILS (BD-32)
9	RUMBLE STRIPS FOR CENTERLINE, NON-FREEWAY (BD-55)
10	TRAFFIC CONTROL AND PROTECTION FOR SIDE RAODS, INTERSECTIONS, AND DRIVEWAYS (TC-10)
11	TYPICAL APPLICATIONS RAISED REFLECTIVE PAVEMENT MARKERS (SNOW-PLOW RESISTANT) (TC-11)
12	DISTRICT ONE TYPICAL PAVEMENT MARKINGS (TC-13)
13	SHORT TERM PAVEMENT MARKING LETTERS AND SYMBOLS (TC-16)
14	ARTERIAL ROAD INFORMATION SIGN (TC-22)
15	DRIVEWAY ENTRANCE SIGNING (TC-26)

000001-08	STANDARD SYMBOLS, ABBREVIATIONS, AND PATTERNS
442201-03	CLASS C AND D PATCHES
642006-01	SHOULDER RUMBLE STRIPS, 8 IN.
701006-05	OFF-RD OPERATIONS, 2L, 2W, 15' TO 24" FROM PAVEMENT EDGE
701011-04	OFF-ROAD MOVING OPERATIONS 2L, 2W, DAY ONLY
701201-05	LANE CLOSURE, 2L, 2W, DAY ONLY, FOR SPEEDS ≥ 45 MPH
701301-04	LANE CLOSURE, 2L, 2W, SHORT TIME OPERATIONS
701306-04	LANE CLOSURE, 2L, 2W, SLOW MOVING OPERATIONS DAY ONLY, FRO SPEEDS ≥ 45 MPH
701311-03	LANE CLOSURE, 2L, 2W, MOVING OPERATIONS DAY ONLY
701901-10	TRAFFIC CONTROL DEVICES
780001-05	TYPICAL PAVEMENT MARKINGS
781001-04	TYPICAL APPLICATIONS RAISED REFLECTIVE PAVEMENT MARKERS

1. THE CONTRACTOR WILL NOT BE ALLOWED TO SET UP A YARD OR FIELD OFFICE ON STATE PROPERTY WITHOUT WRITTEN PERMISSION FROM THE DEPARTMENT.
2. ALL MILLED SURFACES SHALL BE A UNIFORM CROSS SLOPE PER LANE AND FREE OF RIDGES BETWEEN PASSES. ANY DEVIATIONS SHALL BE CORRECTED AT NO COST TO THE DEPARTMENT.
3. ALL PAVEMENT PATCHING LOCATIONS WILL BE DETERMINED IN THE FIELD BY THE RESIDENT ENGINEER.
4. IT SHALL BE THE CONTRACTOR'S RESPONSIBILITY TO VERIFY ALL DIMENSIONS AND CONDITIONS EXISTING IN THE FIELD PRIOR TO CONSTRUCTION AND ORDERING OF MATERIALS.
5. FRAMES AND GRATES ADJUSTMENT OF PRIVATE UTILITIES WITHIN THE LIMITS OF IMPROVEMENTS SHALL BE DONE BY THEIR RESPECTIVE OWNERS AND ARE NOT PART OF THIS CONTRACT.
6. THE CONTRACTOR SHALL CONTACT KALPANA KANNAN-HOSADURGA, THE DISTRICT ONE TRAFFIC CONTROL SUPERVISOR, AT KALPANA.KANNAN-HOSADURGA@ILLINOIS.GOV A MINIMUM OF 72 HOURS IN ADVANCE OF BEGINNING WORK.
7. THE RESIDENT ENGINEER SHALL CONTACT BRANDY KENNEDY, AREA TRAFFIC FIELD ENGINEER VIA EMAIL AT BRANDY.KENNEDY@ILLINOIS.GOV A MINIMUM OF TWO (2) WEEKS PRIOR TO THE PLACEMENT OF PERMANENT PAVEMENT MARKINGS.
8. PAVEMENT MARKING TAPE, TYPE IV SHALL BE USED FOR SHORT TERM PAVEMENT MARKINGS ON ALL FINAL SURFACES.
9. ALL PAVEMENT MARKINGS SHALL BE PLACED THROUGHOUT THE IMPROVEMENT ACCORDING TO THE DISTRICT 1 TYPICAL PAVEMENT MARKINGS.
10. ALL RAISED REFLECTIVE PAVEMENT MARKERS SHALL BE PLACED THROUGHOUT THE IMPROVEMENT ACCORDING TO THE DISTRICT 1 TYPICAL APPLICATIONS RAISED REFLECTIVE PAVEMENT MARKERS (SNOW-PLOW RESISTANT)
11. BEFORE BEGINNING ANY WORK, THE CONTRACTOR SHALL RETAIN AND RECORD FOR FUTURE REFERENCE, ALL EXISTING PAVEMENT MARKING LINES (AND RAISED REFLECTIVE PAVEMENT MARKERS) IN ORDER THAT THESE LOCATIONS CAN BE RE-ESTABLISHED FOR STRIPING. EXACT LOCATIONS OF ALL PAVEMENT MARKINGS SHALL BE SHOWN ON THE PLANS OR AS DIRECTED BY THE ENGINEER.
12. BUTT JOINTS WILL BE INSTALLED AT THE ENDS OF ALL RESURFACING (WHERE RESURFACING MEETS EXISTING PAVEMENT) ACCORDING TO THE "BUTT JOINT AND HOT-MIX ASPHALT TAPER DETAILS" SHEET INCLUDED IN THE PLANS, UNLESS OTHERWISE SPECIFIED.
13. OVERNIGHT LANE CLOSURES SHALL NOT BE ALLOWED FOR REHABILITAION PROJECTS INVLOLVING DAYTIME MILLING AND RESURFACING OPERATIONS AND CLASS D PATCHING UNLESS OTHER CONDITIONS WARRANT EXTENDED LANE CLOSURES AS DETERMINED AND APPROVED IN WRITING BY THE ENGINEER OR AS PROVIDED FOR IN THE CONTRACT SPECIFICATIONS.

GENERAL NOTES CONTINUE ON NEXT SHEET

	USER NAME = nicholas.babul	DESIGNED -	REVISED -	STATE OF ILLINOIS DEPARTMENT OF TRANSPORTATION	INDEX OF SHEETS, STATE STANDARDS AND GENERAL NOTES US 20 (GRANT HWY.) [0.2 MI S/E OF HARMONY RD. TO GETTY RD.]			F.A.P. RTE.	SECTION	COUNTY	TOTAL SHEETS	SHEET NO.
		DRAWN -	REVISED -					525	FAP 0525 23 SMART	MCHENRY	15	2
	PLOT SCALE =	CHECKED -	REVISED -					CONTRACT NO. 62V53				
	PLOT DATE = 3/8/2025	DATE -	REVISED -		SCALE:	SHEET 1	OF 1	SHEETS	STA.	TO STA.	ILLINOIS FED. AID PROJECT	

MODEL: GenNotesSh01 [Sheet]
FILE NAME: c:\pw_work\pwtol\nicholas.babul@illinois.gov\0927952\0103124-sht-gennote.dgn

US 20 (GRANT HIGHWAY)

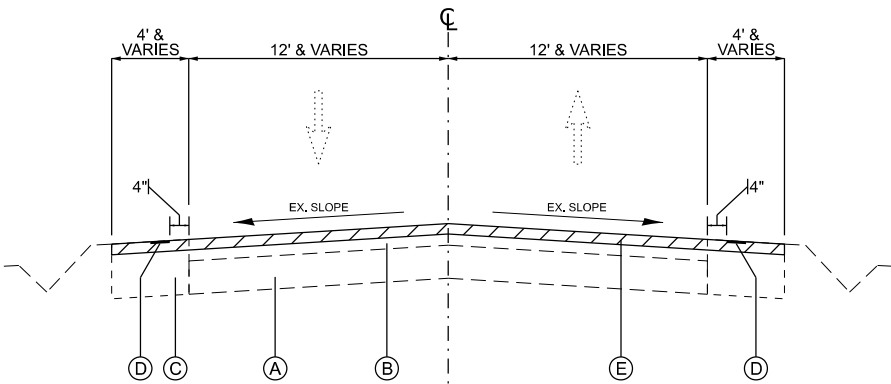

EXISTING TYPICAL SECTION

STA. 14+90 TO STA. 41+36

LEGEND - EXISTING:

- (A) CONCRETE PAVEMENT ±8"
- (B) HOT MIX ASPHALT SURFACE BEFORE MILLING, ±6"
- (C) EXISTING HOT MIX ASPHALT SHOULDER
- (D) EXISTING SHOULDER RUMBLE STRIPS, 8"
- (E) HOT MIX ASPHALT SURFACE REMOVAL 2-1/2"

LEGEND - PROPOSED:

- (1) POLYMERIZED HOT MIX ASPHALT SURFACE COURSE, IL-9.5, MIX "E", N70, 1-3/4"
- (2) POLYMERIZED HOT MIX ASPHALT BINDER COURSE, IL-4.75, N50, 3/4"
- (3) PROPOSED SHOULDER RUMBLE STRIPS, 8"
- (4) PROPOSED CENTERLINE RUMBLE STRIPS, 16"

NOTES:

- THE CONTRACTOR SHALL MILL FIRST BEFORE PATCHING.
- THE LONGITUDINAL JOINT SEALANT SHALL BE PLACED ON THE POLYMERIZED HMA BINDER COURSE IL-4.75.

HOT-MIX ASPHALT MIXTURE REQUIREMENTS		QUALITY MANAGEMENT PROGRAM (QMP)
MIXTURE TYPE	AIR VOIDS(%) @ Ndes	
PAVEMENT RESURFACING		
POLYMERIZED HOT MIX ASPHALT SURFACE COURSE, IL-9.5, MIX "E", N70, 1-3/4"	4% @ 70 GYR.	QC/QA
POLYMERIZED HOT MIX ASPHALT BINDER COURSE, IL-4.75, N50, 3/4"	3.5% @ 50 GYR.	QC/QA
PATCHING		
CLASS D PATCHES (HMA BINDER IL-19.0)	4% @ 70 GYR.	QC/QA
QMP DESIGNATION: QUALITY CONTROL/QUALITY ASSURANCE (QC/QA); QUALITY CONTROL FOR PERFORMANCE (QCP); PAY FOR PERFORMANCE (PFP)		

- NOTE 1: THE UNIT WEIGHT USED TO CALCULATE ALL HMA SURFACE MIXTURE QUANTITIES IS 112 LBS/SQ YD/IN.
- NOTE 2: THE "AC TYPE" FOR POLYMERIZED HMA MIXES SHALL BE "SBS/SBR PG 76-22" AND FOR NON-POLYMERIZED HMA THE "AC TYPE" SHALL BE "PG 64-22" UNLESS MODIFIED BY RECLAIMED MATERIALS SPECIFICATIONS.

US 20 (GRANT HIGHWAY)

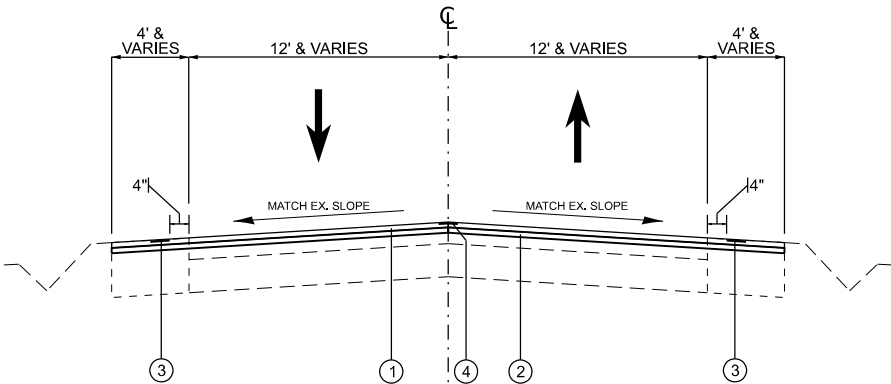

PRPOSED TYPICAL SECTION

STA. 14+90 TO STA. 41+36

1 REVISED ENTIRE SHEET 4/7/2025

STATE OF ILLINOIS
DEPARTMENT OF TRANSPORTATION

EXISTING AND PROPOSED TYPICAL SECTIONS
US 20 (GRANT HWY.) [0.2 MI S/E OF HARMONY RD. TO GETTY RD.]

SCALE: SHEET 1 OF 1 SHEETS STA. TO STA.

F.A.P. RTE.	SECTION	COUNTY	TOTAL SHEETS	SHEET NO.
525	FAP 0525 23 SMART	MCHENRY	15	4
CONTRACT NO. 62V53				

ILLINOIS FED. AID PROJECT

MODEL: Typical Section 1 [Sheet]
FILE NAME: c:\pawork\pawork\nicholas.babul\03124-sh-typical.dgn

USER NAME = nicholas.babul	DESIGNED -	REVISED -
	DRAWN -	REVISED -
	CHECKED -	REVISED -
PLOT DATE = 12/4/2024	DATE -	REVISED -

MODEL: ExCL - Plan 1 [Sheet]
FILE NAME: c:\pwr_work\pwr\id\intcholas.babul\03124-sh-plan.dgn

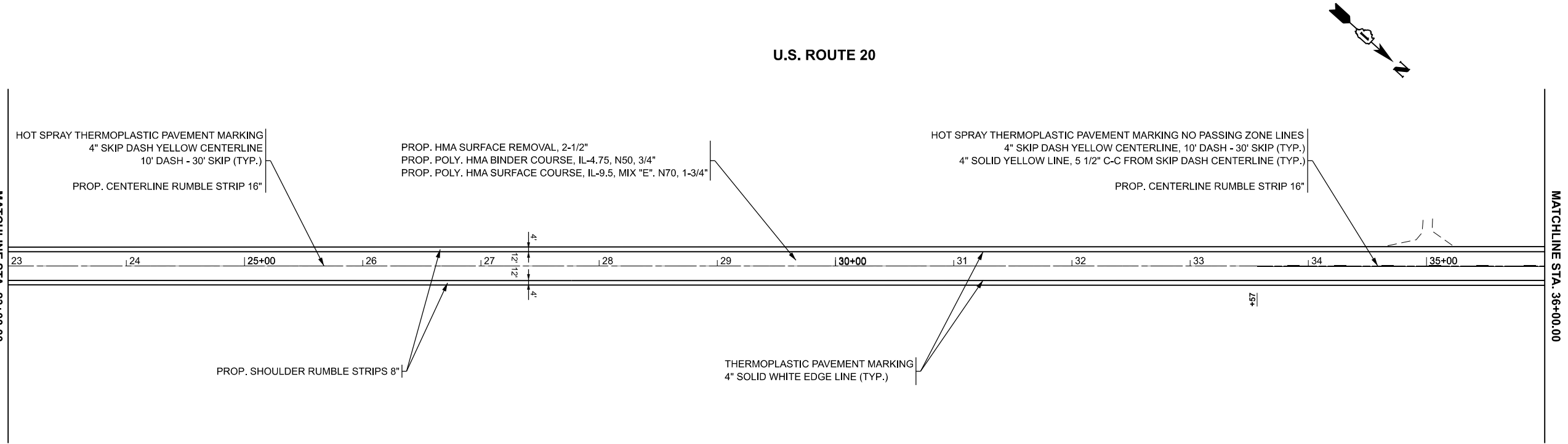
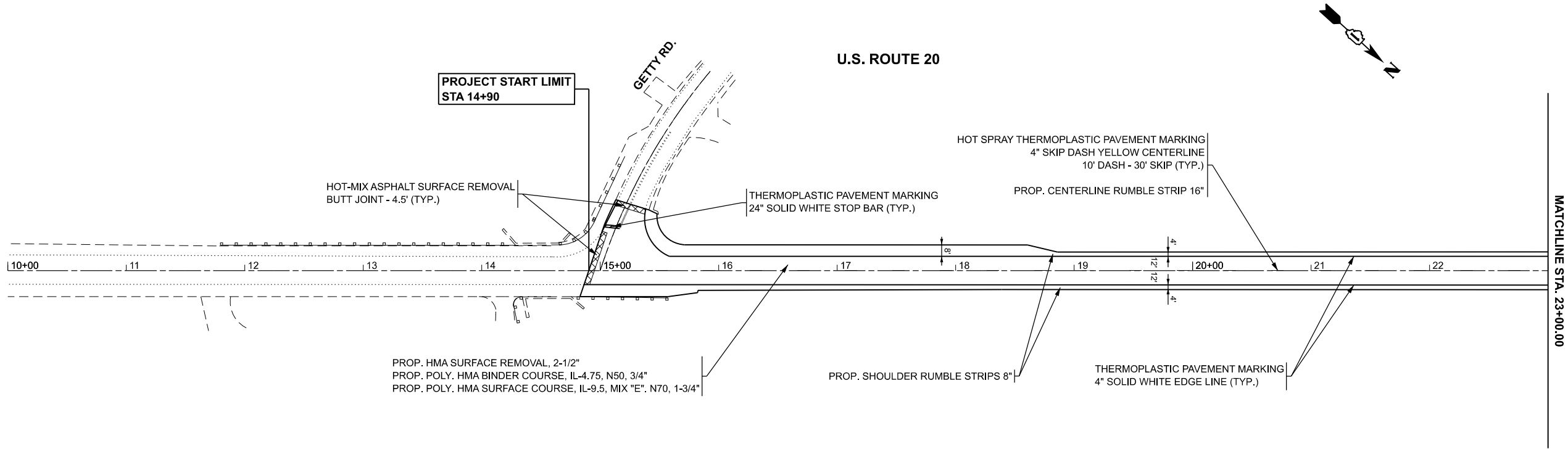

1 REVISED ENTIRE SHEET 4/7/2025

USER NAME	= nicholas.babul	DESIGNED	-	REVISED	-
		DRAWN	-	REVISED	-
PLOT SCALE	= 100' / in.	CHECKED	-	REVISED	-
PLOT DATE	= 3/8/2025	DATE	-	REVISED	-

STATE OF ILLINOIS
DEPARTMENT OF TRANSPORTATION

ROADWAY AND PAVEMENT MARKING PLAN
US 20 (GRANT HWY.) [0.2 MI S/E OF HARMONY RD. TO GETTY RD.]

SCALE: 1"=50' SHEET 1 OF 2 SHEETS STA. 10+00.00 TO STA. 36+00.00

F.A.P. RTE.	SECTION	COUNTY	TOTAL SHEETS	SHEET NO.
525	FAP 0525 23 SMART	MCHENRY	15	5
CONTRACT NO. 62V53				
ILLINOIS FED. AID PROJECT				

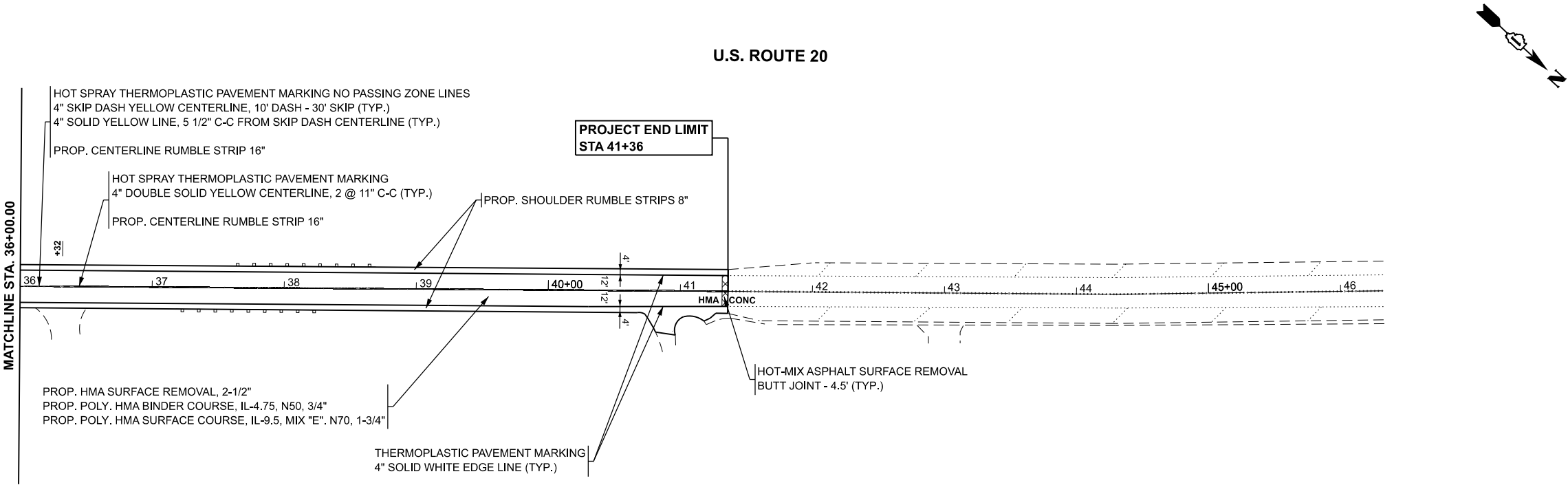

MODEL: EXCL - Plan 3 [Sheet]
FILE NAME: c:\p\work\p\id\intcholas.babul\illinois.gov\0827952\03\24-sh-plan.dgn

REVISED ENTIRE SHEET 4/7/2025

	USER NAME = nicholas.babul	DESIGNED -	REVISED -	STATE OF ILLINOIS DEPARTMENT OF TRANSPORTATION	ROADWAY AND PAVEMENT MARKING PLAN US 20 (GRANT HWY.) [0.2 MI S/E OF HARMONY RD. TO GETTY RD.]				F.A.P. RTE.	SECTION	COUNTY	TOTAL SHEETS	SHEET NO.
	PLOT SCALE = 100' / In.	DRAWN -	REVISED -						525	FAP 0525 23 SMART	MCHENRY	15	6
	PLOT DATE = 3/8/2025	CHECKED -	REVISED -		SCALE: 1"=50'		CONTRACT NO. 62V53						
		DATE -	REVISED -		SHEET 2	OF 2 SHEETS	STA. 36+00.00	TO STA. 49+00.00					
											ILLINOIS FED. AID PROJECT		