

STATE OF ILLINOIS
DEPARTMENT OF TRANSPORTATION

F.A.P. RTE.	SECTION	COUNTY	TOTAL SHEETS	SHEET NO.
525	FAP 0525 23 SMART	MCHENRY	15	1
		ILLINOIS	CONTRACT NO. 62V53	

FOR INDEX OF SHEETS, SEE SHEET NO. 2

**THE PROJECT IS LOCATED WITHIN:
CORAL TOWNSHIP**

TRAFFIC DATA

2023 ADT - 7,850
POSTED SPEED LIMIT - 45 MPH
OTHER PRINCIPAL ARTERIAL

PROPOSED HIGHWAY PLANS

**F.A.P. ROUTE 525: US 20 (GRANT HWY)
0.2 MI SE OF HARMONY ROAD TO GETTY ROAD
SECTION: FAP 0525 23 SMART
PROJECT: NHPP-AZW1(947)
STANDARD OVERLAY
MCHENRY COUNTY**

C-91-036-24

**PROJECT ENDS
STA. 41+36**

T 43 N

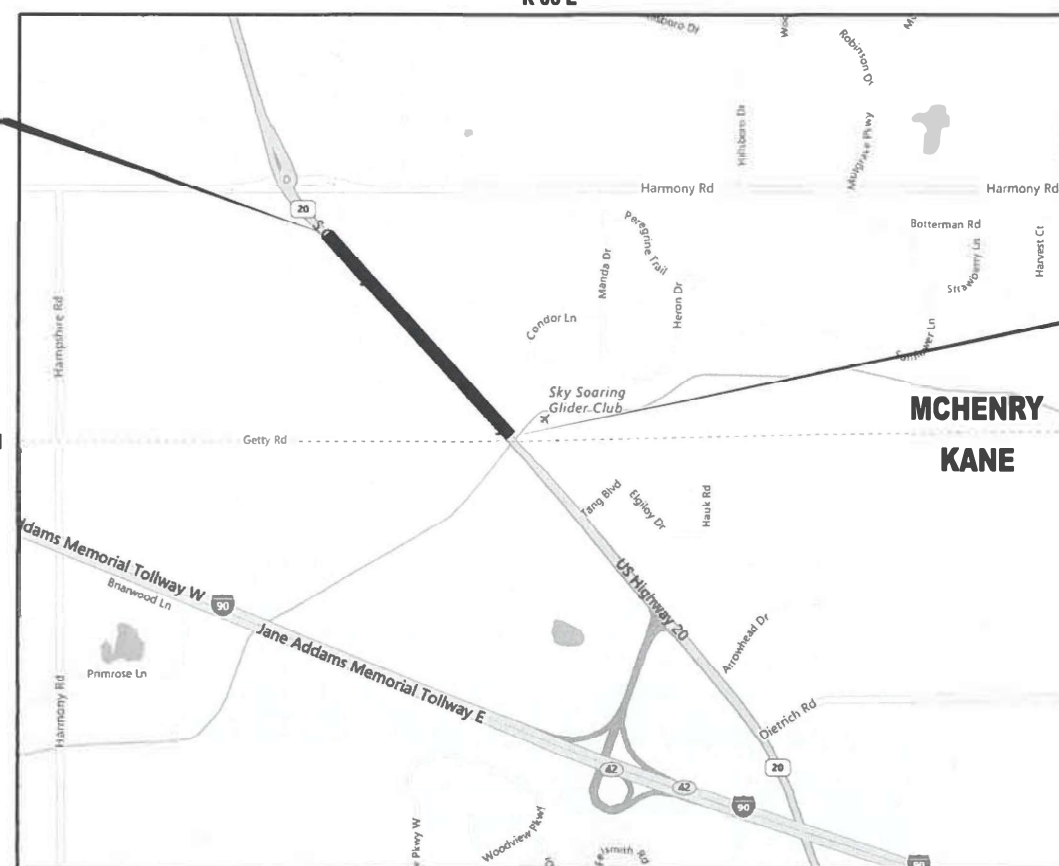

CORAL TOWNSHIP

GROSS LENGTH = NET LENGTH = 2646.0 FT. = 0.50 MILE



LOCATION MAP
(NOT TO SCALE)

**PROJECT BEGINS
STA. 14+90**

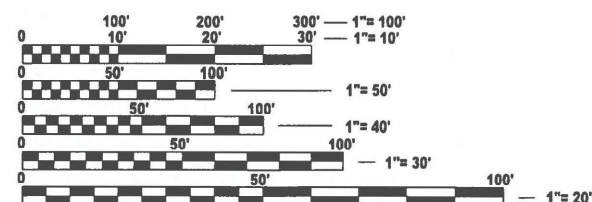

FULL SIZE PLANS HAVE BEEN PREPARED USING STANDARD ENGINEERING SCALES. REDUCED SIZED PLANS WILL NOT CONFORM TO STANDARD SCALES. IN MAKING MEASUREMENTS ON REDUCED PLANS, THE ABOVE SCALES MAY BE USED.

J.U.L.I.E.
JOINT UTILITY LOCATION INFORMATION FOR EXCAVATION
1-800-892-0123
OR 811

PROJECT ENGINEER: LUKASZ POCIECHA (847) 705-4255
PROJECT MANAGER: VESELIN VELICHKOV

CONTRACT NO. 62V53

D-91-031-24

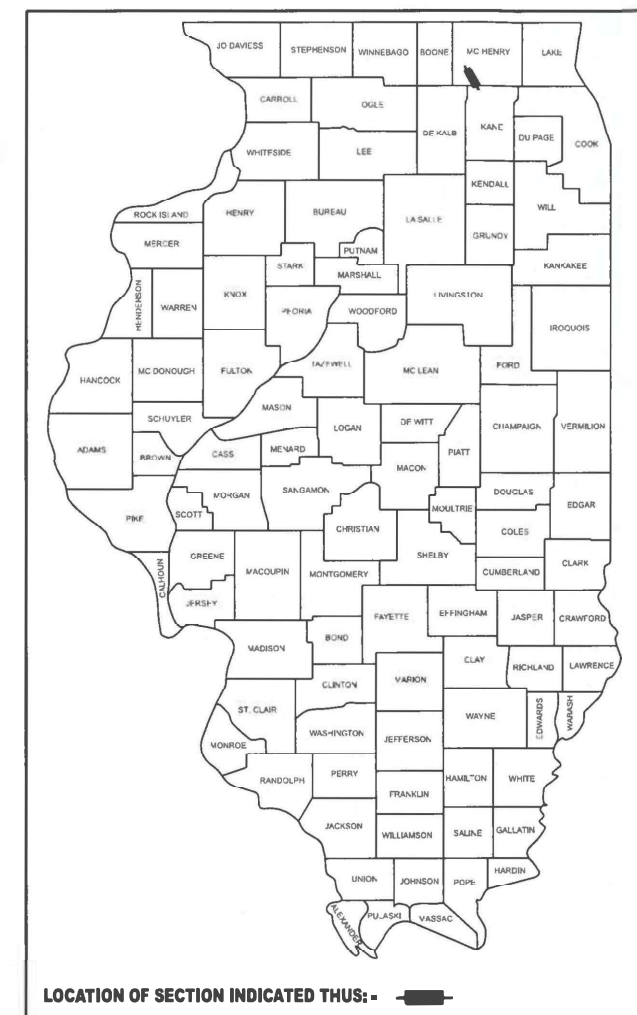

LOCATION OF SECTION INDICATED THUS: -

STATE OF ILLINOIS
DEPARTMENT OF TRANSPORTATION

SUBMITTED Jan 29th 2025 IR REGIONAL ENGINEER

March 21, 2025 Scott A. Etkin
ENGINEER OF DESIGN AND ENVIRONMENT

March 21, 2025 John J. Barry
DIRECTOR OF HIGHWAYS PROJECT IMPLEMENTATION

**PRINTED BY THE AUTHORITY
OF THE STATE OF ILLINOIS**

INDEX OF SHEETS

STATE STANDARDS

GENERAL NOTES

SHEET NO.

DESCRIPTION

STANDARD NO.

DESCRIPTION

1	COVER SHEET
2	INDEX OF SHEETS, STATE STANDARDS, AND GENERAL NOTES
3	SUMMARY OF QUANTITIES
4	EXISTING AND PROPOSED TYPICAL SECTIONS
5-6	ROADWAY AND PAVEMENT MARKING PLANS
7	PAVEMENT PATCHING FOR HMA SURFACED PAVEMENT (BD-22)
8	BUTT JOINT AND HMA TAPER DETAILS (BD-32)
9	RUMBLE STRIPS FOR CENTERLINE, NON-FREEWAY (BD-55)
10	TRAFFIC CONTROL AND PROTECTION FOR SIDE RAODS, INTERSECTIONS, AND DRIVEWAYS (TC-10)
11	TYPICAL APPLICATIONS RAISED REFLECTIVE PAVEMENT MARKERS (SNOW-PLOW RESISTANT) (TC-11)
12	DISTRICT ONE TYPICAL PAVEMENT MARKINGS (TC-13)
13	SHORT TERM PAVEMENT MARKING LETTERS AND SYMBOLS (TC-16)
14	ARTERIAL ROAD INFORMATION SIGN (TC-22)
15	DRIVEWAY ENTRANCE SIGNING (TC-26)

000001-08	STANDARD SYMBOLS, ABBREVIATIONS, AND PATTERNS
442201-03	CLASS C AND D PATCHES
642001-03	SHOULDER RUMBLE STRIPS, 16 IN.
701006-05	OFF-RD OPERATIONS, 2L, 2W, 15' TO 24" FROM PAVEMENT EDGE
701011-04	OFF-ROAD MOVING OPERATIONS 2L, 2W, DAY ONLY
701201-05	LANE CLOSURE, 2L, 2W, DAY ONLY, FOR SPEEDS ≥ 45 MPH
701301-04	LANE CLOSURE, 2L, 2W, SHORT TIME OPERATIONS
701306-04	LANE CLOSURE, 2L, 2W, SLOW MOVING OPERATIONS DAY ONLY, FRO SPEEDS ≥ 45 MPH
701311-03	LANE CLOSURE, 2L, 2W, MOVING OPERATIONS DAY ONLY
701901-10	TRAFFIC CONTROL DEVICES
780001-05	TYPICAL PAVEMENT MARKINGS
781001-04	TYPICAL APPLICATIONS RAISED REFLECTIVE PAVEMENT MARKERS

1. THE CONTRACTOR WILL NOT BE ALLOWED TO SET UP A YARD OR FIELD OFFICE ON STATE PROPERTY WITHOUT WRITTEN PERMISSION FROM THE DEPARTMENT.
2. ALL MILLED SURFACES SHALL BE A UNIFORM CROSS SLOPE PER LANE AND FREE OF RIDGES BETWEEN PASSES. ANY DEVIATIONS SHALL BE CORRECTED AT NO COST TO THE DEPARTMENT.
3. ALL PAVEMENT PATCHING LOCATIONS WILL BE DETERMINED IN THE FIELD BY THE RESIDENT ENGINEER.
4. IT SHALL BE THE CONTRACTOR'S RESPONSIBILITY TO VERIFY ALL DIMENSIONS AND CONDITIONS EXISTING IN THE FIELD PRIOR TO CONSTRUCTION AND ORDERING OF MATERIALS.
5. FRAMES AND GRATES ADJUSTMENT OF PRIVATE UTILITIES WITHIN THE LIMITS OF IMPROVEMENTS SHALL BE DONE BY THEIR RESPECTIVE OWNERS AND ARE NOT PART OF THIS CONTRACT.
6. THE CONTRACTOR SHALL CONTACT KALPANA KANNAN-HOSADURGA, THE DISTRICT ONE TRAFFIC CONTROL SUPERVISOR, AT KALPANA.KANNAN-HOSADURGA@ILLINOIS.GOV A MINIMUM OF 72 HOURS IN ADVANCE OF BEGINNING WORK.
7. THE RESIDENT ENGINEER SHALL CONTACT WALTER CZARNY, AREA TRAFFIC FIELD ENGINEER VIA EMAIL AT WALTER.CZARNY@ILLINOIS.GOV A MINIMUM OF TWO (2) WEEKS PRIOR TO THE PLACEMENT OF PERMANENT PAVEMENT MARKINGS.
8. PAVEMENT MARKING TAPE, TYPE IV SHALL BE USED FOR SHORT TERM PAVEMENT MARKINGS ON ALL FINAL SURFACES.
9. ALL PAVEMENT MARKINGS SHALL BE PLACED THROUGHOUT THE IMPROVEMENT ACCORDING TO THE DISTRICT 1 TYPICAL PAVEMENT MARKINGS.
10. ALL RAISED REFLECTIVE PAVEMENT MARKERS SHALL BE PLACED THROUGHOUT THE IMPROVEMENT ACCORDING TO THE DISTRICT 1 TYPICAL APPLICATIONS RAISED REFLECTIVE PAVEMENT MARKERS (SNOW-PLOW RESISTANT)
11. BEFORE BEGINNING ANY WORK, THE CONTRACTOR SHALL RETAIN AND RECORD FOR FUTURE REFERENCE, ALL EXISTING PAVEMENT MARKING LINES (AND RAISED REFLECTIVE PAVEMENT MARKERS) IN ORDER THAT THESE LOCATIONS CAN BE RE-ESTABLISHED FOR STRIPING. EXACT LOCATIONS OF ALL PAVEMENT MARKINGS SHALL BE SHOWN ON THE PLANS OR AS DIRECTED BY THE ENGINEER.
12. BUTT JOINTS WILL BE INSTALLED AT THE ENDS OF ALL RESURFACING (WHERE RESURFACING MEETS EXISTING PAVEMENT) ACCORDING TO THE "BUTT JOINT AND HOT-MIX ASPHALT TAPER DETAILS" SHEET INCLUDED IN THE PLANS, UNLESS OTHERWISE SPECIFIED.
13. OVERNIGHT LANE CLOSURES SHALL NOT BE ALLOWED FOR REHABILITAION PROJECTS INVOLVING DAYTIME MILLING AND RESURFACING OPERATIONS AND CLASS D PATCHING UNLESS OTHER CONDITIONS WARRANT EXTENDED LANE CLOSURES AS DETERMINED AND APPROVED IN WRITING BY THE ENGINEER OR AS PROVIDED FOR IN THE CONTRACT SPECIFICATIONS.

GENERAL NOTES CONTINUE ON NEXT SHEET

	USER NAME = nicholas.babul	DESIGNED -	REVISED -	STATE OF ILLINOIS DEPARTMENT OF TRANSPORTATION	INDEX OF SHEETS, STATE STANDARDS AND GENERAL NOTES US 20 (GRANT HWY.) [0.2 MI S/E OF HARMONY RD. TO GETTY RD.]			F.A.P. RTE.	SECTION	COUNTY	TOTAL SHEETS	SHEET NO.
		DRAWN -	REVISED -					525	FAP 0525 23 SMART	MCHENRY	15	2
	PLOT SCALE =	CHECKED -	REVISED -					CONTRACT NO. 62V53				
	PLOT DATE = 12/2/2024	DATE -	REVISED -		SCALE:	SHEET 1	OF 1	SHEETS	STA.	TO STA.	ILLINOIS FED. AID PROJECT	

MODEL: GenNotesSh01 [Sheet]
FILE NAME: c:\pwwork\pwwork\nicholas.babul\illinois.gov\0927952\03124-sh-gennote.dgn

MODEL: SOQ01 [Sheet]
FILE NAME: c:\p\work\pww\tdm\nicolas.babul\illinois.gov\0927952\0103124-sh-SOQ.dgn

SUMMARY OF QUANTITIES				TOTAL QUANTITIES	CONSTRUCTION TYPE CODE						SUMMARY OF QUANTITIES				TOTAL QUANTITIES	CONSTRUCTION TYPE CODE							
CODE NO.	ITEM		UNIT		0005 80% FED 20% STATE ROADWAY	0005 100% STATE					CODE NO.	ITEM		UNIT		0005 80% FED 20% STATE ROADWAY	0005 100% STATE						
40600290	BITUMINOUS MATERIALS (TACK COAT)		POUND	6770	6770						78300200	RAISED REFLECTIVE PAVEMENT MARKER REMOVAL		EACH	43	43							
40600370	LONGITUDINAL JOINT SEALANT		FOOT	2646	2646						78300202	PAVEMENT MARKING REMOVAL - WATER BLASTING		SQ FT	2419	2419							
40600400	MIXTURE FOR CRACKS, JOINTS, AND FLANGEWAYS		TON	16	16						X6420114	CENTER LINE - RUMBLE STRIP - 16"		FOOT	2578	2578							
40600982	HOT-MIX ASPHALT SURFACE REMOVAL - BUTT JOINT		SQ YD	76	76						X6700407	ENGINEER'S FIELD OFFICE, TYPE A (D1)		CAL MO	6	6							
40603200	POLYMERIZED HOT-MIX ASPHALT BINDER COURSE, IL 4.75, N50		TON	414	414						★ X7800815	HOT SPRAY THERMOPLASTIC PAVEMENT MARKING LINE - 4 INCH		FOOT	1877	1877							
40604172	POLYMERIZED HOT-MIX ASPHALT SURFACE COURSE, IL-9.5, MIX "E", N70		TON	983	983						Z0013798	CONSTRUCTION LAYOUT		L SUM	1	1							
44000159	HOT-MIX ASPHALT SURFACE REMOVAL, 2 1/2"		SQ YD	10030	10030						Z0030850	TEMPORARY INFORMATION SIGNING		SQ FT	73.8	73.8							
44201785	CLASS D PATCHES, TYPE I, 12 INCH		SQ YD	25	25																		
44201789	CLASS D PATCHES, TYPE II, 12 INCH		SQ YD	100	100																		
44201794	CLASS D PATCHES, TYPE III, 12 INCH		SQ YD	50	50																		
44201796	CLASS D PATCHES, TYPE IV, 12 INCH		SQ YD	25	25																		
60920015	PIPE CULVERTS TO BE CLEANED 15"		FOOT	300		300																	
64200116	SHOULDER RUMBLE STRIPS, 16 INCH		FOOT	5224	5224																		
67100100	MOBILIZATION		L SUM	1	1																		
70100450	TRAFFIC CONTROL AND PROTECTION, STANDARD 701201		L SUM	1	1																		
70100460	TRAFFIC CONTROL AND PROTECTION, STANDARD 701306		L SUM	1	1																		
70300100	SHORT TERM PAVEMENT MARKING		FOOT	6427	6427																		
70300150	SHORT TERM PAVEMENT MARKING REMOVAL		SQ FT	2143	2143																		
70300221	TEMPORARY PAVEMENT MARKING - LINE 4" - PAINT		FOOT	21537	21537																		
70300281	TEMPORARY PAVEMENT MARKING - LINE 24" - PAINT		FOOT	39	39																		
★ 78000200	THERMOPLASTIC PAVEMENT MARKING - LINE 4"		FOOT	5302	5302																		
★ 78000650	THERMOPLASTIC PAVEMENT MARKING - LINE 24"		FOOT	13	13																		
★ 78100100	RAISED REFLECTIVE PAVEMENT MARKER		EACH	43	43																		
																				★ = SPECIALTY ITEMS			
		USER NAME = nicholas.babul		DESIGNED -		REVISED -		STATE OF ILLINOIS DEPARTMENT OF TRANSPORTATION				SUMMARY OF QUANTITIES US 20 (GRANT HWY.) [0.2 MI S/E OF HARMONY RD. TO GETTY RD.]				F.A.P. RTE. 525		SECTION FAP 0525 23 SMART		COUNTY MCHENRY	TOTAL SHEETS 15	SHEET NO. 3	
		PLOT SCALE =		DRAWN -		REVISED -										CONTRACT NO. 62V53							
		PLOT DATE = 12/9/2024		CHECKED -		REVISED -																	
				DATE -		REVISED -																	

US 20 (GRANT HIGHWAY)

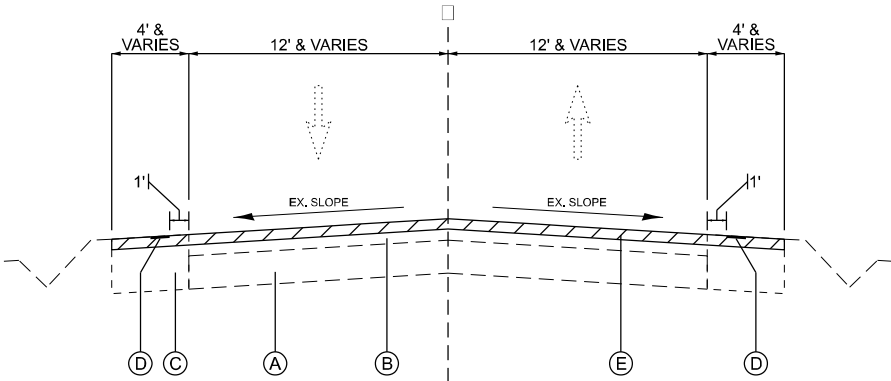

EXISTING TYPICAL SECTION

STA. 14+90 TO STA. 41+36

LEGEND - EXISTING:

- (A) CONCRETE PAVEMENT ±8"
- (B) HOT MIX ASPHALT SURFACE BEFORE MILLING, ±6"
- (C) EXISTING HOT MIX ASPHALT SHOULDER
- (D) EXISTING SHOULDER RUMBLE STRIPS, 16"
- (E) HOT MIX ASPHALT SURFACE REMOVAL 2-1/2"

LEGEND - PROPOSED:

- ① POLYMERIZED HOT MIX ASPHALT SURFACE COURSE, IL-9.5, MIX "E", N70, 1-3/4"
- ② POLYMERIZED HOT MIX ASPHALT BINDER COURSE, IL-4.75, N50, 3/4"
- ③ PROPOSED SHOULDER RUMBLE STRIPS, 16"
- ④ PROPOSED CENTERLINE RUMBLE STRIPS, 16"

NOTES:

- THE CONTRACTOR SHALL MILL FIRST BEFORE PATCHING.
- THE LONGITUDINAL JOINT SEALANT SHALL BE PLACED ON THE POLYMERIZED HMA BINDER COURSE IL-4.75.

US 20 (GRANT HIGHWAY)

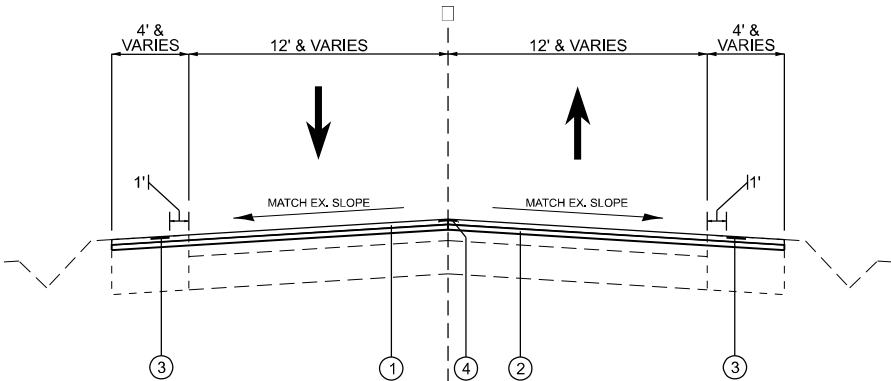

PRPOSED TYPICAL SECTION

STA. 14+90 TO STA. 41+36

HOT-MIX ASPHALT MIXTURE REQUIREMENTS		QUALITY MANAGEMENT PROGRAM (QMP)
MIXTURE TYPE	AIR VOIDS(%) @ Ndes	
PAVEMENT RESURFACING		
POLYMERIZED HOT MIX ASPHALT SURFACE COURSE, IL-9.5, MIX "E", N70, 1-3/4"	4% @ 70 GYR.	QC/QA
POLYMERIZED HOT MIX ASPHALT BINDER COURSE, IL-4.75, N50, 3/4"	3.5% @ 50 GYR.	QC/QA
PATCHING		
CLASS D PATCHES (HMA BINDER IL-19.0)	4% @ 70 GYR.	QC/QA
QMP DESIGNATION: QUALITY CONTROL/QUALITY ASSURANCE (QC/QA); QUALITY CONTROL FOR PERFORMANCE (QCP); PAY FOR PERFORMANCE (PFP)		

- NOTE 1: THE UNIT WEIGHT USED TO CALCULATE ALL HMA SURFACE MIXTURE QUANTITIES IS 112 LBS/SQ YD/IN.
- NOTE 2: THE "AC TYPE" FOR POLYMERIZED HMA MIXES SHALL BE "SBS/SBR PG 76-22" AND FOR NON-POLYMERIZED HMA THE "AC TYPE" SHALL BE "PG 64-22" UNLESS MODIFIED BY RECLAIMED MATERIALS SPECIFICATIONS.

MODEL: Typical Section 1 [Sheet]
FILE NAME: c:\p\work\pwt\intcholas.babul\illinois.gov\0827952\03124-sh-typical.dgn

	USER NAME = nicholas.babul	DESIGNED -	REVISED -	STATE OF ILLINOIS DEPARTMENT OF TRANSPORTATION	EXISTING AND PROPOSED TYPICAL SECTIONS US 20 (GRANT HWY.) [0.2 MI S/E OF HARMONY RD. TO GETTY RD.]		F.A.P. RTE.	SECTION	COUNTY	TOTAL SHEETS	SHEET NO.
		DRAWN -	REVISED -				525	FAP 0525 23 SMART	MCHENRY	15	4
		CHECKED -	REVISED -				CONTRACT NO. 62V53				
	PLOT DATE = 12/4/2024	DATE -	REVISED -				ILLINOIS FED. AID PROJECT				
SCALE:		SHEET 1	OF 1	SHEETS	STA.	TO STA.					

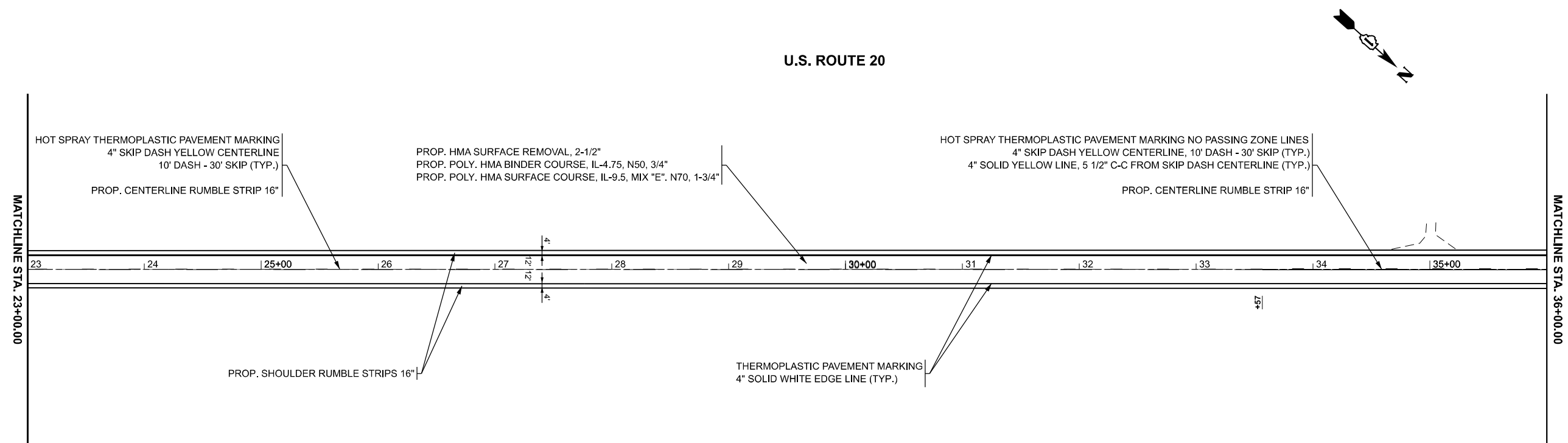
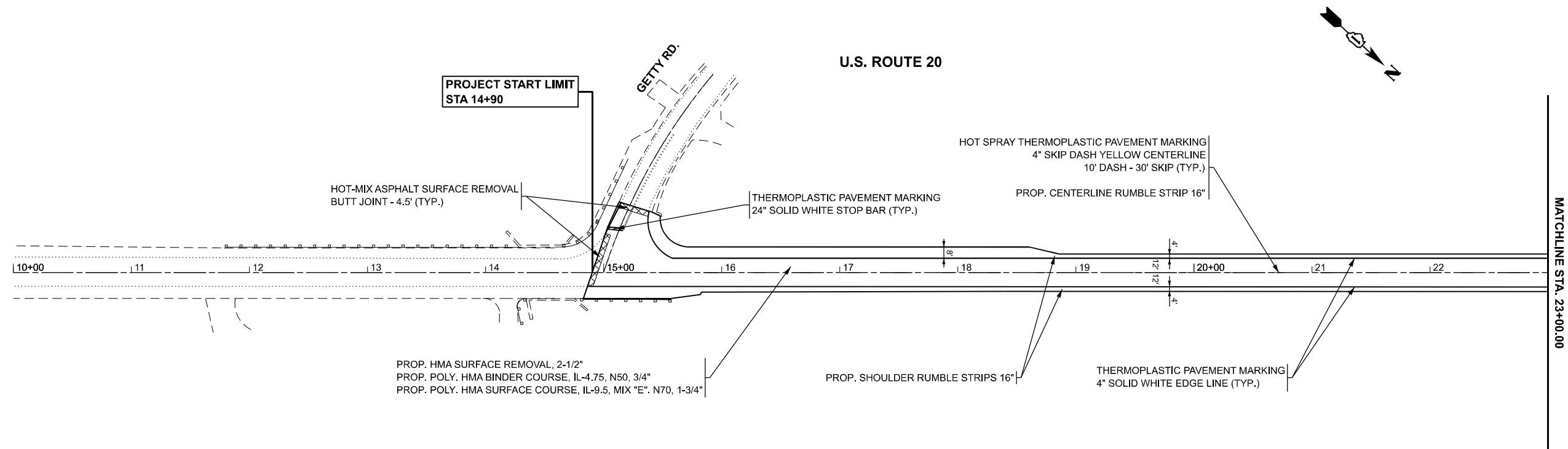

F.A.P. RTE.	SECTION	COUNTY	TOTAL SHEETS	SHEET NO.
525	FAP 0525 23 SMART	MCHENRY	15	5
		CONTRACT NO. 62V53		
ILLINOIS		FED. AID PROJECT		

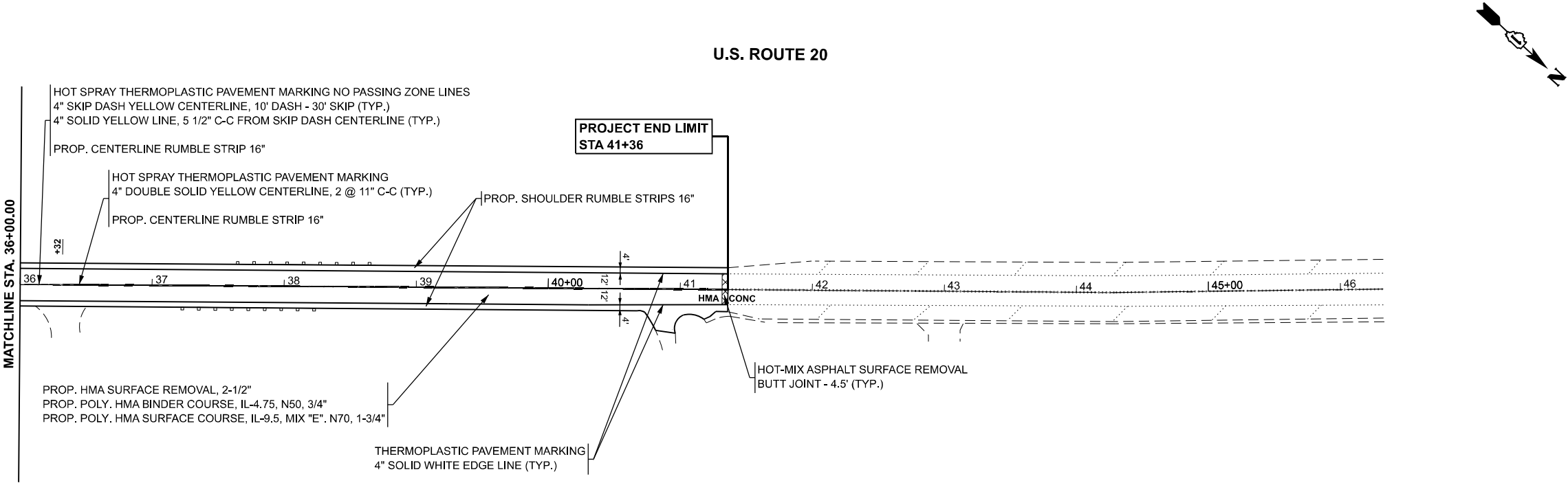

MODEL: EXCL - Plan 3 (Sheet)
FILE NAME: c:\p\work\p\work\illinois.gov\0827952\103124-sh-plan.dgn

	USER NAME = nicholas.babul	DESIGNED -	REVISED -	STATE OF ILLINOIS DEPARTMENT OF TRANSPORTATION	ROADWAY AND PAVEMENT MARKING PLAN US 20 (GRANT HWY.) [0.2 MI S/E OF HARMONY RD. TO GETTY RD.]			F.A.P. RTE.	SECTION	COUNTY	TOTAL SHEETS	SHEET NO.
	PLOT SCALE = 100' / in.	DRAWN -	REVISED -					525	FAP 0525 23 SMART	MCHENRY	15	6
	PLOT DATE = 12/4/2024	CHECKED -	REVISED -		SCALE: 1"=50'			CONTRACT NO. 62V53				
		DATE -	REVISED -		SHEET 2	OF 2	SHEETS	STA. 36+00.00	TO STA. 49+00.00	ILLINOIS FED. AID PROJECT		

METHOD OF MEASUREMENT

REFER TO SECTION 442 OF THE STANDARD SPECIFICATIONS FOR ROAD AND BRIDGE CONSTRUCTION AND THE RECURRING SPECIAL PROVISION "PATCHING WITH HOT-MIX ASPHALT OVERLAY REMOVAL."

BASIS OF PAYMENT

- 1. REFER TO SECTION 442 OF THE STANDARD SPECIFICATIONS FOR ROAD AND BRIDGE CONSTRUCTION AND THE RECURRING SPECIAL PROVISION "PATCHING WITH HOT-MIX ASPHALT OVERLAY REMOVAL."
- 2. SAW CUT/SCORING OF EXISTING HMA OVERLAY IS INCLUDED IN THE COST OF PAVEMENT PATCHING.
- 3. SAW CUT/SCORING OF EXISTING PAVEMENT IS INCLUDED IN THE COST OF PAVEMENT PATCHING.

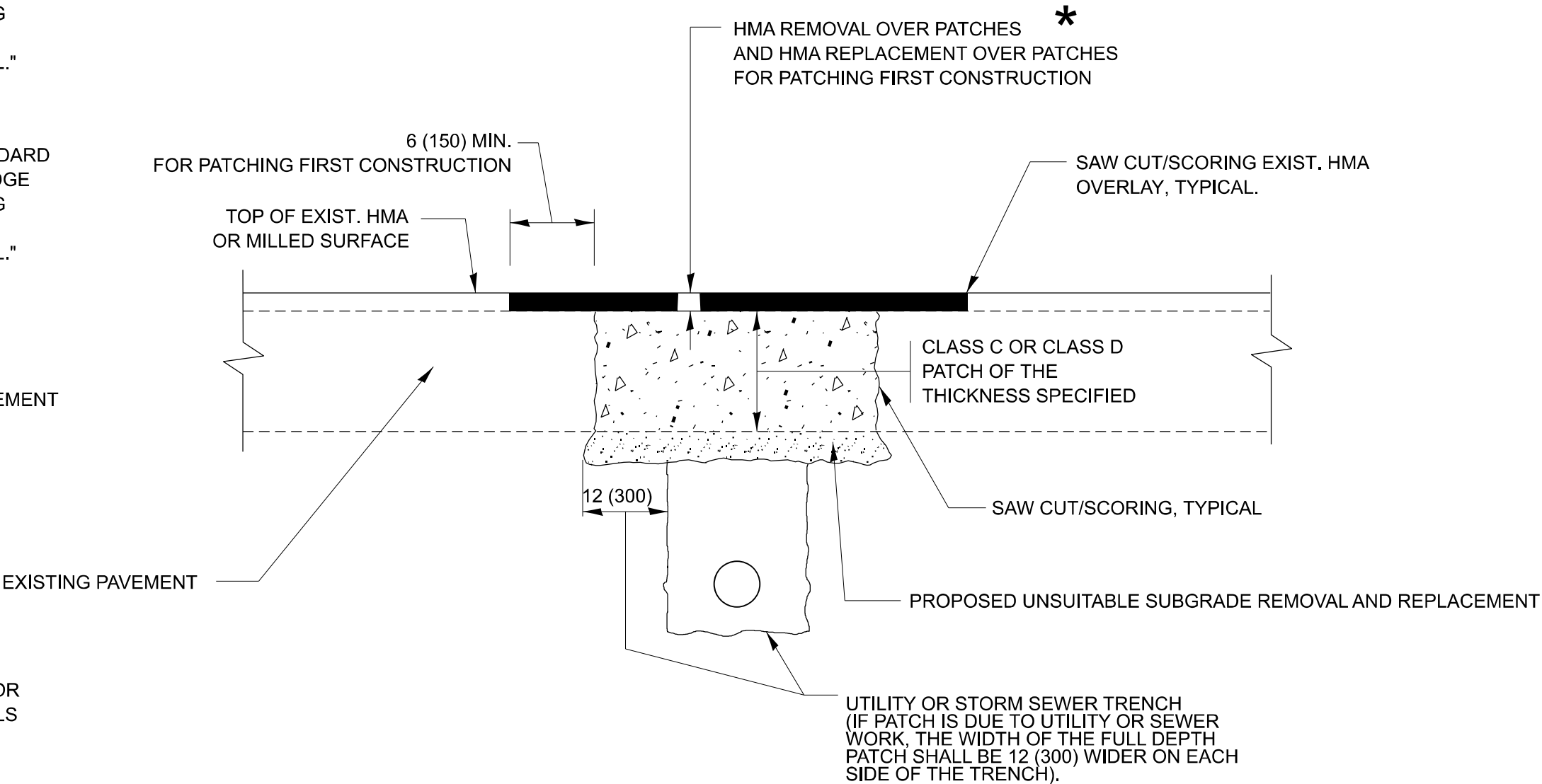

SEQUENCE OF CONSTRUCTION (PATCHING FIRST)

- 1. REMOVE THE EXISTING HMA MATERIAL OVER THE AREA TO BE PATCHED.
- 2. REMOVE AND REPLACE WITH CLASS C OR D PATCH.
- 3. REPLACE HMA MATERIAL OVER THE AREA TO BE PATCHED.

SEQUENCE OF CONSTRUCTION (MILLING FIRST)

- 1. MILL HMA FIRST IF THERE IS AT LEAST 4 1/2 INCHES OR MORE OF HMA MATERIAL ON TOP OF THE EXISTING PAVEMENT OR IF THE PAVEMENT IS FULL DEPTH HMA. A MINIMUM OF 2 INCHES OF HMA MATERIAL SHALL BE IN PLACE AFTER MILLING.
- 2. REMOVE AND REPLACE WITH FULL DEPTH CLASS D PATCHES TO TOP OF MILLED SURFACE.

ALL DIMENSIONS ARE IN INCHES (MILLIMETERS) UNLESS OTHERWISE SHOWN.

MODEL: BD-22 (Sheet)
FILE NAME: c:\pav_work\pav\mcholas.babul\03124-sh-h-DistShts.dgn

	USER NAME = nicholas.babul	DESIGNED - R. SHAH	REVISED - R. BORO 01-01-07	STATE OF ILLINOIS DEPARTMENT OF TRANSPORTATION	PAVEMENT PATCHING FOR HMA SURFACED PAVEMENT				F.A.P. RTE.	SECTION	COUNTY	TOTAL SHEETS	SHEET NO.
		DRAWN -	REVISED - R. BORO 09-04-07						525	FAP 0525 23 SMART	MCHENRY	15	7
	PLOT SCALE = 0.16666633" / in.	CHECKED -	REVISED - K. ENG 10-27-08						BD400-04 (BD-22)		CONTRACT NO. 62V53		
	PLOT DATE = 12/4/2024	DATE - 10-25-94	REVISED - K. SMITH 11-18-22		ILLINOIS FED. AID PROJECT								
	SCALE: NONE		SHEET 1		OF 1	SHEETS	STA.	TO STA.					

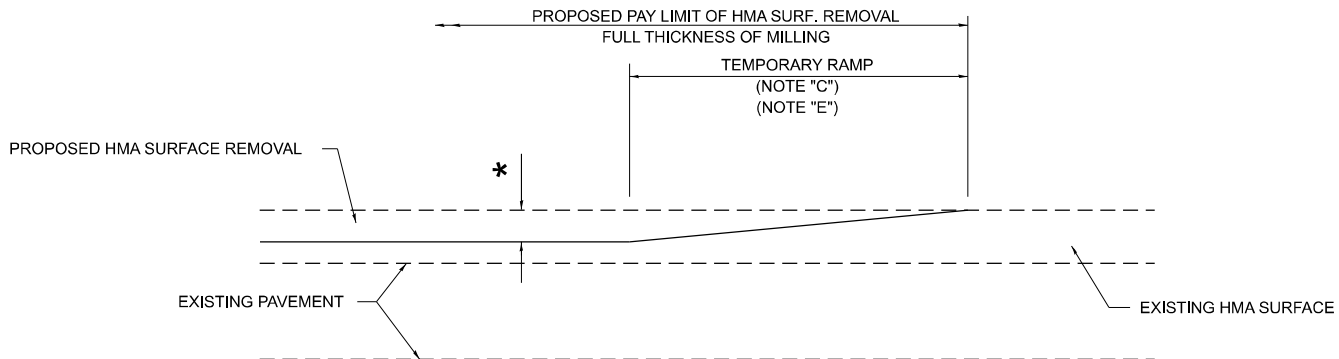

MILLED TEMPORARY RAMP
(FOR BUTT JOINT AND HMA TAPER SEE DETAIL BELOW)

OPTION 1

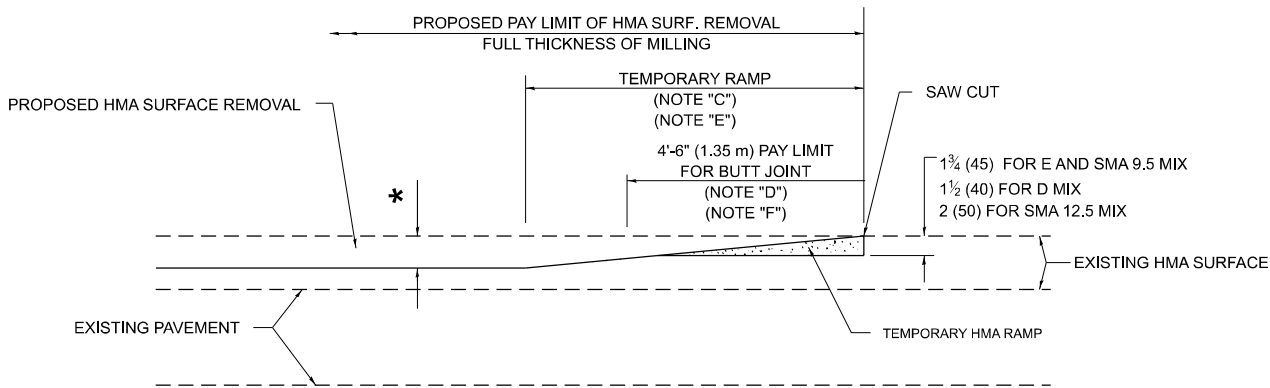

HMA CONSTRUCTED TEMPORARY RAMP
(FOR BUTT JOINT AND HMA TAPER SEE DETAIL BELOW)

OPTION 2

TYPICAL TEMPORARY RAMP

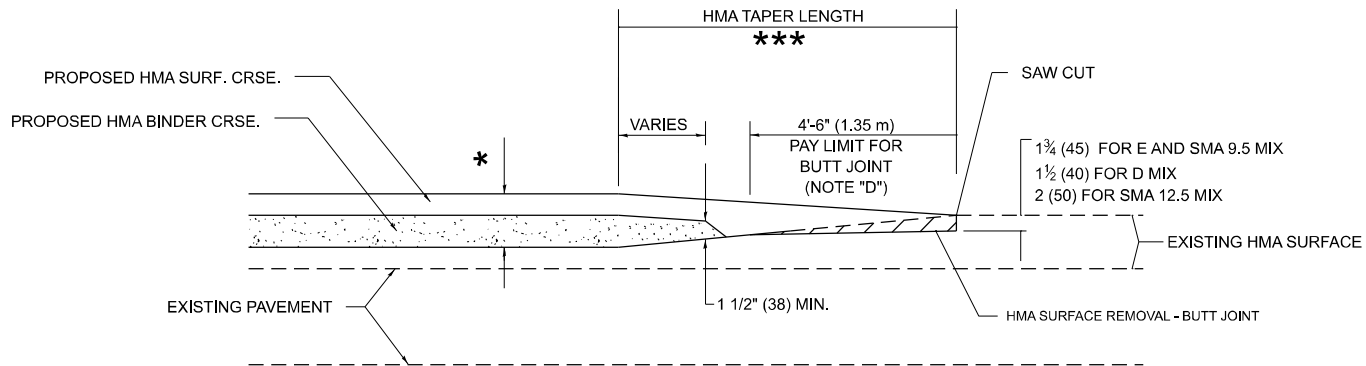

**BUTT JOINT AND
HMA TAPER**

**TYPICAL BUTT JOINT AND HMA TAPER
FOR MILLING AND RESURFACING**

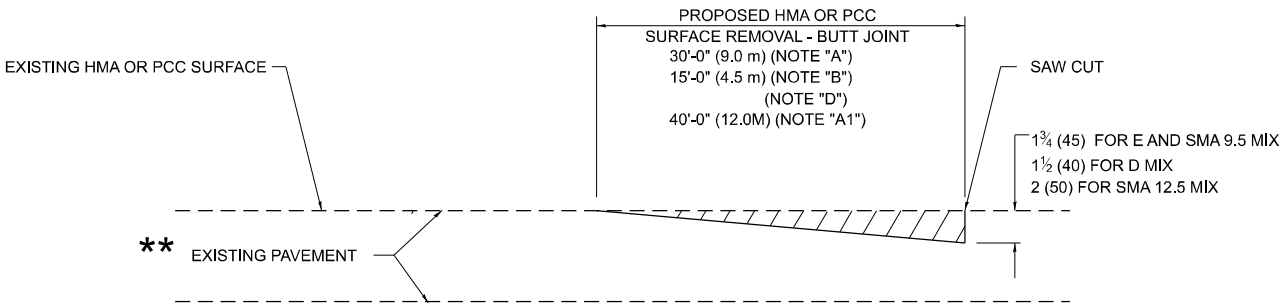

BUTT JOINT DETAIL

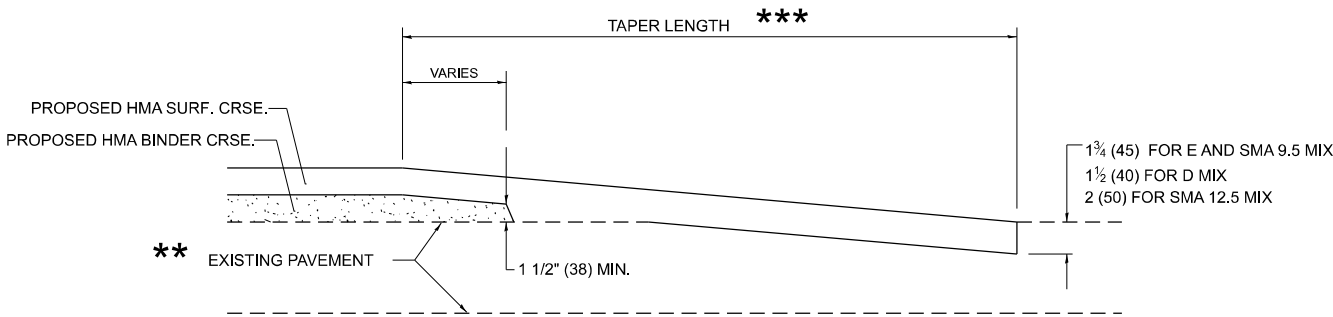

HMA TAPER DETAIL

**TYPICAL BUTT JOINT AND HMA TAPER
FOR RESURFACING ONLY**

****** PC CONCRETE, HMA OR HMA RESURFACED PAVEMENT.

GENERAL NOTES

- A. MAINLINE ARTERIAL ROADWAYS AND MAJOR SIDE ROADS.
- A1. INTERSTATES
- B. MINOR SIDE ROADS.
- C. THE TEMP. RAMP SHALL BE CONSTRUCTED IMMEDIATELY UPON REMOVAL OF THE EXISTING HMA SURFACE.
- D. THE BUTT JOINT SHALL BE CONSTRUCTED IMMEDIATELY PRIOR TO PLACING THE PROPOSED HMA COURSES.
- E. TAPER THE TEMP. RAMP AT A RATE OF 3' - 4" (1.02m) PER 1 INCH (25 mm) OF MILLING THICKNESS.
***** SEE TYPICAL SECTIONS FOR MILLING THICKNESS.
- F. SEE ARTICLE 406.08 AND 406.14 OF THE STANDARD SPECIFICATIONS FOR "HMA AND/OR PCC SURFACE REMOVAL, BUTT JOINT".

20'-0" (6.1 m) PER 1 (25) RESURFACING (NOTE "A")
10'-0" (3.0 m) PER 1 (25) RESURFACING (NOTE "B")

BASIS OF PAYMENT

- 1. THE BUTT JOINT WILL BE PAID FOR AT THE CONTRACT UNIT PRICE PER SQUARE YARD (SQUARE METER) FOR "HOT-MIX ASPHALT SURFACE REMOVAL - BUTT JOINT" OR FOR "PORTLAND CEMENT CONCRETE SURFACE REMOVAL- BUTT JOINT".
- 2. THE TEMPORARY RAMP AND SAW CUT SHALL BE INCLUDED IN THE UNIT COST FOR HMA OR PCC SURFACE REMOVAL-BUTT JOINT.

ALL DIMENSIONS ARE IN INCHES (MILLIMETERS) UNLESS OTHERWISE SHOWN.

MODEL: BD-32 [Sheet]
FILE NAME: c:\pav_work\pav\mcholas.babul\illinois.gov\0927952\103124-sh-h-DistSds.dgn

USER NAME = nicholas.babul	DESIGNED - M. DE YONG	REVISED - A. ABBAS 03-21-97
	DRAWN - M. GOMEZ 04-06-01	REVISED - M. GOMEZ 04-06-01
PLOT SCALE = 0.16666633"/in.	CHECKED -	REVISED - R. BORO 01-01-07
PLOT DATE = 12/4/2024	DATE - 06-13-90	REVISED - K. SMITH 11-18-22

STATE OF ILLINOIS
DEPARTMENT OF TRANSPORTATION

**BUTT JOINT AND
HMA TAPER DETAILS**

SCALE: NONE SHEET 1 OF 1 SHEETS STA. TO STA.

F.A.P. RTE.	SECTION	COUNTY	TOTAL SHEETS	SHEET NO.
525	FAP 0525 23 SMART	MCHENRY	15	8
BD400-05 BD-32		CONTRACT NO. 62V53		
ILLINOIS		FED. AID PROJECT		

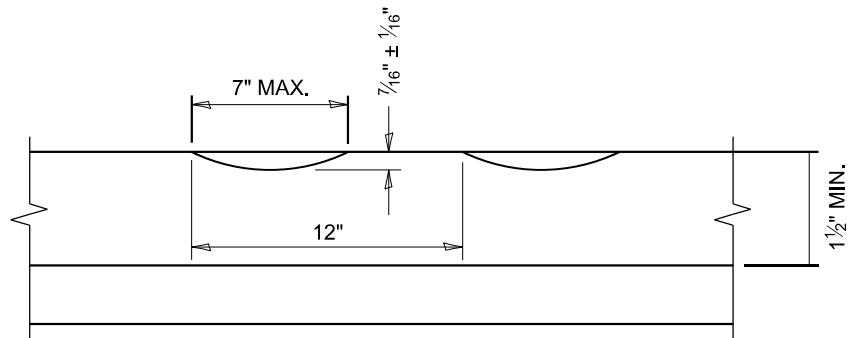

SECTION A-A

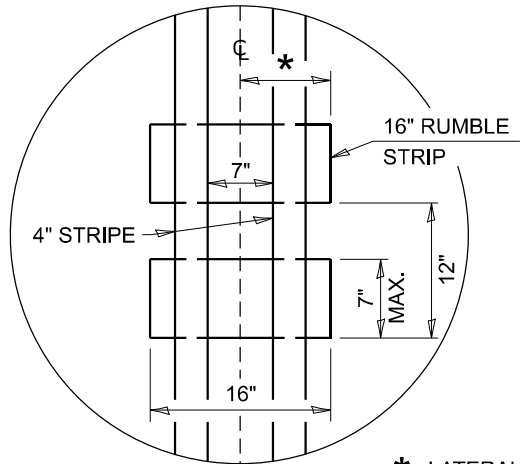

* LATERAL DEVIATION SHALL NOT EXCEED ONE INCH IN 100 FEET.

DETAIL B

GENERAL NOTES

- CENTERLINE RUMBLE STRIPS SHALL BE CONSTRUCTED ACCORDING TO SECTION 642 ALONG THE CENTERLINE OF PAVEMENT.
- SEE STANDARD 780001 FOR OTHER STRIPING LAYOUTS.
- RUMBLE STRIPS SHALL NOT BE PLACED ON BRIDGES.
- ALL RUMBLE STRIPS SHALL BE MILLED.
- CENTERLINE RUMBLE STRIPS SHALL BE CONTINUOUS THROUGH CONNECTIONS OF SIDEROADS WITH NO LEFT TURN LANES.
- DISCONTINUE CENTERLINE RUMBLE STRIPS THROUGH THE LIMITS OF ALL LEFT TURN LANES, INCLUDING ANY LANE TAPER SECTIONS.
- AFTER RUMBLE STRIPS ARE INSTALLED, THE PAVEMENT SURFACE SHALL BE SWEEPED CLEAN PRIOR TO THE PLACEMENT OF THE NEW PAVEMENT MARKINGS.
- WHERE USED, ADJUST SPACING OF RAISED REFLECTIVE PAVEMENT MARKERS TO FALL IN WIDER GAP BETWEEN RUMBLE STRIPS.

BASIS OF PAYMENT

- THIS WORK WILL BE PAID FOR AT THE CONTRACT UNIT PRICE PER FOOT FOR CENTERLINE-RUMBLE STRIP OF THE WIDTH SPECIFIED.
- HOT-SPRAY THERMOPLASTIC PAVEMENT MARKING WILL BE USED OVER THE RUMBLE STRIPS, AND WILL BE PAID FOR SEPARATELY.

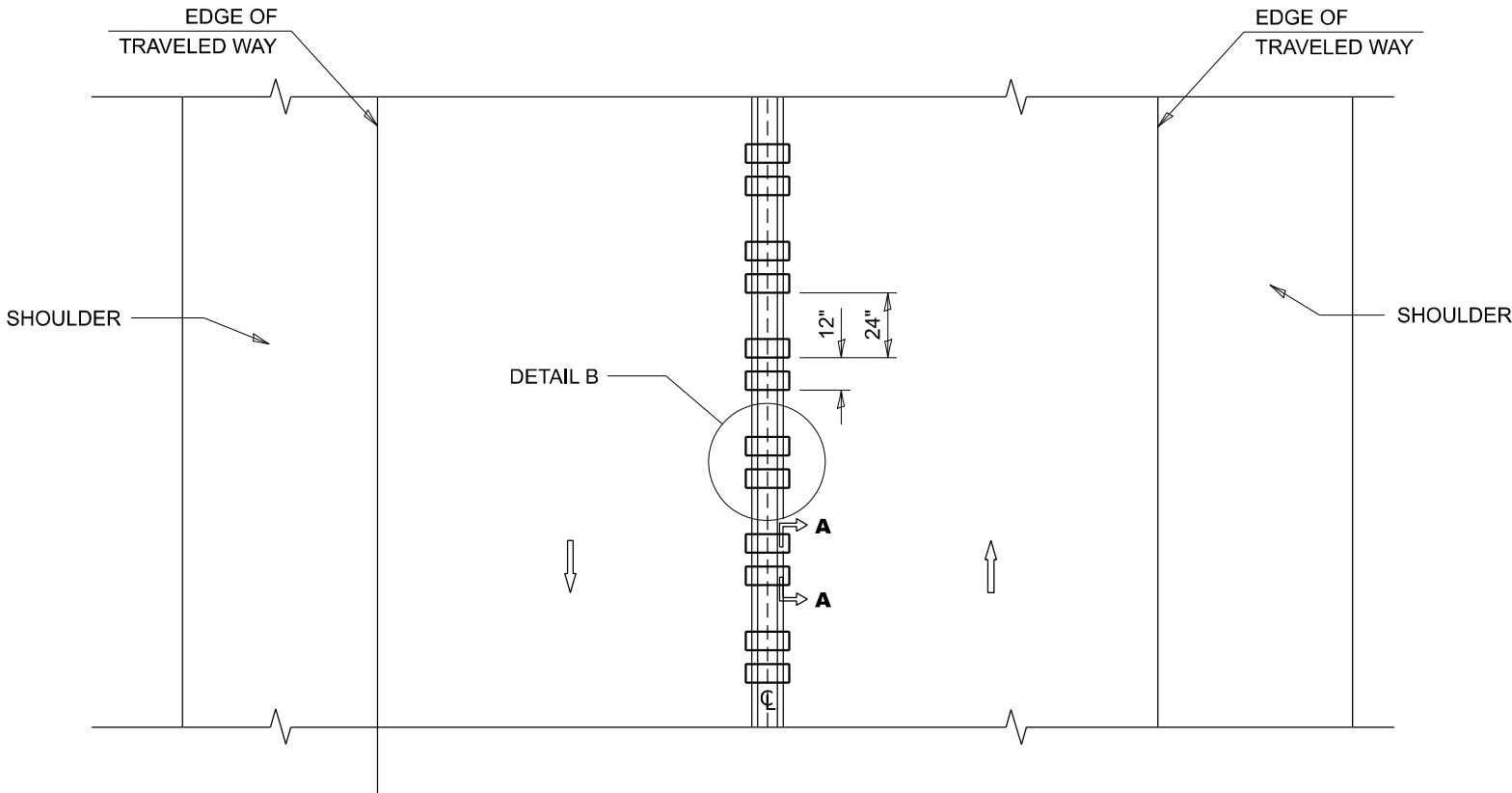

TWO-WAY ROAD

MODEL: BD-55 (Sheet)
FILE NAME: c:\p\work\pwt\nicholas.babul\illinois.gov\0827952\03124-sh-Dis\Sds.dgn

USER NAME = nicholas.babul	DESIGNED - R. BORO	REVISED - K. SMITH 11-18-22
	DRAWN -	REVISED -
	CHECKED -	REVISED -
PLOT DATE = 12/4/2024	DATE - 08-06-2012	REVISED -

STATE OF ILLINOIS
DEPARTMENT OF TRANSPORTATION

RUMBLE STRIPS FOR CENTERLINE, NON-FREEWAY

SCALE: NONE SHEET 1 OF 1 SHEETS STA. TO STA.

F.A.P RTE.	SECTION	COUNTY	TOTAL SHEETS	SHEET NO.
525	FAP 525 23 SMART	MCHENRY	15	9
BD 55		CONTRACT NO. 62V53		
ILLINOIS		FED. AID PROJECT		

MODEL: TC-10 (Sheet)
FILE NAME: c:\p\work\pwtol\nicholas.babul\illinois.gov\0927952\0103124-sh-Dis\Sds.dgn

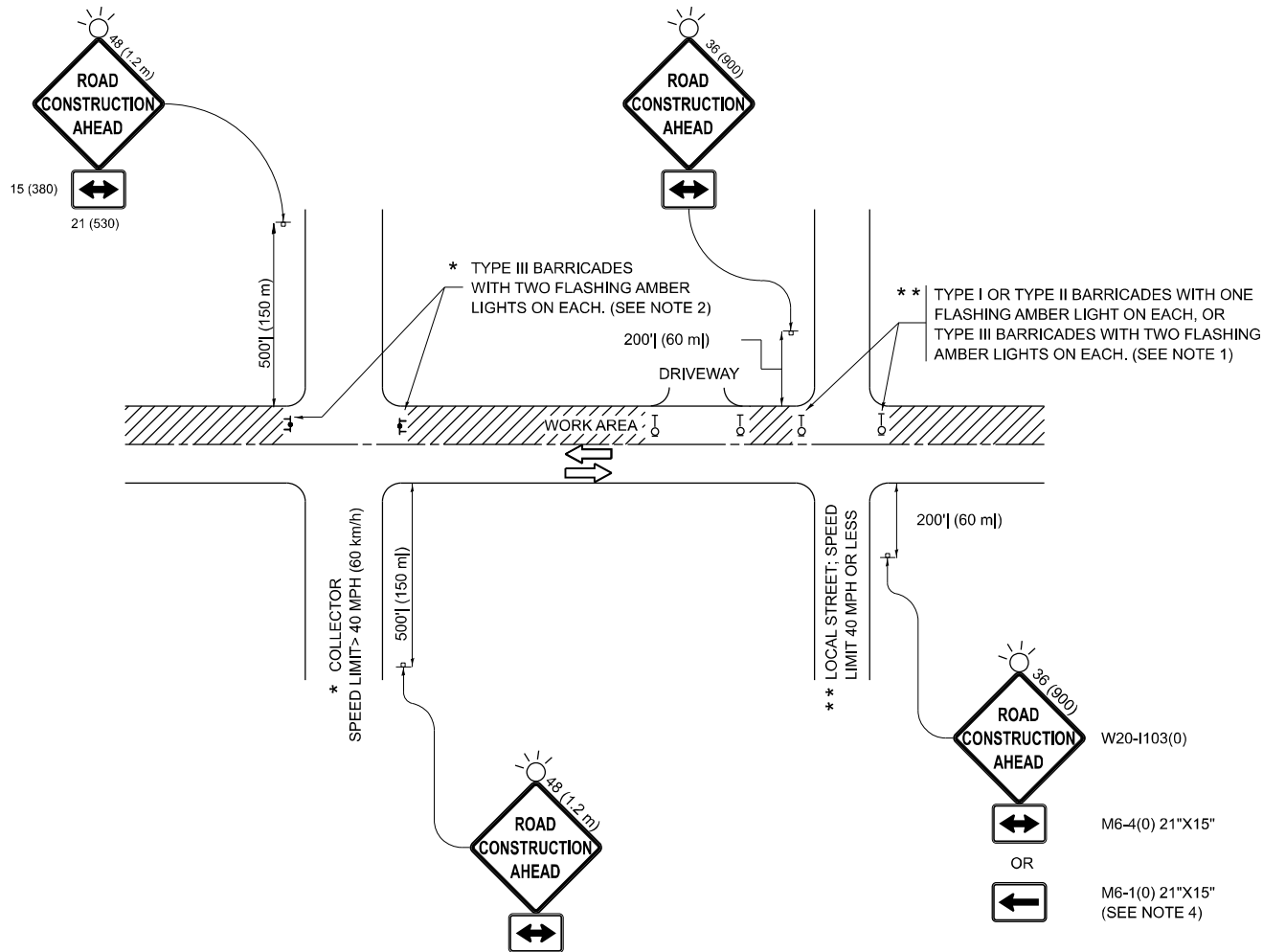

NOTES:

- SIDE ROAD WITH A SPEED LIMIT OF 40 MPH (60 km/h) OR LESS AS SHOWN ON THE DRAWING AND AS DIRECTED BY THE ENGINEER:
 - ONE "ROAD CONSTRUCTION AHEAD" SIGN 36 x 36 (900x900) WITH A FLASHER MOUNTED ON IT APPROXIMATELY 200' (60 m) IN ADVANCE OF THE MAIN ROUTE.
 - THE CLOSED PORTION OF THE MAIN ROUTE SHALL BE PROTECTED BY BLOCKING WITH TYPE I, TYPE II OR TYPE III BARRICADES, 1/3 OF THE CROSS SECTION OF THE CLOSED PORTION.
- SIDE ROAD WITH A SPEED LIMIT GREATER THAN 40 MPH (60 km/h) AS SHOWN ON THE DRAWING AND AS DIRECTED BY THE ENGINEER:
 - ONE "ROAD CONSTRUCTION AHEAD" SIGN 48 x 48 (1.2 m x 1.2 m) WITH A FLASHER MOUNTED ON IT APPROXIMATELY 500' (150 m) IN ADVANCE OF THE MAIN ROUTE.
 - THE CLOSED PORTION OF THE MAIN ROUTE SHALL BE PROTECTED BY BLOCKING WITH TYPE III BARRICADES, 1/2 OF THE CROSS SECTION OF THE CLOSED PORTION.
- CONES MAY BE SUBSTITUTED FOR BARRICADES OR DRUMS AT HALF THE SPACING DURING DAY OPERATIONS. CONES SHALL BE A MINIMUM OF 28 (710) IN HEIGHT.
- WHEN THE SIDE ROAD LIES BETWEEN THE BEGINNING OF THE MAINLINE SIGNING AND THE WORK ZONE, A SINGLE HEADED ARROW (M6-1) SHALL BE USED IN LIEU OF THE DOUBLE HEADED ARROW (M6-4).
- WHEN WORK IS BEING PERFORMED ON A SIDE ROAD OR DRIVEWAY, FOLLOW THE APPLICABLE STANDARD(S). THE DIRECTIONAL ARROW (M6-1 OR M6-4) SHALL BE COVERED OR REMOVED WHEN NO LONGER CONSISTENT WITH THE TRAFFIC CONTROL SET-UP.
- ADVANCE WARNING SIGNS ARE TO BE OMITTED ON DRIVEWAYS UNLESS OTHERWISE SPECIFIED IN THE PLANS OR BY THE ENGINEER.
- THE TRAFFIC CONTROL AND PROTECTION FOR SIDE ROADS, INTERSECTIONS, AND DRIVEWAYS SHALL BE INCLUDED IN THE COST OF SPECIFIED TRAFFIC CONTROL STANDARDS OR ITEMS.

All dimensions are in inches (millimeters)
unless otherwise shown.

	USER NAME = nicholas.babul	DESIGNED - L.H.A.	REVISED - T. RAMMACHER 01-06-00	STATE OF ILLINOIS DEPARTMENT OF TRANSPORTATION	TRAFFIC CONTROL AND PROTECTION FOR SIDE ROADS, INTERSECTIONS, AND DRIVEWAYS	F.A.P. RTE.		SECTION	COUNTY	TOTAL SHEETS	SHEET NO.
		DRAWN -	REVISED - A. SCHUETZE 07-01-13			525	FAP 0525 23 SMART	MCHENRY	15	10	
	PLOT SCALE = 0.16666633" / in.	CHECKED -	REVISED - A. SCHUETZE 09-15-06			TC-10		CONTRACT NO. 62V53			
	PLOT DATE = 12/4/2024	DATE - 06-89	REVISED - D. SENDERAK 05-03-24			SCALE:	SHEET	OF	SHEETS	STA.	TO STA.

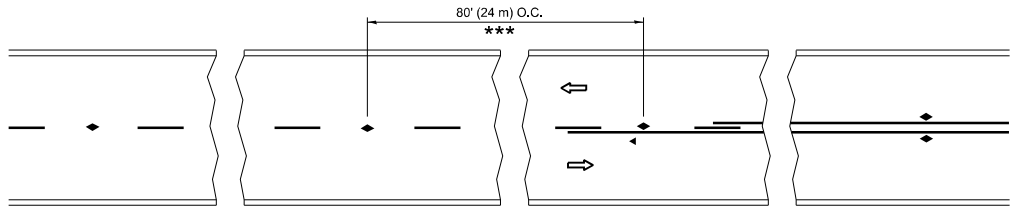

*** REDUCE TO 40' (12 m) O.C. ON CURVES WITH POSTED OR ADVISORY SPEED 45 M.P.H. (70 km/h) OR LESS.

TWO-LANE/TWO-WAY

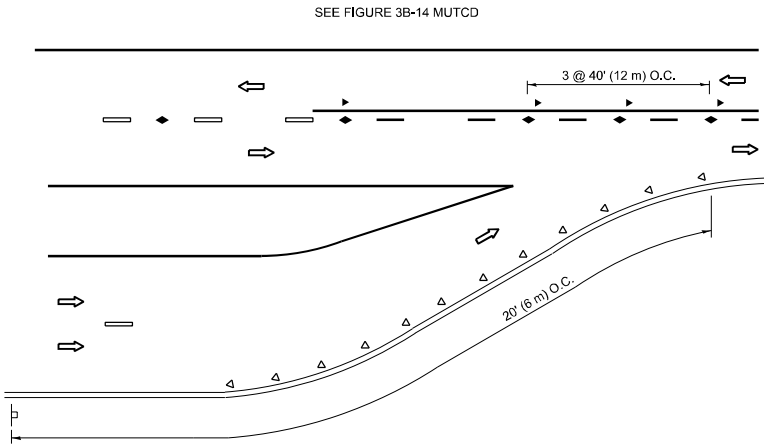

LANE REDUCTION TRANSITION

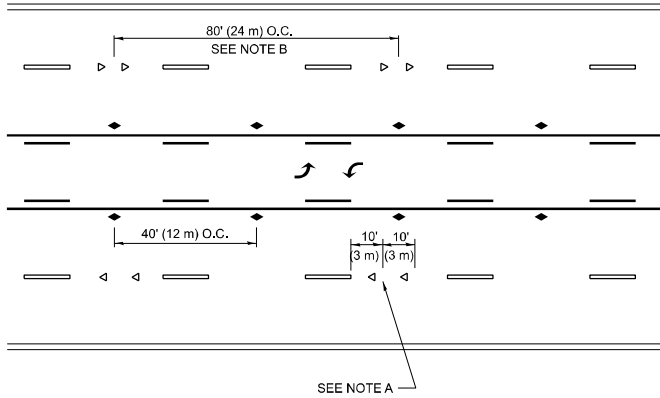

TWO-WAY LEFT TURN

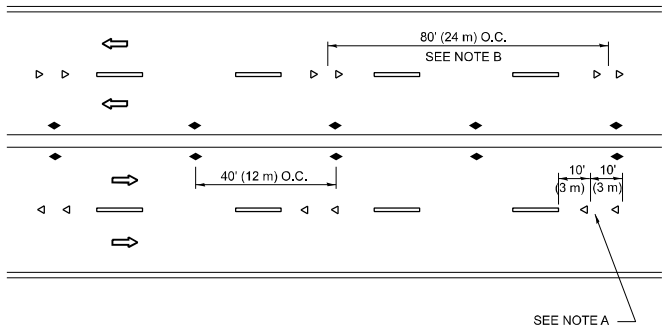

MULTI-LANE/UNDIVIDED

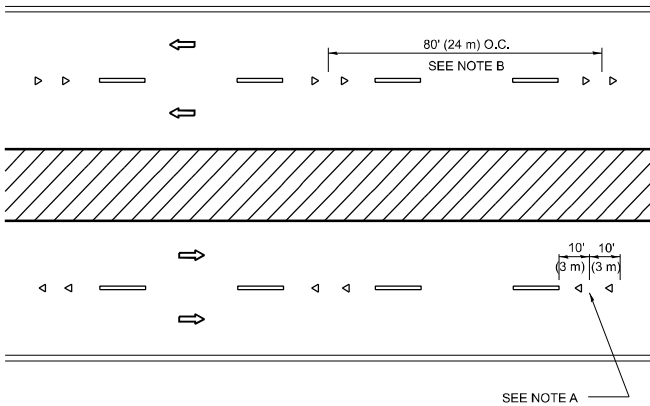

MULTI-LANE/DIVIDED

GENERAL NOTES

- MARKERS USED WITH DASHED LINES SHALL BE CENTERED IN THE GAP BETWEEN SEGMENTS.
- MARKERS USED ADJACENT TO SOLID LINES SHALL BE OFFSET 2 TO 3 (50 TO 75) TOWARD TRAFFIC AS SHOWN.
- MARKERS THROUGH TANGENTS LESS THAN 500' (150 m) IN LENGTH BETWEEN CURVES SHALL BE INSTALLED AT THE LESSER OF THE TWO CURVE SPACINGS.
- MARKERS ARE TO BE USED ADJACENT TO BOTH SOLID WHITE LINES IN DUAL LEFT TURN LANES

SYMBOLS

- YELLOW STRIPE
- WHITE STRIPE
- ONE-WAY AMBER MARKER
- ONE-WAY CRYSTAL MARKER (W/O)
- TWO-WAY AMBER MARKER

LANE MARKER NOTES

- USE DOUBLE LANE LINE MARKERS SPACED AS SHOWN.
- REDUCE TO 40' (12 m) O.C. ON CURVES WHERE ADVISORY SPEEDS ARE 10 M.P.H (20 km/h) LOWER THAN POSTED SPEEDS.

DESIGN NOTES

- DOUBLE LANE LINE MARKERS SHALL BE USED UNLESS SPECIFIED OTHERWISE.
- EXCEPT AS SHOWN ON THE LANE REDUCTION TRANSITION AND FREEWAY EXIT RAMP DETAIL, MARKERS ARE NOT TO BE SPECIFIED ON RIGHT EDGE LINES.
- THE EXACT MARKER LIMITS, SPACING, AND COLOR SHALL BE INCLUDED IN THE PLANS WHEN STANDARD SPECIFICATIONS ARE NOT BEING USED.
- MARKERS SHOULD NOT BE USED ALONGSIDE CURBS EXCEPT FOR EXTREMELY SHORT SECTIONS OF CURBS WHERE NOT MORE THAN TWO MARKERS WOULD BE INVOLVED.

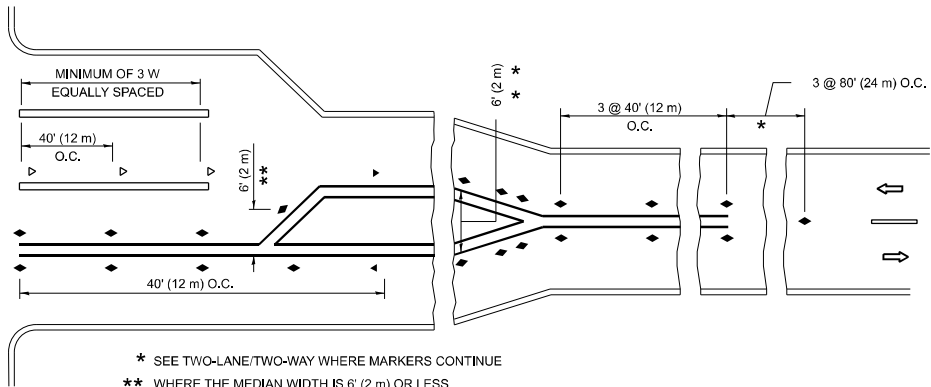
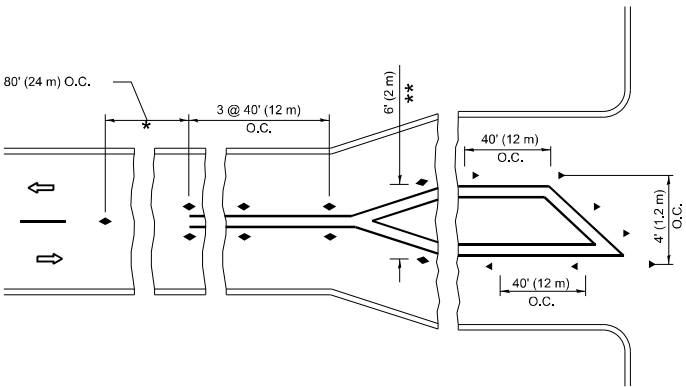

TURN LANES

All dimensions are in inches (millimeters) unless otherwise shown.

STATE OF ILLINOIS
DEPARTMENT OF TRANSPORTATION

TYPICAL APPLICATIONS
RAISED REFLECTIVE PAVEMENT MARKERS (SNOW-PLOW RESISTANT)

SCALE: NONE SHEET 1 OF 1 SHEETS STA. TO STA.

F.A.P. RTE.	SECTION	COUNTY	TOTAL SHEETS	SHEET NO.
525	FAP 0525 23 SMART	MCHENRY	15	11
TC-11		CONTRACT NO. 62V53		
ILLINOIS		FED. AID PROJECT		

MODEL: TC-13 (Sheet)
FILE NAME: c:\pav_work\wvdot\nicholas.babul\illinois.gov\0927952\0103124-shd-DistSds.dgn

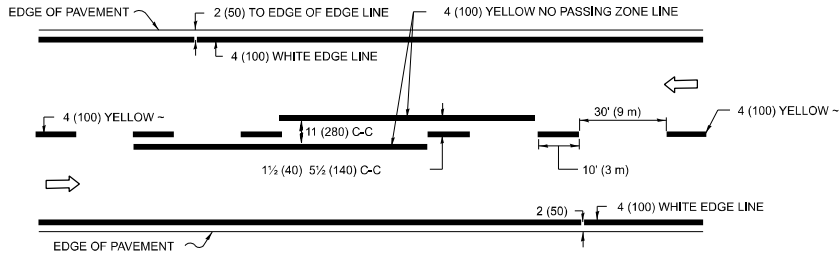

2-LANE ROADWAY

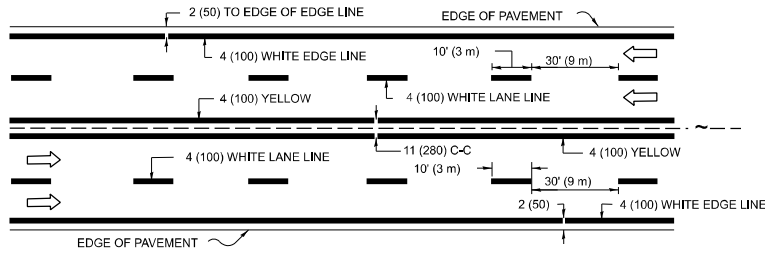

MULTI-LANE UNDIVIDED

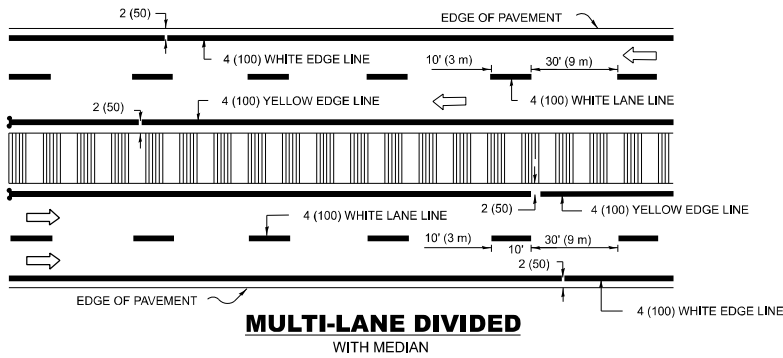

TYPICAL LANE AND EDGE LINE MARKING

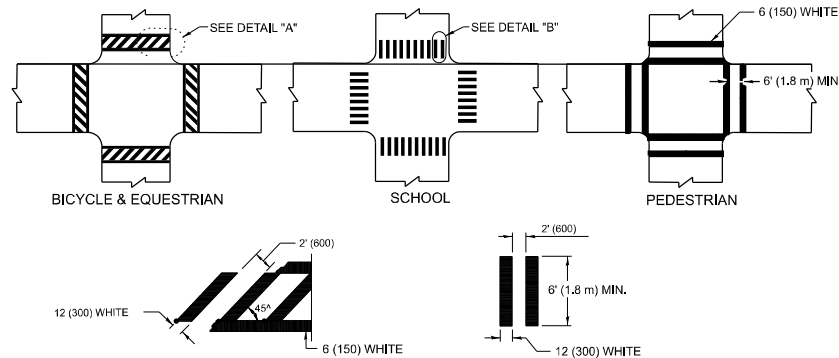

DETAIL "A"

DETAIL "B"

TYPICAL CROSSWALK MARKING

* MARKINGS SHALL BE INSTALLED PARALLEL TO THE CENTERLINE OF THE ROAD WHICH IT CROSSES

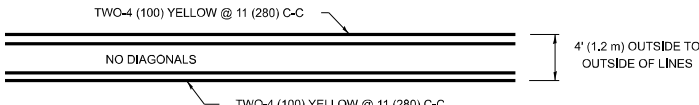

4' (1.2 m) WIDE MEDIANS ONLY

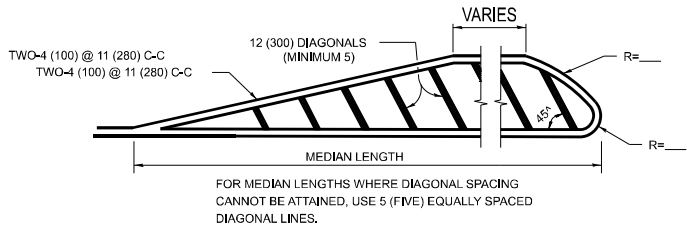

DIAGONAL LINE SPACING: 50' (15 m) C-C (LESS THAN 30MPH (50 km/h))
75' (25 m) C-C 30MPH (50 km/h) TO 45MPH (70 km/h)
150' (45 m) C-C (MORE THAN 45MPH (70 km/h))

MEDIANS OVER 4' (1.2 m) WIDE

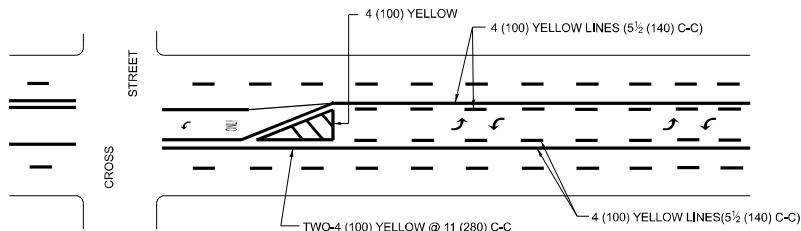

MEDIAN WITH TWO-WAY LEFT TURN LANE

TYPICAL PAINTED MEDIAN MARKING

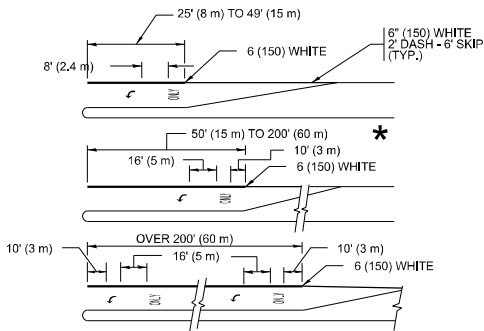

FULL SIZE LETTERS 8' (2.4 m) AND ARROWS SHALL BE USED.
AREA = 15.6 SQ. FT. (1.5 m²) ONLY AREA = 20.8 SQ. FT. (1.9 m²)

* TURN LANES IN EXCESS OF 400' (120 m) IN LENGTH MAY HAVE AN ADDITIONAL SET OF ARROW - "ONLY" INSTALLED MIDWAY BETWEEN THE OTHER TWO SETS OF ARROW - "ONLY".

TYPICAL LEFT (OR RIGHT) TURN LANE

TYPICAL TURN LANE MARKING

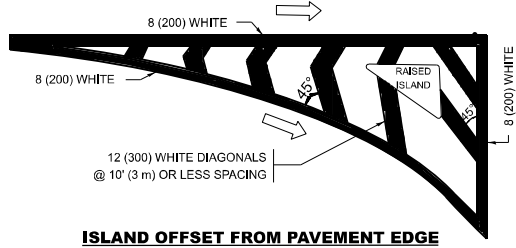

ISLAND OFFSET FROM PAVEMENT EDGE

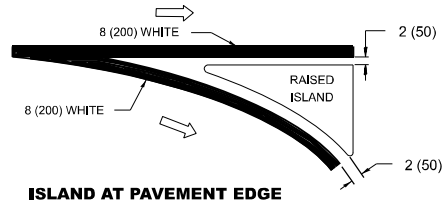

ISLAND AT PAVEMENT EDGE

TYPICAL ISLAND MARKING

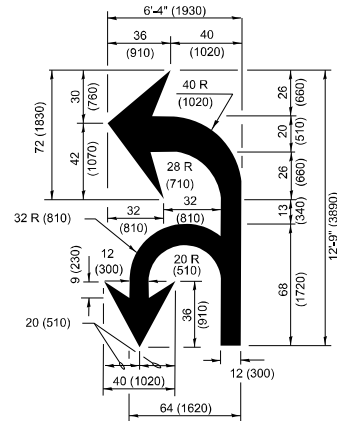

COMBINATION LEFT AND U-TURN

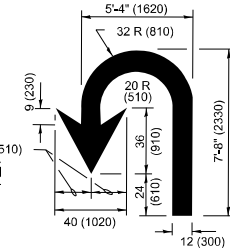

U-TURN

LANE REDUCTION TRANSITION

* LANE REDUCTION ARROWS REQUIRED AT SPEEDS OF 45 MPH OR GREATER OR WHEN SPECIFIED IN PLANS.

TYPE OF MARKING	WIDTH OF LINE	PATTERN	COLOR	SPACING / REMARKS
CENTERLINE ON 2 LANE PAVEMENT	4 (100)	SKIP-DASH	YELLOW	10' (3 m) LINE WITH 30' (9 m) SPACE
CENTERLINE ON MULTI-LANE UNDIVIDED PAVEMENT	2 @ 4 (100)	SOLID	YELLOW	11 (280) C-C
NO PASSING ZONE LINES: FOR ONE DIRECTION FOR BOTH DIRECTIONS	4 (100) 2 @ 4 (100)	SOLID SOLID	YELLOW YELLOW	5 1/2 (140) C-C FROM SKIP-DASH CENTERLINE 11 (280) C-C OMIT SKIP-DASH CENTERLINE BETWEEN
LANE LINES	4 (100) 5 (125) ON FREEWAYS	SKIP-DASH SKIP-DASH	WHITE WHITE	10' (3 m) LINE WITH 30' (9 m) SPACE
DOTTED LINES (EXTENSIONS OF CENTER, LANE OR TURN LANE MARKINGS)	SAME AS LINE BEING EXTENDED	SKIP-DASH	SAME AS LINE BEING EXTENDED	2' (600) LINE WITH 6' (1.8 m) SPACE
EDGE LINES	4 (100)	SOLID	YELLOW-LEFT WHITE-RIGHT	OUTLINE MEDIANS IN YELLOW
TURN LANE MARKINGS	6 (150) LINE: FULL SIZE LETTERS & SYMBOLS (8' (2.4m))	SOLID	WHITE	SEE TYPICAL TURN LANE MARKING DETAIL
TWO WAY LEFT TURN MARKING	2 @ 4 (100) EACH DIRECTION 8' (2.4m) LEFT ARROW	SKIP-DASH AND SOLID IN PAIRS	YELLOW WHITE	10' (3 m) LINE WITH 30' (9 m) SPACE FOR SKIP-DASH; 5 1/2 (140) C-C BETWEEN SOLID LINE AND SKIP-DASH LINE SEE TYPICAL TWO-WAY LEFT TURN MARKING DETAIL
CROSSWALK LINES (PEDESTRIAN) A. DIAGONALS (BIKE & EQUESTRIAN) B. LONGITUDINAL BARS (SCHOOL)	2 @ 6 (150) 12 (300) @ 45° 12 (300) @ 90°	SOLID SOLID SOLID	WHITE WHITE WHITE	NOT LESS THAN 6' (1.8 m) APART 2' (600) APART 2' (600) APART SEE TYPICAL CROSSWALK MARKING DETAILS.
STOP LINES	24 (600)	SOLID	WHITE	PLACE 4' (1.2 m) IN ADVANCE OF AND PARALLEL TO CROSSWALK, IF PRESENT. OTHERWISE, PLACE AT DESIRED STOPPING POINT, PARALLEL TO CROSSROAD CENTERLINE, WHERE POSSIBLE
PAINTED MEDIANS	2 @ 4 (100) WITH 12 (300) DIAGONALS @ 45° NO DIAGONALS USED FOR 4' (1.2 m) WIDE MEDIANS	SOLID	YELLOW: TWO WAY TRAFFIC WHITE: ONE WAY TRAFFIC	11 (280) C-C FOR THE DOUBLE LINE SEE TYPICAL PAINTED MEDIAN MARKING.
GORE MARKING AND CHANNELIZING LINES	8 (200) WITH 12 (300) DIAGONALS @ 45°	SOLID	WHITE	DIAGONALS: 15' (4.5 m) C-C (LESS THAN 30MPH (50 km/h)) 20' (6 m) C-C 30MPH (50 km/h) TO 45MPH (70 km/h) 30' (9 m) C-C (OVER 45MPH (70 km/h))
RAILROAD CROSSING	24 (600) TRANSVERSE LINES: "RR" IS 8' (1.8 m) LETTERS: 16 (400) LINE FOR "X"	SOLID	WHITE	SEE STATE STANDARD 780001 AREA OF: *R*=3.6 SQ. FT. (0.33 m ²) EACH *X*=54.0 SQ. FT. (5.0 m ²)
SHOULDER DIAGONALS (REQUIRED FOR SHOULDERS ≥ 8')	12 (300) @ 45°	SOLID	WHITE - RIGHT YELLOW - LEFT	50' (15 m) C-C (LESS THAN 30MPH (50 km/h)) 75' (25 m) C-C 30 MPH (50 km/h) TO 45MPH (70 km/h) 150' (45 m) C-C (OVER 45MPH (70 km/h))
U TURN ARROW	SEE DETAIL	SOLID	WHITE	16.3 SF
2 ARROW COMBINATION LEFT AND U TURN	SEE DETAIL	SOLID	WHITE	30.4 SF

FOR FURTHER DETAILS ON PAVEMENT MARKING REFER TO STANDARD SPECIFICATIONS FOR ROAD AND BRIDGE CONSTRUCTION AND STATE STANDARD 780001.

All dimensions are in inches (millimeters) unless otherwise shown.

USER NAME = nicholas.babul	DESIGNED - EVERS	REVISED - C. JUCIUS 09-09-09
DRAWN -	REVISD - C. JUCIUS 07-01-13	
PLOT SCALE = 0.16666633" / in.	CHECKED -	REVISED - C. JUCIUS 12-21-15
PLOT DATE = 12/4/2024	DATE - 03-19-90	REVISED - C. JUCIUS 04-12-16

STATE OF ILLINOIS DEPARTMENT OF TRANSPORTATION

DISTRICT ONE TYPICAL PAVEMENT MARKINGS

SCALE: NONE SHEET 1 OF 1 SHEETS STA. TO STA.

F.A.P. RTE.	SECTION	COUNTY	TOTAL SHEETS	SHEET NO.
525	FAP 0525 23 SMART	MCHENRY	15	12
TC-13		CONTRACT NO. 62V53		
ILLINOIS		FED. AID PROJECT		

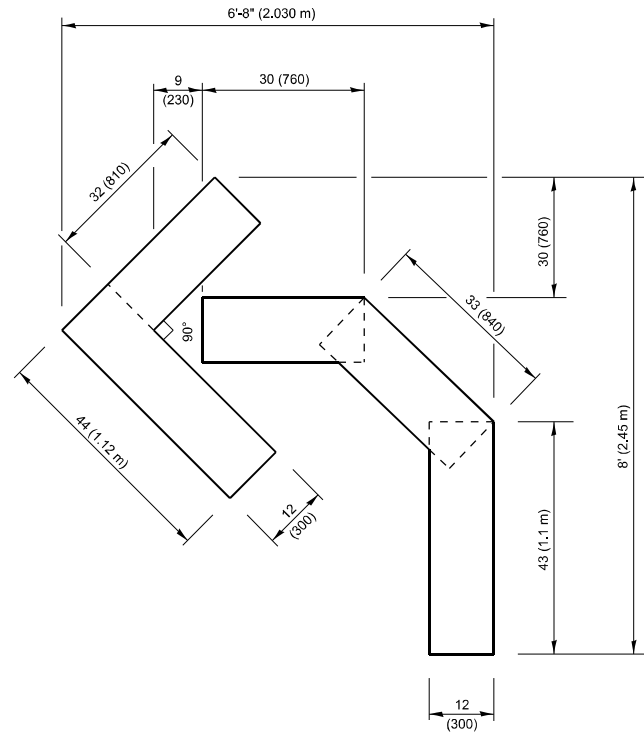

QUANTITY

4 (100) LINE = 45.5 ft. (13.9 m)
15.2 sq. ft. (1.41 sq. m)

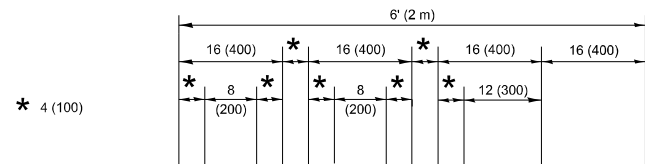

QUANTITY

4 (100) LINE = 64.1 ft. (19.5 m)
21.4 sq. ft. (1.99 sq. m)

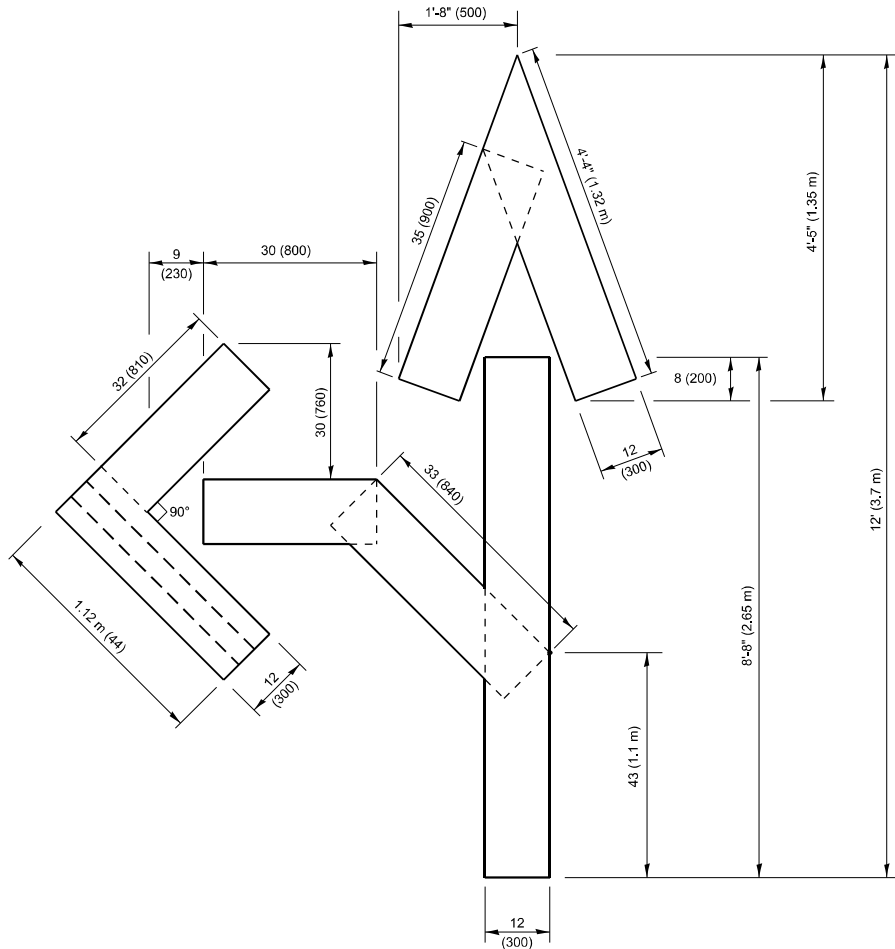

QUANTITY

4 (100) LINE = 82.5 ft. (25.1 m)
27.5 sq. ft. (2.53 sq. m)

NOTE:

ALL QUANTITIES OF PLACEMENT ARE REPRESENTED
IN LINEAR FEET OF 4" LINES TO MATCH THE
4" TEMPORARY TAPE PAY ITEM AND REPRESENTS
THE TOTAL QUANTITY OF 4" TAPE REQUIRED.

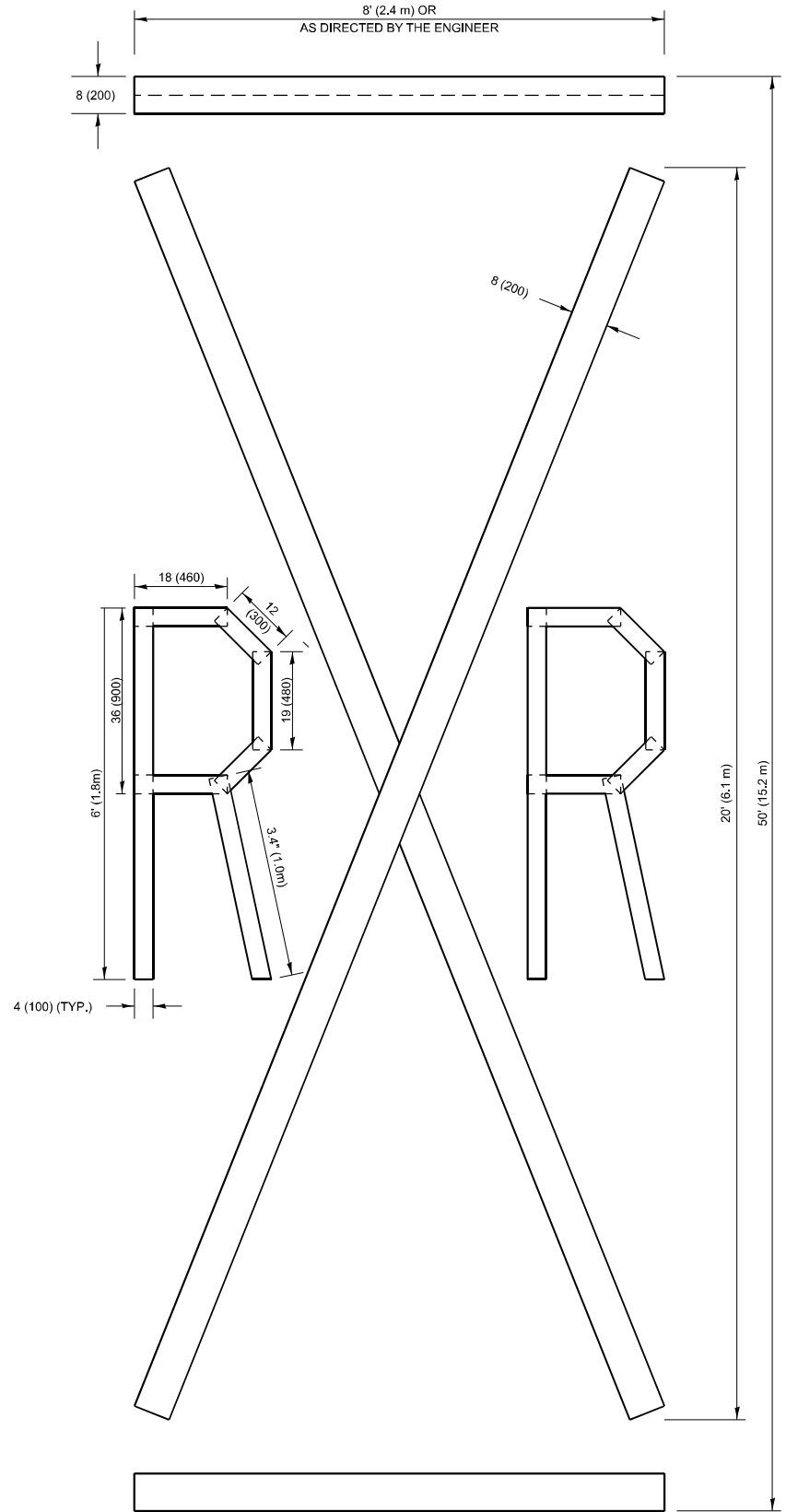

QUANTITY

4 (100) LINE = 225.9 ft. (68.9 m)
75.3 sq. ft. (6.99 sq. m)

All dimensions are in inches (millimeters)
unless otherwise shown.

MODEL: TC-16 (Sheet)
FILE NAME: c:\pav_work\pav\illinois.gov\0827952\0103124-sh-Dis\Sids.dgn

USER NAME	= nicholas.babul	DESIGNED	-	REVISED	- T. RAMMACHER 03-02-98
DRAWN	-	REVIS	- E. GOMEZ 08-28-00		
PLOT SCALE	= 0.16666633" / in.	CHECKED	-	REVISED	- E. GOMEZ 08-28-00
PLOT DATE	= 12/4/2024	DATE	- 09-18-94	REVISED	- A. SCHUETZE 09-15-16

STATE OF ILLINOIS
DEPARTMENT OF TRANSPORTATION

SHORT TERM PAVEMENT MARKING LETTERS AND SYMBOLS

SCALE: NONE SHEET 1 OF 1 SHEETS STA. TO STA.

F.A.P. RTE.	SECTION	COUNTY	TOTAL SHEETS	SHEET NO.
525	FAP 0525 23 SMART	MCHENRY	15	13
TC-16		CONTRACT NO. 62V53		
ILLINOIS		FED. AID PROJECT		

MODEL: TC-22 [Sheet]
FILE NAME: c:\p\work\pwt\micholas.babul@illinois.gov\0927952\0103124-sh-Dis\Sigs.dgn

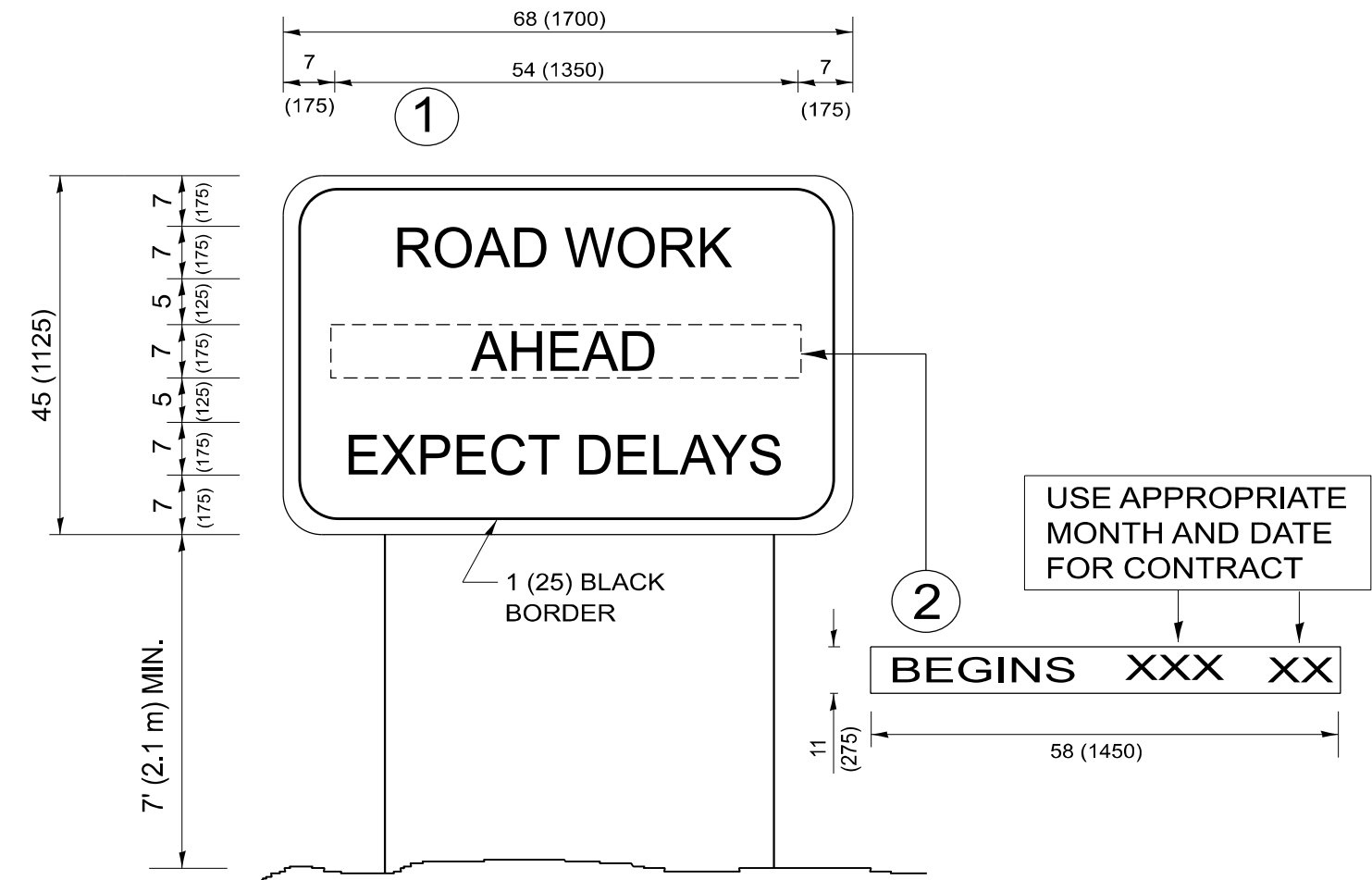

NOTES:

1. USE BLACK LETTERING ON ORANGE BACKGROUND.
2. ERECT SIGNS IN ADVANCE OF THE LOCATION FOR THE "ROAD CONSTRUCTION AHEAD" SIGN AT LOCATIONS AS DIRECTED BY THE ENGINEER.
3. ERECT SIGN ① WITH INSTALLED PANEL ② ONE WEEK PRIOR TO THE START OF CONSTRUCTION.
4. REMOVE PANEL ② SOON AFTER THE START OF CONSTRUCTION.
5. SEE SPECIAL PROVISION FOR "TEMPORARY INFORMATION SIGNING" FOR ADDITIONAL INFORMATION.
6. ONE SIGN ASSEMBLY EQUALS 25.70 SQ. FT. (2.3 SQ. M.)
7. SHALL BE PAID FOR AS TEMPORARY INFORMATION SIGNING.

ALL DIMENSIONS ARE IN INCHES (MILLIMETERS)
UNLESS OTHERWISE SHOWN.

	USER NAME = nicholas.babul	DESIGNED -	REVISED - R. MIRS 09-15-97	STATE OF ILLINOIS DEPARTMENT OF TRANSPORTATION	ARTERIAL ROAD INFORMATION SIGN					F.A.P. RTE.	SECTION	COUNTY	TOTAL SHEETS	SHEET NO.	
		DRAWN -	REVISED - R. MIRS 12-11-97							525	FAP 0525 23 SMART	MCHENRY	15	14	
	PLOT SCALE = 0.16666633" / in.	CHECKED -	REVISED - T. RAMMACHER 02-02-99							TC-22					CONTRACT NO. 62V53
	PLOT DATE = 12/4/2024	DATE -	REVISED - C. JUCIUS 01-31-07		SCALE: NONE					SHEET 1	OF 1 SHEETS	STA.	TO STA.		
	ILLINOIS FED. AID PROJECT														

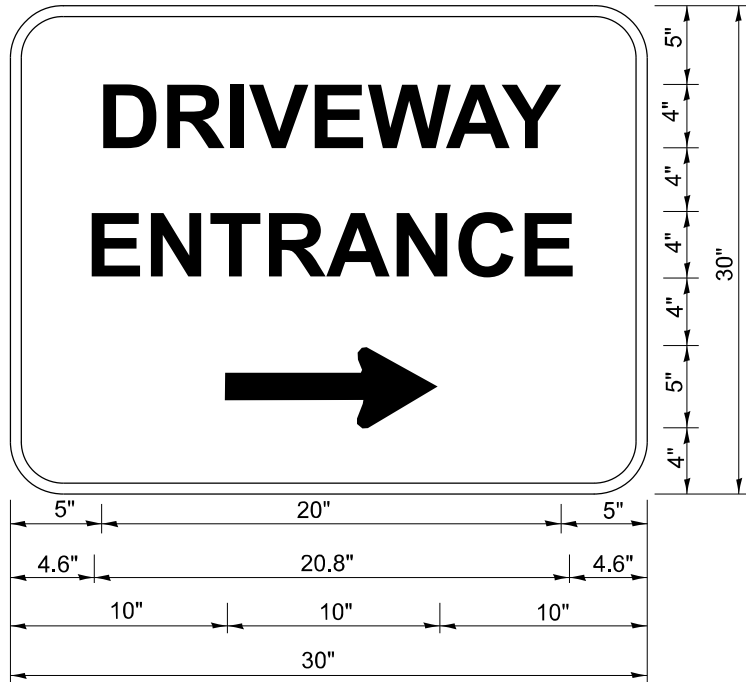

3.0" RADIUS, 0.5" BORDER, WHITE ON GREEN; REFLECTORIZED
"DRIVEWAY" D; "ENTRANCE" D; STANDARD ARROW CUSTOM 12.0" x 5.0"

- NOTES:**
1. HALF OF THE SIGNS WILL REQUIRE A LEFT HAND FACING ARROW.
 2. TWO SIGNS SHALL BE USED AT EACH COMMERCIAL ENTRANCE
PLACED BACK-TO-BACK: ONE WITH A RIGHT HAND ARROW (SHOWN)
SHALL BE PLACED ON THE NEAR RIGHT SIDE THE DRIVEWAY
AND ONE WITH A LEFT HAND ARROW SHALL BE PLACED ON THE
FAR LEFT SIDE OF THE DRIVEWAY.
 3. SIGNS TO BE PAID FOR AS ITEM "TEMPORARY INFORMATION SIGNING".

MODEL: TC-26 (Sheet)
FILE NAME: c:\p\work\p\work\nicholas.babul\illinois.gov\0827952D103124-sh-Dist\Signs.dgn

	USER NAME = nicholas.babul	DESIGNED -	REVISED - C. JUCIUS 02-15-07	STATE OF ILLINOIS DEPARTMENT OF TRANSPORTATION	DRIVEWAY ENTRANCE SIGNING			F.A.P. RTE.	SECTION	COUNTY	TOTAL SHEETS	SHEET NO.
		DRAWN -	REVISED -					525	FAP 0525 23 SMART	MCHENRY	15	15
	PLOT SCALE = 0.16666633" / in.	CHECKED -	REVISED -		TC-26			CONTRACT NO. 62V53				
	PLOT DATE = 12/4/2024	DATE -	REVISED -		SCALE: NONE	SHEET 1	OF 1	SHEETS	STA.	TO STA.	ILLINOIS FED. AID PROJECT	