

MATCHLINE STA. 13+00

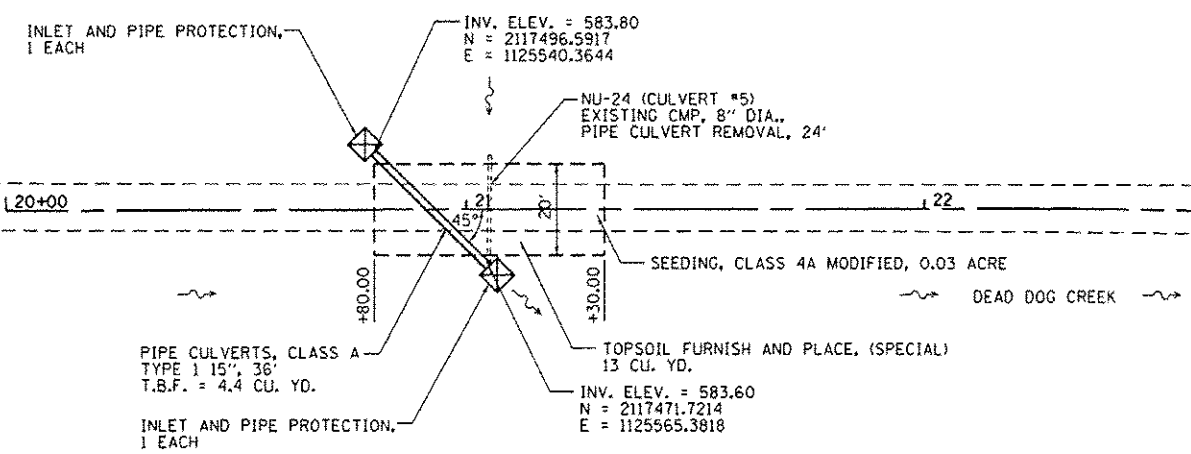
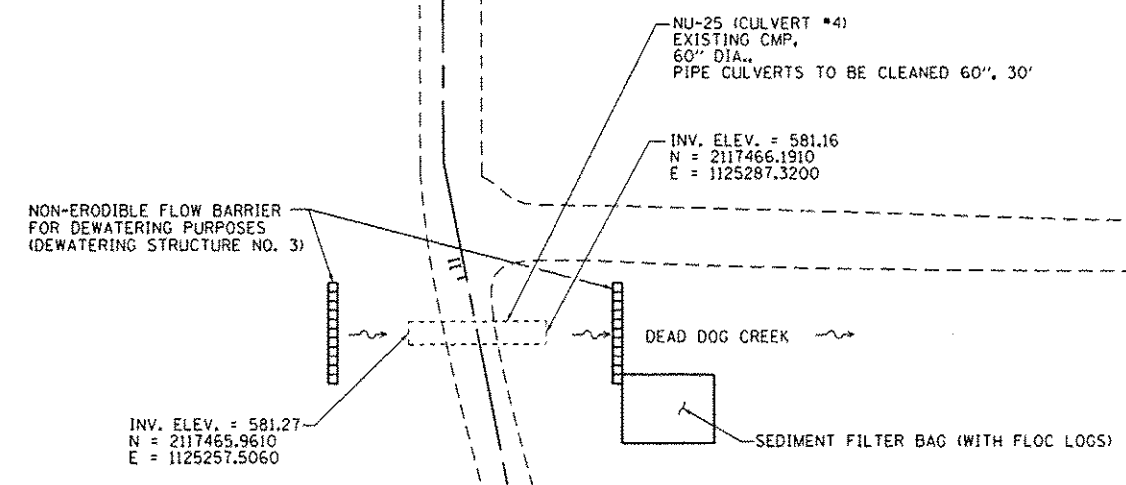
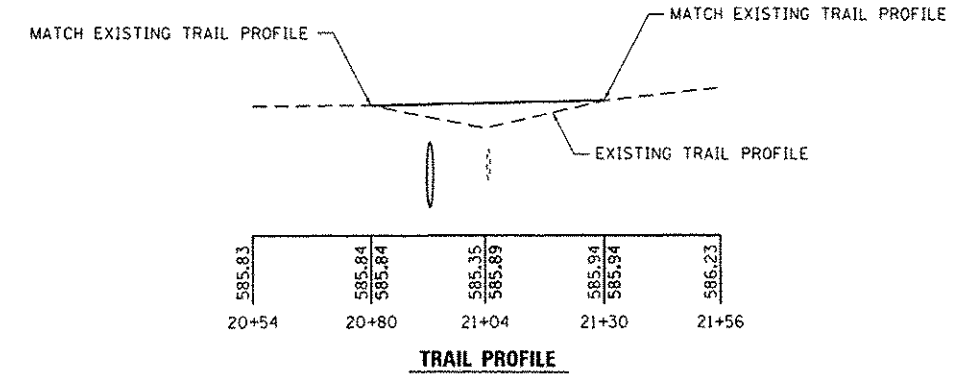
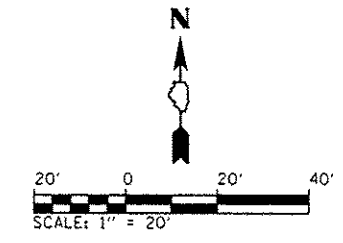

MATCHLINE STA. 23+00

**NOTES:**

1. THE CONTRACTOR SHALL BE REQUIRED TO IMPLEMENT SEDIMENT FILTER BAGS (WITH FLOC LOGS) IN CONJUNCTION WITH ANY DEWATERING AND/OR FLOW DIVERSION OPERATIONS AS SHOWN ON THE PLANS AND SPECIFIED IN THE PROJECT SPECIAL PROVISIONS.
2. THE CONTRACTOR SHALL ENSURE THAT SEDIMENT LADEN WATER IS NOT DISCHARGED FROM THE SITE DIRECTLY TO DEAD DOG CREEK.
3. THE CONTRACTOR SHALL PROTECT THE DISCHARGE SIDE OF THE DEWATERING/DIVERSION TO PREVENT EROSION OR SCOURING OF DEAD DOG CREEK.

**LEGEND**

- ~ DIRECTION OF FLOW
- 585.60 PROPOSED ELEVATION
- 585.35 EXISTING ELEVATION

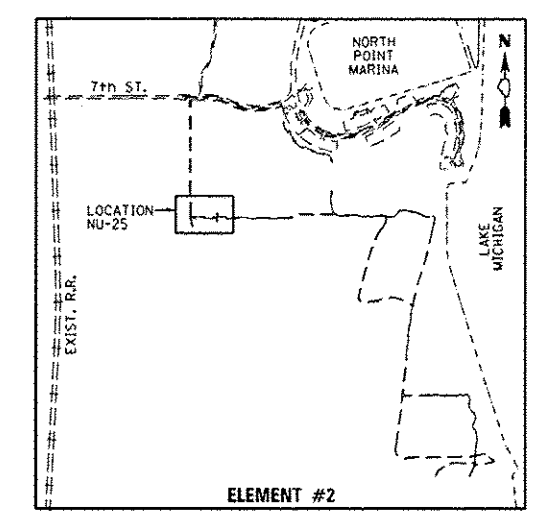

FILE NAME *	USER NAME * Matt Overbey	DESIGNED - CPD	REVISED -
L:\1001\1106618\0.7\Draw\CADD\Sheets\CE-003.PLN, Culvert.dgn		DRAWN - MJO	REVISED -
Default	PLOT SCALE * 40,0000 1/ in.	CHECKED - SPH	REVISED -
	PLOT DATE * 2/1/2013	DATE - 2/1/2013	REVISED -

**STATE OF ILLINOIS**  
**DEPARTMENT OF TRANSPORTATION**

<b>CULVERT LOCATION PLAN -- ELEMENT 2</b>			
<b>IDNR ILLINOIS BEACH STATE PARK</b>			
SCALE:	SHEET	OF	SHEETS
	STA.	TO	STA.

F.A.P. RTE.	SECTION	COUNTY	TOTAL SHEETS	SHEET NO.
N/A	PARK ROADS	LAKE	60	16
IDNR NO. 2-12-010		CONTRACT NO. 46250		
ILLINOIS FED. AID PROJECT				