

PROPOSED CURVE DATA
 PI STA. = 10+28.99
 $\Delta = 29^\circ 22' 22''$ (LT)
 $D = 114^\circ 35' 30''$
 $R = 50.00'$
 $T = 13.10'$
 $L = 25.63'$
 $E = 1.69'$
 P.C. STA = 10+15.89
 P.T. STA = 10+41.52

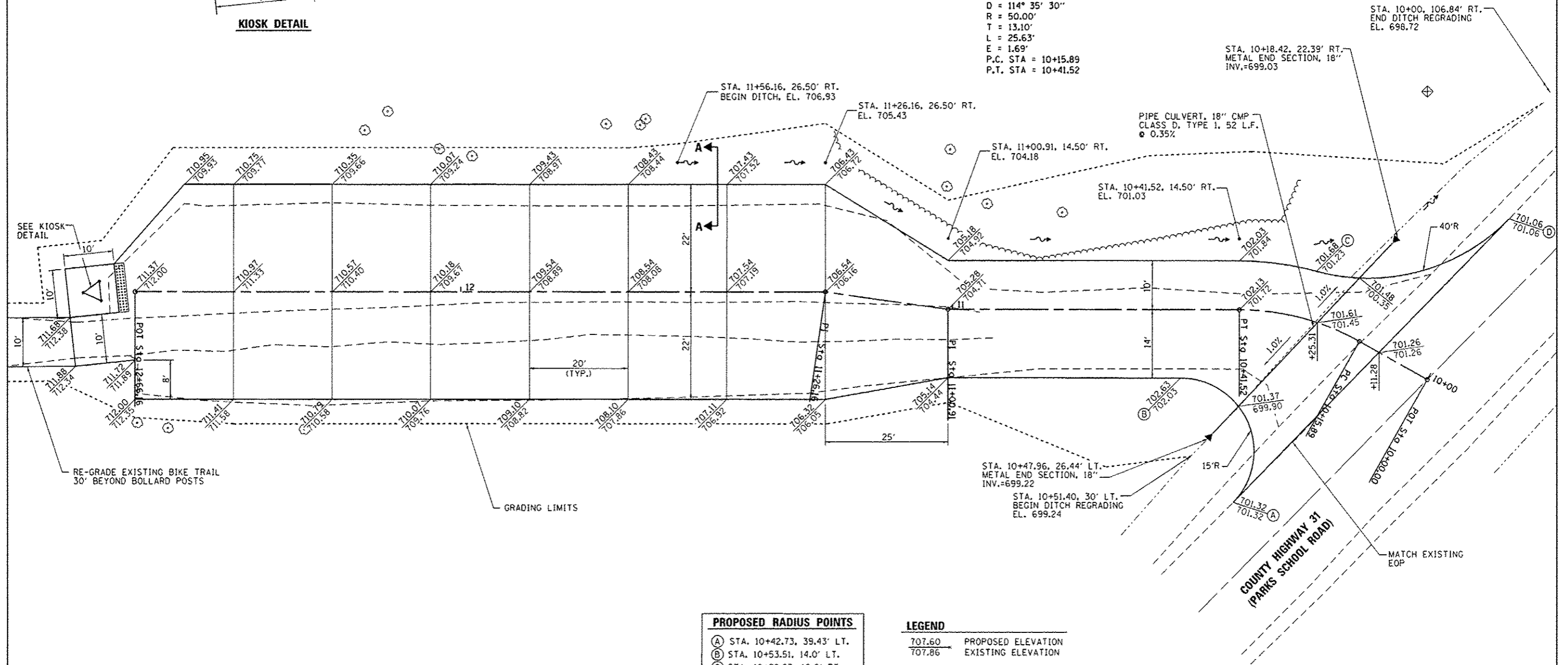

PROPOSED RADIUS POINTS	
(A)	STA. 10+42.73, 39.43' LT.
(B)	STA. 10+53.51, 14.0' LT.
(C)	STA. 10+28.23, 10.0' RT.
(D)	STA. 10+01.63, 36.83' RT.

LEGEND	
707.60	PROPOSED ELEVATION
707.86	EXISTING ELEVATION

FILE NAME : L:\1001\1186618\10_8\Draw\CADD_Sheets\Grading\Staking_ParkSchoolRd.dgn	USER NAME : Kristin Timmons	DESIGNED - KLT	REVISED -
Default	PLOT SCALE = 20.0000' / 1"	CHECKED - SPH	REVISED -
	PLOT DATE = 2/5/2013	DATE - 2/1/2013	REVISED -

STATE OF ILLINOIS
DEPARTMENT OF TRANSPORTATION

GRADING AND STAKING PLAN - PARKS SCHOOL ROAD
ROCK ISLAND TRAIL STATE PARK

SCALE: 1" = 10' SHEET OF SHEETS STA. TO STA.

F.A. R.T.E.	SECTION	COUNTY	TOTAL SHEETS	SHEET NO.
	PARK ROADS	PEORIA/STARBUCK	37	20
			CONTRACT NO. 46256	
ILLINOIS FED. AID PROJECT				