

*NOTE: THE PAY ITEMS AND ESTIMATED QUANTITIES FOR P.C.C. SIDEWALK REMOVAL AND REPLACEMENT AND DETECTABLE WARNINGS ARE PROVIDED. THE EXACT LOCATIONS ARE DETERMINED BY R.E. IN THE FIELD

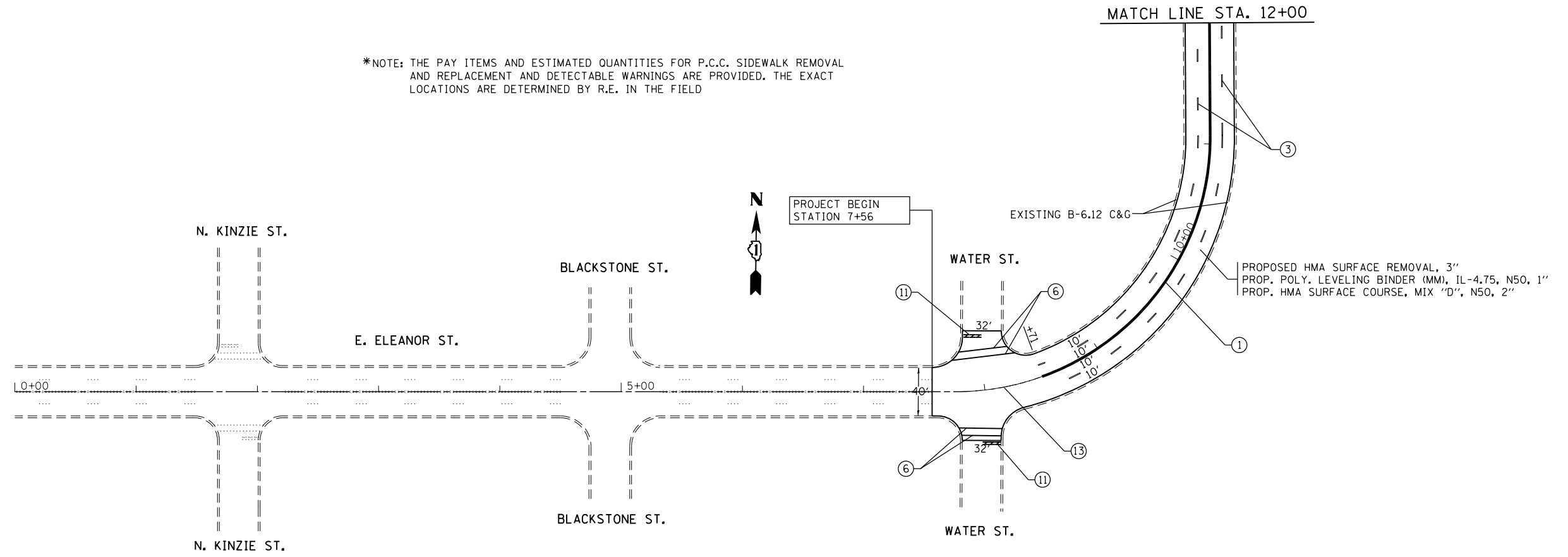

NOTE:
-FOR RAISED REFLECTIVE PAVEMENT MARKERS, REFER TO TYPICAL APPLICATIONS RAISED REFLECTIVE PAVEMENT MARKERS (SNOW-PLOW RESISTANT) AND DISTRICT TYPICAL PAVEMENT MARKERS.

NOTES FOR SIDE STREETS:
-RESURFACING LIMITS ARE TO RADIUS RETURNS WITH 4.5' BUTT JOINTS, UNLESS OTHERWISE NOTED.
-PROPOSED HMA SURFACE REMOVAL, 3"
-PROP. POLY LEVELING BINDER (MM), IL-4.75, N50, 1"
-PROP. HMA SURFACE COURSE, MIX "D", N50, 2"

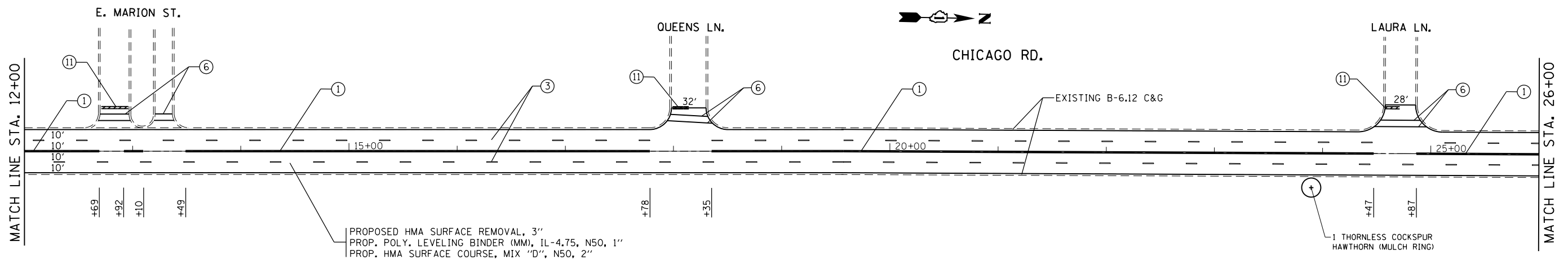

NOTE:
-FOR RAISED REFLECTIVE PAVEMENT MARKERS, REFER TO TYPICAL APPLICATIONS RAISED REFLECTIVE PAVEMENT MARKERS (SNOW-PLOW RESISTANT) AND DISTRICT TYPICAL PAVEMENT MARKERS.

NOTES FOR SIDE STREETS:
-RESURFACING LIMITS ARE TO RADIUS RETURNS WITH 4.5' BUTT JOINTS, UNLESS OTHERWISE NOTED.
-PROPOSED HMA SURFACE REMOVAL, 3"
-PROP. POLY LEVELING BINDER (MM), IL-4.75, N50, 1"
-PROP. HMA SURFACE COURSE, MIX "D", N50, 2"

THERMOPLASTIC PAVEMENT MARKING LEGEND

- ① 4" DOUBLE SOLID YELLOW LINE, 11" C-C
- ② 4" SKIP-DASH YELLOW CENTERLINE, 10' LINE WITH 30' SPACE
- ③ 4" SKIP-DASH WHITE LINE, 10' LINE WITH 30' SPACE
- ④ 6" SOLID WHITE LINE (TURN LANE LINE)
- ⑤ 6" SOLID WHITE LINE (CROSSWALK)
- ⑥ 4" SOLID WHITE LINE (EDGE LINE)
- ⑦ 12" SOLID YELLOW DIAGONALS, AT 45 DEGREES
- ⑧ 12" SOLID WHITE DIAGONALS, AT 45 DEGREES
- ⑨ 12" SOLID WHITE LONGITUDINAL BARS (SCHOOL CROSSWALK)
- ⑩ 24" SOLID WHITE LINE
- ⑪ SOLID WHITE LETTERS AND SYMBOLS
- ⑫ 4" DOUBLE YELLOW LINE, 2' LINE WITH 6' SPACE

FILE NAME =	USER NAME = gaglianob	DESIGNED -	REVISED -
et:\pw\work\p\id\dot\gaglianob\40285780\036906-sht-plan.dgn		DRAWN -	REVISED -
PLOT SCALE = 100.0000' / in.		CHECKED -	REVISED -
PLOT DATE = 1/8/2013		DATE -	REVISED -

**STATE OF ILLINOIS
DEPARTMENT OF TRANSPORTATION**

**PROPOSED ROADWAY AND PAVEMENT MARKING PLAN
CHICAGO RD. (LINCOLN AVE. TO WATER ST.)**

SCALE: SHEET NO. 1 OF 9 SHEETS STA. 0+00 TO STA. 26+00

F.A.U. R.E.	SECTION	COUNTY	TOTAL SHEETS	SHEET NO.
2921	(S.B&R) R5-8	COOK	34	9
CONTRACT NO. 60B56			ILLINOIS FED. AID PROJECT	