

WETLAND SITE 19, A.C.O.E. JURISDICTIONAL
 IMPACTED AREA = 0.172 AC.
 TOTAL AREA = 0.213+ AC.
 FQI = 4.0

- NOTES:
- SEE SHEET ER-01 FOR LEGEND AND NOTES.
 - SEE SHEETS DN-02 AND DN-03 FOR SUGGESTED SEQUENCE OF DRAINAGE INSTALLATION.

P-1A 5'- 12" TEMPORARY STORM SEWER CLASS A,
 TYPE 2, SLOPE TO DRAIN (TBF= 1 CU YD)

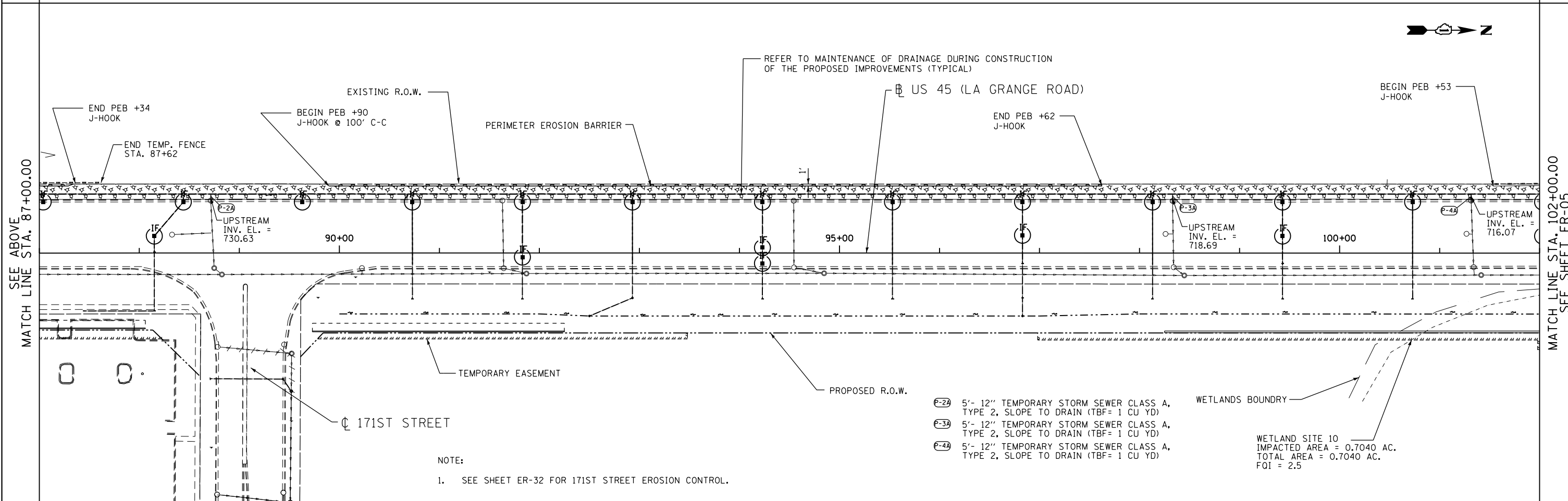

- NOTE:
- SEE SHEET ER-32 FOR 171ST STREET EROSION CONTROL.

- P-2A 5'- 12" TEMPORARY STORM SEWER CLASS A,
 TYPE 2, SLOPE TO DRAIN (TBF= 1 CU YD)
 P-3A 5'- 12" TEMPORARY STORM SEWER CLASS A,
 TYPE 2, SLOPE TO DRAIN (TBF= 1 CU YD)
 P-4A 5'- 12" TEMPORARY STORM SEWER CLASS A,
 TYPE 2, SLOPE TO DRAIN (TBF= 1 CU YD)

WETLAND SITE 10
 IMPACTED AREA = 0.7040 AC.
 TOTAL AREA = 0.7040 AC.
 FQI = 2.5

APEX
 CONSULTING ENGINEERS, LLC
 111 E. Wacker Drive, Suite 520
 Chicago, IL 60601

| | | | |
|---------------------------------------|---------------------------|------------------|-----------|
| FILE NAME = D160F05-SHT-ER0504.dgn | USER NAME = Anthony.Plutz | DESIGNED - L.N. | REVISED - |
| | | DRAWN - M.P. | REVISED - |
| | | CHECKED - W.H.I. | REVISED - |
| | | DATE - 03/13/13 | REVISED - |

**STATE OF ILLINOIS
 DEPARTMENT OF TRANSPORTATION**

**EROSION AND SEDIMENT CONTROL PLAN
 US 45 (LAGRANGE ROAD) - SOUTH CONTRACT - PRE-STAGE**

SCALE: 1"=50' SHEET NO. 3 OF 6 SHEETS STA. 72+00.00 TO STA. 102+00.00

| | | | | |
|---------------------------|---------|--------------------|--------------|-----------|
| F.A.P. RTE. | SECTION | COUNTY | TOTAL SHEETS | SHEET NO. |
| 330 | 103R-3 | COOK | 932 | 194 |
| ER-04 | | CONTRACT NO. 60F05 | | |
| ILLINOIS FED. AID PROJECT | | | | |