

SEE SHEET ER-23
MATCH LINE STA. 132+00.00

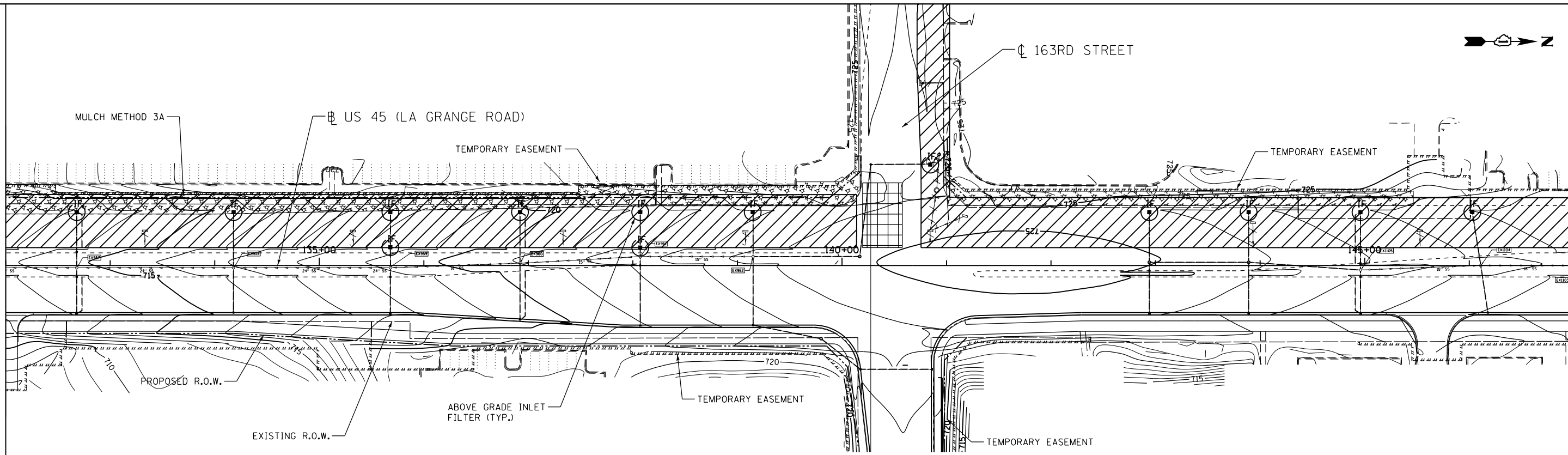

NOTE: SEE SHEET ER-01 FOR LEGEND AND NOTES.

MATCH LINE STA. 147+00.00
SEE BELOW

SEE ABOVE
MATCH LINE STA. 147+00.00

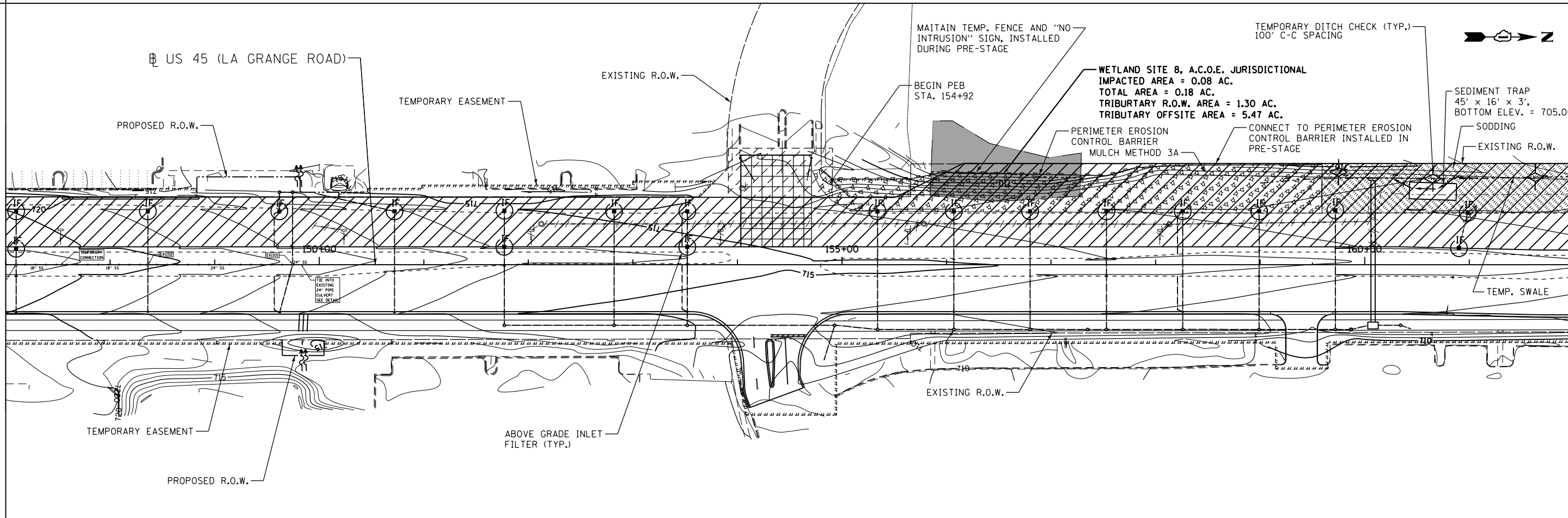

MATCH LINE STA. 162+00.00
SEE SHEET ER-25

FILE NAME = D160F05-SHT-ER0524.dgn	USER NAME = Anthony.Plutz	DESIGNED - L.N.	REVISED -
		DRAWN - M.P.	REVISED -
		CHECKED - W.H.I.	REVISED -
		DATE - 03/13/13	REVISED -

**STATE OF ILLINOIS
DEPARTMENT OF TRANSPORTATION**

**EROSION AND SEDIMENT CONTROL PLAN
US 45 (LAGRANGE ROAD) - SOUTH CONTRACT - STAGE III**

SCALE: 1"=50' SHEET NO. 5 OF 6 SHEETS STA. 132+00.00 TO STA. 162+00.00

F.A.P. RTE.	SECTION	COUNTY	TOTAL SHEETS	SHEET NO.
330	103R-3	COOK	932	214
ER-24			CONTRACT NO. 60F05	
ILLINOIS FED. AID PROJECT				