

FLARED END SECTION REMOVAL
 40+67.7, 63.8 LT
 42+78.1, 59.3 RT
 43+97.5, 41.8 RT
 45+21.5, 29.9 RT

CONCRETE HEADWALL REMOVAL
 45+19.4, 72.3 LT

REMOVING MANHOLES
 40+69.1, 6.0 LT

REMOVING CATCH BASINS
 40+39.1, 28.5 RT
 40+68.9, 47.4 LT
 40+73.1, 17.5 LT
 41+87.9, 24.7 RT
 41+90.4, 60.7 RT
 43+29.2, 50.4 LT
 43+30.2, 13.8 LT
 43+97.8, 19.3 RT

STORM SEWER REMOVAL - 12"
 STA. 39+14.6 TO 41+90.4 - 273'
 STA. 40+39.1 TO 40+69.1 - 41'
 STA. 40+69.1 TO 40+68.9 - 37'
 STA. 40+68.9 TO 40+67.7 - 15'
 STA. 40+69.1 TO 40+73.1 - 8'
 STA. 41+87.9 TO 41+90.4 - 32'
 STA. 41+90.4 TO 42+71.8 - 87'
 STA. 43+29.2 TO 43+30.2 - 33'
 STA. 43+97.5 TO 43+97.8 - 21'

STORM SEWER REMOVAL - 15"
 STA. 43+29.2 TO 45+19.6 - 187'

STORM SEWER REMOVAL - 18"
 STA. 45+19.6 TO 45+53.2 - 31'

PIPE CULVERT REMOVAL
 STA. 45+19.4 TO 45+21.5 - 102'

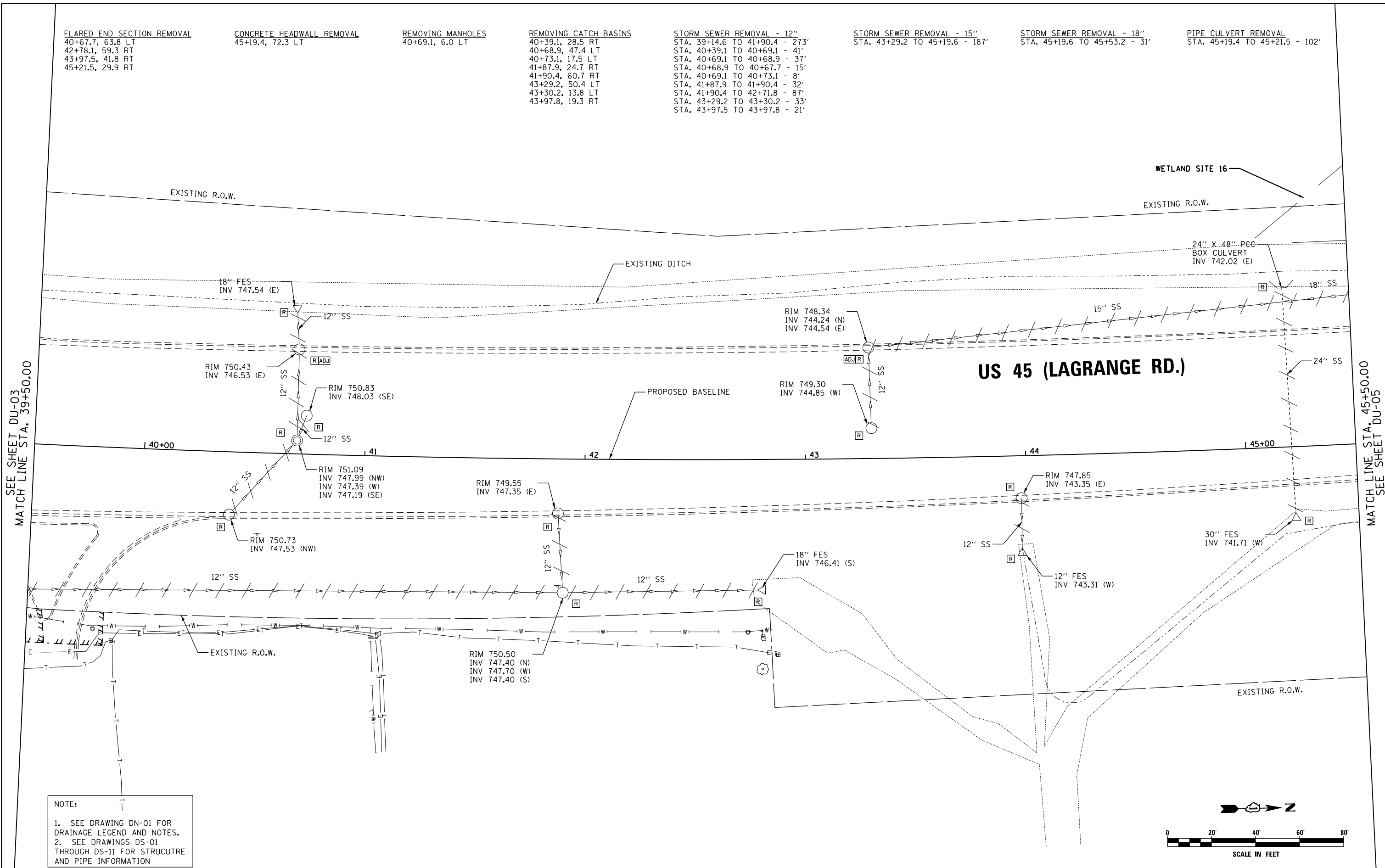

NOTE:
 1. SEE DRAWING DN-01 FOR DRAINAGE LEGEND AND NOTES.
 2. SEE DRAWINGS DS-01 THROUGH DS-11 FOR STRUCTURE AND PIPE INFORMATION

100 S. WACKER DR.
 SUITE 600
 CHICAGO, IL 60606
 TEL (312) 939-1000
 FAX (312) 939-4998



FILE NAME = D:\160F05-KEA-SHT-DRAINEX04.dgn	USER NAME = Frank_Stallone	DESIGNED - MGS	REVISED -
SHT.PLAN	PLOT SCALE = 40.0001' / in.	DRAWN - REW	REVISED -
	PLOT DATE = 3/14/2013	CHECKED - JRS	REVISED -
		DATE - 03/13/13	REVISED -

**STATE OF ILLINOIS
 DEPARTMENT OF TRANSPORTATION**

EXISTING DRAINAGE PLAN - US 55 (LAGRANGE ROAD)

SCALE: 1"=20' SHEET 4 OF 35 SHEETS STA. 39+50.00 TO STA. 45+50.00

F.A.P. RTE. 330	SECTION 103R-3	COUNTY COOK	TOTAL SHEETS 932	SHEET NO. 260
DU-04		CONTRACT NO. 60F05		
ILLINOIS FED. AID PROJECT				