

REMOVING CATCH BASINS  
 107+41.3, 14.4 RT  
 107+44.4, 52.6 LT  
 107+64.1, 19.4 LT  
 109+30.7, 14.0 RT  
 109+34.1, 52.4 LT

REMOVING MANHOLES  
 109+22.3, 20.7 RT

STORM SEWER REMOVAL - 12"  
 STA. 107+36.0 TO 107+41.3 - 7'  
 STA. 107+41.3 TO 107+44.4 - 63'  
 STA. 107+42.8 TO 107+64.1 - 19'  
 STA. 109+22.3 TO 109+30.7 - 6'  
 STA. 109+30.7 TO 109+34.1 - 62'

STORM SEWER REMOVAL - 15"  
 STA. 105+16.5 TO 109+22.3 - 403'

WETLAND SITE 11

US 45 (LAGRANGE RD.)

SEE SHEET DU-14  
 MATCH LINE STA. 105+50.00

MATCH LINE STA. 111+50.00  
 SEE SHEET DU-16

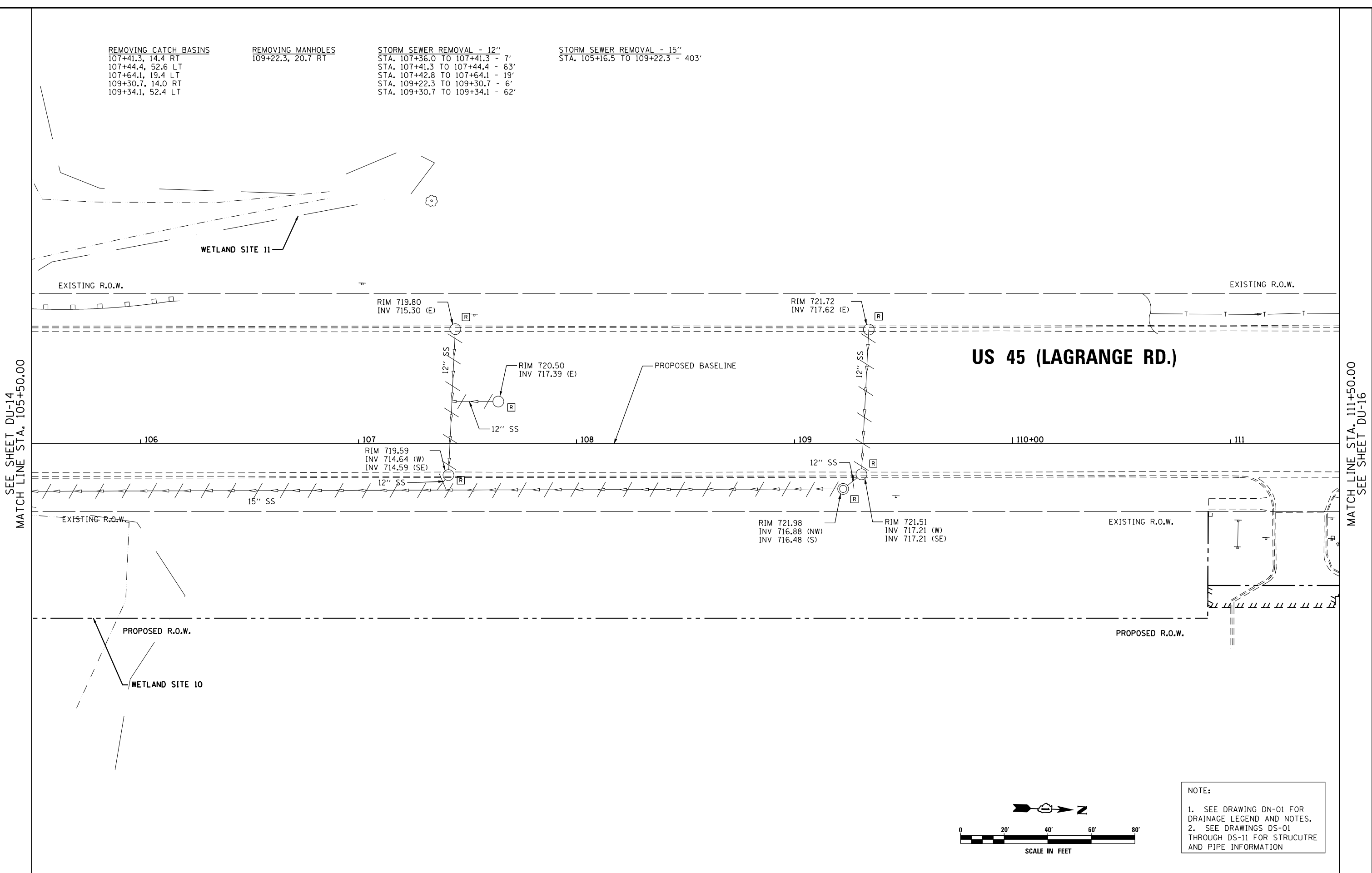

URS  
 100 S. WACKER DR.  
 SUITE 600  
 CHICAGO, IL 60606  
 TEL (312) 939-1000  
 FAX (312) 939-4998

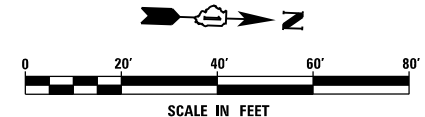

NOTE:  
 1. SEE DRAWING DN-01 FOR DRAINAGE LEGEND AND NOTES.  
 2. SEE DRAWINGS DS-01 THROUGH DS-11 FOR STRUCTURE AND PIPE INFORMATION

FILE NAME = D160F05-KEA-SHT-DRAINEX15.dgn	USER NAME = Frank.Stallone	DESIGNED - MGS	REVISED -
		DRAWN - REW	REVISED -
		CHECKED - JRS	REVISED -
SHT.PLAN	PLOT DATE = 3/14/2013	DATE - 03/13/13	REVISED -

STATE OF ILLINOIS  
 DEPARTMENT OF TRANSPORTATION

EXISTING DRAINAGE PLAN - US 45 (LAGRANGE ROAD)

SCALE: 1"=20' SHEET 15 OF 35 SHEETS STA. 105+50.00 TO STA. 111+50.00

F.A.P. RTE.	SECTION	COUNTY	TOTAL SHEETS	SHEET NO.
330	103R-3	COOK	932	271
<b>DU-15</b>			<b>CONTRACT NO. 60F05</b>	
ILLINOIS FED. AID PROJECT				