

US 45 (LAGRANGE RD.)

REMOVING MANHOLES
451+00.4, 40.6 LT

REMOVING CATCH BASINS
450+91.4, 33.0 LT
450+94.1, 33.5 RT

MANHOLES TO BE ADJUSTED
452+49.5, 39.4 LT
454+00.3, 40.1 LT

CATCH BASINS TO BE ADJUSTED
452+39.4, 33.0 LT
452+41.8, 33.3 RT
452+70.7, 51.9 RT
453+09.8, 51.0 RT
453+90.8, 33.0 LT
453+91.9, 33.3 RT

STORM SEWER REMOVAL - 12"
STA. 450+94.1 TO 451+00.4 - 70'
STA. 451+00.4 TO 451+37.6 - 35'
STA. 450+91.4 TO 450+99.6 - 6'

SEE DU-12 FOR US 45 EXISTING DRAINAGE

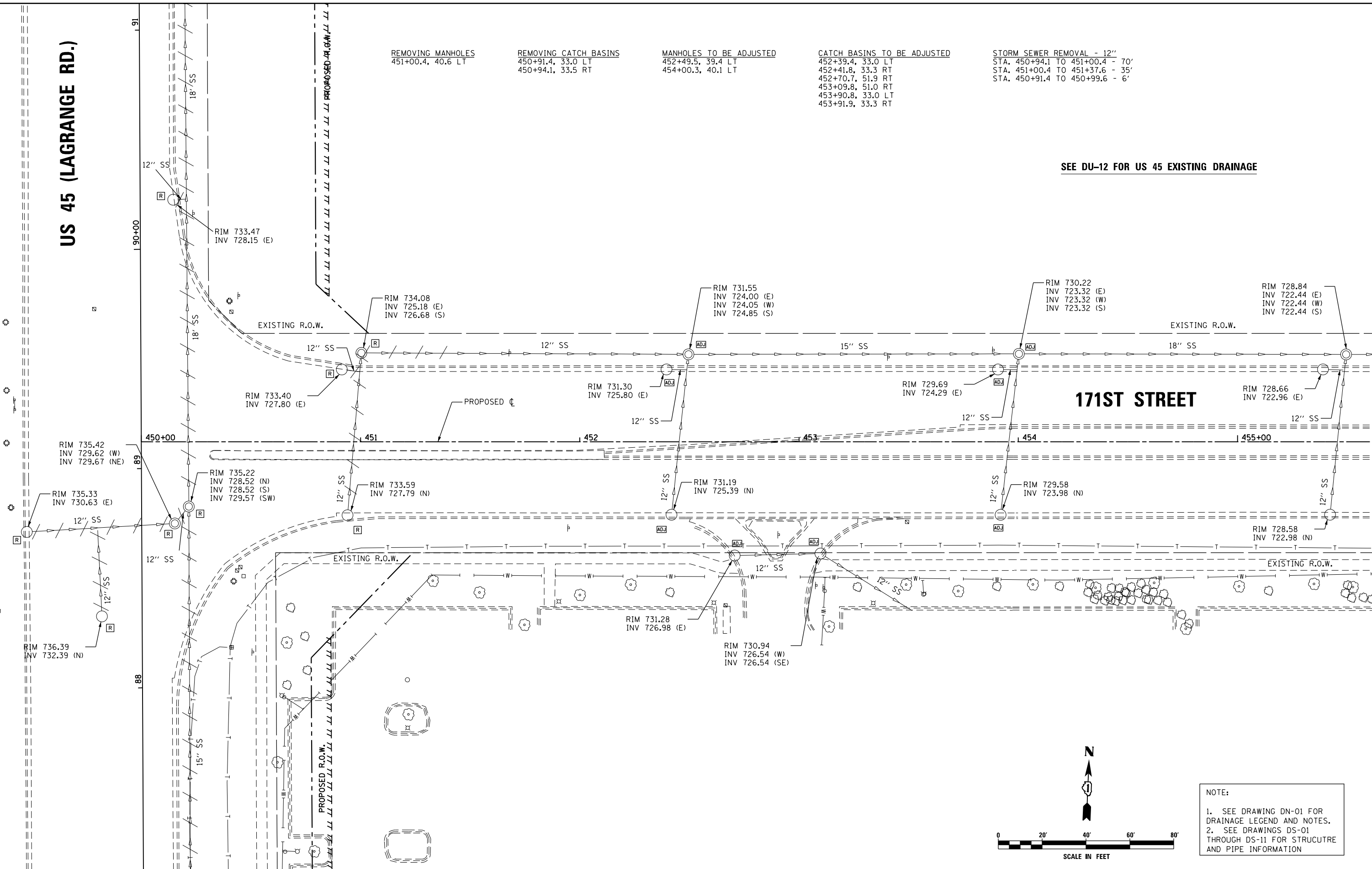

171ST STREET

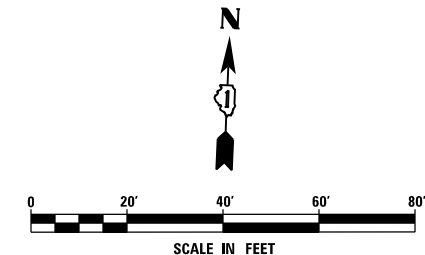

NOTE:
1. SEE DRAWING DN-01 FOR DRAINAGE LEGEND AND NOTES.
2. SEE DRAWINGS DS-01 THROUGH DS-11 FOR STRUCTURE AND PIPE INFORMATION

URS
100 S. WACKER DR.
SUITE 600
CHICAGO, IL 60606
TEL (312) 939-1000
FAX (312) 939-4998

FILE NAME = D160F05-KEA-SHT-DRAINEX30.dgn	USER NAME = Frank.Stallone	DESIGNED - MGS	REVISED -	STATE OF ILLINOIS DEPARTMENT OF TRANSPORTATION	EXISTING DRAINAGE PLAN - 171ST STREET			F.A.P. RTE. 330	SECTION 103R-3	COUNTY COOK	TOTAL SHEETS 932	SHEET NO. 286
PLOT SCALE = 40.0001' / in.	CHECKED - JRS	DRAWN - REW	REVISED -		SCALE: 1"=20'	SHEET 30 OF 35 SHEETS	STA. TO STA.	DU-30 CONTRACT NO. 60F05				
PLOT DATE = 3/14/2013	DATE - 03/13/13	REVISOR -	REVISOR -		ILLINOIS FED. AID PROJECT							
SHT.PLAN												