

REMOVING CATCH BASINS
428+55.3, 24.2 RT
428+56.5, 9.8 LT

FLARED END SECTION REMOVAL
429+36.2, 43.1 LT

STORM SEWER REMOVAL - 12"
STA. 428+55.3 TO 428+56.5 - 30'
STA. 428+56.5 TO 429+21.8 - 66'

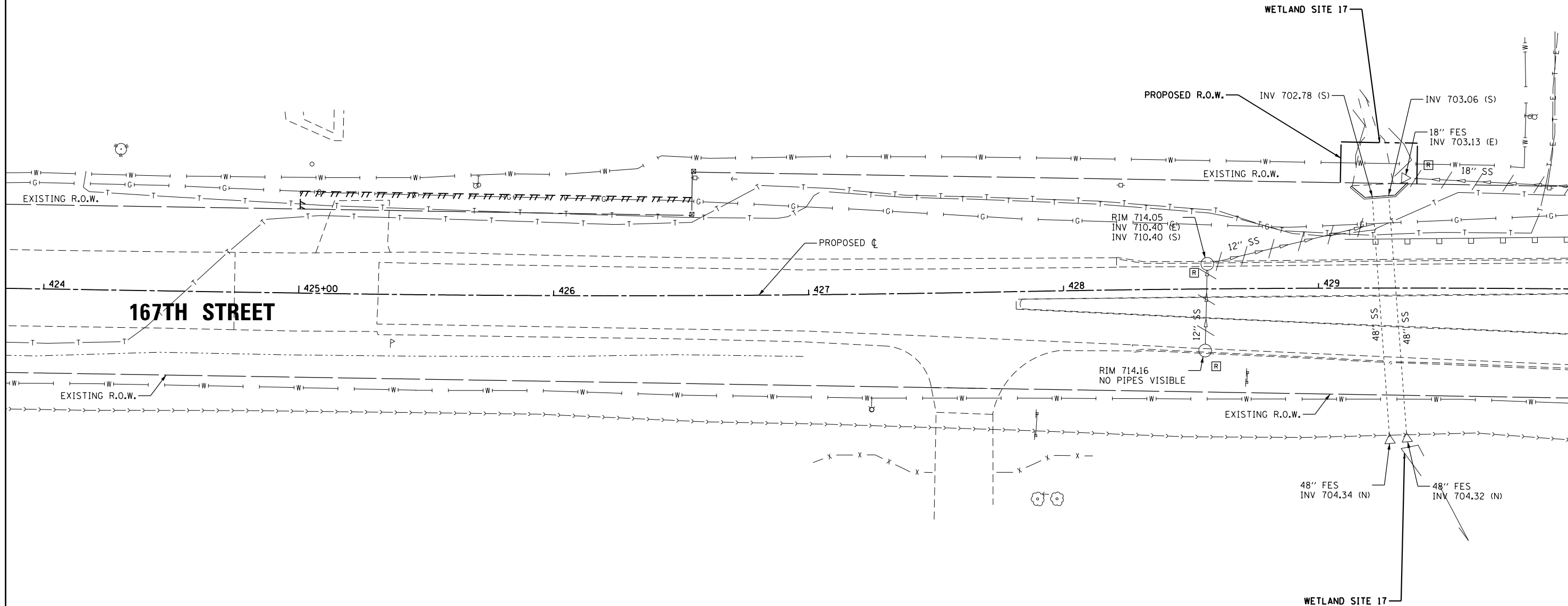

MATCH LINE STA. 430+00.00
SEE SHEET DU-32

NOTE:
1. SEE DRAWING DN-01 FOR DRAINAGE LEGEND AND NOTES.
2. SEE DRAWINGS DS-01 THROUGH DS-11 FOR STRUCTURE AND PIPE INFORMATION

URS
100 S. WACKER DR.
SUITE 600
CHICAGO, IL 60606
TEL (312) 939-1000
FAX (312) 939-4198

FILE NAME = D160F05-KEA-SHT-DRAINEX31.dgn	USER NAME = Frank.Stallone	DESIGNED - MGS	REVISED -
		DRAWN - REW	REVISED -
		CHECKED - JRS	REVISED -
		DATE - 03/13/13	REVISED -

**STATE OF ILLINOIS
DEPARTMENT OF TRANSPORTATION**

EXISTING DRAINAGE PLAN - 167TH STREET

SCALE: 1"=20' SHEET 31 OF 35 SHEETS STA. BEGIN TO STA. 430+00.00

F.A.P. RTE. 330	SECTION 103R-3	COUNTY COOK	TOTAL SHEETS 932	SHEET NO. 287
DU-31			CONTRACT NO. 60F05	
ILLINOIS FED. AID PROJECT				