

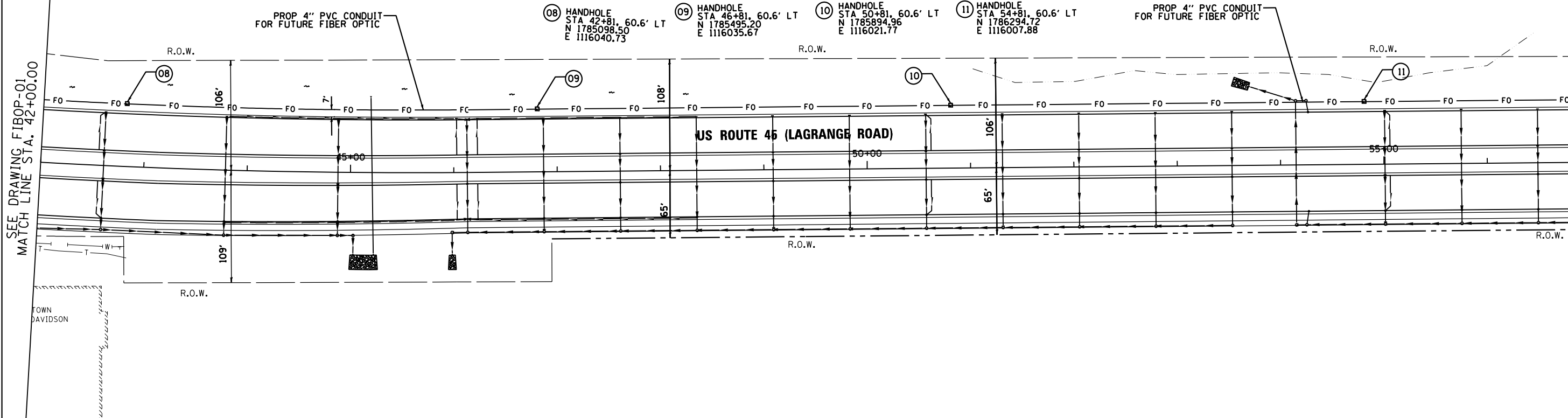

SEE DRAWING FIBOP-01
MATCH LINE STA. 42+00.00

MATCH LINE STA. 57+00.00
SEE BELOW



RESTORATION OF WORK AREA, RESTORATION OF THE TRAFFIC SIGNAL WORK AREA SHALL BE INCIDENTAL TO THE RELATED PAY ITEM SUCH AS FOUNDATION, CONDUIT, HANDHOLE, TRENCH AND BACKFILL, ETC., AND NO EXTRA COMPENSATION SHALL BE ALLOWED. ALL ROADWAY SURFACES SUCH AS SHOULDERS, MEDIANS, SIDEWALKS, PAVEMENT, ETC. SHALL BE REPLACED IN KIND. ALL DAMAGE TO MOWED LAWNS SHALL BE REPLACED WITH AN APPROVED SOD, AND ALL DAMAGE TO UNMOWED FIELDS SHALL BE SEED IN ACCORDANCE WITH STANDARD SPECIFICATIONS 252 AND 250 RESPECTIVELY.

NOTE:
GALVANIZED STEEL CONDUIT IDENTIFIED AS IN TRENCH (T) OR PUSHED (P) IS SHOWN FOR INFORMATION ONLY. ALL UNDERGROUND CONDUIT SHALL BE PAID FOR AT THE CONTRACT UNIT PRICER PER FOOT FOR UNDERGROUND CONDUIT, OF THE TYPE AND SIZE SPECIFIED, REGARDLESS OF THE METHOD OF INSTALLATION.



SEE ABOVE
MATCH LINE STA. 57+00.00

MATCH LINE STA. 72+00.00
SEE DRAWING FIBOP-03

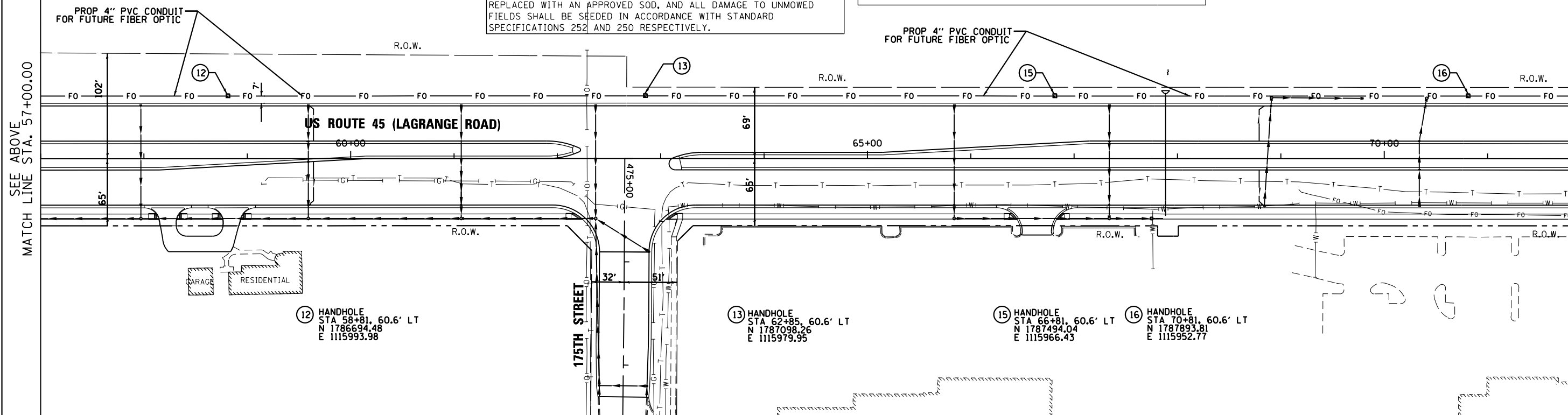

100 S. WACKER DR.
SUITE 600
CHICAGO, IL 60606
TEL (312) 939-1000
FAX (312) 939-4998

FILE NAME = D:\160F05-SHT-FIBOP02.dgn
SHT_DOUBLE PLAN
DT160F05-SHT-FIBOP02.dgn 3/12/2013 3:22:46 PM

USER NAME = Anthony.Plutz	DESIGNED - BA	REVISED -
PLOT SCALE = 100.000000' / in.	DRAWN - BA	REVISED -
PLOT DATE = 3/12/2013	CHECKED - MJT	REVISED -
	DATE - 03/13/13	REVISED -

STATE OF ILLINOIS
DEPARTMENT OF TRANSPORTATION

PROPOSED FIBER OPTIC CONDUIT
US 45 (LAGRANGE ROAD)
FROM 183RD STREET TO 159TH STREET

SCALE: 1"=50'
SHEET 2 OF 6 SHEETS
STA. 42+00.00 TO STA. 72+00.00

F.A.P. RTE. 330	SECTION 103R-3	COUNTY COOK	TOTAL SHEETS 932	SHEET NO. 372
FIBOP-02		CONTRACT NO. 60F05		
ILLINOIS FED. AID PROJECT				