

MATCHLINE STA. 63+50

MATCHLINE STA. 69+00

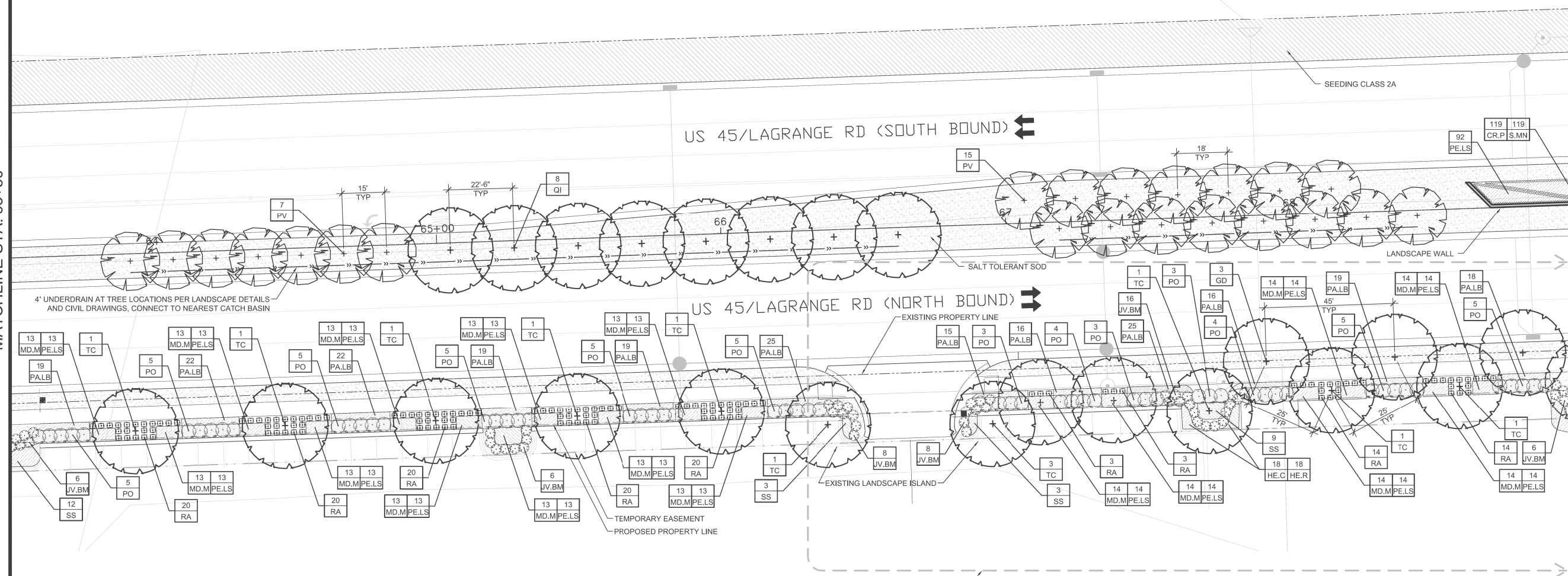

1 LANDSCAPE PLAN
1"=20'-0"

CONTRACTOR TO OBTAIN UPDATED SURVEY FOR AREA AND COORDINATE CHANGES BETWEEN AOR & EOR AND ALL UTILITIES

PLANT SCHEDULE						
CODE	QUANTITY	BOTANICAL NAME	COMMON NAME	SIZE	ROOT	REMARKS
SHADE TREES						
GD	3	Gymnocladus dioica	Kentucky Coffee Tree	2.5" cal.	B&B	matching heads
QI	6	Quercus imbricaria	Shingle Oak	2.5" cal.	B&B	matching heads
TC	12	Tilia cordata	Little Leaf Linden	2.5" cal.	B&B	matching heads
ORNAMENTAL TREES						
PV	22	Prunus virginiana 'Canada Red'	Canada Red Cherry	2.5" cal.	B&B	matching heads
SHRUBS						
JV.BM	50	Juniper virginiana 'Blue Mountain'	Blue Mountain Juniper	5 gal.	pot	42" o.c.
PO	57	Physocarpus opulifolius 'Monto'	Diablo Ninebark	36"H	B&B	40" o.c.
RA	134	Rhus aromatica 'Gro Low'	Grow Low Sumac	24"W	pot	30" o.c.
PERENNIALS, ORNAMENTAL GRASSES, VINES AND OTHER						
CR.P	119	Crocus 'Purple'	Purple Crocus	8 cm.	pot	15" interplanted
HE.C	18	Hemerocallis 'Chicago Apache'	Chicago Apache Daylily	gal.	pot	15" o.c.
HE.R	18	Hemerocallis 'Rosy Returns'	Rosy Returns Pink Daylily	gal.	pot	15" o.c.
MD.M	227	Mondardia didyma 'Marshall's Delight'	Marshall's Delight Monarda	gal.	pot	15" o.c.
PALB	235	Pennisetum alopecuroides 'Little Bunny'	Little Bunny Fountain Grass	gal.	pot	18" o.c.
PE.LS	319	Paroskia atriplicifolia 'Little Spire'	Little Spire Russian Sage	gal.	pot	15" o.c.
S.MN	119	Salvia 'May Night'	May Night Salvia	gal.	pot	15" o.c.
SS	27	Schizachyrium scoparium	Little Bluestem	3 gal.	pot	30" o.c.

NOTES:

- ALL PLANTINGS SHALL FOLLOW IDOT BUREAU OF DESIGN & ENVIRONMENT MANUAL - CHAPTER 59 - LANDSCAPE DESIGN AND EROSION CONTROL 59-7.09 PLANTING IN URBANIZED AREA FOR SIGHT DISTANCES.
- ALL AREAS TO BE LANDSCAPED SHALL BE EXCAVATED TO THE DEPTH APPROPRIATE FOR THE PROPOSED PLANTINGS. NO EXISTING SOD SHALL REMAIN IN NEW PLANTING AREAS.
- PLANT QUANTITIES SHOWN ON DRAWINGS ARE APPROXIMATE. CONTRACTOR SHALL PROVIDE PLANT MATERIALS SUFFICIENT TO COVER AREAS SHOWN ON PLANS AT THE SPACING INDICATED.
- ANY AREAS OUTSIDE OF THE LANDSCAPE BEDS THAT ARE DISTURBED SHALL BE REPLACED IN KIND.
- NO PLANTING SHALL BE CLOSER THAN 72" FROM FACE OF MEDIAN CURB. NO TREES SHALL BE CLOSER THAN 72" FROM FACE OF MEDIAN CURB.
- MULCH METHOD 2 SHALL BE USED AT ALL SEEDING LOCATIONS NOT PROTECTED BY EROSION CONTROL BLANKET. HATCHING MAY HAVE BEEN OMITTED FOR CLARITY.
- WEED CONTROL NON-SELECTIVE AND NON-RESIDUAL (WETLAND SHOULD BE USED AT ALL INTERSEEDING CLASS 4 AREAS.)
- INTERSEEDING. CLASS 4 SHOULD BE USED WITHIN THE LIMITS OF SELECTIVE CLEARING.
- FOR LANDSCAPE PLANTING DETAILS, SEE SHEETS LA-11 & LA-12.
- FOR PLANT SCHEDULE, SEE SHEET LA-13.
- FOR PROPOSED LANDSCAPE WALL DETAILS, SEE SHEET LA-14.
- FOR ADDITIONAL PLANTING NOTES, SEE SHEET LA-12.
- COORDINATE ALL LANDSCAPE PLANTINGS WITH NEW AND EXISTING UTILITY LINES AND STRUCTURES.
- CONNECT ALL UNDERDRAINS TO NEAREST DRAINAGE STRUCTURE. COORDINATE WITH EOR/AOR.
- ALL NEW SHADE TREES SHALL BE 15'-0" MIN. AWAY FROM OVERHEAD UTILITY LINES AND STRUCTURES.
- CONTRACTOR IS RESPONSIBLE FOR VERIFYING EXISTING CONDITIONS AND SURVEY WITH PROPOSED PLANES. COORDINATE ANY DISCREPANCIES WITH EOR/AOR.

LEGEND:

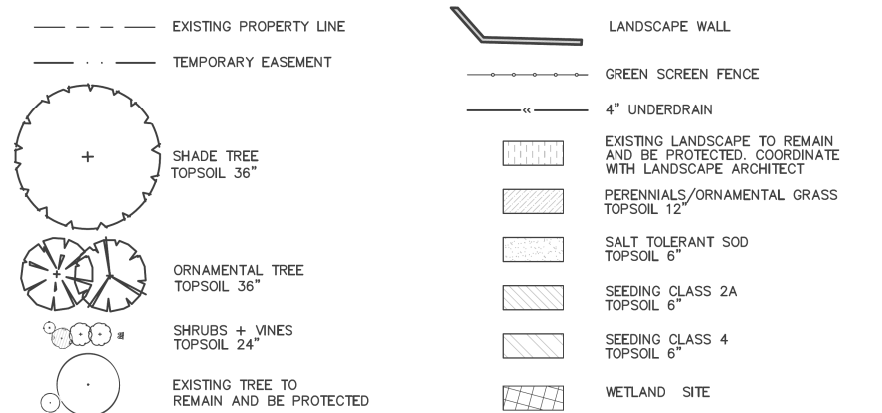

FILE NAME = 7102_land.dwg	USER NAME = jrossman	DESIGNED = AB	REVISED =
		DRAWN = JR	REVISED =
		CHECKED = BM	REVISED =
		DATE = 03/13/13	REVISED =

STATE OF ILLINOIS
DEPARTMENT OF TRANSPORTATION

LANDSCAPING PLAN US 45 (LAGRANGE ROAD)		F.A.P. RITE. 330	SECTION 103R-3	COUNTY COOK	TOTAL SHEETS 932	SHEET NO. 430
SCALE: AS SHOWN	SHEET NO. 6 OF 15 SHEETS	STA. 63+50.00 TO STA. 69+00.00	LA-06		CONTRACT NO. 60F05	
ILLINOIS FED. AID PROJECT						