

| PLANT SCHEDULE | | | | | | |
|---|----------|---------------------------------|-------------------------|-----------|------|------------------|
| SHADE TREES | | | | | | |
| CODE | QUANTITY | BOTANICAL NAME | COMMON NAME | SIZE | ROOT | REMARKS |
| CO | 8 | Cellis occidentalis | Northern Hackberry | 2.5" cal. | B&B | matching heads |
| LT | 4 | Liliodendron tulipifera | Tulip Tree | 2.5" cal. | B&B | matching heads |
| QB | 5 | Quercus bicolor | Swamp White Oak | 2.5" cal. | B&B | matching heads |
| QM | 7 | Quercus muehlenbergii | Chinkapin Oak | 2.5" cal. | B&B | matching heads |
| ORNAMENTAL TREES | | | | | | |
| CODE | QUANTITY | BOTANICAL NAME | COMMON NAME | SIZE | ROOT | REMARKS |
| CV | 10 | Crataegus virdis 'Winter King' | Winter King Hawthorn | 8'H | B&B | multi-stem |
| SHRUBS | | | | | | |
| CODE | QUANTITY | BOTANICAL NAME | COMMON NAME | SIZE | ROOT | REMARKS |
| HK | 136 | Hypericum kalmianum 'Ames' | St. Johnswort | 18"H | pot | 30" o.c. |
| RA | 150 | Rhus aromatica 'Gro Low' | Grow Low Sumac | 24"W | pot | 30" o.c. |
| RO.W | 40 | Rosa JACruwhi 'Wild Spice' | Wild Spice White Rose | 2 gal. | pot | 36" o.c. |
| SP.TR | 42 | Spiraea Tor | Birchleaf Tor Spiraea | 24"H | pot | 30" o.c. |
| PERENNIALS, ORNAMENTAL GRASSES, VINES AND OTHER | | | | | | |
| CODE | QUANTITY | BOTANICAL NAME | COMMON NAME | SIZE | ROOT | REMARKS |
| CR.Y | 236 | Crocus 'Yellow' | Yellow Crocus | 8 cm. | pot | 15" interplanted |
| CV.Z | 236 | Coreopsis verticillata 'Zagreb' | Zagreb Coreopsis | gal. | pot | 15" o.c. |
| PV.S | 160 | Panicum virgatum 'Shenandoah' | Shenandoah Switch Grass | 3 gal. | pot | 30" o.c. |
| SA | 46 | Sesleria autumnalis | Autumn Moor Grass | 3 gal. | pot | 30" o.c. |

NOTES:

- ALL PLANTINGS SHALL FOLLOW IDOT BUREAU OF DESIGN & ENVIRONMENT MANUAL - CHAPTER 59 - LANDSCAPE DESIGN AND EROSION CONTROL 59-7.09 PLANTING IN URBANIZED AREA FOR SIGHT DISTANCES.
- ALL AREAS TO BE LANDSCAPED SHALL BE EXCAVATED TO THE DEPTH APPROPRIATE FOR THE PROPOSED PLANTINGS. NO EXISTING SOD SHALL REMAIN IN NEW PLANTING AREAS.
- PLANT QUANTITIES SHOWN ON DRAWINGS ARE APPROXIMATE. CONTRACTOR SHALL PROVIDE PLANT MATERIALS SUFFICIENT TO COVER AREAS SHOWN ON PLANS AT THE SPACING INDICATED.
- ANY AREAS OUTSIDE OF THE LANDSCAPE BEDS THAT ARE DISTURBED SHALL BE REPLACED IN KIND.
- NO PLANTING SHALL BE CLOSER THAN 72" FROM FACE OF MEDIAN CURB. NO TREES SHALL BE CLOSER THAN 72" FROM FACE OF MEDIAN CURB.
- MULCH METHOD 2 SHALL BE USED AT ALL SEEDING LOCATIONS NOT PROTECTED BY EROSION CONTROL BLANKET. HATCHING MAY HAVE BEEN OMITTED FOR CLARITY.
- WEED CONTROL NON-SELECTIVE AND NON-RESIDUAL (WETLAND SHOULD BE USED AT ALL INTERSEEDING CLASS 4 AREAS.)
- INTERSEEDING. CLASS 4 SHOULD BE USED WITHIN THE LIMITS OF SELECTIVE CLEARING.
- FOR LANDSCAPE PLANTING DETAILS, SEE SHEETS LA-11 & LA-12.
- FOR PLANT SCHEDULE, SEE SHEET LA-13.
- FOR PROPOSED LANDSCAPE WALL DETAILS, SEE SHEET LA-14.
- FOR ADDITIONAL PLANTING NOTES, SEE SHEET LA-12.
- COORDINATE ALL LANDSCAPE PLANTINGS WITH NEW AND EXISTING UTILITY LINES AND STRUCTURES.
- CONNECT ALL UNDERDRAINS TO NEAREST DRAINAGE STRUCTURE. COORDINATE WITH EOR/AOR.
- ALL NEW SHADE TREES SHALL BE 15'-0" MIN. AWAY FROM OVERHEAD UTILITY LINES AND STRUCTURES.
- CONTRACTOR IS RESPONSIBLE FOR VERIFYING EXISTING CONDITIONS AND SURVEY WITH PROPOSED PLANES. COORDINATE ANY DISCREPANCIES WITH EOR/AOR.

LEGEND:

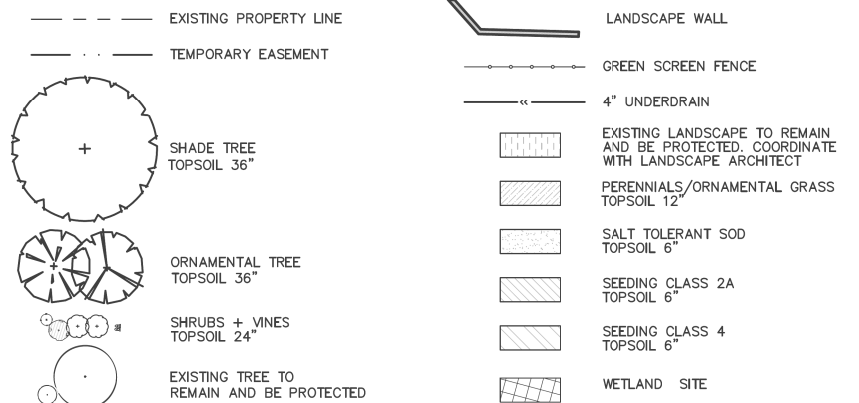

| | | | |
|---------------------------|----------------------|-----------------|-----------|
| FILE NAME = 7102_land.dwg | USER NAME = jrossman | DESIGNED = AB | REVISED = |
| | | DRAWN = JR | REVISED = |
| | | CHECKED = BM | REVISED = |
| | | DATE = 03/13/13 | REVISED = |

**STATE OF ILLINOIS
DEPARTMENT OF TRANSPORTATION**

**LANDSCAPING PLAN
US 45 (LAGRANGE ROAD)**

SCALE: AS SHOWN SHEET NO. 8 OF 15 SHEETS STA. 75+00.00 TO STA. 81+00.00

| | | | | |
|---------------------------|----------------|--------------------|------------------|---------------|
| F.A.P. RTE. 330 | SECTION 103R-3 | COUNTY COOK | TOTAL SHEETS 932 | SHEET NO. 432 |
| LA-08 | | CONTRACT NO. 60F05 | | |
| ILLINOIS FED. AID PROJECT | | | | |