

MATCH LINE SEE DRAWING E-9
US-45 STA 144+50

MATCH LINE SEE BELOW
US-45 STA 159+50

MATCH LINE SEE ABOVE
US-45 STA 159+50

LIMIT OF ELECTRICAL WORK

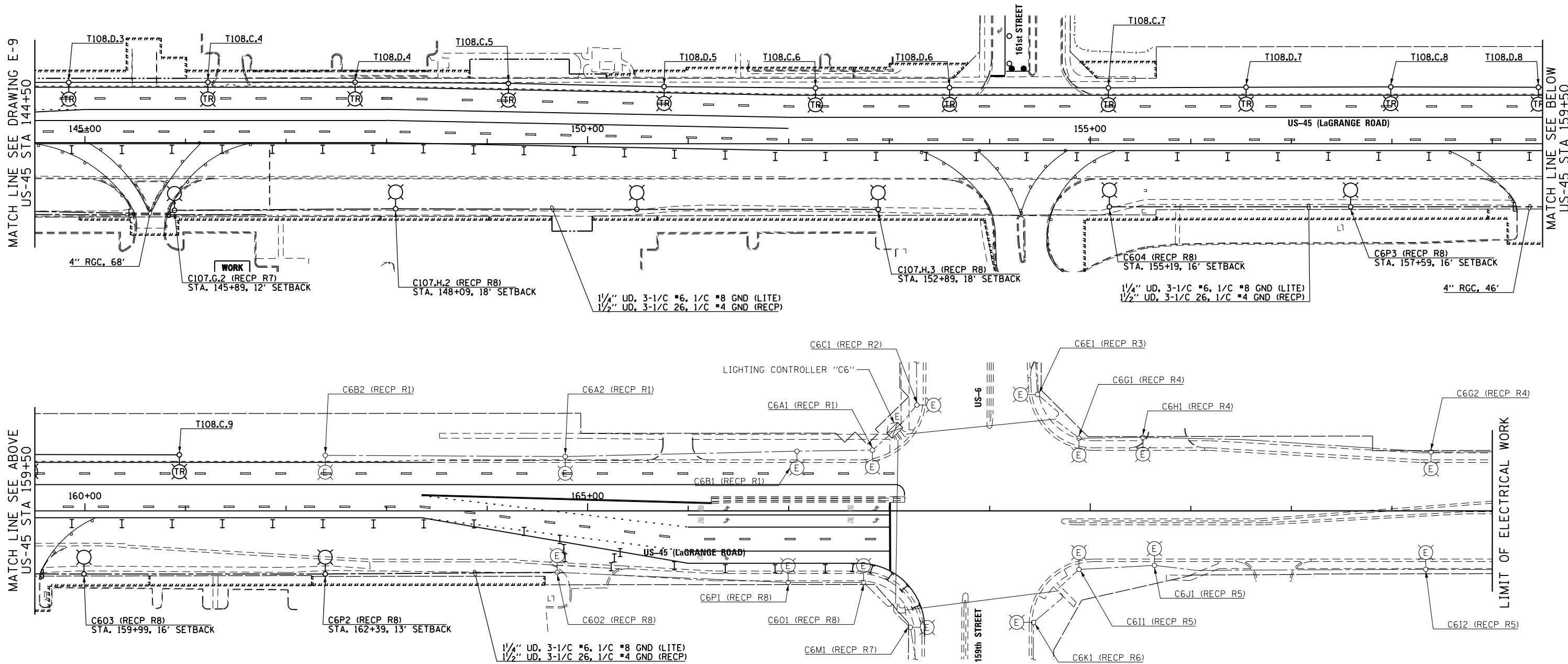

NOTES:

- SEE DRAWING E-1 FOR ELECTRICAL SYMBOL LIST AND ABBREVIATIONS. SEE DRAWING E-2 FOR ELECTRICAL GENERAL NOTES.
- SEE DRAWING E-26 FOR PROPOSED LIGHTING UNIT DETAILS. SEE IDOT STANDARD DRAWING E-25 FOR PROPOSED LIGHTING UNIT FOUNDATION DETAILS.
- CONTRACTOR SHALL REMOVE THE IDENTIFIED TEMPORARY LIGHTING UNITS, TEMPORARY LIGHTING CONTROLLERS, ALL ASSOCIATED UTILITY SERVICE WORK, AND THE TEMPORARY WIRING DURING CONSTRUCTION STAGE 2, ONCE ALL OF THE PROPOSED ROADWAY LIGHTING UNITS ALONG THE EAST SIDE OF LAGRANGE ROAD ARE INSTALLED, ENERGIZED, TESTED, AND APPROVED BY THE ENGINEER.

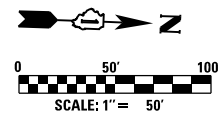

100 S. WACKER DR.
 SUITE 600
 CHICAGO, IL 60606
 TEL (312) 939-1000
 FAX (312) 939-4998
URS

FILE NAME = D160F05-SHT-E10.dgn	USER NAME = Frank.Stallone	DESIGNED - MAE	REVISED -
		DRAWN - WM	REVISED -
	PLOT SCALE = 100.000000' / in.	CHECKED - DAD	REVISED -
SHT.PLAN	PLOT DATE = 3/14/2013	DATE - 03/13/13	REVISED -

**STATE OF ILLINOIS
DEPARTMENT OF TRANSPORTATION**

**US 45 (LaGRANGE ROAD)
TEMPORARY LIGHTING PLAN: STAGE 2**

SCALE: 1"=50' SHEET 2 OF 2 SHEETS STA. 144+50.00 TO STA. 174+00.00

F.A.P. RTE.	SECTION	COUNTY	TOTAL SHEETS	SHEET NO.
330	103R-3	COOK	932	536
E-10			CONTRACT NO. 60F05	
ILLINOIS FED. AID PROJECT				