

DATE	
BY	
FINISHED	
PLOTTED	
TEMPLATE	
AREAS	
AREAS CHECKED	

DATE	
BY	
ORIGINAL SURVEY	
PLOTTED	
TEMPLATE	
AREAS	
AREAS CHECKED	

100 S. WACKER DR.  
 CHICAGO, IL 60606  
 TEL 312/939-4000  
 FAX 312/939-4098

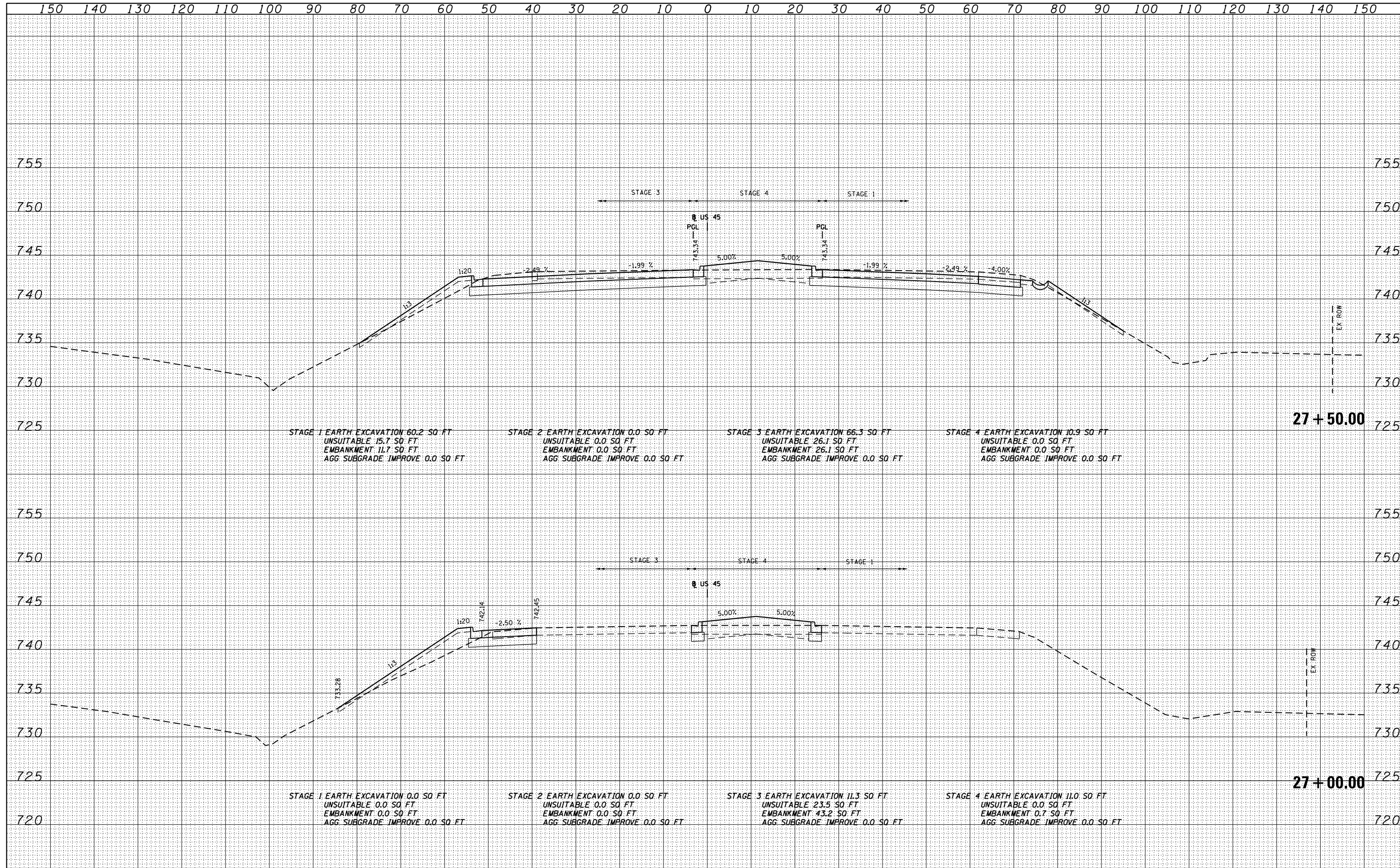

FILE NAME = D160F05-SHT-XSST01.dgn	USER NAME = Anthony.Plutz	DESIGNED - BFH	REVISIED -	<b>STATE OF ILLINOIS</b> <b>DEPARTMENT OF TRANSPORTATION</b>	<b>US 45 CROSS SECTIONS</b> SCALE: 1"=10'H; 1"=5'V SHEET NO. 8 OF 147 SHEETS STA. 27+00.00 TO STA. 27+50.00			F.A.P. RTE. 330	SECTION 103R-3	COUNTY COOK	TOTAL SHEETS 932	SHEET NO. 745
PLOT SCALE = 20.0000" / in.	CHECKED - E.JG	REVISIED -	<b>XS-US45-08</b>					CONTRACT NO. 60F05				
PLOT DATE = 3/9/2013	DATE - 03/13/13	REVISIED -	ILLINOIS FED. AID PROJECT									