

DATE	
BY	
FINISHED	
NO. OF SHEETS	
DATE	
BY	
FINISHED	
NO. OF SHEETS	
DATE	
BY	
FINISHED	
NO. OF SHEETS	

DATE	
BY	
FINISHED	
NO. OF SHEETS	
DATE	
BY	
FINISHED	
NO. OF SHEETS	
DATE	
BY	
FINISHED	
NO. OF SHEETS	

100 SWACKER DR.
 CHICAGO, IL 60606
 TEL (312) 939-1000
 FAX (312) 939-4198

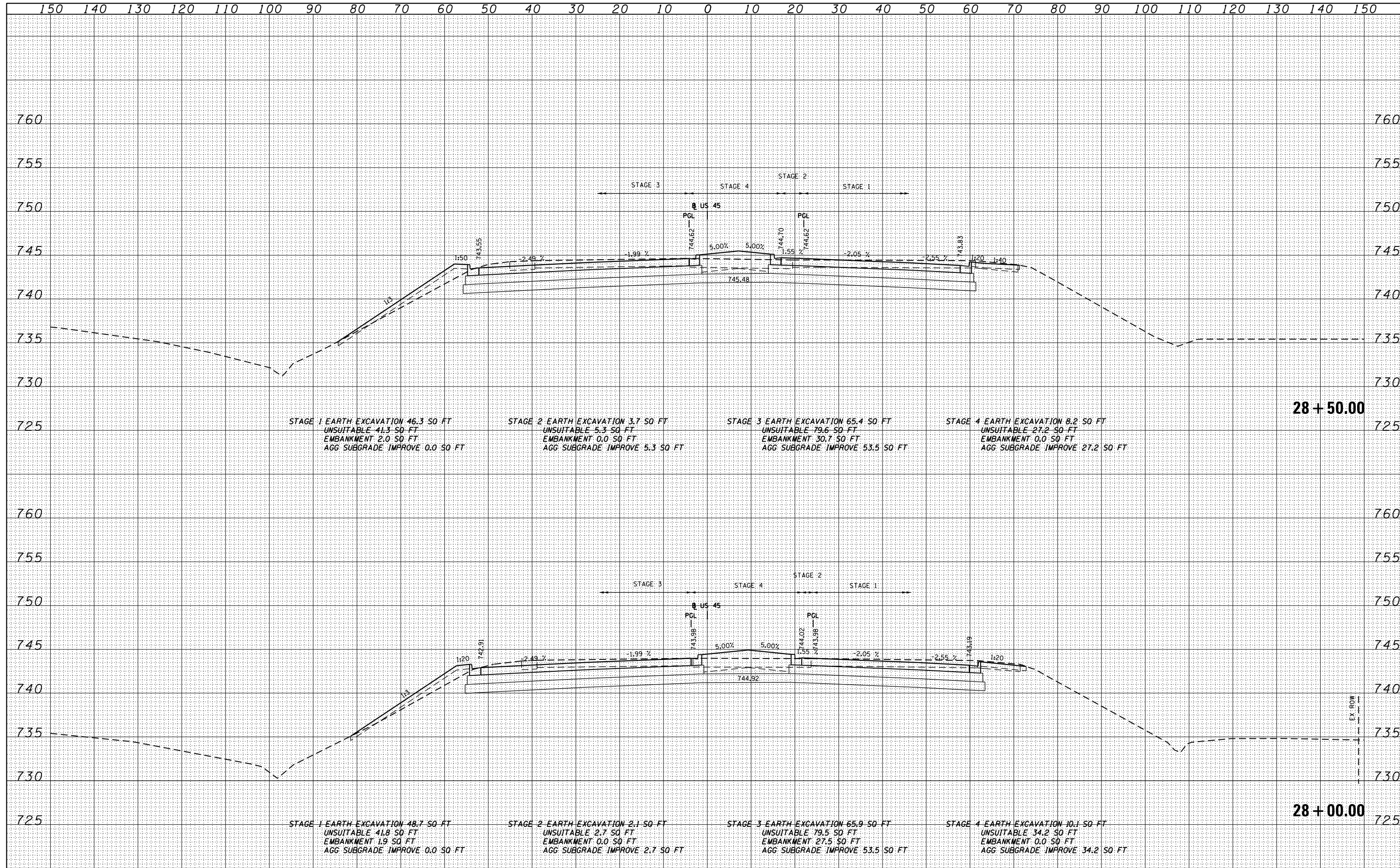

FILE NAME =	USER NAME = Anthony.Plutz	DESIGNED - BFH	REVISED -	STATE OF ILLINOIS DEPARTMENT OF TRANSPORTATION	US 55 CROSS SECTIONS			F.A.P. RTE.	SECTION	COUNTY	TOTAL SHEETS	SHEET NO.
D160F05-SHT-XSST01.dgn		DRAWN - BFH	REVISED -		330	103R-3	COOK	932	746			
PLOT SCALE = 20.0000' / in.		CHECKED - EUG	REVISED -		XS-US45-09			CONTRACT NO. 60F05				
PLOT DATE = 3/9/2013		DATE - 03/13/13	REVISED -		SCALE: 1"=10'H; 1"=5'V			SHEET NO. 9 OF 147 SHEETS		STA. 28+00.00 TO STA. 28+50.00		ILLINOIS FED. AID PROJECT