

DATE	
BY	
FINISHED SURVEY	
PLOTTED	
TEMPLATE	
NOTE BOOK	
AREAS CHECKED	

DATE	
BY	
ORIGINAL SURVEY	
PLOTTED	
TEMPLATE	
NOTE BOOK	
AREAS CHECKED	

100 S. WACKER DR.  
 CHICAGO, IL 60606  
 TEL 312/939-1000  
 FAX 312/939-4198

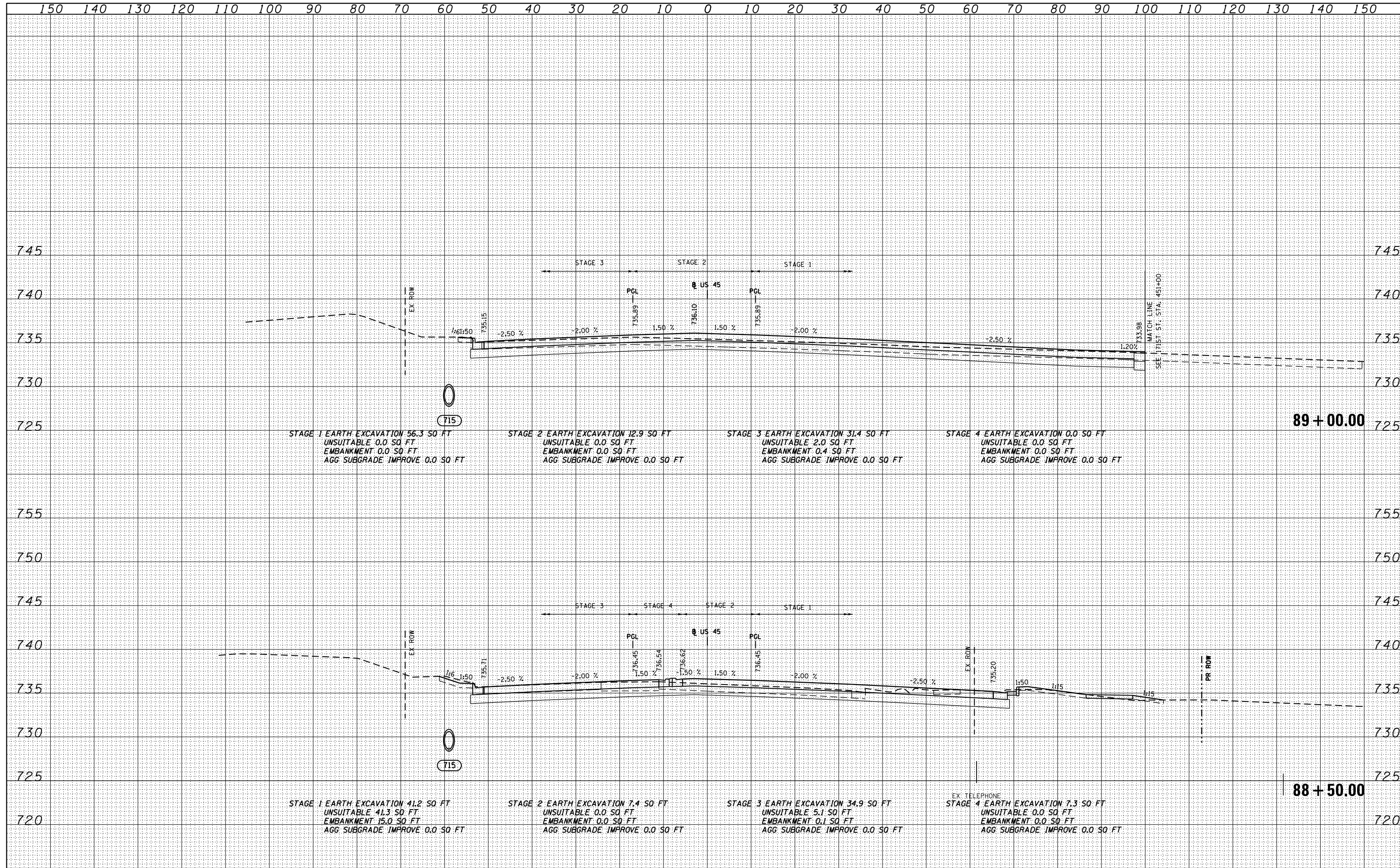

FILE NAME = D160F05-SHT-XSSHT01.dgn	USER NAME = Anthony.Plutz	DESIGNED - BFH	REVISIED -	<b>STATE OF ILLINOIS</b> <b>DEPARTMENT OF TRANSPORTATION</b> <b>US 45 CROSS SECTIONS</b> SCALE: 1"=10'H; 1"=5' SHEET NO. 70 OF 147 SHEETS STA. 88+50.00 TO STA. 89+00.00	F.A.P. RTE. 330	SECTION 103R-3	COUNTY COOK	TOTAL SHEETS 932	SHEET NO. 807	
	PLOT SCALE = 20.0000' / in.	CHECKED - EUG	REVISIED -		<b>XS-US45-70</b>		CONTRACT NO. 60F05			
	PLOT DATE = 3/9/2013	DATE - 03/13/13	REVISIED -		ILLINOIS FED. AID PROJECT					