

DATE	
BY	
SURVEYED	
PLOTTED	
TEMPLATE	
AREAS	
CHECKED	
FINISH	
NO.	

DATE	
BY	
SURVEYED	
PLOTTED	
TEMPLATE	
AREAS	
CHECKED	
ORIGINAL	
NO.	

100 S. WACKER DR.  
 SUITE 200  
 CHICAGO, IL 60606  
 TEL (312) 939-1000  
 FAX (312) 939-4198

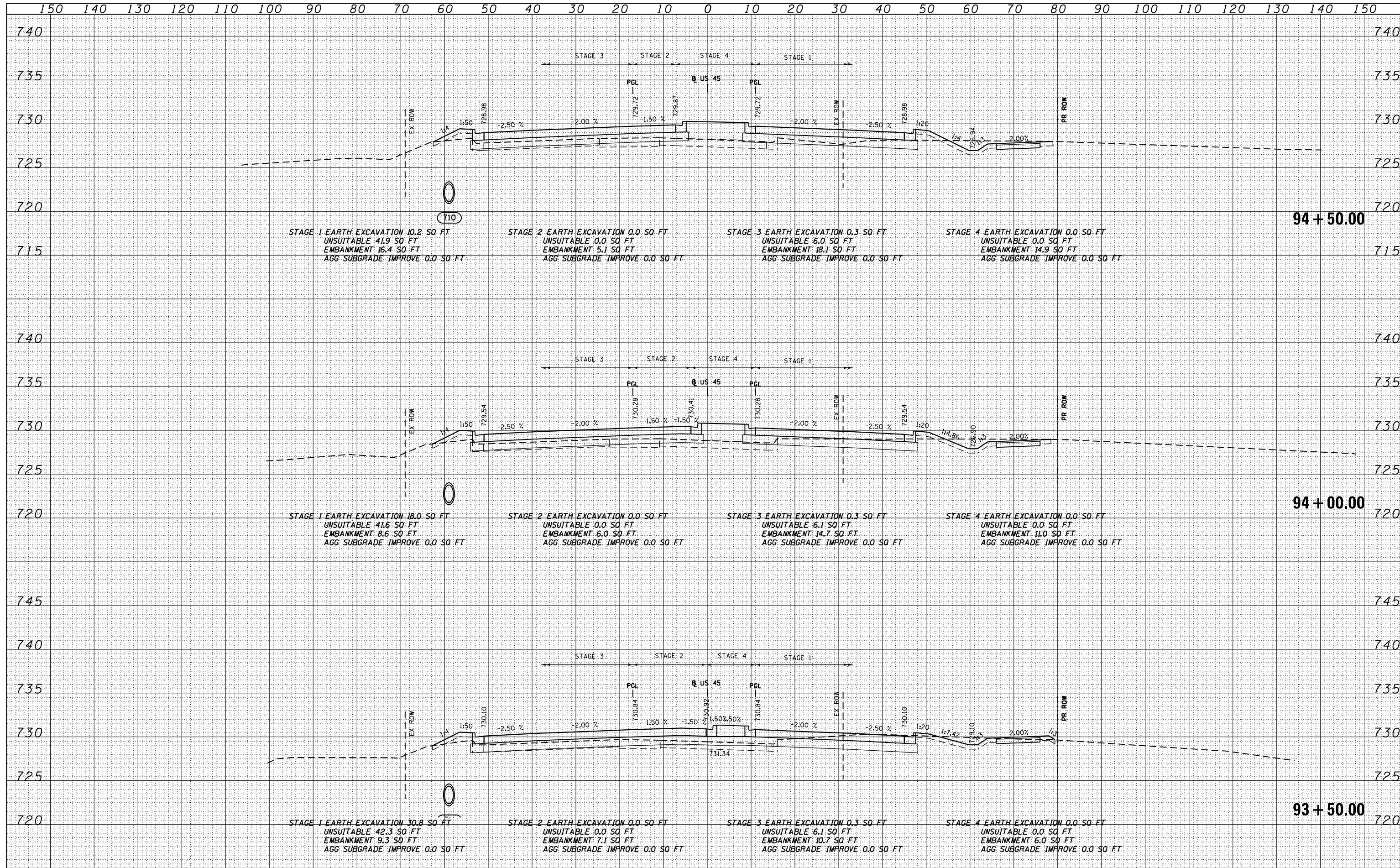

FILE NAME = D160F05-SHT-XSSHT01.dgn	USER NAME = Anthony.Plutz	DESIGNED - BFH	REVISD -	<b>STATE OF ILLINOIS</b> <b>DEPARTMENT OF TRANSPORTATION</b> <b>US 55 CROSS SECTIONS</b> SCALE: 1"=10'H 1"=5'V SHEET NO. 75 OF 147 SHEETS STA. 93+50.00 TO STA. 94+50.00	F.A.P. RFE. 330	SECTION 103R-3	COUNTY COOK	TOTAL SHEETS 932	SHEET NO. 812
PLOT SCALE = 20.0000" / in.	CHECKED - EJG	REVISD -	CONTRACT NO. 60F05						
PLOT DATE = 3/9/2013	DATE - 03/13/13	REVISD -	ILLINOIS FED. AID PROJECT						