

LEGEND:

	MEDIAN REMOVAL		DRIVEWAY PAVEMENT REMOVAL		TREE REMOVAL
	PAVEMENT REMOVAL		SIDEWALK REMOVAL		CURB AND GUTTER REMOVAL

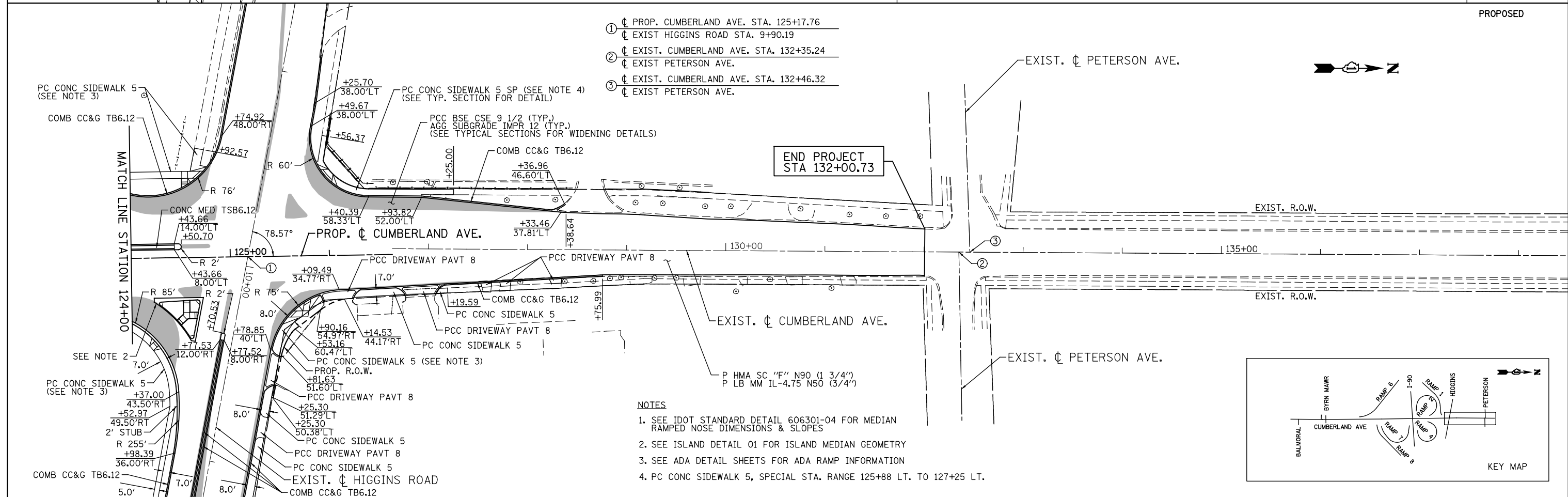

- 1. CL PROP. CUMBERLAND AVE. STA. 125+17.76
- 2. CL EXIST. HIGGINS ROAD STA. 9+90.19
- 3. CL EXIST. CUMBERLAND AVE. STA. 132+35.24
- 4. CL EXIST. PETERSON AVE.

- NOTES**
1. SEE IDOT STANDARD DETAIL 606301-04 FOR MEDIAN RAMPED NOSE DIMENSIONS & SLOPES
 2. SEE ISLAND DETAIL 01 FOR ISLAND MEDIAN GEOMETRY
 3. SEE ADA DETAIL SHEETS FOR ADA RAMP INFORMATION
 4. PC CONC SIDEWALK 5, SPECIAL STA. RANGE 125+88 LT. TO 127+25 LT.

PATRICK ENGINEERING INC.
4970 VARSITY DRIVE
LISLE, IL 60532
patrickengineering.com

USER NAME = tkceppen@rdwy.lisle
PLOT CONFIG = PDF(Grey_Small).plt
PLOT SCALE = 1:1000
PLOT DATE = 2/18/2013 4:50:25 PM

DESIGNED - CPK
DRAWN - MJP
CHECKED - JAH
DATE - 2/18/2013

REVISED -
REVISED -
REVISED -
REVISED -

**STATE OF ILLINOIS
DEPARTMENT OF TRANSPORTATION**

**ROADWAY PLAN
CUMBERLAND AVENUE**

SCALE: 1"=50' SHEET PP-04 OF 9 STA. 124+00 TO STA. 132+00.73

F.A.U. RTE.	SECTION	COUNTY	TOTAL SHEETS	SHEET NO.
274E	1616B	COOK	404	55
FED. ROAD DIST. NO. ILLINOIS FED. AID PROJECT			60J14	

G:\IDOT\21050_006_CumberlandAve\Drawings\CADD Sheets\160J14-sht-plan_02.dgn