

ADVANCE SIGNING DETAIL:

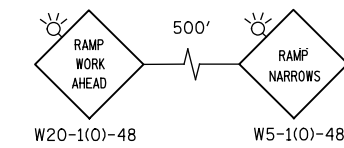

NOTE:
PLACE FOLLOWING SIGN AT START OF RAMP ON I-90 EASTBOUND MAINLINE.

**RAMP TO
IL 171 SOUTH
MAX WIDTH
10'-6"**

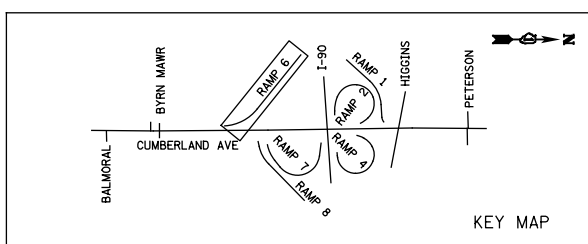

LEGEND

- WORK AREA
- TEMPORARY PAVEMENT
- PROP. BASE COURSE WIDENING WITH 2 1/2" OF TEMPORARY PAVEMENT
- TYPE II BARRICADES OR DRUMS WITH STEADY BURNING LIGHTS @ 50 FT CENTERS ALONG ROADWAY (TANGENTS), 25 FT CENTERS MONO-DIRECTIONAL ALONG TAPERS, AND 12 FT CENTERS ALONG RADIAL
- IMP ATTN TEMP FRN TL3
- TEMPORARY CONCRETE BARRIER
- DIRECTION OF TRAFFIC
- VERTICAL PANEL WITH STEADY BURNING LIGHT 50 FT C-C
- TYPE III BARRICADES WITH FLASHING LIGHTS

<p>PATRICK ENGINEERING INC. 4970 VARSITY DRIVE LISLE, IL 60532 patrickengineering.com</p>	USER NAME = tkceppen(Rdwy_Lisle)	DESIGNED - CPK	REVISED -
	PLOT CONFIG = PDF(Grey_Small).plt	DRAWN - CPK	REVISED -
	PLOT SCALE = 1:1000	CHECKED - JAH	REVISED -
	PLOT DATE = 2/18/2013 7:10:53 PM	DATE - 2/18/2013	REVISED -

**STATE OF ILLINOIS
DEPARTMENT OF TRANSPORTATION**

**SUGGESTED STAGES OF CONSTRUCTION & TRAFFIC CONTROL
STAGE 2 FOR I-90 RAMP 6**

SCALE: 1"=50' SHEET MOT-28 OF 42 STA. TO STA.

F.A.U. RTE.	SECTION	COUNTY	TOTAL SHEETS	SHEET NO.
2746	1616B	COOK	404	88
				60J14

FED. ROAD DIST. NO. ILLINOIS FED. AID PROJECT

G:\DOT\21050_006.CumberlandAve\Drawings\CADD Sheets\160J14-1st-staging_02.07_ramp6.dgn