

MATCHLINE STA. 112+17  
SEE SHEET TS-42B

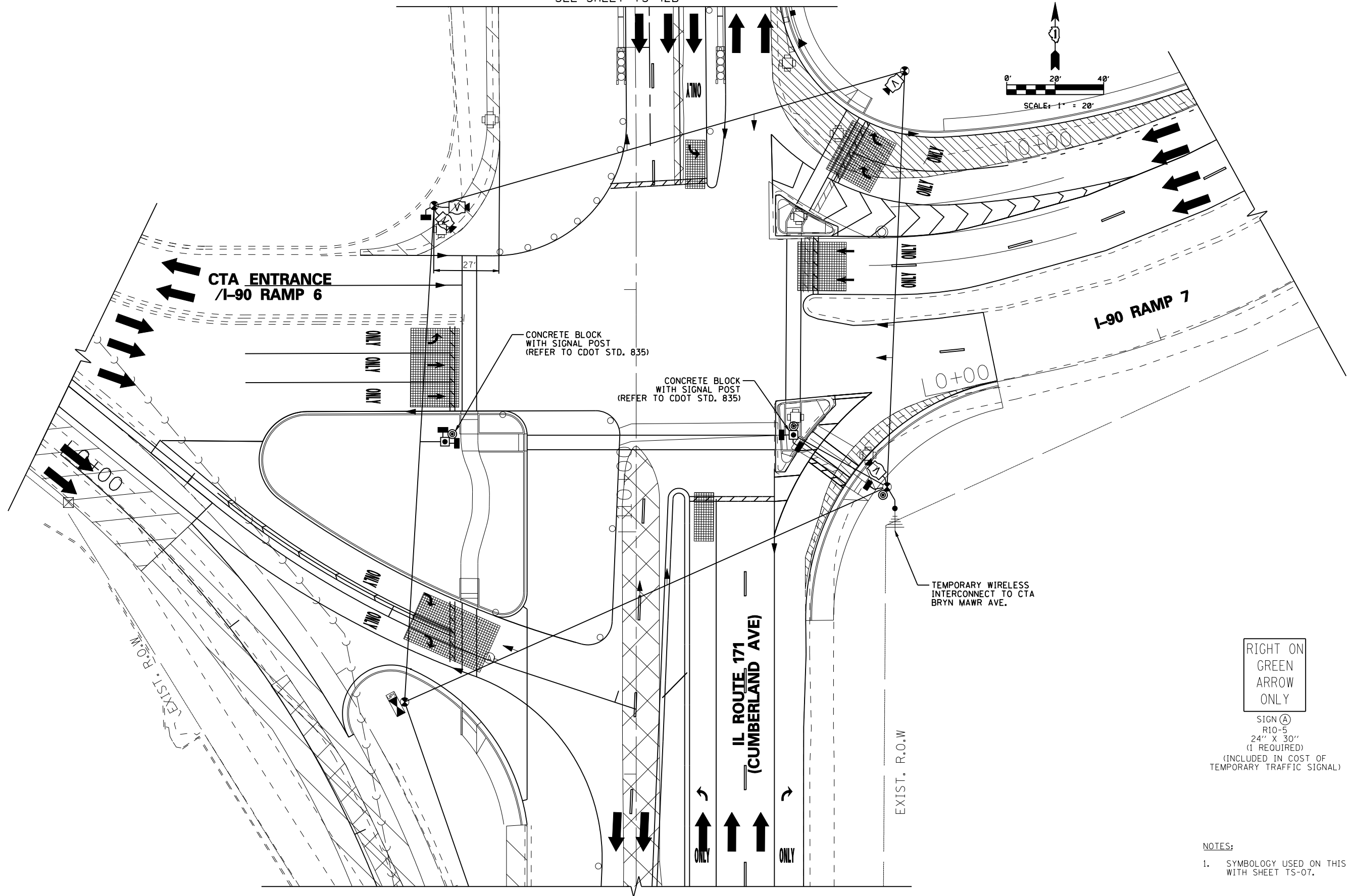
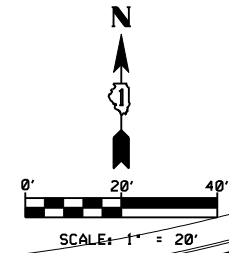

RIGHT ON  
GREEN  
ARROW  
ONLY

SIGN (A)  
R10-5  
24" X 30"  
(1 REQUIRED)  
(INCLUDED IN COST OF  
TEMPORARY TRAFFIC SIGNAL)

NOTES:

1. SYMBOLOGY USED ON THIS SHEET IS IN ACCORDANCE WITH SHEET TS-07.

2/18/2013 1:59:59 PM ...sheet\DI60J14-sht-ts\_46.dgn

USER NAME =	DESIGNED - GR	REVISED -
	DRAWN - GR	REVISED -
PLOT SCALE =	CHECKED - CG	REVISED -
PLOT DATE =	DATE - 2/18/2013	REVISED -



STATE OF ILLINOIS  
DEPARTMENT OF TRANSPORTATION

TEMPORARY TRAFFIC SIGNAL INSTALLATION (STAGE 2)  
IL RTE 171 (CUMBERLAND AVENUE) AT CTA ENTRANCE-I-90 RAMPS

F.A.U. RTE.	SECTION	COUNTY	TOTAL SHEETS	SHEET NO.
2746	1616B	COOK	404	213
CONTRACT NO. 60J14				
ILLINOIS FED. AID PROJECT				

TS-54