

s:\projects\3009 1-90_cumberland-patrick\project work\disciplines\electrical\sheet\DI60J14-sht-light-29.dgn

2/18/2013 2:43:40 PM

2/18/2013

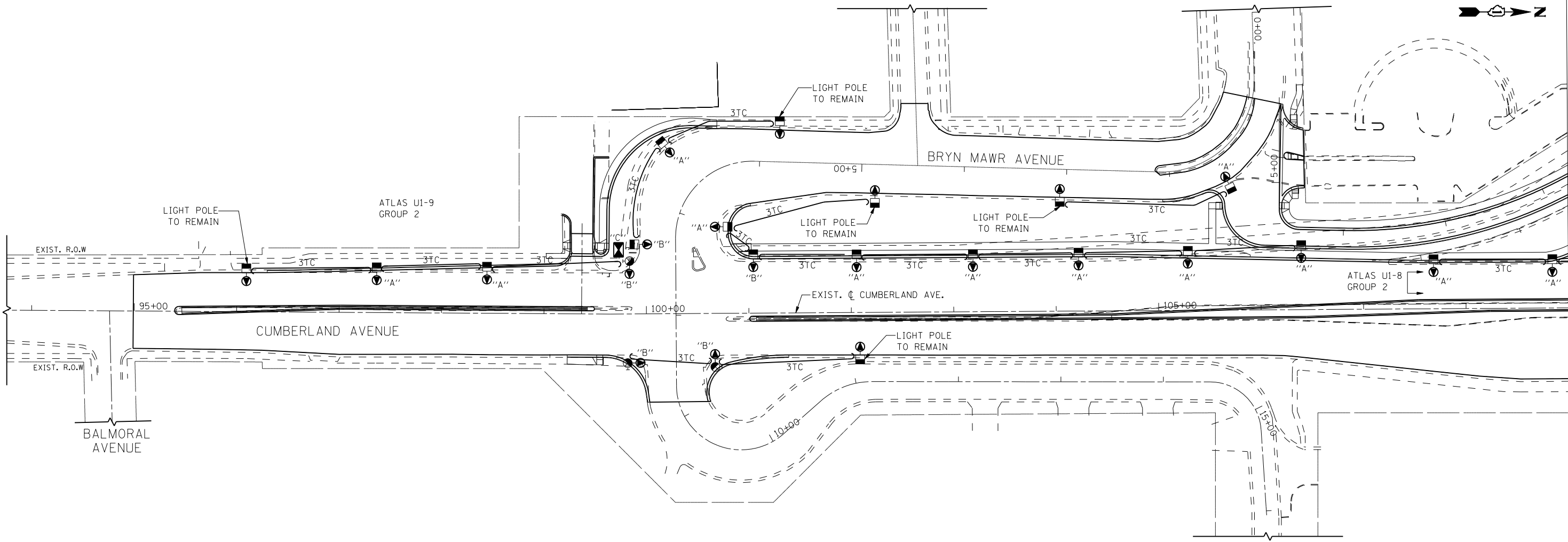

MATCH LINE STATION 109+00
SEE SHEET LT-30

KEY

- "A"- REMOVE EXISTING CITY OF CHICAGO LIGHT POLE AND LUMINAIRE FOR RELOCATION TO NEW FOUNDATION. REMOVE EXISTING POLE FOUNDATION.
- "B"- REMOVE EXISTING CITY OF CHICAGO MAST ARM AND LUMINAIRE FROM COMBINATION TRAFFIC POLE FOR RELOCATION TO NEW COMBINATION TRAFFIC POLE.
- "C"- REMOVE EXISTING CITY OF CHICAGO LIGHTING CONTROLLER FOR RELOCATION TO NEW FOUNDATION. REMOVE EXISTING CONTROLLER FOUNDATION.

NOTES:

1. SEE PROPOSED LIGHTING PLANS FOR NEW LOCATIONS OF LIGHT POLES AND CONTROLLERS TO BE RELOCATED.
2. THE CONTRACTOR MUST PROVIDE ANY TEMPORARY WIRING REQUIRED TO MAINTAIN OPERATION OF THE LIGHTING SYSTEM DURING REMOVAL AND RELOCATION OPERATIONS. THE COST OF THIS WORK IS INCLUDED IN THE PRICE OF THE ITEM "MAINTENANCE OF STREET LIGHTING SYSTEM (CITY OF CHICAGO)."



USER NAME =	DESIGNED - RAS	REVISED -
	DRAWN - RAS	REVISED -
PLOT SCALE =	CHECKED - MKR	REVISED -
PLOT DATE =	DATE - 2/18/2013	REVISED -



**STATE OF ILLINOIS
DEPARTMENT OF TRANSPORTATION**

**CDOT ROADWAY LIGHTING REMOVAL PLAN
CUMBERLAND AVENUE**

SCALE: 1" = 50' SHEET NO. 1 OF 3 SHEETS STA. 93+76 TO STA. 109+00

F.A.U. RTE.	SECTION	COUNTY	TOTAL SHEETS	SHEET NO.
2746	1616B	COOK	404	261
CONTRACT NO. 60J14				
ILLINOIS FED. AID PROJECT				

LT-29