

NOTES:

1. ALL CONDUIT TO BE PVC SCHEDULE 40, UNLESS NOTED OTHERWISE. SIZE AS NOTED.
2. ALL LIGHT POLE FOUNDATIONS SHALL BE INSTALLED MINIMUM 3 FT FROM THE FACE OF CURB.
3. REFER TO DOE0 STANDARD DRAWING 826 FOR SYMBOLS.
4. THE CONTRACTOR SHALL MAKE HIS OWN INVESTIGATION TO DETERMINE THE EXACT LOCATION OF ALL UTILITY LINES AND APPURTENANCES WITHIN THE LIMITS OF THIS IMPROVEMENT. THE COST OF THIS WORK WILL BE CONSIDERED INCIDENTAL TO THE CONTRACT.
5. REFER TO CUMBERLAND AVE AND BRYN MAWR AVE TRAFFIC SIGNAL PLAN FOR CONDUIT, HANDHOLE AND COMBINATION STREET LIGHT & TRAFFIC SIGNAL POLE LOCATIONS.

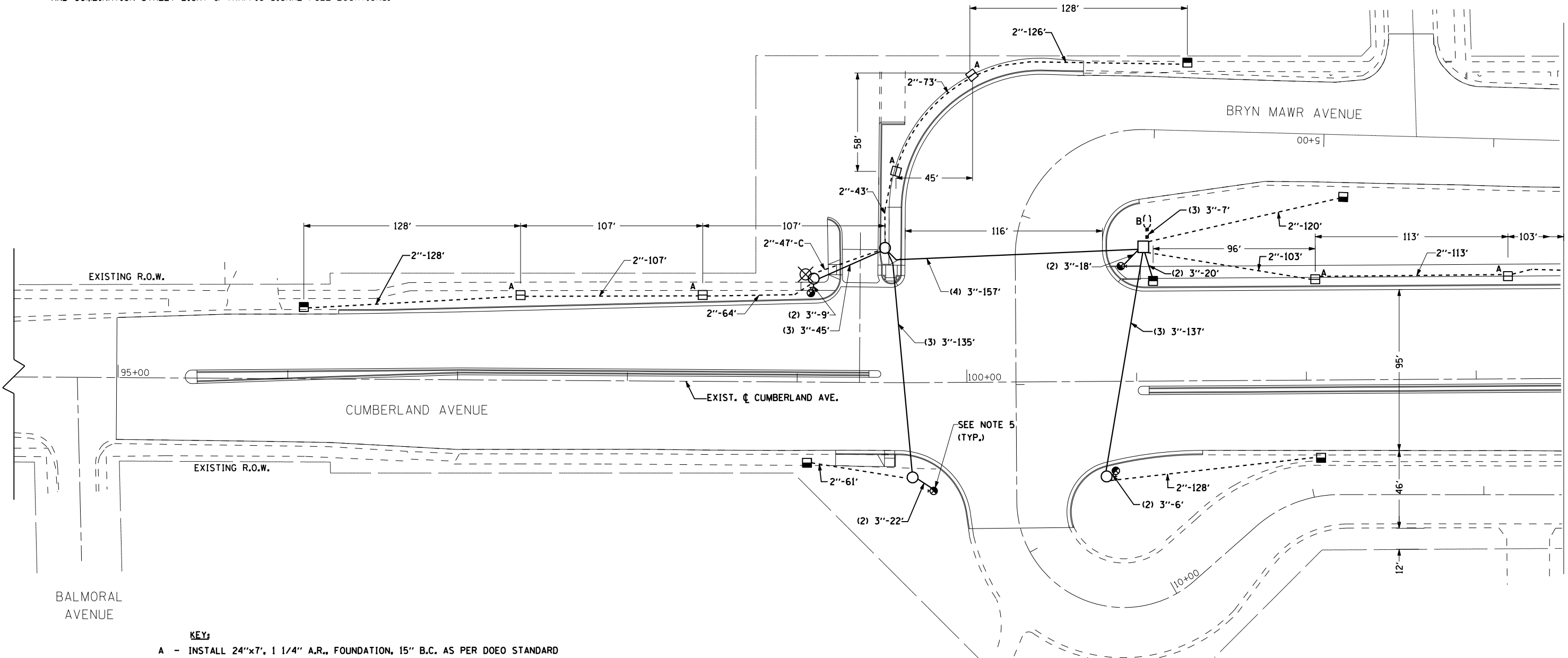

s:\projects\3009_1-90_cumberland-patrick\project_work\disciplines\electrical\sheet\DI60J14-sht-light-32.dgn
2/18/2013 2:43:44 PM



KEY:

- A - INSTALL 24"x7", 1 1/4" A.R., FOUNDATION, 15" B.C. AS PER DOE0 STANDARD DRAWING NO. 818 (RELOCATED LIGHT POLE FOUNDATION)
- B - INSTALL CONCRETE FOUNDATION FOR STREET LIGHT CONTROLLER AS PER DOE0 STANDARD DRAWING NO. 709
- C - INSTALL 2" GALVANIZED STEEL CONDUIT

MATCH LINE STATION 103+50
SEE SHEET LT-33

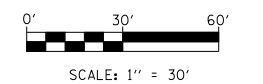

USER NAME =	DESIGNED - RAS	REVISED -
PLOT SCALE =	DRAWN - RAS	REVISED -
PLOT DATE =	CHECKED - MKR	REVISED -
	DATE - 2/18/2013	REVISED -



**STATE OF ILLINOIS
DEPARTMENT OF TRANSPORTATION**

**CDOT ROADWAY LIGHTING FOUNDATION AND
UNDERGROUND FACILITIES PLAN
CUMBERLAND AVENUE**

SCALE: 1" = 30' SHEET NO. 1 OF 3 SHEETS STA. 94+38 TO STA. 103+50

F.A.U. RTE.	SECTION	COUNTY	TOTAL SHEETS	SHEET NO.
2746	1616B	COOK	404	264
CONTRACT NO. 60J14				
ILLINOIS FED. AID PROJECT				

LT-32