

Notes:  
See sheet S23 of S59 for Sections C-C & D-D.  
a10(E), and a11(E) bar spacings measured along  
⊕ Rdwy.

**PLAN**

- \* Tilt #9 b11(E) bars as required to maintain clearance.
- \*\* 46-#5 a11(E) bars at 8" cts bottom of slab,  
25x2-#4 a10(E) bars at 15" cts. top of slab.
- \*\*\*\* 25-#4 a8(E) Bars at 15" cts. top of slab,  
and 46-#5 a9(E) bars at 8" cts. bottom of slab.

**MIN. BAR LAP**

#4 bar = 1'-10"  
#5 bar = 2'-0"

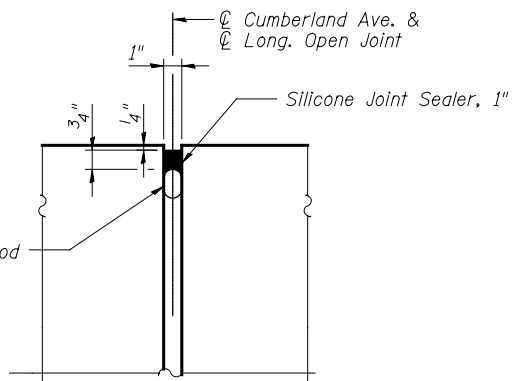

**LONGITUDINAL OPEN JOINT DETAIL**

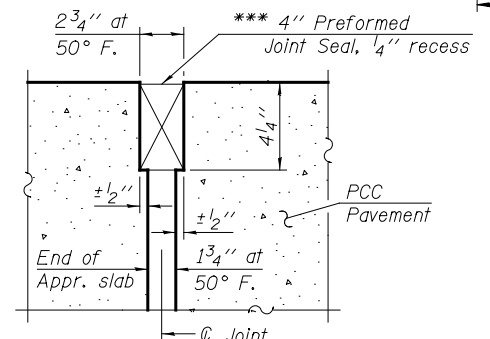

**DETAIL A**

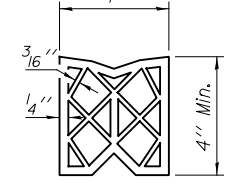

**PREFORMED JOINT SEAL**

\*\*\* Cost included with Concrete Superstructure.

PATRICK ENGINEERING INC.  
4970 VARSITY DRIVE  
LISLE, IL 60532  
patrickengineering.com

USER NAME =	DESIGNED - AD	REVISED
PLOT SCALE =	DRAWN - AD	REVISED
PLOT DATE =	CHECKED - RLD	REVISED
	DATE - 2/18/2013	REVISED

STATE OF ILLINOIS	BRIDGE APPROACH SLAB
DEPARTMENT OF TRANSPORTATION	STRUCTURE NO. 016-1250

F.A.U. RTE.	SECTION	COUNTY	TOTAL SHEETS	SHEET NO.
2746	1616B	COOK	404	291
CONTRACT NO. 60J14				

SCALE: NONE	SHEET NO. S22 OF S59	SHEETS
-------------	----------------------	--------

ILLINOIS FED. AID PROJECT				
---------------------------	--	--	--	--