

**EXISTING CONDITIONS**

- (A) HOT-MIX ASPHALT SURFACE AND BINDER COURSE, 3 1/4"
- (B) PCC PAVEMENT, 10"
- (C) COMBINATION CONCRETE CURB AND GUTTER
- (D) AGGREGATE SHOULDERS
- (E) MOUNTABLE CONCRETE MEDIAN, CORRUGATED
- (F) PORTLAND CEMENT CONCRETE PAVEMENT, 9"

**PROPOSED IMPROVEMENTS**

- (1) HOT-MIX ASPHALT SURFACE REMOVAL, 2 1/4"
- (2) HOT-MIX ASPHALT SURFACE COURSE, MIX "D", N70, 1 1/2"
- (3) POLYMERIZED LEVELING BINDER (MACHINE METHOD), IL-4.75, N50, 3/4"
- (4) COMBINATION CURB & GUTTER REMOVAL AND REPLACEMENT (AT LOCATIONS AS DETERMINED BY THE ENGINEER)
- (5) AGGREGATE WEDGE SHOULDER, TYPE B (TAPER 3" TO 1" THICKNESS)
- (6) EXISTING HOT-MIX ASPHALT SURFACE AFTER PROPOSED SURFACE REMOVAL

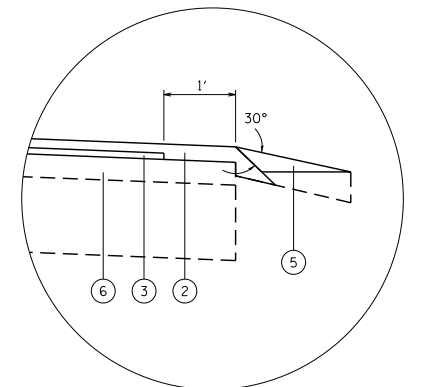
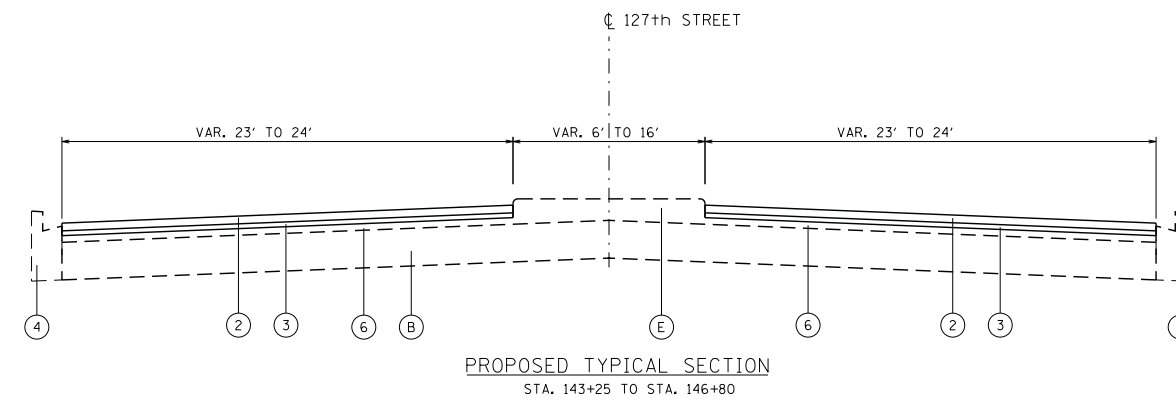
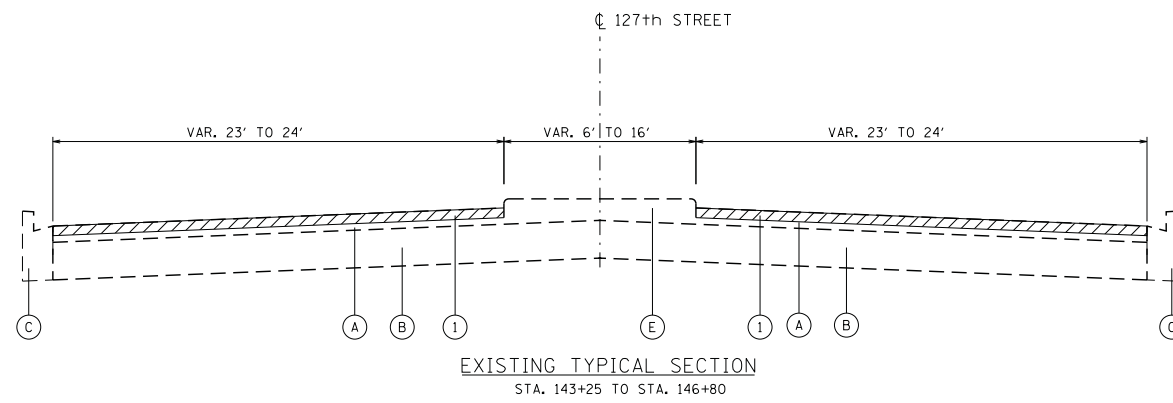

**RESURFACING TREATMENT AT SHOULDER AND SAFETY EDGE DETAILS**  
N.T.S.

NOTE: INCREASED THICKNESS OF HMA SURFACE COURSE ALONG SHOULDER EDGE SHALL BE INCLUDED IN THE COST OF HOT-MIX ASPHALT SURFACE COURSE, MIX "D", N70

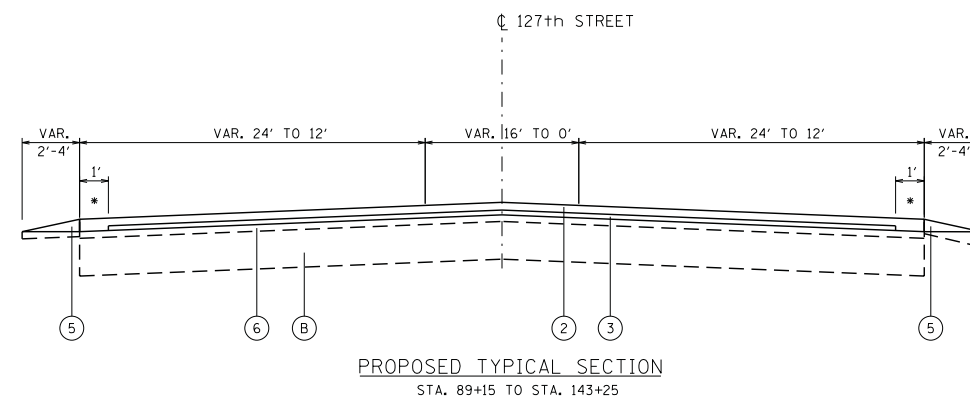
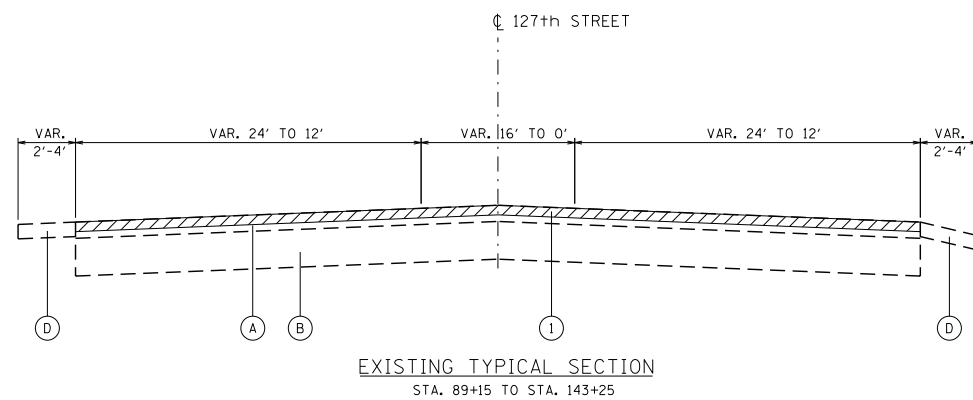

NOTE: THE CONTRACTOR SHALL PATCH FIRST BEFORE MILLING. SEE DISTRICT 1 DETAIL PAVEMENT PATCHING FOR HMA SURFACED PAVEMENT.

**HOT-MIX ASPHALT MIXTURE REQUIREMENTS**

MIXTURE TYPE	AIR VOIDS (%) @ Ndes
<b>PAVEMENT RESURFACING</b>	
HOT-MIX ASPHALT SURFACE COURSE, MIX "D", N70 (IL-9.5mm)	4% @ 70 GYR.
POLYMERIZED LEVELING BINDER (MACHINE METHOD), IL-4.75, N50	3.5% @ 50 GYR.
<b>PATCHING</b>	
CLASS D PATCHES (HMA BINDER, IL-19mm)	4% @ 70 GYR.
HMA REPLACEMENT OVER PATCHES (HMA BINDER IL-19mm)	4% @ 70 GYR.
<b>DRIVEWAYS</b>	
HMA SURFACE COURSE, MIX "D", N 50 (IL 9.5 mm); 2"	4% @ 50 GYR.
HMA BASE COURSE (HMA BINDER IL-19mm); PE -6"	4% @ 50 GYR.

THE UNIT WEIGHT TO CALCULATE ALL HMA SURFACE MIXTURE QUANTITIES IS 112 LBS/SQ YD/1IN

THE "AC TYPE" FOR POLYMERIZED HMA MIXES SHALL BE "SBS/SBR PG 76-22" AND FOR NON-POLYMERIZED HMA THE "AC TYPE" SHALL BE "PG 64 -22" UNLESS MODIFIED BY DISTRICT ONE SPECIAL PROVISIONS.

FOR USE OF RECYCLED MATERIALS SPECIAL PROVISIONS.

COMPANY NAME: HRGreen  
PROJECT CONTACT: HRGreen.com  
DATE PLOTTED: 2/8/2013 14:55:53 AM  
FILE NAME: 86100196.01-1yp-01.dgn  
PLOT DRIVER: pdfplot  
PEN TABLE: standard-trans.tbl



USER NAME = spenel	DESIGNED - CMH	REVISED -
	DRAWN - SMP	REVISED -
PLOT SCALE = N.T.S.	CHECKED - TEH	REVISED -
PLOT DATE = 2/8/2013	DATE - 2/8/13	REVISED -

**STATE OF ILLINOIS  
DEPARTMENT OF TRANSPORTATION**

**TYPICAL SECTIONS  
127TH STREET (RIDGELAND AVE. TO IL RTE. 83)**

SCALE: N.T.S. SHEET NO. 1 OF 1 SHEETS STA. BEGIN TO STA. END

F.A. RTE.	SECTION	COUNTY	TOTAL SHEETS	SHEET NO.
1587	3034-RS-S	COOK	48	9
CONTRACT NO.			60L82	
FED. ROAD DIST. NO.		ILLINOIS FED. AID PROJECT		