

**REMOVAL LEGEND**

- |  |                                 |  |   |
|--|---------------------------------|--|---|
|  | PAVEMENT REMOVAL                |  | TREE REMOVAL (ACRES)  |
|  | HOT MIX ASPHALT SURFACE REMOVAL |  | SELECTIVE CLEARING (S.F.)   |
|  | PAVED SHOULDER REMOVAL          |  | TREE REMOVAL (UNIT DIAMETER)  |
|  | MEDIAN OR ISLAND REMOVAL        |  | TREE PROTECTION (UNIT DIAMETER) - TEMPORARY FENCE AND TREE ROOT PRUNING |
|  | DRIVEWAY PAVEMENT REMOVAL       |  | REMOVE SIGN PANEL ASSEMBLY - (TYPE SPECIFIED)                           |
|  | SIDEWALK REMOVAL                |  | MAIL BOX REMOVAL AND RELOCATION (NOT PAID SEPARATELY)                   |
|  | PARKING LOT PAVEMENT REMOVAL    |  |   |

**NOTES:**

1. THE CONTRACTOR SHALL CONTACT THE ROADSIDE DEVELOPMENT UNIT IN THE BUREAU OF MAINTENANCE AT (847) 705-4171 AT LEAST 72 HOURS IN ADVANCE OF SELECTIVE CLEARING WORK TO ASSIST WITH MARKING OF TREES TO BE SAVED.
2. TEMPORARY FENCE USED IN TREE PROTECTION SHALL BE LOCATED A MINIMUM OF 1 FOOT OUTSIDE THE DRIPLINE OF THE TREE TO BE PROTECTED AND IN NO CASE CLOSER THAN 5 FEET TO THE TRUNK OF ANY TREE.
3. IN AREAS OF SELECTIVE CLEARING, MULCH METHOD 2 (ACRES) AND WEED CONTROL, PRE-EMERGENT GRANULAR HERBICIDE (ACRES) IS TO BE APPLIED.
4. SEE EROSION CONTROL PLANS FOR TEMPORARY FENCE LIMITS AND "NO INTRUSION" SIGNING LOCATIONS.

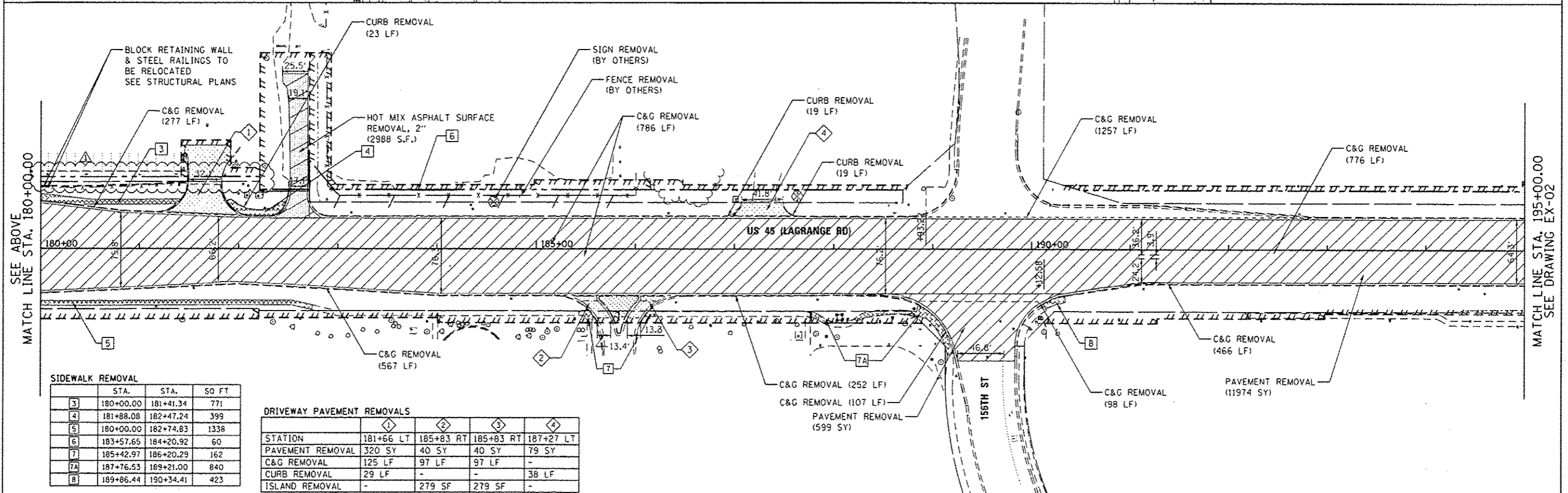
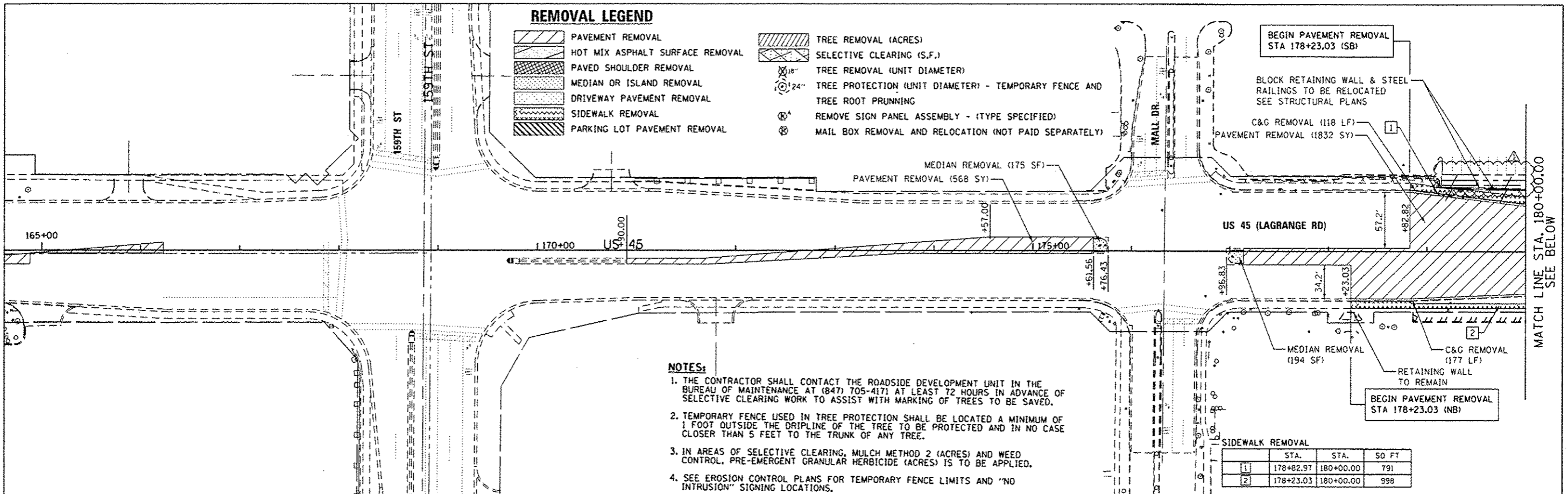

URS  
RD S. WACKER DR.  
SUITE 500  
CHICAGO, IL 60606  
TEL (312) 999-0000  
FAX (312) 999-0098

|                                  |                        |                |                      |
|----------------------------------|------------------------|----------------|----------------------|
| FILE NAME = DIGM61-SHT-REM01.dgn | USER NAME = james.push | DESIGNED - BPH | REVISED - 04/12/2013 |
| PLOT SCALE = 1/8"=1'-0"          | PLOT DATE = 4/11/2013  | DRAWN - BPH    | REVISED -            |
| SHT. DOUBLE PLAN                 | DATE - 03/13/2013      | CHECKED - MJT  | REVISED -            |

STATE OF ILLINOIS  
DEPARTMENT OF TRANSPORTATION

EXISTING PLAN AND REMOVALS - US 45 (LAGRANGE ROAD)

SCALE: 1"=50' SHEET 1 OF 4 SHEETS STA. BEGIN TO STA. 195+00.00

|                           |                |                    |                  |              |
|---------------------------|----------------|--------------------|------------------|--------------|
| F.A.P. RTE. 330           | SECTION 103R-4 | COUNTY COOK        | TOTAL SHEETS 877 | SHEET NO. 45 |
| EX-01                     |                | CONTRACT NO. 60M61 |                  |              |
| ILLINOIS FED. AID PROJECT |                |                    |                  |              |