

DRIVEWAY PAVEMENT REMOVALS									
	71	72	73	74	75	76	77	78	79
STATION	176+16 LT	176+20 RT	176+50 RT	176+74 LT	177+42 RT	179+19 LT	179+23 RT	181+16 LT	181+28 RT
PAVEMENT REMOVAL	74 SY	28 SY	25 SY	50 SY	42 SY	93 SY	67 SY	52 SY	52 SY
C&G REMOVAL	-	-	-	-	-	50 LF	34 LF	-	36 LF
CURB REMOVAL	-	-	20 LF	41 LF	23 LF	12 LF	-	21 LF	-
ISLAND REMOVAL	-	-	-	-	-	-	-	-	-

SIDEWALK REMOVAL											
	STA.	STA.	SO FT		STA.	STA.	SO FT		STA.	STA.	SO FT
116	175+31.00	176+12.30	390	120	178+89.71	179+10.25	99				
117	176+26.93	176+42.64	80	121	179+35.17	181+14.77	880				
118	176+56.65	177+30.00	358	122	181+27.81	181+42.82	74				
119	177+53.46	177+59.91	31	123	181+40.08	181+55.12	75				

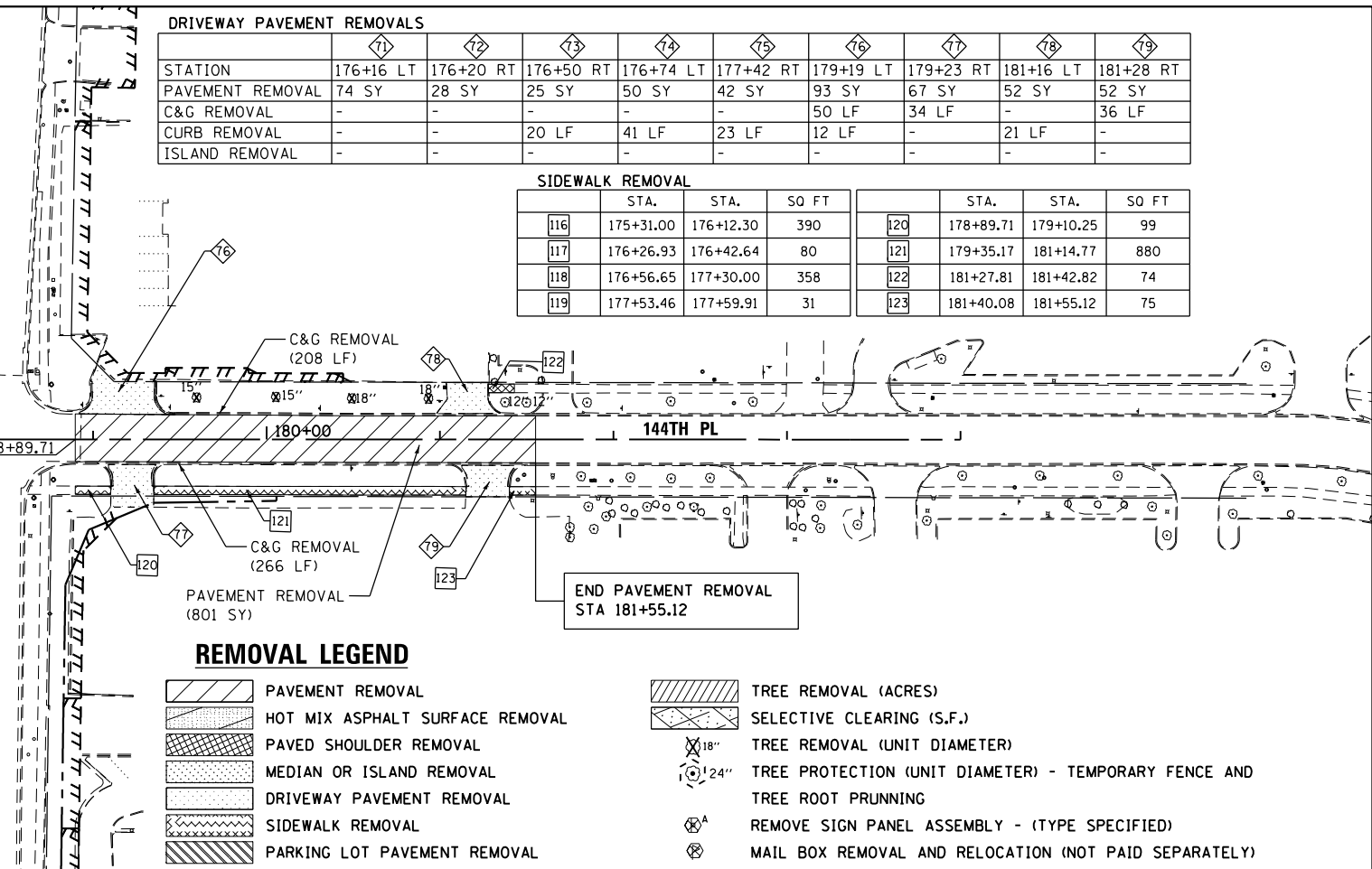
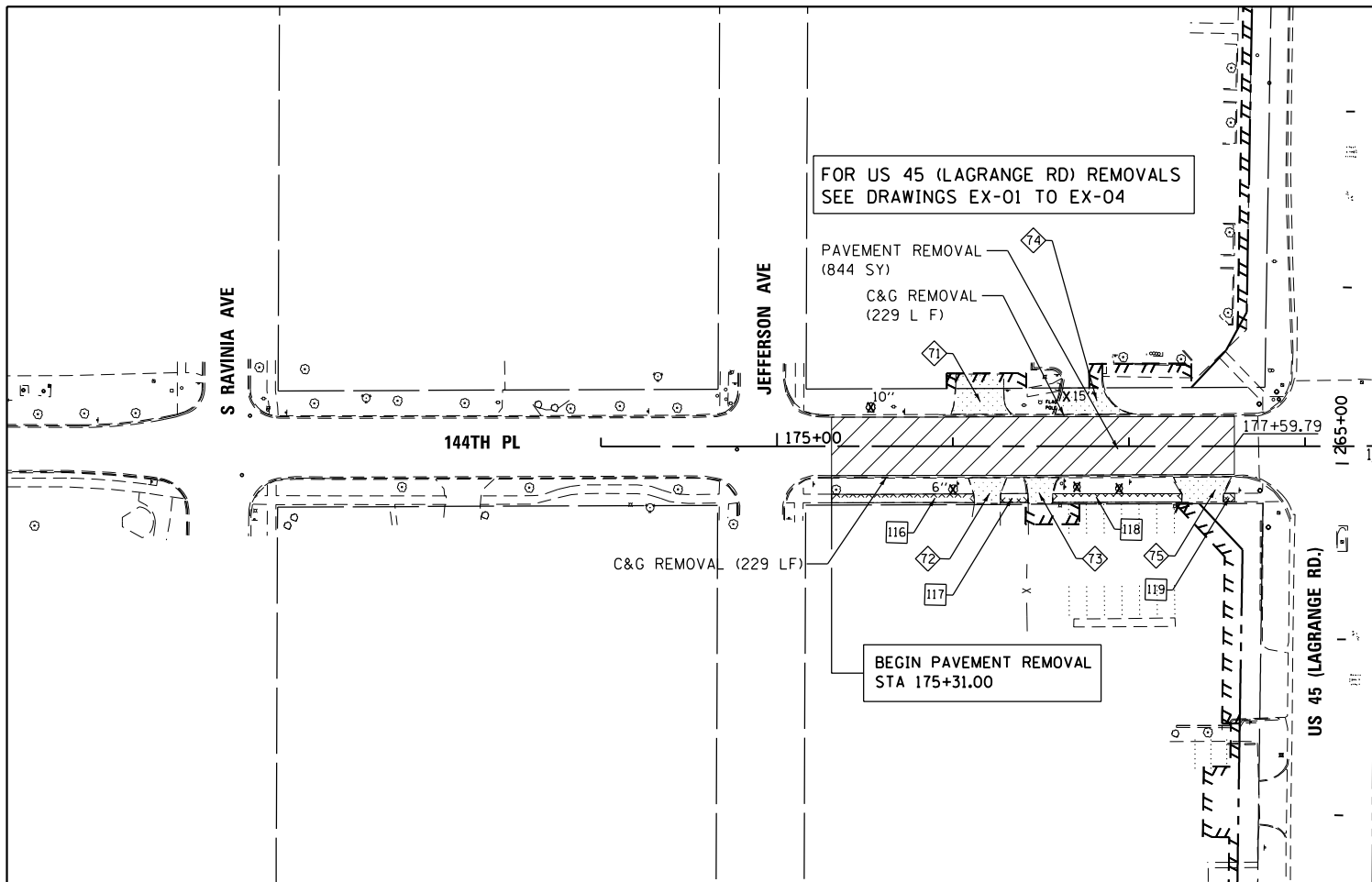

**REMOVAL LEGEND**

- PAVEMENT REMOVAL
- HOT MIX ASPHALT SURFACE REMOVAL
- PAVED SHOULDER REMOVAL
- MEDIAN OR ISLAND REMOVAL
- DRIVEWAY PAVEMENT REMOVAL
- SIDEWALK REMOVAL
- PARKING LOT PAVEMENT REMOVAL
- TREE REMOVAL (ACRES)
- SELECTIVE CLEARING (S.F.)
- TREE REMOVAL (UNIT DIAMETER)
- TREE PROTECTION (UNIT DIAMETER) - TEMPORARY FENCE AND TREE ROOT PRUNING
- REMOVE SIGN PANEL ASSEMBLY - (TYPE SPECIFIED)
- MAIL BOX REMOVAL AND RELOCATION (NOT PAID SEPARATELY)

**NOTES:**

1. THE CONTRACTOR SHALL CONTACT THE ROADSIDE DEVELOPMENT UNIT IN THE BUREAU OF MAINTENANCE AT (847) 705-4171 AT LEAST 72 HOURS IN ADVANCE OF SELECTIVE CLEARING WORK TO ASSIST WITH MARKING OF TREES TO BE SAVED.
2. TEMPORARY FENCE USED IN TREE PROTECTION SHALL BE LOCATED A MINIMUM OF 1 FOOT OUTSIDE THE DRIPLINE OF THE TREE TO BE PROTECTED AND IN NO CASE CLOSER THAN 5 FEET TO THE TRUNK OF ANY TREE.
3. IN AREAS OF SELECTIVE CLEARING, MULCH METHOD 2 (ACRES) AND WEED CONTROL, PRE-EMERGENT GRANULAR HERBICIDE (ACRES) IS TO BE APPLIED.
4. SEE EROSION CONTROL PLANS FOR TEMPORARY FENCE LIMITS AND "NO INTRUSION" SIGNING LOCATIONS.

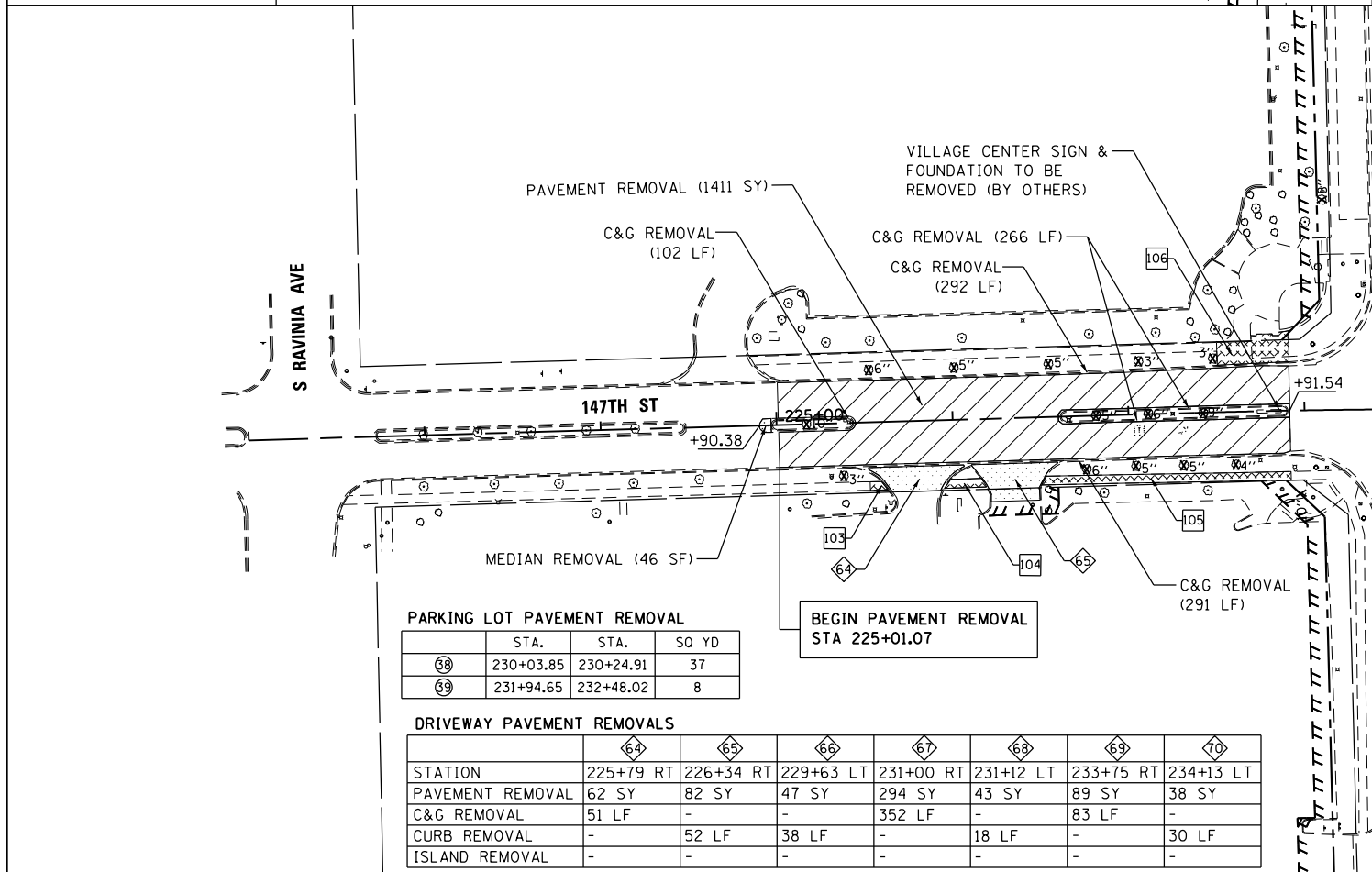

PARKING LOT PAVEMENT REMOVAL			
	STA.	STA.	SO YD
68	230+03.85	230+24.91	37
69	231+94.65	232+48.02	8

DRIVEWAY PAVEMENT REMOVALS									
	64	65	66	67	68	69	70		
STATION	225+79 RT	226+34 RT	229+63 LT	231+00 RT	231+12 LT	233+75 RT	234+13 LT		
PAVEMENT REMOVAL	62 SY	82 SY	47 SY	294 SY	43 SY	89 SY	38 SY		
C&G REMOVAL	51 LF	-	-	352 LF	-	83 LF	-		
CURB REMOVAL	-	52 LF	38 LF	-	18 LF	-	30 LF		
ISLAND REMOVAL	-	-	-	-	-	-	-		

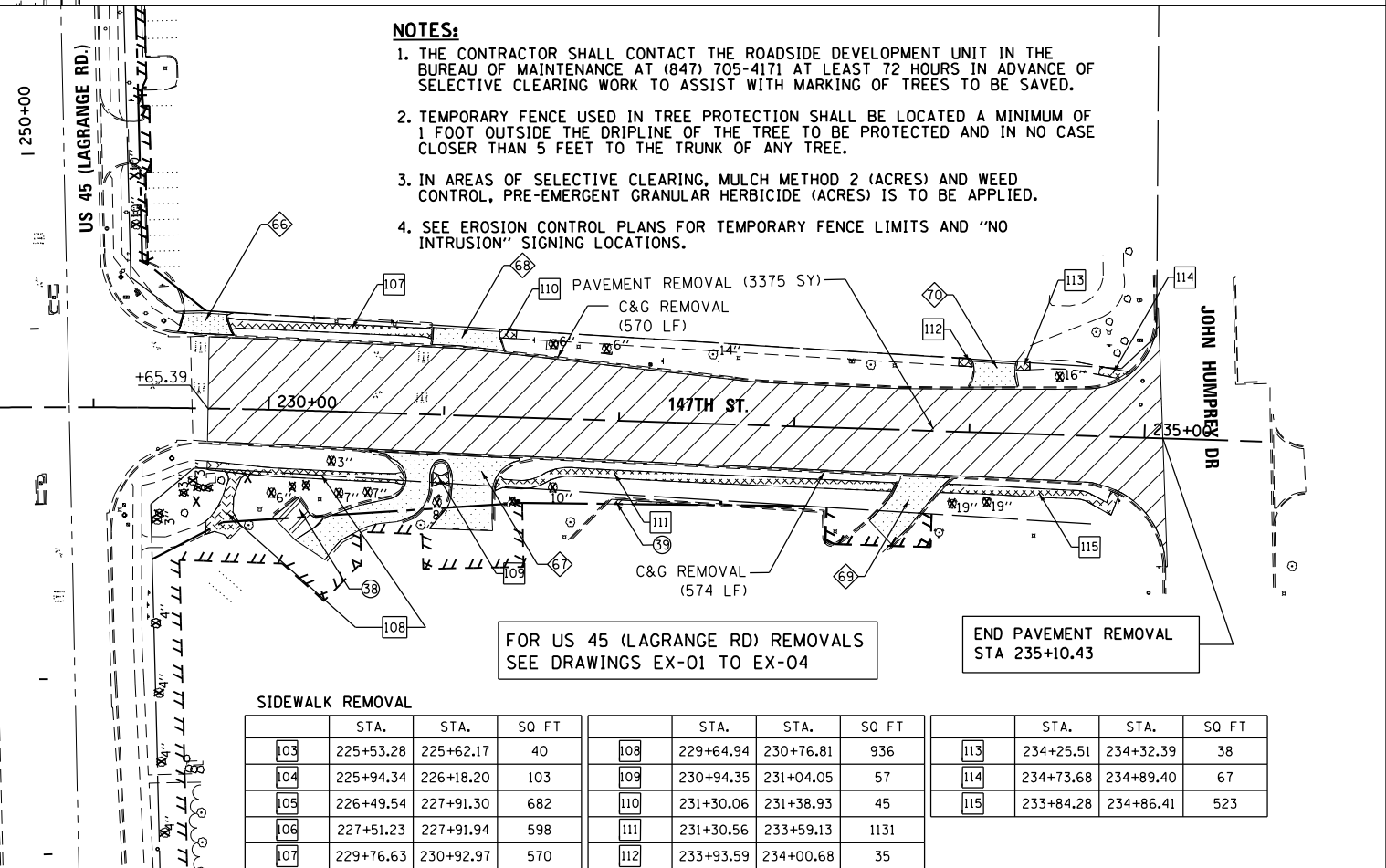

SIDEWALK REMOVAL											
	STA.	STA.	SO FT		STA.	STA.	SO FT		STA.	STA.	SO FT
103	225+53.28	225+62.17	40	108	229+64.94	230+76.81	936				
104	225+94.34	226+18.20	103	109	230+94.35	231+04.05	57				
105	226+49.54	227+91.30	682	110	231+30.06	231+38.93	45				
106	227+51.23	227+91.94	598	111	231+30.56	233+59.13	1131				
107	229+76.63	230+92.97	570	112	233+93.59	234+00.68	35				

	STA.	STA.	SO FT		STA.	STA.	SO FT		STA.	STA.	SO FT
113	234+25.51	234+32.39	38								
114	234+73.68	234+89.40	67								
115	233+84.28	234+86.41	523								

100 S. WACKER DR.  
SUITE 600  
CHICAGO, IL 60606  
TEL (312) 939-1000  
FAX (312) 939-4998

**URS**

FILE NAME = D160M61-SHT-REM07.dgn	USER NAME = Anthony.Plutz	DESIGNED - BFH	REVISED -
PLOT SCALE = 1/8" = 1'-0"	CHECKED - MJT	DRAWN - BFH	REVISED -
PLOT DATE = 3/14/2013	DATE - 03/13/2013		REVISED -

**STATE OF ILLINOIS  
DEPARTMENT OF TRANSPORTATION**

**EXISTING PLAN AND REMOVALS - 147TH STREET AND 144TH PLACE**

SCALE: 1"=50' SHEET 1 OF 1 SHEETS STA. BEGIN TO STA. END

F.A.P. R.E. 330	SECTION 103R-4	COUNTY COOK	TOTAL SHEETS 877	SHEET NO. 51
<b>EX-07</b>		CONTRACT NO. 60M61		
ILLINOIS FED. AID PROJECT				