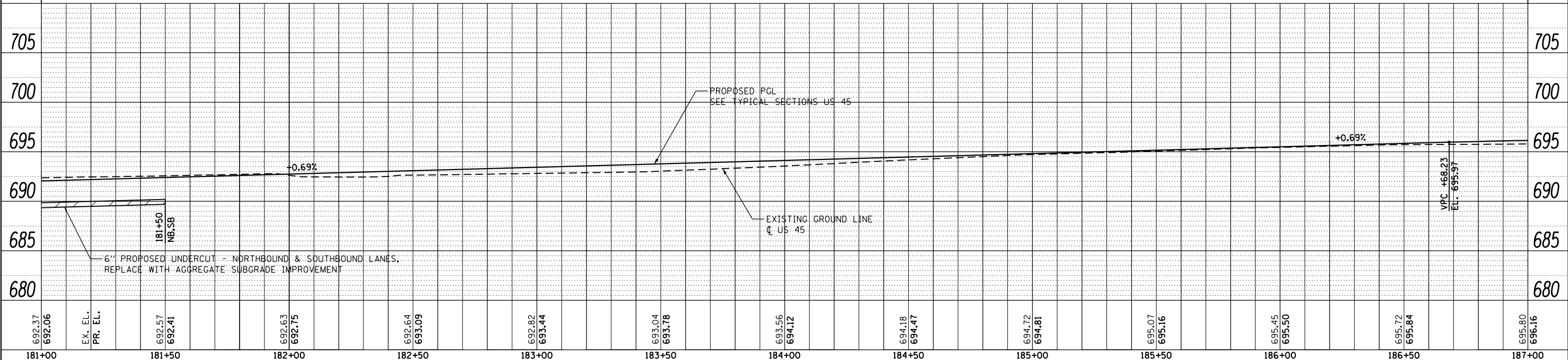
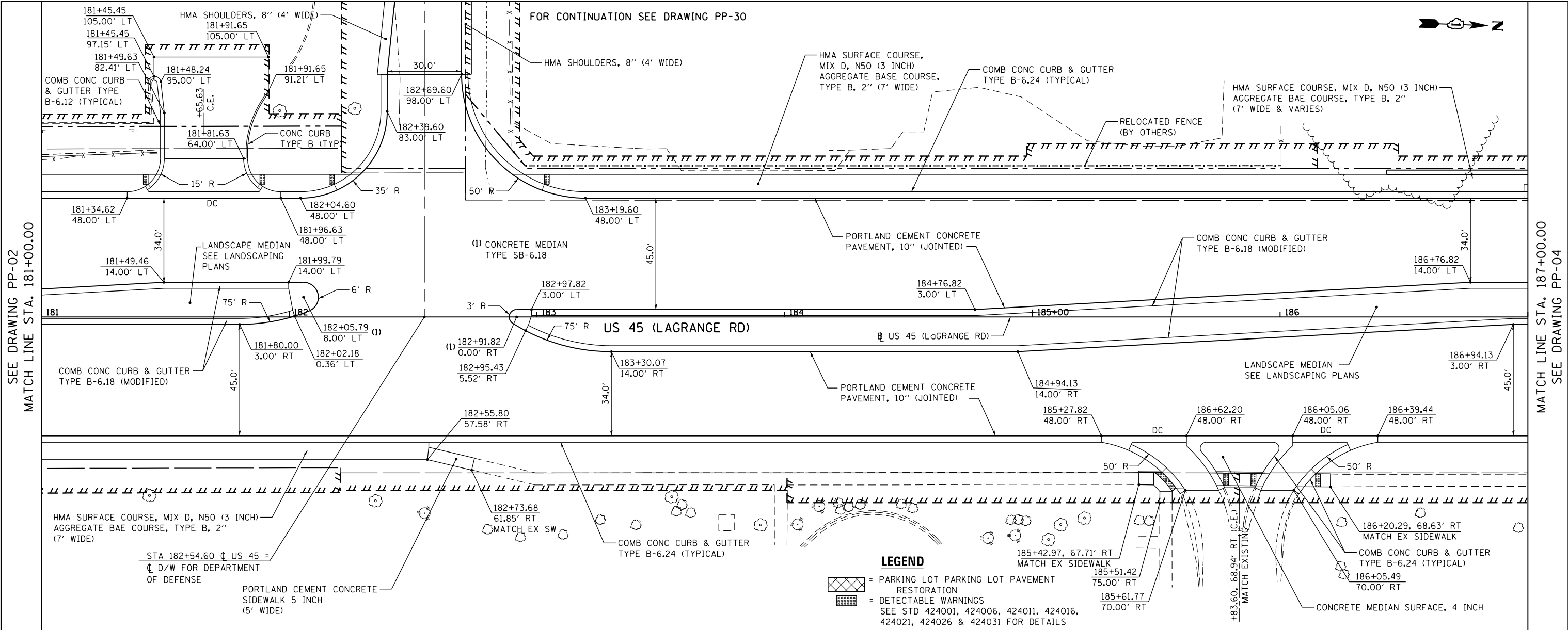

DATE	BY	PLANNED
		DESIGNED
		DRAWN
		CHECKED
		IN CHARGE
		NO. /

DATE	BY	PROF. FILE
		GRADES CHECKED
		STRUCTURE NOTATIONS CHECKED
		NO. /

100 S. WACKER DR.  
SUITE 500  
CHICAGO, IL 60606  
TEL (312) 934-4900  
FAX (312) 934-4999

FILE NAME = D16\M61-SHT-PLANPRF03.dgn	USER NAME = Frank.Stallone	DESIGNED - JTF	REVISED -
PLOT SCALE = 40.0000' / in.	CHECKED - MJT	DRAWN - JTF	REVISED -
PLOT DATE = 3/15/2013	DATE - 03/13/2013	REVISOR -	REVISED -

**STATE OF ILLINOIS  
DEPARTMENT OF TRANSPORTATION**

**PROPOSED PLAN AND PROFILE - US 45 (LAGRANGE ROAD)**

SCALE: 1" = 20' H: 1" = 5' | SHEET 3 OF 18 SHEETS | STA. 181+00.00 TO STA. 187+00.00

F.A.P. R.T.E.	SECTION	COUNTY	TOTAL SHEETS	SHEET NO.
330	103R-4	COOK	877	54
PP-03			CONTRACT NO. 60M61	
ILLINOIS FED. AID PROJECT				