

**NOTE 1:**  
 ANY PAVEMENT REMOVAL AND REPAIR IN THE PARKING LOT ENCOUNTERED DURING THE INSTALLATION OF CURB TYPE B SHALL NOT BE PAID FOR SEPARATELY BUT SHALL BE INCLUDED IN THE PAY ITEM "CONCRETE CURB TYPE B". MAINTAIN EXISTING DRAINAGE PATTERN

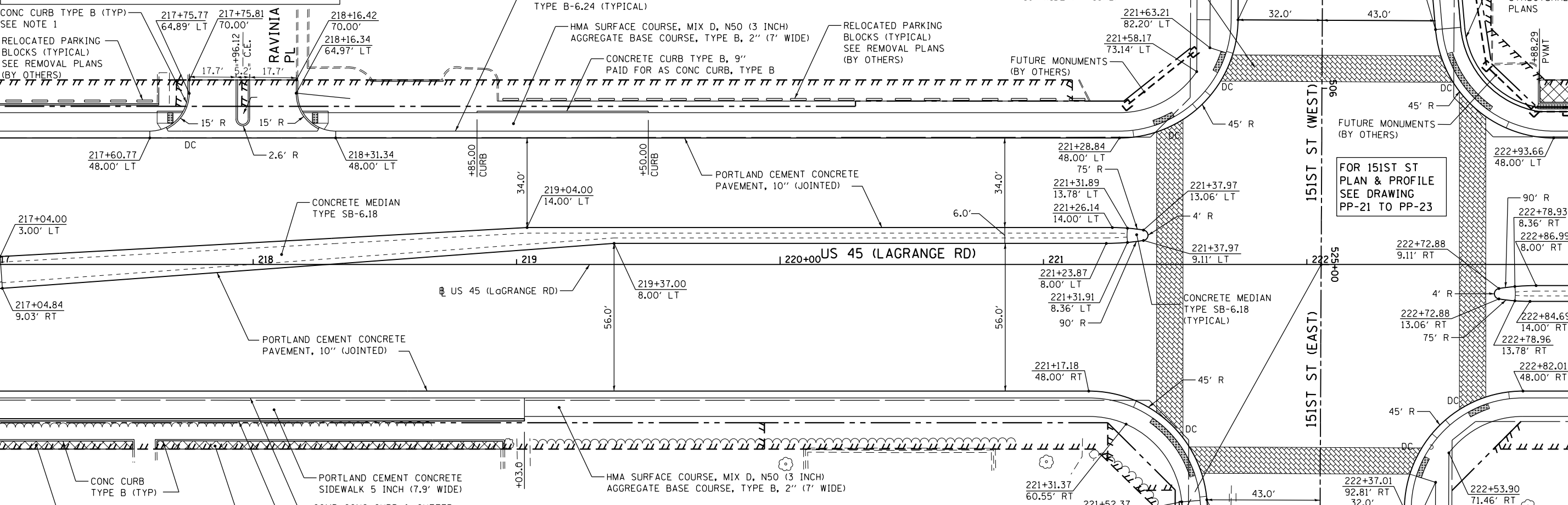

**NOTE:**  
 PARKING LOT PAVEMENT RESTORATION SHALL CONSIST OF MATCHING THE EXISTING PAVEMENT STRUCTURE. ESTIMATED QUANTITIES CONSIST OF  
 HMA SURFACE COURSE, MIX D, N50 (1 1/2" THICK)  
 HMA BINDER COURSE, IL-19.0, N50 (2 1/4" THICK)  
 AGGREGATE BASE COURSE, TYPE B, 8"

**LEGEND**  
 [Symbol] = PARKING LOT PAVEMENT RESTORATION  
 [Symbol] = DETECTABLE WARNINGS  
 [Symbol] = RETAINING WALL NO. 26  
 SEE STD 424001, 424006, 424011, 424016, 424021, 424026 & 424031 FOR DETAILS  
 STA 222+05.40 @ US 45 =  
 STA 506+66.80 @ 151ST ST (WEST)  
 STA 525+00.00 @ 151ST ST (EAST)

SEE DRAWING PP-08  
 MATCH LINE STA. 217+00.00

MATCH LINE STA. 223+00.00  
 SEE DRAWING PP-10

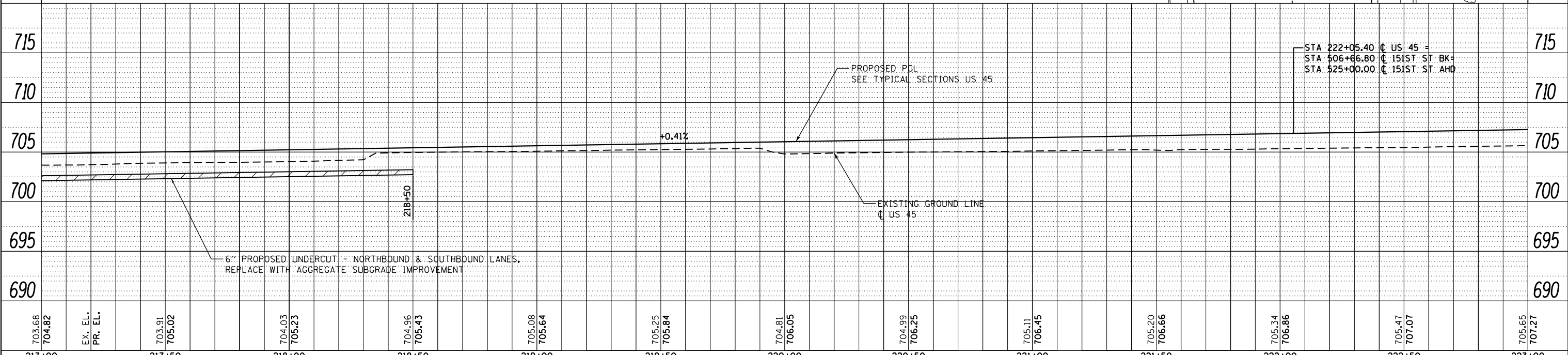

PLAN	SURVEYED	DATE
	PLOTTED	
	ALIGNED	
	CHECKED	
	FILED	
	NO.	

PROFILE	SURVEYED	DATE
	PLOTTED	
	GRADES CHECKED	
	STRUCTURE	
	NOT AT THIS OFFICE	
	NO.	

100 S. WACKER DR.  
 SUITE 500  
 CHICAGO, IL 60606  
 TEL (312) 557-0000  
 FAX (312) 557-4998

FILE NAME = D160M61-SHT-PLNPRF09.dgn	USER NAME = Frank.Stallone	DESIGNED - JTF	REVISED -	STATE OF ILLINOIS DEPARTMENT OF TRANSPORTATION	PROPOSED PLAN AND PROFILE - US 45 (LAGRANGE ROAD)	F.A.P. R.E. = 330	SECTION = 103R-4	COUNTY = COOK	TOTAL SHEETS = 877	SHEET NO. = 60
PLOT SCALE = 48.0000' / in.	CHECKED - MJT	REVISED -	SCALE: 1" = 20' H, 1" = 5' V			SHEET 9 OF 18 SHEETS	STA. 217+00.00 TO STA. 223+00.00	PP-09	CONTRACT NO. 60M61	ILLINOIS FED. AID PROJECT
PLOT DATE = 3/15/2013	DATE = 03/13/2013	REVISED -								
SHT_PLNPRF_URBAN										