

LEGEND

- DETOUR ROUTE
- TRAFFIC DIRECTION
- WORK ZONE

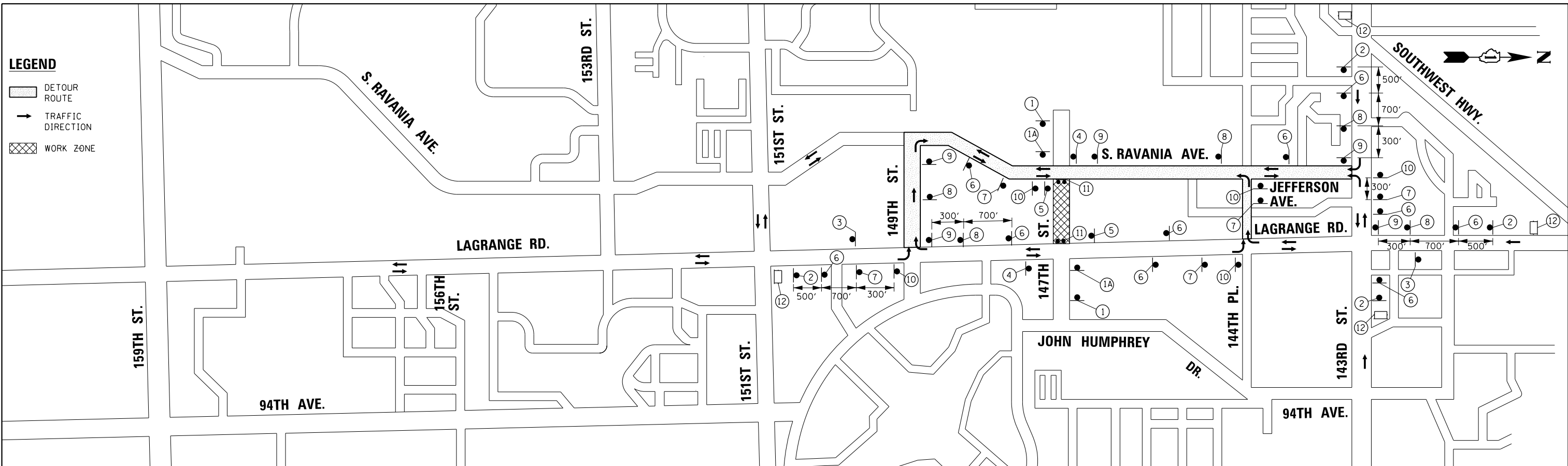

①	①A	②	③	④	⑤	⑥	⑦	⑧	⑨	⑩
W20-3(O)-48	W20-3(O)-48	W20-2(O)-48	M4-8A(O)-2412	R3-2-36	R3-1-36	WEST 147TH ST. DETOUR M6-3-2115	WEST 147TH ST. DETOUR M5-1L(O)-2115	WEST 147TH ST. DETOUR M5-1R(O)-2115	WEST 147TH ST. DETOUR M4-9R(O)-3024	WEST 147TH ST. DETOUR M4-9L(O)-3024

⑪	⑫
R11-2-4830 ON TYPE III BARRICADE (ALSO INSTALL AT CLOSED DRIVEWAYS)	PHASE I 3-SEC DISPLAY (18" LETTERS) PHASE II 3-SEC DISPLAY (18" LETTERS) PORTABLE CHANGEABLE MESSAGE SIGN (TOTAL 4 - EACH)

100 S. WACKER DR.
 SUITE 600
 CHICAGO, IL 60606
 TEL (312) 939-1000
 FAX (312) 939-4998
URS

FILE NAME = D160M61-SHT-DETOUR 5.dgn	USER NAME = Anthony.Plutz	DESIGNED - BA	REVISED -
		DRAWN - BA	REVISED -
		CHECKED - RCH	REVISED -
SHT.PLAN	PLOT DATE = 3/15/2013	DATE - 03/13/2013	REVISED -

**STATE OF ILLINOIS
DEPARTMENT OF TRANSPORTATION**

DETOUR PLAN - WEST LEG CLOSURE			
147TH STREET AT US 45 (LAGRANGE ROAD)			
SCALE: NTS	SHEET 5 OF 5 SHEETS	STA.	TO STA.

F.A.P. RTE. 330	SECTION 103R-4	COUNTY COOK	TOTAL SHEETS 877	SHEET NO. 91
MN-10			CONTRACT NO. 60M61	
ILLINOIS FED. AID PROJECT				